



Model - 40699

Slimline DVD Player

User's Guide



DIVX\MPEG4\DVD\SVCD\VCD\CD\MP3 PLAYER



Now you have purchased a Tevion product you can rest assured in the knowledge that as well as your 3 year parts and labour warranty you have the added peace of mind of dedicated help lines and web support

AFTER SALES SUPPORT

UK/N.IRELAND HELPINE NO 0161 975 0458

REP.IRELAND HELPLINE NO 1800 882912

WEB SUPPORT www.fascin8.co.uk

MODEL NUMBER: 40699

Contents

03	Introduction
04	General Information and Safety Instructions
05	Accessories
08	Remote Control Operation
09	Connecting Your DVD Player
11	DVD Operation
12	DVD Operation
13	USB Operation
14	Setup Menu
17	Troubleshooting
18	Technical Specifications
19	Warranty Card
20	Fault Report Card

Welcome!

Congratulations on choosing to buy a Tevion® product. By doing so you now have the assurance and peace of mind that comes with purchasing a product made by one of Europe's leading manufacturers. All products brought to you by Tevion® are manufactured to the highest standards of performance and safety, and, as part of our philosophy of customer service and satisfaction are backed by our comprehensive 3 year Warranty. Please fill in and return the Warranty Card to the address provided. We hope you will enjoy your purchase for many years to come.

General Information and Safety Instructions

- The lightning flash with arrowhead symbol, within an equilateral triangle, is intended to alert the user to the presence of un-insulated "dangerous voltage" within the product's enclosure that may be of sufficient magnitude to constitute a risk of electric shock.



The exclamation point within an equilateral triangle is intended to alert the user to the presence of important operation and servicing instructions in the literature accompanying the appliance.

- Please read through the following safety guidelines before use.
- **Ventilation-** Slots and openings in the case are provided for ventilation to ensure reliable operation of the video product and to protect it from overheating. These openings must not be blocked or covered.
- **Water and Moisture-** do not use this video product near water for example, near a bath tub, wash bowl, kitchen sink or laundry tub, in a wet basement, or near a swimming pool etc.
- **Cleaning-** Unplug this video product from the wall outlet before cleaning. Do not use liquid cleaners or aerosol cleaners. Use a damp cloth for cleaning.
- **Lightning-**For added protection for this video product during a lightning storm, or when it is left unattended and unused for long periods of time, unplug it from the wall outlet and disconnect the antenna or cable system. This will prevent damage to the video product due to lightning and power line surges.
- **Servicing-**Do not attempt to service this video product yourself, as opening or removing covers may expose you to dangerous voltage or other hazards. Refer all servicing to qualified service personnel.
- **Battery Handling and Usage** This remote control uses 2 x AAA alkaline batteries (included)
- Never throw batteries into a fire or expose to heat sources.
- If battery is swallowed, please seek immediate medical attention



Do not dispose of this product in your household waste. Contact your local authority for details of local recycling schemes



Batteries should not be disposed of in household waste. Batteries should be taken to appropriate disposal points or alternatively contact your local authority for details on disposal schemes



Do not dispose of this product in your household waste. Contact your local authority for details of local recycling schemes



- The player is classified as CLASS 1 LASER PRODUCT do not look directly at the laser this may harm your eyes

Accessories



Remote Control x 1



Scart Cable x 1



AV Cable x 1

Features

- **USB Functionality**
- **DVD Freeze frame function**
- **Random track playback**
- **Audio Out Connection**
- **RGB Connection**

Remote Control

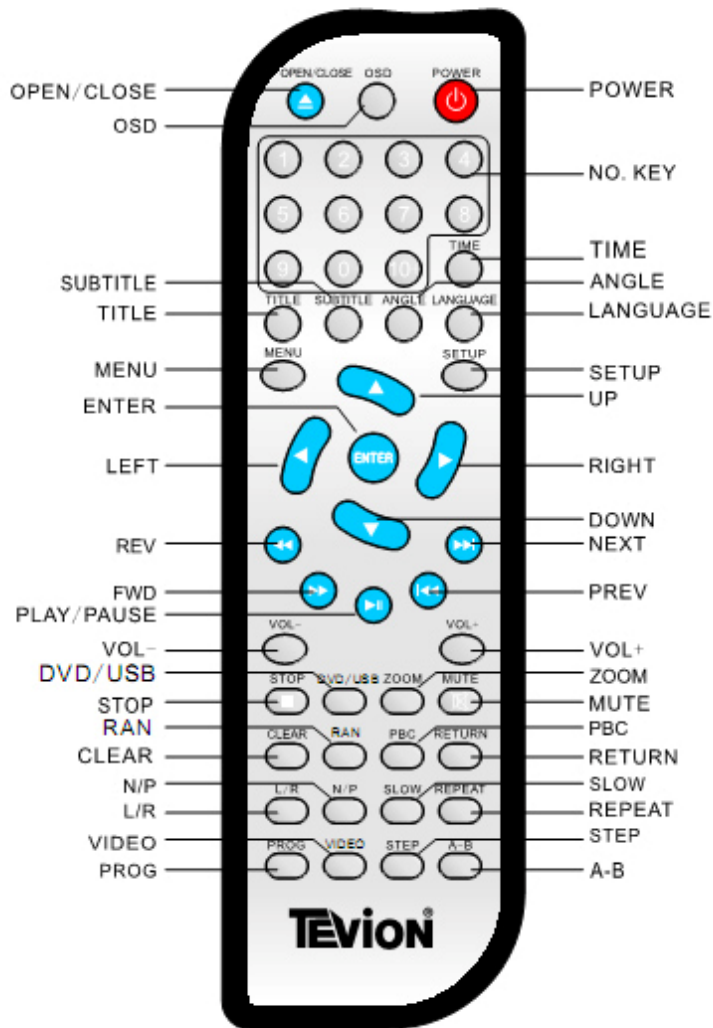

Remote Control Operation

REMOTE CONTROL OPERATION

1. remove battery cover
2. insert batteries
3. close the battery cover

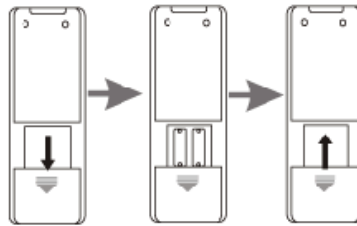

CARE FOR REMOTE CONTROL

Aim remote control at remote sensor of DVD.

Do not drop the unit from a high position or cause high impacts

Do not place the remote control in hot or moist environments

Do not splash water or any other liquid on remote control

Distance:

The remote control works best within 7 metres from the DVD player

Do not expose the remote control sensor directly to a heat source or it will malfunction



Connecting your DVD Player

Front Panel

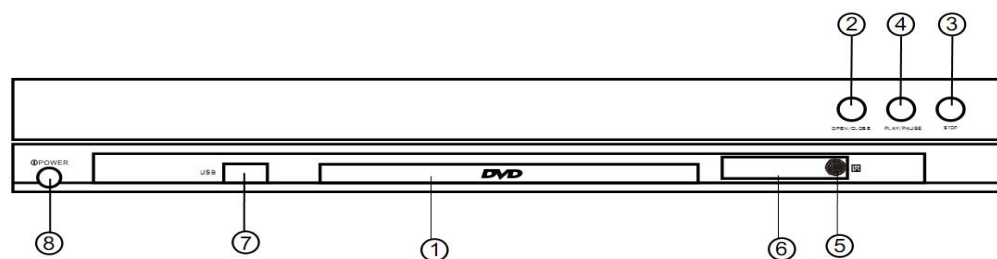

- | | |
|----------------------|---------------------------|
| 1. DVD DOOR | 5. REMOTE RECEIVER WINDOW |
| 2. OPEN/CLOSE BUTTON | 6. DISPLAY WINDOW |
| 3. STOP BUTTON | 7. USB JACK |
| 4. PLAY/PAUSE BUTTON | 8. POWER BUTTON |

Rear Panel

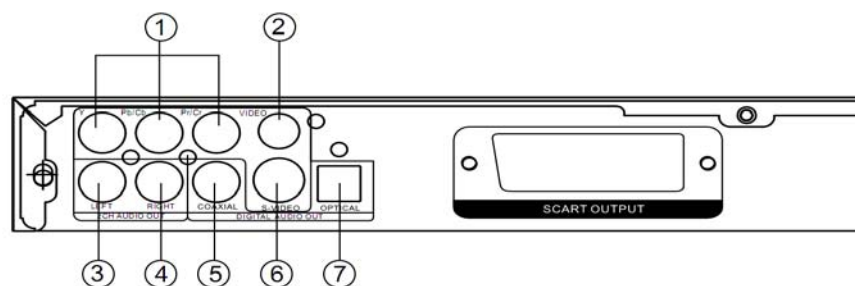

- | | |
|--|------------------------------------|
| 1. Y Pb/Cb Pr/Cr component output jack | 4. 2CH Right output jack |
| 2. Video output jack | 5. Digital Signal Coaxial out jack |
| 3. 2 CH Left output jack | 6. S-Video output jack |
| 7. Digital Signal Optical output jack | |

Connecting Your DVD Player

This product has a choice of three connections but these cannot be connected at the same time. The choice of connection will depend on the video jack on your TV,

- In order to connect your DVD to your TV simply use the scart lead provided to connect from the scart socket on the DVD to the scart socket on your TV itself. Then connect the power supply to a mains socket.
- Also via the AV Output socket from the DVD player using the AV cable provided (red, yellow and white) to the AV Input on your TV
- Also via the RGB socket (red, green and blue) from the DVD player to the RGB socket on your TV

Connecting to a HIFI System

If you also want to have your HIFI System connected to the DVD player you can connect via the audio output socket on the DVD using a RCA cable (red on the right, white on the left) but you must have Audio In on the HIFI System. You can also connect via an amplifier if you do not have Audio In on your HIFI System.

DVD Operation

After completing the connection of your appliance you can now switch the power to on and press the power button on the front of the unit. When you switch on your DVD your TV may automatically divert to the DVD mode and will display the Tevion logo on your TV screen (this is not the case for all appliances.) If this does not display then you may need to change your TV into the input mode you chose example scart, AV or RGB (refer to your TV user manual on how to do this.)

You will also need to press the 'Video' button on your remote to select the input mode of the DVD

- S-Video, choose S-video mode
- (Y.Cb,Cr) choose YUV mode
- Scart choose RGB mode

If you have an audio system connected you will need to choose the correct audio output on the amplifier (refer to your amplifier manual on how to do this.)

Disc Loading

Do not play any cracked broken or deformed disc. The disc is rotated at high speed, so it is very dangerous to play any broken or deformed disc and this may cause damage to the player.



Step 1: Press the 'open/close' button, the disc tray will slide out automatically

Step 2: Load a disc into the tray and press 'open/close' the screen will indicate loading and the player will identify the format of the disc, and then indicate it on the upper left of the TV screen

- After reading the disc it will go to the menu of the DVD or title menu
- When playing CD discs it will play in the sequence chapter number

Operation

During disc playback to pause the DVD press the 'play/pause' button and press this again to resume normal play

Press the 'stop' button once to stop your DVD and press 'play/pause' to resume. Press the stop button for the second time to stop the DVD completely.

Press 'previous' button, the previous chapter will be played

Press 'next' button, the next chapter will be played

By pressing the 'forward' or 'rewind' button continuously you can change the speed of skipping x2, x4, x8, x16, x32

Helpline No. UK/Northern Ireland 0161 975 0458 Rep.Ireland 1800-882912
Web Support www.fascin8.co.uk
Model Number: 40699

DVD Operation

You can select a desired subtitle from the available ones encoded on the disc, this operation is only available with supported DVDs press the 'subtitle' button continuously to change between languages.

Some DVDs also have the angle feature so you can view the film from another angle, if your DVD supports this option press the 'angle' button to change viewing angle.

During DVD playback press the 'title' button to return to the DVD root menu use the direction buttons to navigate through the menu, in the chapter selection menu you can use the numeric buttons to select the desired chapter

With CD playback press the numeric buttons to select the track or use the direction buttons to navigate to the chosen track.

When using VCD discs press the PBC button to return to root menu.

Press the 'N/P' button to select either format NTSC or PAL, this will depend on the colour format of your TV.

Press the 'slow' button during DVD playback to view your disc in slow motion press this continuously to change speed ½, ¼, 1/8, 1/16

Press the 'step' button to freeze the frame and continuously press this to move from frame to frame. Press the 'play/pause' button to resume normal play

You can zoom in on your DVD by pressing the 'zoom' button the zoom size will display on screen until you resume normal size playback press this continuously to increase the zoom x2, x3, x4

USB Operation

The USB reader only performs MP3 and JPEG picture playback. The maximum capacity the USB will accept is 4GB.

Power on your DVD player ensuring no disc is inserted in the tray, now insert the USB device and press the 'DVD/USB' button. Use the direction keys to navigate to the USB option, press 'enter' to select this and a waiting message will appear on your TV screen then press 'enter' again to confirm USB. Your files will then display on the screen, you can select your desired file using the direction keys to navigate to this and 'enter' button to confirm this



Please note if using a MP3 CD you can access your files as shown above.

With USB and MP3 music selection you have the option for repeat press the 'repeat' button to select from single song play, single song repeat, folder repeat or folder play. Press 'repeat' continuously and your choice will display on the bottom of your screen.

JPEG Picture Operation

When viewing JPEG pictures your screen will display as below use the direction keys to navigate to the picture you wish to view and press the 'enter' button to view the image on screen. This will automatically go from picture to picture within the folder you can use the direction keys to rotate your picture on screen. At any time press the 'title' button to return to the root menu

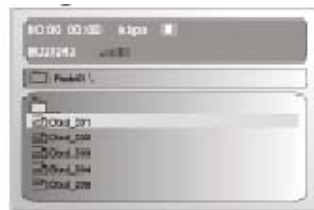

Setup Menu

To enter your Setup Menu select 'setup' button to navigate through the menu use the direction keys and 'enter' to confirm your selection

General Setup

In general setup you will have the following options

TV Display	Pan & Scan 16:9
	Letterbox 4:3
	Normal
Angle Mark	On
	Off
OSD Lang	English
	German
	Spanish
Captions	On
	Off
Screensaver	On
	Off
HDCD	Off
	1X
	2X

Audio

The audio menu gives you the following options

Downmix	L/T R/T
	Stereo
Spdif Output	Off
	Raw
	PCM

Setup Menu

Dolby

In Dolby menu you will have the following options

Dual Mono	Stereo
	L-Mono
	R-Mono
	Mix Mono
Dynamic	Off
	Full

Video

In video menu you will have the following options

Component	S-Video
	YUV
	RGB
TV Mode	
Sharpness	High
	Medium
	Low
Brightness	Setting
Contrast	Setting

Preference

In preference you will see the following options

TV Type	PAL
	Auto
	NTSC
Audio	Audio Language (8 Available)
Subtitle	Subtitle Language (8 Available)

Disc Menu	Menu Language (8 Available)
Parental	Settings
Password	Settings
Default	Reset

Helpline No. UK/Northern Ireland 0161 975 0458 Rep.Ireland 1800-882912
Web Support www.fascin8.co.uk
Model Number: 40699

Trouble Shooting

If you are having any problems with your player, check below for a possible cause and solution. Some simple checks or adjustment on your part may eliminate the problem and restore proper operation.

Symptom	Remedy
No Power	Insert the AC adaptor securely into the power outlet
No picture	<ul style="list-style-type: none">• Ensure the equipment is connected properly.• Ensure you are in the correct mode on both the player and your TV• Ensure the TV video socket is working properly
No sound	<ul style="list-style-type: none">• Check the audio settings are correct• Check the input setting for the TV and stereo system are correct• Ensure the equipment is connected properly
The disc does not load	<ul style="list-style-type: none">• Ensure the disc has been inserted into the tray correctly (with label facing up)• Make sure your disc is clean with no scratches• Ensure the disc format is compatible
The remote does not respond	<ul style="list-style-type: none">• Check the batteries are in the correct polarity• You are pointing the remote control at the sensor on the player not your TV
My USB is not loading	<ul style="list-style-type: none">• Ensure you are in USB mode• Check the USB is connected securely• Check files are compatible with the player

Technical Specifications

DVD Player

Power supply	AC 90-240V-50/60HZ
Power Consumption	11W
Weight	Around 1.5 kg
Video System	NTSC/PAL/AUTO
Optical read-out system	Semiconductor ALGaAs Weam,wave
Audio Frequency Response	DVD audio : Fs 48KHz PCM4 Hz ~ 22KHz Fs 48KHz PCM4 Hz ~ 22KHz
S/N Ration	≥90dB
Dynamic Range	≥90dB
Rotating Ration	Within measurable range
Operation Condition	Temperature 0°C ~ 40°C;Operation

Output

Video output	1.0V(p-p),75Ω
S-video output	(Y)1.0v(p-p), 75Ω (C)0.286V(p-p), 75Ω
Audio output(Analog Audio)	2.0V(rms)



SLIMLINE DVD PLAYER

WARRANTY CARD

Congratulations! You have an excellent choice with this purchase of this quality product. Our commitment to quality also includes our service. Should you contrary to expectations, experience defects due to manufacturing faults during private use within 36 months of the date of purchase we shall be liable for warranty in accordance with statutory warranty regulations provided that:

- the device was not put to any use other than the intended
- was not overloaded
- was not used with the wrong accessories
- repairs were not carried out by any other than the authorised workshop

The warranty certificate is only valid in connection with the receipt. Please keep both in a safe place.

This warranty does not affect your statutory rights.

This purchase is guaranteed for a period of three years beginning on the day of purchase. Keep your purchase receipt safe as proof of date of purchase. The guarantee can only be extended for the duration of any repair required. Should your item become defective during the warranty period, in the first instance please call our service centre on the number below, they will inform you of what to do next. We will at our discretion, either repair or exchange the device in accordance with warranty legislation.

Please enclose the following when sending your product in for repair:

1. Receipt (Proof of purchase)
2. This warranty certificate with the fault report form overleaf complete with your name contact details and fault description.

If the original receipt is not enclosed the repair will be charged in all cases. After the warranty has expired you can still send defective devices for repairs freight prepaid to the address stated below. Quotes as well as repairs after the warranty period are to be paid in all cases.

Ensure that the product is sent well packed as no responsibility can be accepted for items lost or damaged in transit. This warranty does not affect your statutory rights.



SLIMLINE DVD PLAYER

FAULT REPORT CARD

Name _____

Address _____

Email _____ Daytime Tel No _____

Model Number 40699 _____

Fault Description _____

Service Hotline

Fascin8 Ltd

14 Embankment Business Park, Vale Road

Heaton Mersey, Stockport, SK4 3GN

HELPLINE UK MAINLAND – 0161 975 0458

HELPLINE IRELAND – 1800-882912

WEBSUPPORT www.fascin8.co.uk

Helpline No. UK/Northern Ireland 0161 975 0458 Rep.Ireland 1800-882912

Web Support www.fascin8.co.uk

Model Number:

40699