



**SAMSUNG**

# **PDP-TELEVISION**

## **(PLASMA DISPLAY PANEL)**

### **Owner's Instructions**

Before operating the unit,  
please read this manual thoroughly,  
and retain it for future reference.

**ON-SCREEN MENUS**  
**PICTURE IN PICTURE (PIP)**  
**TELETEXT**

**SRS**   
**TruSurround XT**

**DNie™**

**◆ Screen Image retention**

Do not display a still image (such as on a video game) on the plasma monitor panel for more than 2 hours as it can cause screen image retention. This image retention is also known as “screen burn”. To avoid such image retention, reduce the degree of brightness and contrast of this screen when displaying a still image.

**◆ Cell Defect**

The plasma display panel consists of fine cells. Although the panels are produced with more than 99.9 percent active cells, there may be some cells that do not produce light or remain lit.

**◆ Height**

The PDP can normally operate only under 2000m in height. It might abnormally function at a place over 2000m in height and do not install and operate there.

**◆ Warranty**

- Warranty does not cover any damage caused by image retention.
- Burn-in is not covered by the warranty.

## Checking Parts

ENG



Owner's Instructions

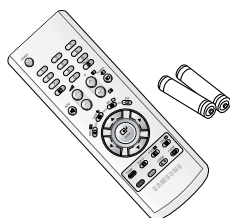

Remote Control/  
AAA Batteries



Power Cord



Antenna Cable

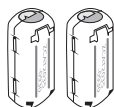

Ferrite Cores for  
Speaker Wire



Speaker Wires

### *Sold Separately*

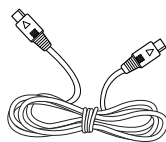

S-VIDEO Cable

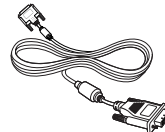

DVI Cable

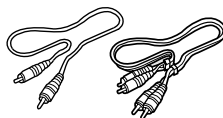

Component Cables  
(RCA)

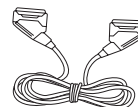

Scart Cable

# Contents

◆ <b>FOREWORD</b>	
■ Important ! .....	2
■ Checking Parts .....	3
◆ <b>CONNECTING AND PREPARING YOUR DISPLAY</b>	
■ Your New Plasma Display Panel .....	6
■ Infrared Remote Control .....	8
■ Inserting the Batteries in the Remote Control .....	9
■ Assembling the Stand-Base .....	9
■ Installing the Display on the Wall Attachment Panel .....	10
■ Connecting Speakers .....	12
■ Connecting to an Aerial or Cable Television Network .....	14
■ Connecting a Satellite Receiver or Decoder .....	14
■ Switching On and Off .....	15
■ Placing in Standby Mode .....	15
■ Becoming Familiar with the Remote Control .....	16
■ Plug & Play Feature .....	17
■ Choosing Your Language .....	18
◆ <b>SETTING THE CHANNELS</b>	
■ Storing Channels Automatically .....	19
■ Storing Channels Manually .....	20
■ Skipping Unwanted Channels .....	22
■ Sorting the Stored Channels .....	23
■ Assigning Names to Channels .....	24
■ Activating the Child Lock .....	25
■ Displaying Information .....	26
■ Using the LNA (Low Noise Amplifier) Feature .....	36
◆ <b>USING YOUR DISPLAY (continued)</b>	
■ Changing the Picture Standard .....	26
■ Adjusting the Picture Settings .....	27
■ Adjusting the Picture Settings (DVI Mode) .....	28
■ Using the Fine Tune .....	29
■ Viewing the Channel Scan Picture .....	30
■ Freezing the Current Picture .....	30
■ Selecting the Picture Size .....	31
■ Selecting the Film Mode .....	32
■ DNie™ (Digital Natural Image engine <b>DNie</b> ) .....	32
■ Setting the Blue Screen .....	33
■ Setting the Melody Sound .....	33
■ Viewing the Picture In Picture (PIP) .....	34
■ Using the Digital NR (Digital Noise Reduction) Feature .....	36
■ Changing the Sound Standard .....	37

## Contents (continued)

◆ USING YOUR DISPLAY	
■ Adjusting the Sound Settings .....	38
■ Adjusting the Volume Automatically .....	38
■ Setting the TruSurround XT .....	39
■ Selecting the Internal Mute .....	39
■ Selecting the Sound Mode (depending on the model) .....	40
■ Setting the Sleep Timer .....	41
■ Setting and Displaying the Current Time .....	42
■ Switching the Television On and Off Automatically .....	43
■ Viewing an External Signal Source .....	44
■ Redirecting an Input to the External Output .....	45
◆ USING THE TELETEXT FEATURE	
■ Teletext Feature .....	46
■ Displaying the Teletext Information .....	47
■ Selecting Display Options .....	48
■ Selecting a Teletext Page .....	49
◆ ADDITIONAL INFORMATION AND CONNECTIONS	
■ Connecting to the External Devices .....	50
■ Connecting to the S-Video Input .....	51
■ Connecting to the DVI Input .....	52
■ Connecting to the Component Input .....	53
■ Connecting and Using the Home Theater System .....	54
■ Pin Configurations .....	55
◆ RECOMMENDATIONS FOR USE	
■ Troubleshooting: Before Contacting Service Personnel .....	56

Symbols



Press



Important



Note

## Your New Plasma Display Panel

ENG

➤ The actual configuration on your PDP may be different, depending on your model.

### Front Panel

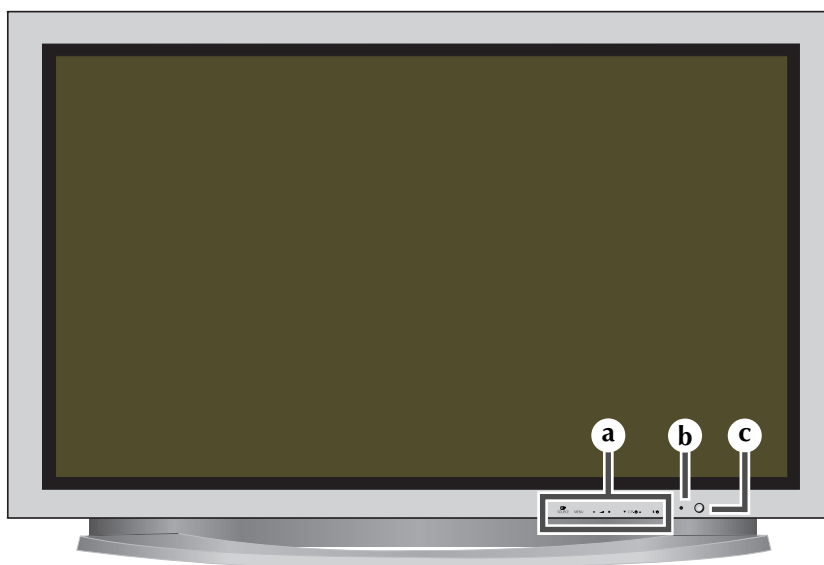

**a**



#### **SOURCE**

External input selection.

When the Main menu is displayed on screen, the Main menu is not operated with source key.

#### **MENU**

Menu display and exit.



Volume adjustment.



Channel selection. Auto power On.



Press to turn the PDP on and off.

**b**

#### **Power Indicator**

- Power Off; Red
- Power On; Off
- Timer On; Green

**c**

#### **Remote Control Signal Receiver**

Aim the remote control towards this spot on the PDP.

## Your New Plasma Display Panel (continued)

- The actual configuration on your PDP may be different, depending on your model.

ENG

### Rear Panel

- For further details about connection, refer to pages 50~54.

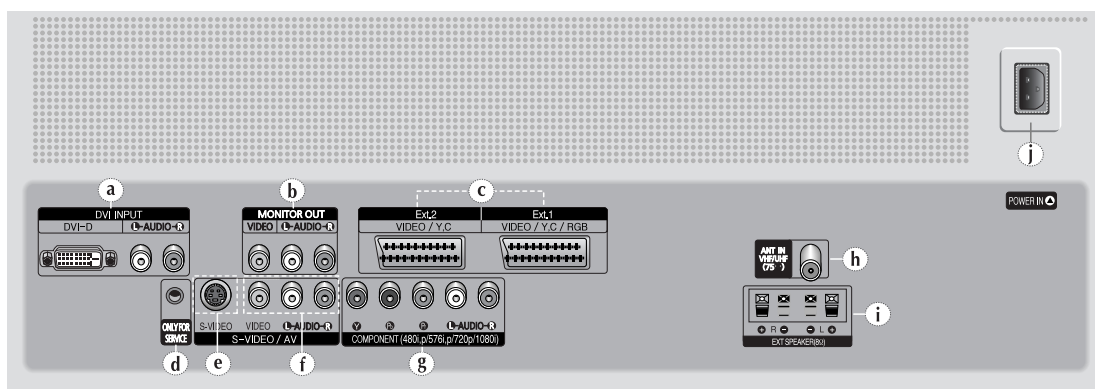

- a) DVI INPUT**  
Connect to digital video output jack for device with DVI output. (Not compatible with PC)
- b) MONITOR OUT (VIDEO / L-AUDIO-R)**  
Outputs for external devices
- c) Ext.1, Ext.2**  
Inputs or outputs for external devices, such as VCR, DVD, video game device or video disc players.
- d) ONLY FOR SERVICE**  
Connector for service only.
- e) S-VIDEO**  
Video and audio inputs for external devices with an S-Video output, such as a camcorder or VCR.
- f) AV (VIDEO / L-AUDIO-R)**  
Video and audio inputs for external devices, such as a camcorder or VCR.
- g) COMPONENT**  
Video (Y/Pb/Pr) and audio (L-AUDIO-R) inputs for Component.
- h) ANT IN VHF/UHF (75Ω)**  
75Ω Coaxial connector for Aerial/Cable Network.
- i) EXT SPEAKER(8Ω)**  
Connectors for external speakers.
- j) POWER IN**  
Connect the supplied power cord.

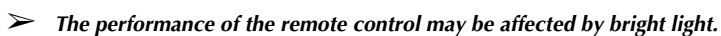



## Inserting the Batteries in the Remote Control

*You must insert or replace the batteries in the remote control when you:*

- ◆ *Purchase the PDP*
- ◆ *Find that the remote control is no longer operating correctly*

- 1 Remove the cover on the rear of the remote control by pressing the symbol (▼) downwards and then pulling firmly to remove it.
- 2 Insert two R03, UM4, "AAA" 1.5V or equivalent batteries taking care to respect the polarities:
  - ◆ - on the battery against - on the remote control
  - ◆ + on the battery against + on the remote control
- 3 Replace the cover by aligning it with the base of the remote control and pressing it back into place.

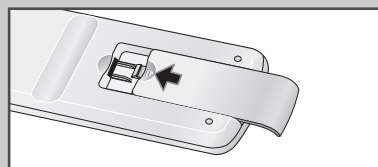
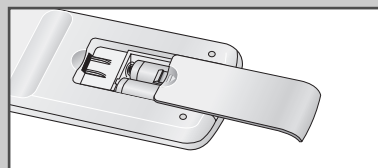
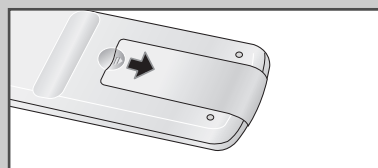

## Assembling the Stand-Base (Option)

*The stand base will be sold separately depending on model.*

- 1 Assemble two support pins with the stand base and firmly secure both sides of the support pins using 8 screws provided.
  - 2 Assemble the PDP with the stand and firmly secure the PDP using 4 screws provided.
- ◆ Two or more people should carry the PDP. Never lay the PDP on the floor because of possible damage to the screen. Always store the PDP upright.

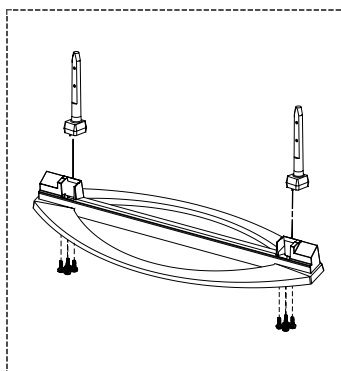
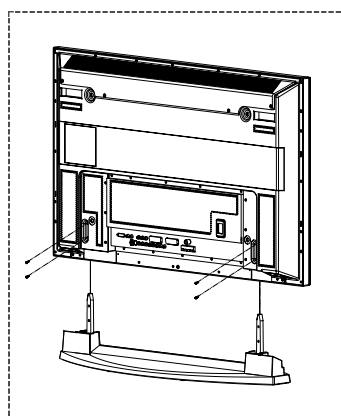

## Installing the Display on the Wall Attachment Panel

ENG

### Installation Notes

- ◆ Do not install the PDP on any place other than vertical walls.
- ◆ To protect the performance of the PDP and prevent troubles, avoid the followings:
  - Do not install next to smoke and fire detectors.
  - Do not install in an area subjected to vibration or high voltage.
  - Do not install near or around any heating apparatus.
- ◆ Use only recommended parts and components.

### Mounting Kits

Wall Mount Bracket

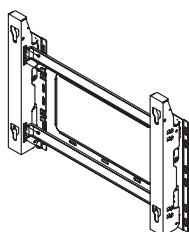

Plastic Hanger



4 EA

Screws



4 EA

### How to Adjust Mounting Angle

*(depending on your model)*

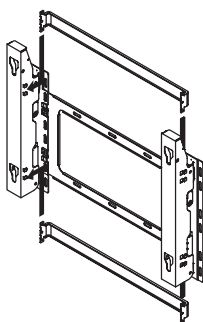

The wall mount bracket is delivered separately. Please tighten the captive screw in the direction of the arrow after assembling the bracket.

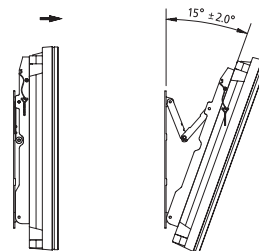

- 1 Secure the PDP to the wall mount bracket. (Please refer to the following instructions.)
- 2 Set the angle by pulling the upper end of the PDP attached to bracket in the direction of the arrow.
- 3 The angle can be adjusted from 0° to 15° by  $\pm 2^\circ$ .

## Installing the Display on the Wall Attachment Panel (continued)

- The exterior of the PDP may be different than the picture.  
(Assembly and installation of the plastic hanger is the same.)

ENG

- 1 Remove the screws from the back of the PDP.

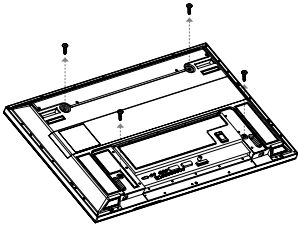

- 2 Use the screws and assemble the plastic hanger.



- ◆ Please ask the installers to install the wall mount bracket.
- ◆ Please be sure to check if the plastic hanger is completely secured on both the left and right side after hanging the PDP on the wall mount bracket.
- ◆ Please avoid catching your fingers while installing and adjusting the angle.
- ◆ Please tightly secure the wall mount bracket to the wall to avoid injury from a falling PDP.

- 3 Tighten the screws of the plastic hanger to the back side of the PDP.

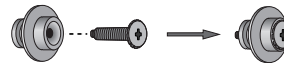
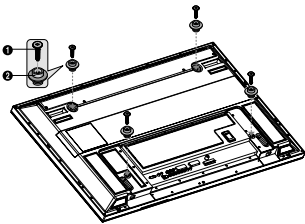

- 4 Put the 4 pegs on the PDP in the grooves of the wall mount bracket and pull down on the PDP (①) to secure it to the wall mount bracket (②). Tighten the screws as shown (③) so that the PDP cannot be separated from wall mount bracket.

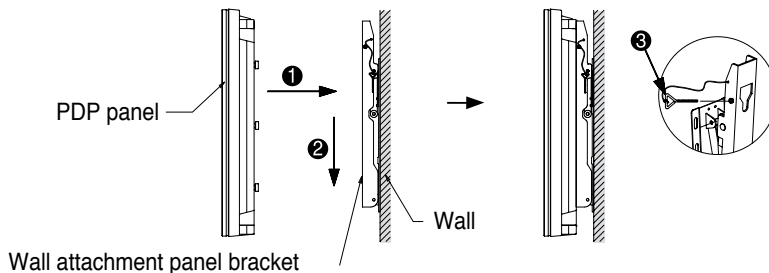

## Connecting External Devices to the PDP

- ◆ To connect external devices such as a DVD or a Home Theater System to the PDP, please refer to following instructions:

- 1 Be sure to remove the safety pins underneath the PDP.
  - ◆ If the safety pins are not removed, the angle cannot be adjusted. Any attempt to do so may cause damage to the PDP.
- 2 Pull out the bottom of the PDP (which has been attached to the Wall Mount Bracket) in the direction indicated by the arrows (refer to the illustration) until it clicks.
  - ◆ Using the PDP After Connecting External Devices.  
Be sure to secure the PDP by inserting the 2 safety pins after readjusting the angle of the PDP to 0°.
  - ◆ For safety, be sure to secure the PDP using the safety pins. If the safety pins are not used, the PDP may fall, causing serious injury.

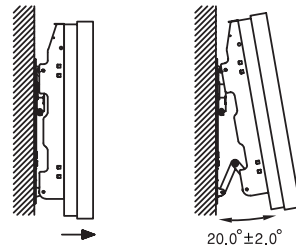

## Connecting Speakers

ENG

- 1 Remove the screws on the rear of the PDP.

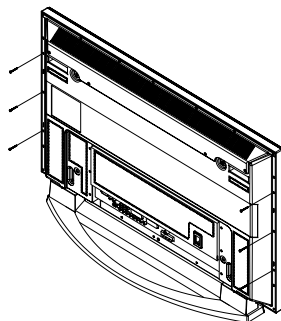

- 2 Hang the two "T" shaped hangers on the square holes on the rear of the PDP.

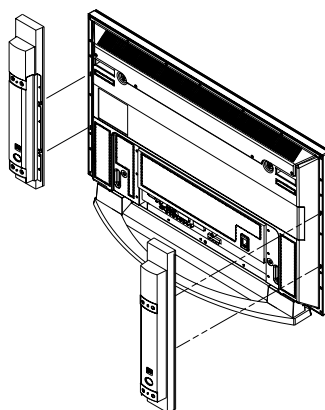

- 3 Tighten the PDP and the speaker bracket using the screws removed from the PDP.

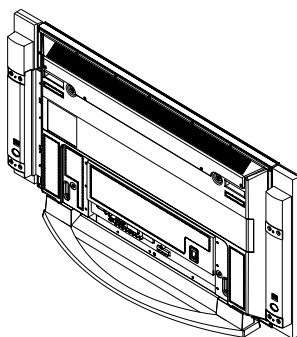

- When moving your PDP, do NOT hold the speaker connected to your PDP. It may damage the bracket clamping the speaker and your PDP together and result in a drop of your PDP and a risk of personal damage and injury.

## Connecting Speakers (continued)

ENG

Connect the speaker audio cable to the external speaker output jack on the rear of the PDP matching the “+” and “-” ends of the cable with the diagram on the PDP.

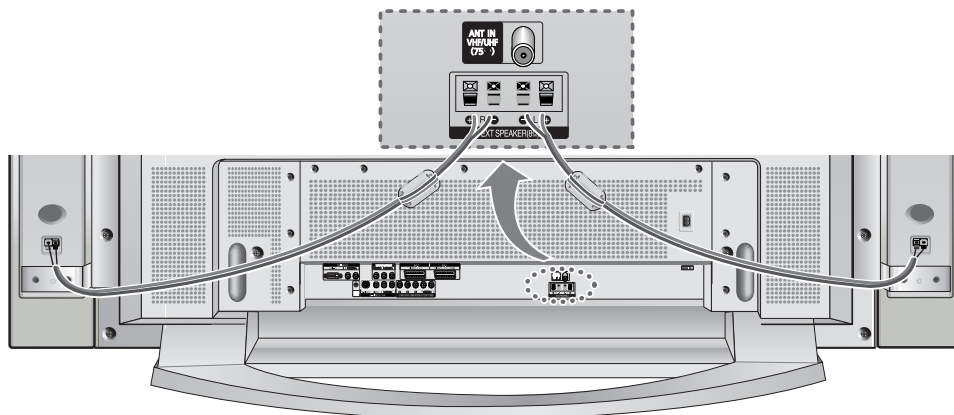

- ♦ The speakers MUST have to a power handling capability of 10 watts minimum (impedance 8Ω).
- ♦ When you connect the speaker wire to the external speaker out connector, first bind the speaker wire round the ferrite core to secure it.
- Before connecting the speaker wire to the PDP, turn off your PDP.

### Ferrite Cores

The ferrite cores are used to attenuate undesired signals. When connecting cables, attach one of these ferrite cores to the cable near the connector.

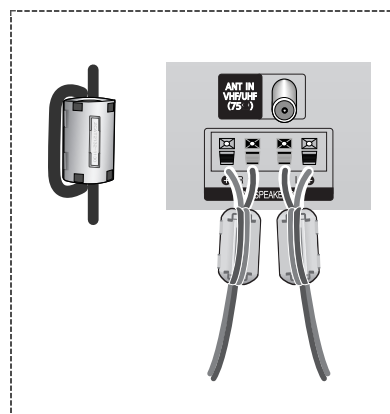

## Connecting to an Aerial or Cable Television Network

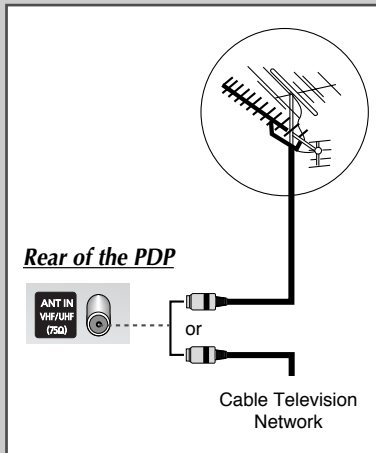

*To view television channels correctly, a signal must be received by the set from one of the following sources:*

- ◆ An outdoor aerial
- ◆ A cable television network
- ◆ A satellite network

- 1 In the first three cases, connect the aerial or network input cable to the 75Ω coaxial socket on the rear of the PDP.
- 2 If you are using an indoor aerial, you may need to turn it when tuning your PDP until you obtain a picture that is both sharp and clear.  
For further details, refer to:
  - ◆ "Storing Channels Automatically" on page 19
  - ◆ "Storing Channels Manually" on page 20

➤ When installing or re-installing your PDP, be sure to use the supplied coaxial antenna cable. If you connect using a different coaxial cable, there is risk of noise or interference to the screen image. (You must not use another general purpose cable.)

## Connecting a Satellite Receiver or Decoder

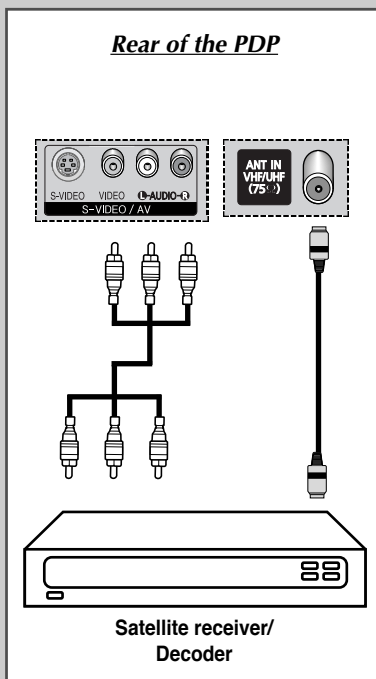

*In order to watch television programmes broadcast via a satellite network, you must connect a satellite receiver to the rear of the PDP. Also, in order to descramble a coded transmission signal, you must connect a decoder to the rear of the PDP.*

### Using a Coaxial cable

Connect a coaxial cable to the:

- ◆ Receiver (or Decoder) output socket.
- ◆ Television aerial input socket.

➤ If you wish to connect both a satellite receiver (or decoder) and a VCR, you should connect the:

- ◆ Receiver (or Decoder) to the VCR
- ◆ VCR to the PDP

Otherwise, connect the receiver (or decoder) directly to the PDP.

## Switching On and Off

*The mains lead is attached to the rear of your PDP.*

- 1 Plug the mains lead into an appropriate socket.  
Result: The Standby indicator on the front of the PDP lights up.  
 ➤ The main voltage is indicated on the rear of the PDP and the frequency is 50 or 60Hz.
- 2 Press the "I / ⏻" button on the front of the PDP (or **POWER** (⏻) button on the remote control) to switch the PDP on.  
Result: The programme that you were watching last is re-selected automatically.  
 ➤ If you have not yet stored any channels, No clear picture appears. Refer to "Storing Channels Automatically" on page 19 or "Storing Channels Manually" on page 20.
- 3 To switch your PDP off, press the "I / ⏻" button again.

*Front of the PDP*

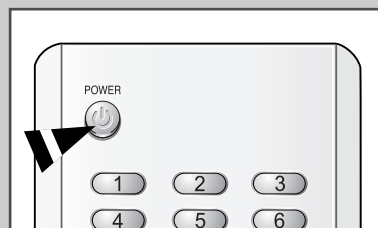
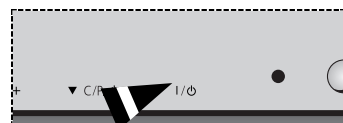

## Placing in Standby Mode

*Your PDP can be placed in Standby mode, in order to reduce the Power consumption.*

*The Standby mode can be useful when you wish to interrupt viewing temporarily (during a meal, for example).*

- 1 Press the **POWER** (⏻) button on the remote control.  
Result: The screen is turned off and the Standby indicator on the front of the PDP lights.
- 2 To switch the PDP back on, simply press the **POWER** (⏻) button again or a numeric button.  
 ➤ You can also switch on by pressing the **P** (⏻) or (⏻) button.

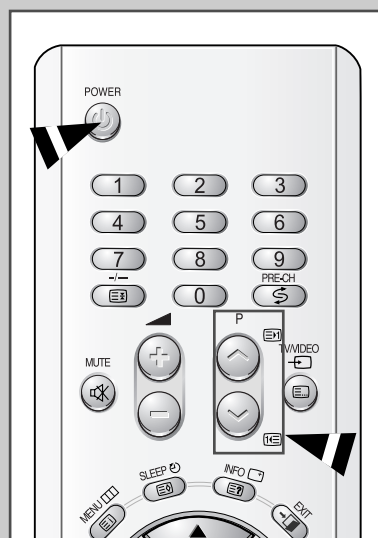

## Becoming Familiar with the Remote Control

ENG

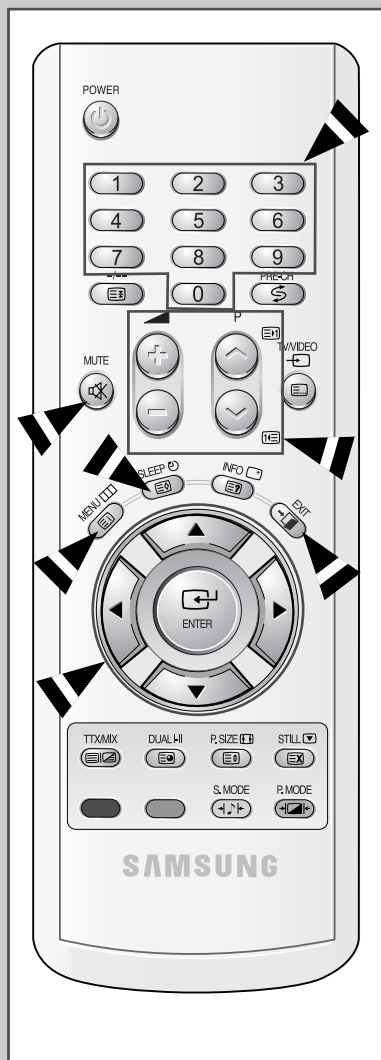

The remote control is used mainly to:

- ◆ Change channels and adjust the volume
- ◆ Display the on-screen menu system

The following table presents the most frequently used buttons and their functions.

Button	Viewing Function	Menu Function
	Used to display the next stored channel.	—
	Used to display the previous stored channel.	—
	Used to display the corresponding channels. ➤ For double digit channels, the second digit must be pushed immediately after the first. Failure to do this will result in a single digit channel being displayed.	
<b>SLEEP</b>	Used to select a preset time interval (off - 30 - 60 - 90 - 120 - 150-180).	
	Used to increase the volume.	—
	Used to decrease the volume.	—
<b>MUTE</b>	Used to switch the sound off temporarily. ➤ To turn the sound back on, press this button again, or press the  or  button.	
<b>MENU</b>	Used to display the on-screen menu system.	Used to return to the previous menu or normal viewing.
	—	Used to: ◆ Display a submenu containing selections for the current menu option ◆ Increase/decrease a menu option value
	—	Used to confirm your choice.
<b>EXIT</b>	—	Used to exit from the menu system and return to normal viewing directly.



## Plug & Play Feature

*When the television is initially powered ON, several basic customer settings proceed automatically and subsequently. The following settings are available.*

- 1 If the television is in Standby mode, press the **POWER** (⏻) button on the remote control.

**Result:** The message **Plug & Play** is displayed. It flickers for a little while, and then the **Language** menu is automatically displayed.

- 2 Select the appropriate language by pressing the ▼ or ▲ button.

- 3 Press the **ENTER** (↵) button to confirm your choice.

**Result:** The message **Antenna input check** is displayed.

- 4 Make sure that the antenna is connected to the TV, and then press the **ENTER** (↵) button.

**Result:** The **Country** menu is displayed.

- 5 Select your country by pressing the ▼ or ▲ button.

- 6 Press the **ENTER** (↵) button to confirm your choice.

**Result:** The **Auto Store** menu is displayed.

- 7 To start the search, press the **ENTER** (↵) button.

**Result:** The search will end automatically. Channels are sorted and stored in an order which reflects their position in the frequency range (with lowest first and highest last). When it has finished, the Clock Set menu is displayed.

➤ To stop the search before it has finished or return to normal viewing, press the **MENU** (⏻) button.

- 8 Press the **ENTER** (↵) button to set the Clock. Press the ◀ or ▶ button to move to the hour or minute. Set the hour or minute by pressing the ▼ or ▲ button.

- 9 When it has finished, the message **Enjoy Your Watching** is displayed, and then the channel which has been stored will be activated.

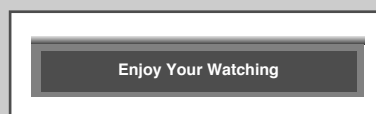
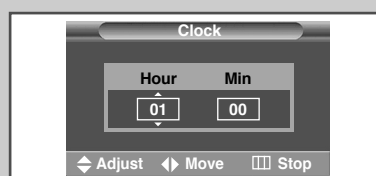
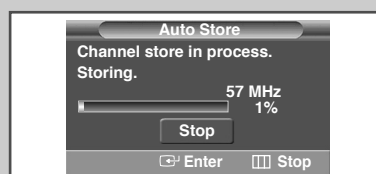
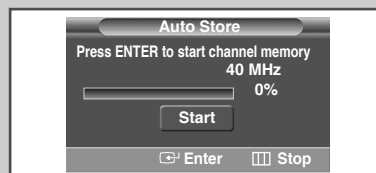
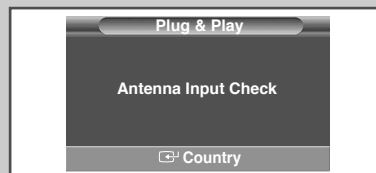

## Plug & Play Feature (continued)

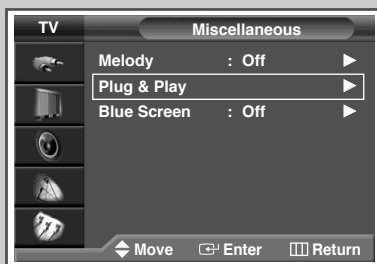

*If you want to reset this feature...*

- 1 Press the **MENU** button.  
Result: The main menu is displayed.
- 2 Press the ▼ or ▲ button to select **Setup**.  
Result: The options available in the **Setup** group are displayed.
- 3 Press the **ENTER** (↵) button.
- 4 Press the ▼ or ▲ button to select **Miscellaneous**. Press the **ENTER** (↵) button.  
Result: The options available in the **Miscellaneous** group are displayed.
- 5 Press the ▼ or ▲ button to select **Plug & Play**. Press the **ENTER** (↵) button.  
Result: The message **Plug & Play** is displayed.
- 6 For further details on how to set, refer to the opposite page.

## Choosing Your Language



*When you start using your television for the first time, you must select the language which will be used for displaying menus and indications.*

- 1 Press the **MENU** button.  
Result: The main menu is displayed.
- 2 Press the ▼ or ▲ button to select **Setup**.  
Result: The options available in the **Setup** group are displayed.
- 3 Press the **ENTER** (↵) button
- 4 Press the ▼ or ▲ button to select **Language**. Press the **ENTER** (↵) button.  
Result: The languages available are listed.
- 5 Select the appropriate language by pressing the ▼ or ▲ button.
- 6 Press the **ENTER** (↵) button to confirm your choice.
- 7 When you are satisfied with your choice, press the **EXIT** (⏏) button to return to normal viewing.

# Storing Channels Automatically

*You can scan for the frequency ranges available to you, (availability depends on your country). Automatically allocated programme numbers may not correspond to actual or desired programme numbers. However you can sort numbers manually and clear any channels you do not wish to watch.*

- 1 Press the **MENU** button.

Result: The main menu is displayed.

- 2 Press the **▼** or **▲** button to select **Channel**.

Result: The options available in the **Channel** group are displayed.

- 3 Press the **ENTER** () button.

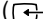
- 4 Press the **▼** or **▲** button to select **Country**. Press the **ENTER** () button.

Result: The countries available are listed.

- 5 Select your country (or area) by pressing the **▼** or **▲** button.

➤ If you have selected the **Others** option but do not wish to scan the PAL frequency range, store the channels manually (see page 21).

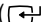
- 6 Press the **ENTER** () button to confirm your choice

- 7 Press the **▼** or **▲** button to select **Auto Store**. Press the **ENTER** () button.

Result: The **Auto Store** menu is displayed.

- 8 Press the **ENTER** () button to start the search.

Result: The search will end automatically. Channels are sorted and stored in an order which reflects their position in the frequency range, (with lowest first and highest last). The programme originally selected is then displayed.

➤ To stop the search before it has finished, press the **MENU** () button.

- 9 When the channels have been stored, you can:

- ◆ Sort them in the order required (see page 23)
- ◆ Clear a channel (see page 22)
- ◆ Fine-tune channel reception if necessary (see page 29)
- ◆ Assign a name to the stored channels (see page 24)
- ◆ Activate/deactivate the Digital Noise Reduction feature (see page 36)

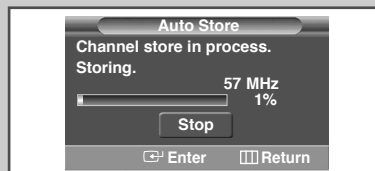

# Storing Channels Manually

ENG



You can store up to 100 television channels, including those received via cable networks.

When storing channels manually, you can choose:

- ◆ Whether or not to store each of the channels found
- ◆ The programme number of each stored channel which you wish to identify

- 1 Press the **MENU** button.  
Result: The main menu is displayed.
- 2 Press the ▼ or ▲ button to select **Channel**.  
Result: The options available in the **Channel** group are displayed.
- 3 Press the **ENTER** (↵) button.
- 4 Press the ▼ or ▲ button to select **Manual Store**. Press the **ENTER** (↵) button.  
Result: The **Manual Store** menu is displayed.
- 5 If necessary, select the broadcasting standard required. Press the ◀ or ▶ button to select **Colour System** and press the ▼ or ▲ button. The colour standards are displayed in the following order. (depending on the model).  
**Auto - PAL - SECAM or**  
**Auto - NT3.58 - NT4.43 - PAL60**
- 6 Press the ◀ or ▶ button to select **Sound System** and press the ▼ or ▲ button. The sound standards are displayed in the following order. (depending on the model).  
**BG - DK - I - L**

## Storing Channels Manually (continued)

ENG

- 7 If you know the number of the channel to be stored, see the following steps.
  - ◆ Press the ◀ or ▶ button to select **Channel1**.
  - ◆ Press the ▼ or ▲ button to select **C** (Air channel) or **S** (Cable channel).
  - ◆ Press the ▶ button.
  - ◆ Press the numeric buttons (0~9) to select indicate the required number.

➤ If no sound or abnormal sound, re-select the sound standard required.

- 8 If you do not know the channel numbers, select the **Search** by pressing the ◀ or ▶ button. Press the ▼ or ▲ button to start the search.
 

Result: The tuner scans the frequency range until the first channel or the channel that you selected is received on your screen.

- 9 To assign a programme number to a channel, select the **Prog.** by pressing the ◀ or ▶ button. Press the ▼ or ▲ button until you find the correct number.

- 10 To store the channel and associated programme number, select the **Store** by pressing the ◀ or ▶ button. Press the **ENTER** (↵) button.

- 11 Repeat Steps 7 to 10 for each channel to be stored.



### Channel mode

- ◆ **C** (Real channel mode): You can select a channel by entering the assigned number to each air broadcasting station in this mode.
- ◆ **S** (Cable channel mode): You can select a channel by entering the assigned number for each cable channel in this mode.

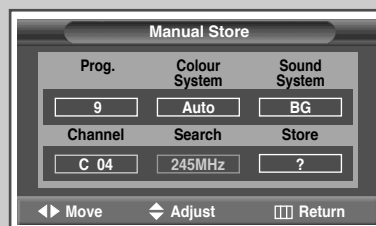
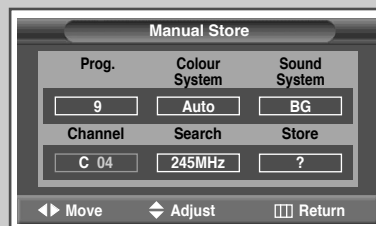

## Skipping Unwanted Channels

ENG

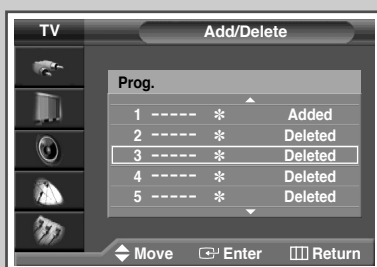

### ◆ Skipping unwanted channels

You can exclude the channels of your choice from the channel scan operation. When you scan through the stored channels, those that you have chosen to skip are thus not displayed. All channels that you do not specifically choose to skip are displayed during scanning.

- 1 Press the **MENU** button.  
Result: The main menu is displayed.
- 2 Press the **▼** or **▲** button to select **Channel**.  
Result: The options available in the **Channel** group are displayed.
- 3 Press the **ENTER** (**↵**) button.
- 4 Press the **▼** or **▲** button to select **Edit**. Press the **ENTER** (**↵**) button.  
Result: The **Edit** menu is displayed.
- 5 Press the **▼** or **▲** button to select **Add/Delete**. Press the **ENTER** (**↵**) button.  
Result: The **Add/Delete** menu is displayed with the current channel automatically is selected.
- 6 Press the **▼** or **▲** button to select the channel to be deleted.
- 7 Press the **ENTER** (**↵**) button.
- 8 To add or delete the channel, select **Added** or **Deleted** by pressing the **▼** or **▲** button. Press the **ENTER** (**↵**) button to confirm.

## Sorting the Stored Channels

*This operation allows you to change the programme numbers of stored channels. This operation may be necessary after using ATM. You can delete those channels you do not want to keep.*

- 1 Press the **MENU** button.  
Result: The main menu is displayed.
- 2 Press the ▼ or ▲ button to select **Channel**.  
Result: The options available in the **Channel** group are displayed.
- 3 Press the **ENTER** (↵) button.
- 4 Press the ▼ or ▲ button to select **Edit**. Press the **ENTER** (↵) button.  
Result: The **Edit** menu is displayed.
- 5 Press the ▼ or ▲ button to select **Sort**. Press the **ENTER** (↵) button.  
Result: The **Sort** menu is displayed.
- 6 Select the channel that you wish to move by pressing the ▼ or ▲ button. Press the **ENTER** (↵) button.
- 7 Select the number of the programme to which the channel is to be moved by pressing the ▼ or ▲ button. Press the **ENTER** (↵) button.  
Result: The channel is moved to its new position and all other channels are shifted accordingly.
- 8 Repeat Steps 6 to 7 until you have moved all the channels to the required programme numbers.

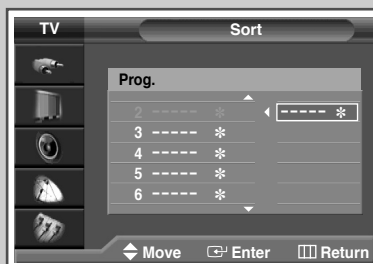
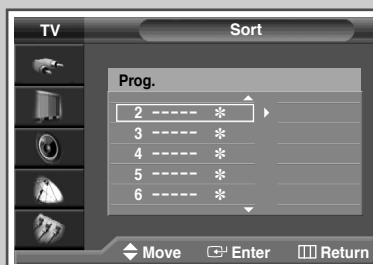

## Assigning Names to Channels

ENG

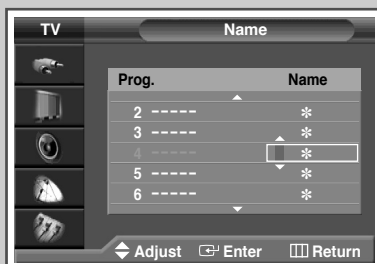
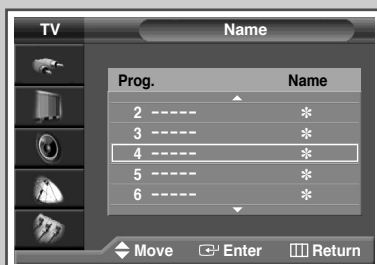

*Channel names will be assigned automatically when channel information is broadcast. These names can be changed, allowing you to assign new names.*

- 1 Press the **MENU** button.  
Result: The main menu is displayed.
- 2 Press the ▼ or ▲ button to select **Channel**.  
Result: The options available in the **Channel** group are displayed.
- 3 Press the **ENTER** (⏏) button.
- 4 Press the ▼ or ▲ button to select **Edit**. Press the **ENTER** (⏏) button.  
Result: The **Edit** menu is displayed.
- 5 Press the ▼ or ▲ button to select **Name**. Press the **ENTER** (⏏) button.  
Result: The **Name** menu is displayed with the current channel automatically is selected.
- 6 If necessary, select the channel to be assigned a new name by pressing the ▼ or ▲ button. Press the **ENTER** (⏏) button.  
Result: Arrow indications are displayed around the name box.
- 7 Press the ▼ or ▲ button to select a letter (A~Z), a number (0~9) or a symbol (–, space). Move on the previous or next letter by pressing the ◀ or ▶ button.
- 8 When you have finished entering the name, press the **ENTER** (⏏) button to confirm the name.



# Activating the Child Lock

ENG

## ◆ Activating the child lock

This feature allows you to lock selected channels so that they cannot be viewed. This can be used to prevent unauthorised viewing of unsuitable programmes.

- 1 Press the **MENU** button.  
Result: The main menu is displayed.
- 2 Press the ▼ or ▲ button to select **Channel**.  
Result: The options available in the **Channel** group are displayed.
- 3 Press the **ENTER** (↵) button.
- 4 Press the ▼ or ▲ button to select **Edit**. Press the **ENTER** (↵) button.  
Result: The **Edit** menu is displayed.
- 5 Press the ▼ or ▲ button to select **Child Lock**. Press the **ENTER** (↵) button.  
Result: The **Child Lock** menu is displayed with the current channel automatically is selected. Blue Screen is displayed when the **Child Lock** is activated.
- 6 Press the ▼ or ▲ button to select the channel to be locked.
- 7 Press the **ENTER** (↵) button. To lock the channel, select **Locked** by pressing the ▼ or ▲ button (to unlock the channel, select **Unlocked**). Press the **ENTER** (↵) button to confirm.

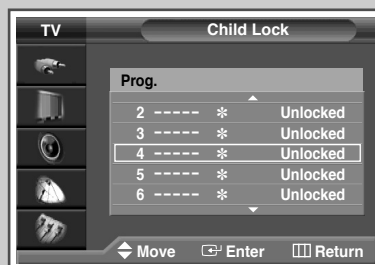

## Displaying Information

ENG

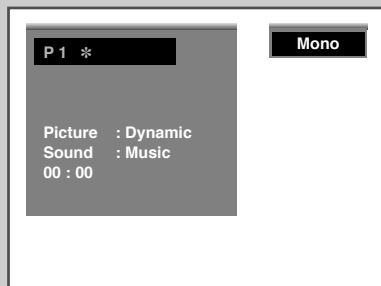

You can view the channel information and setting status you select by pressing the “INFO (+)” button on the remote control.

## Changing the Picture Standard

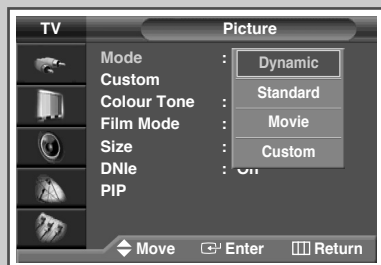
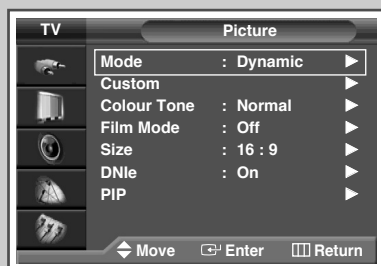

You can select the type of picture which best corresponds to your viewing requirements.

- 1 Press the **MENU** button.  
Result: The main menu is displayed.
- 2 Press the **▼** or **▲** button to select **Picture**.  
Result: The options available in the **Picture** group are displayed.
- 3 Press the **ENTER** ( ) button.  
Result: The **Mode** is selected.
- 4 Press the **ENTER** ( ) button again.  
Result: The options available are listed.
- 5 Select the option by pressing the **▼** or **▲** button.  
Result: The following modes are available depending on the input source.  
  - ◆ **Dynamic - Standard - Movie - Custom**
  - ◆ **High - Middle - Low - Custom** (DVI Mode).
- 6 Press the **ENTER** ( ) button to confirm.

➤ You can also set these options simply by pressing the **P.MODE** ( ) (Picture Mode) button.

# Adjusting the Picture Settings

Your television has several settings which allow you to control picture quality.

- 1 Press the **MENU** button.  
Result: The main menu is displayed.
- 2 Press the ▼ or ▲ button to select **Picture**.  
Result: The options available in the **Picture** group are displayed.
- 3 Press the **ENTER** (↵) button.
- 4 Select the required option (**Custom**, **Colour Tone**) pressing the ▼ or ▲ button.
- 5 Press the ▼ or ▲ button to select **Custom**. Press the **ENTER** (↵) button.  
Result: The **Custom** menu is displayed.
- 6 Press the **ENTER** (↵) button to change the setting. The options are displayed in the following order.
  - ◆ **Custom** : **Contrast**, **Brightness**, **Sharpness**, **Colour**, **Tint**(NTSC ONLY)
    - **Custom** Options available in **DVI Mode**: **Contrast**, **Brightness**, **Sharpness**.
    - The horizontal bar is displayed. Move the horizontal bar's cursor left or right by pressing the ◀ or ▶ button.
    - When the Picture Mode is set to **Custom**, the settings values may vary depending on the input source. (ex. RF, Video, Component or DVI)
    - If you make any changes to these settings, the picture standard is automatically switched to the **Custom**
  - ◆ **Colour Tone** : **Cool2**, **Cool1**, **Normal**, **Warm1**, **Warm2**
- 7 When you are satisfied with the settings, press the **EXIT** (→) button to return to normal viewing.

- If you make any changes to these settings, the picture standard is automatically switched to the **Custom**.

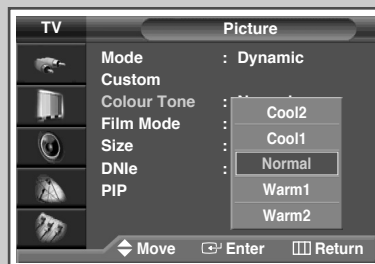
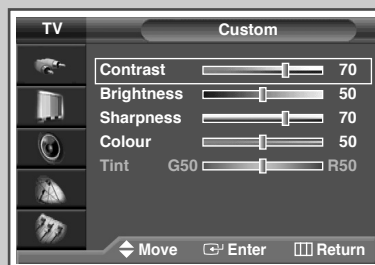
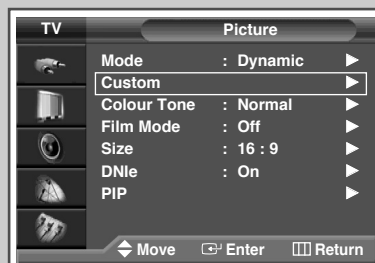

## Adjusting the Picture Settings (DVI Mode)

➤ Preset to the **DVI** mode by using the **TV/VIDEO** button.(or **SOURCE** button on the front of the PDP)

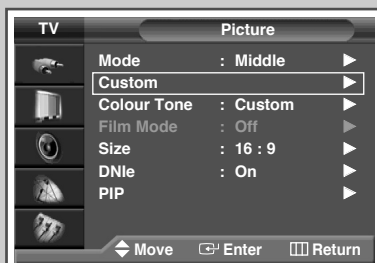

- 1 Press the **MENU** button.  
Result: The main menu is displayed.
- 2 Press the ▼ or ▲ button to select **Picture**.  
Result: The options available in the **Picture** group are displayed.
- 3 Press the **ENTER** (⏏) button.
- 4 Press the ▼ or ▲ button to select **Custom**. Press the **ENTER** (⏏) button.  
Result: The **Custom** menu is displayed.
- 5 Press the ▼ or ▲ button to select the option (**Contrast**, **Brightness**, **Sharpness**) to be adjusted. Press the **ENTER** (⏏) button.  
Result: The horizontal bar is displayed. Move the horizontal bar's cursor left or right by pressing the ◀ or ▶ button.
- 6 Press the **MENU** button to confirm your choice.

## Using the Fine Tune

ENG

*If reception is weak, you can fine tune a channel manually.*

- 1 Press the **MENU** button.  
Result: The main menu is displayed.
  - 2 Press the ▼ or ▲ button to select **Channel**.  
Result: The options available in the **Channel** group are displayed.
  - 3 Press the **ENTER** (↵) button.
  - 4 Press the ▼ or ▲ button to select **Fine tune**. Press the **ENTER** (↵) button.  
Result: The horizontal bar is displayed. Move the horizontal bar's cursor left or right by pressing the ◀ or ▶ button to reach the required setting.
  - 5 Press the ◀ or ▶ button until the picture and sound are both clear and sharp.
- If you are unable to fine tune a channel, check that the **Colour System** and **Sound System** settings are correct.
  - Fine tune Store will change the colour of the Channel **OSD**(On Screen Display) from **White** to **Red**.
  - To reset the fine tuning to "0", press the ▼ button to select "Reset", then press the **ENTER** button.



## Viewing the Channel Scan Picture

ENG

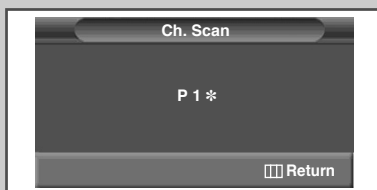

- 1 Press the **MENU** button.  
Result: The main menu is displayed.
- 2 Press the ▼ or ▲ button to select **Channel**.  
Result: The options available in the **Channel** group are displayed.
- 3 Press the **ENTER** (⏏) button.
- 4 Press the ▼ or ▲ button to select **Ch. Scan**. Press the **ENTER** (⏏) button.  
Result: You can view every memorized channel in order.

## Freezing the Current Picture

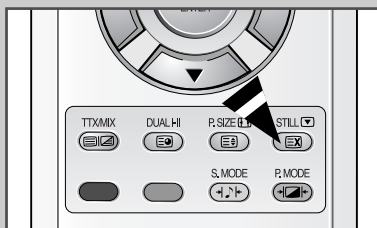

*You can freeze the picture when watching a television programme simply by pressing the "STILL" button. To return to normal viewing, press it again.*

- In the PIP mode, the main and sub pictures are stilled at the same time.
- This function will automatically cancel after 5 minutes.



## Selecting the Picture Size

*You can select the picture size which best corresponds to your viewing requirements.*

- 1 Press the **MENU** button.  
Result: The main menu is displayed.
- 2 Press the ▼ or ▲ button to select **Picture**.  
Result: The options available in the **Picture** group are displayed.
- 3 Press the **ENTER** (↵) button.
- 4 Press the ▼ or ▲ button until the **Size** is selected. Press the **ENTER** (↵) button
- 5 Press the ▼ or ▲ button to change the setting.
  - ◆ **Auto Wide** : Expanding and pulling up the picture from 4:3 to 16:9 ratio.
  - ◆ **16:9** : Sets the picture to 16:9 wide mode.
  - ◆ **Panorama** : Use this mode for the wide aspect ratio of a panoramic picture.
  - ◆ **Zoom** : Magnify the size of the picture vertically on screen.
  - ◆ **14:9** : Magnify the size of the picture more than 4:3.
  - ◆ **4:3** : Sets the picture to 4:3 normal mode.
- 6 Press the **ENTER** (↵) button to confirm.

- ◆ You can select these options by simply pressing the **P.SIZE** button on the remote control.
- ◆ The picture size can not be changed in the PIP mode.
- ◆ Depending on the input source, the **P.SIZE** options may vary.

### Positioning and Sizing the screen using Zoom

- ◆ Resizing the screen using the **Zoom** enables the positioning and sizing of the screen to up/down direction using the ▼ or ▲ button as well as the screen size.
- ◆ Move the screen up/down using the ▼ or ▲ button after selecting the  by pressing the ▼ or ▲ button.
- ◆ Resize the screen vertically using the ▼ or ▲ button after selecting the  by pressing the ▼ or ▲ button.
- ◆ Screen enlargement operates only in TV/Video/S-Video/Component input modes.
- ◆ DVI mode prevents the screen enlargement function.

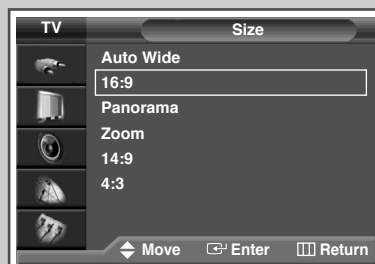
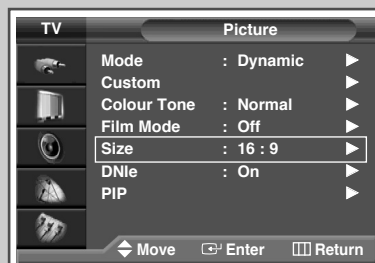

### DVI Mode

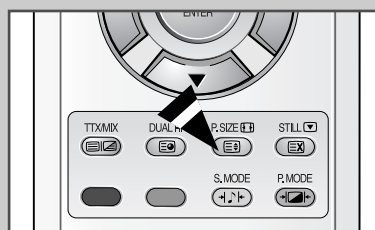

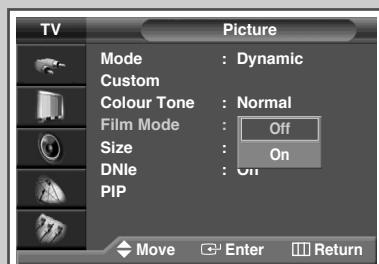
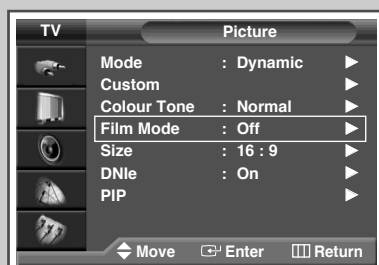

## Selecting the Film Mode

ENG



*You can automatically sense and process film signals from some sources and adjust the picture for optimum quality.*



- 1 Press the **MENU** button.  
Result: The main menu is displayed.
- 2 Press the **▼** or **▲** button to select **Picture**.  
Result: The options available in the **Picture** group are displayed.
- 3 Press the **ENTER** () button.
- 4 Press the **▼** or **▲** button to select **Film Mode**. Press the **ENTER** () button.
- 5 Press the **▼** or **▲** button to change the setting. (**Off** or **On**).
  - ◆ **On** : Automatically senses and processes film signals from some sources and adjusts the picture for optimum quality.
  - ◆ **Off** : Switches off the **Film Mode**.

- ◆ Not available in the DVI or Component (480p, 576p, 720p, 1080i) mode.
- ◆ Mode discrepancies, such as turning off Film Mode while viewing a film source or turning on Film Mode while viewing non-film sources, may affect the picture quality.

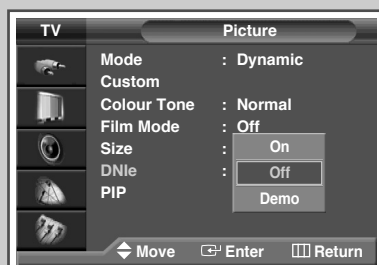
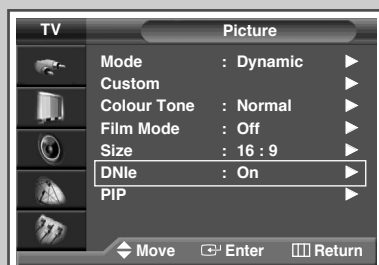
## DNle™ (Digital Natural Image engine)



*This feature bring you more detailed image with 3D noise reduction, detail enhancement, contrast enhancement and white enhancement. New image compensation Algorithm gives brighter, clearer, much detailed image to you.*

- 1 Press the **MENU** button.  
Result: The main menu is displayed.
- 2 Press the **▼** or **▲** button until the **Picture** is selected.  
Result: The options available in the **Picture** group are displayed.
- 3 Press the **ENTER** () button.
- 4 Press the **▼** or **▲** button until the **DNle** is selected. Press the **ENTER** () button.
- 5 Press the **▼** or **▲** button to change the setting.
  - ◆ **On**: Switches on the DNle mode.
  - ◆ **Off**: Switches off the DNle mode.
  - ◆ **Demo** (Option): The screen before applying DNle appears on the right and the screen after applying DNle appears on the left.



## Setting the Blue Screen

*If no signal is being received or the signal is very weak, a blue screen automatically replaces the noisy picture background. If you wish to continue viewing the poor picture, you must set the "Blue Screen" mode to "Off".*

- 1 Press the **MENU** button.  
Result: The main menu is displayed.
- 2 Press the **▼** or **▲** button to select **Setup**.  
Result: The options available in the **Setup** group are displayed.
- 3 Press the **ENTER** (**↵**) button.
- 4 Press the **▼** or **▲** button to select **Miscellaneous**. Press the **ENTER** (**↵**) button.  
Result: The options available in the **Miscellaneous** group are displayed.
- 5 Press the **▼** or **▲** button to select **Blue Screen**. Press the **ENTER** (**↵**) button.
- 6 Press the **▼** or **▲** button to change the setting. (**On** or **Off**).

➤ ◆ **Blue Screen** is displayed while no signal from the external device in the External Mode, regardless of the Blue Screen Setting.

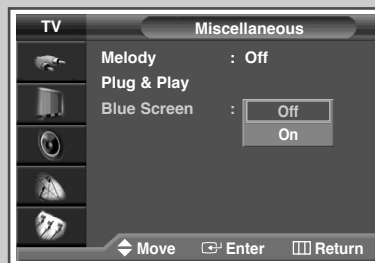
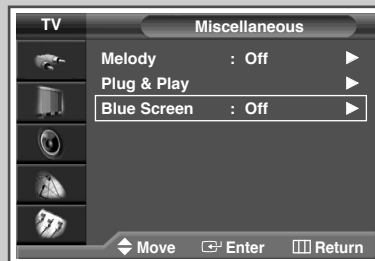

## Setting the Melody Sound

*A melody sounds when the television is powered on or off.*

- 1 Press the **MENU** button.  
Result: The main menu is displayed.
- 2 Press the **▼** or **▲** button to select **Setup**.  
Result: The options available in the **Setup** group are displayed.
- 3 Press the **ENTER** (**↵**) button.
- 4 Press the **▼** or **▲** button to select **Miscellaneous**. Press the **ENTER** (**↵**) button.  
Result: The options available in the **Miscellaneous** group are displayed.
- 5 Press the **▼** or **▲** button to select **Melody**. Press the **ENTER** (**↵**) button.
- 6 Press the **▼** or **▲** button to change the setting. (**On** or **Off**).

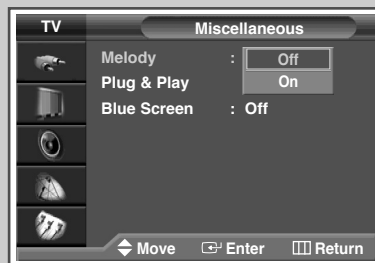
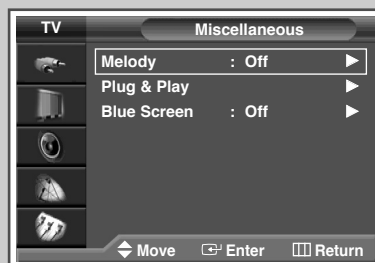





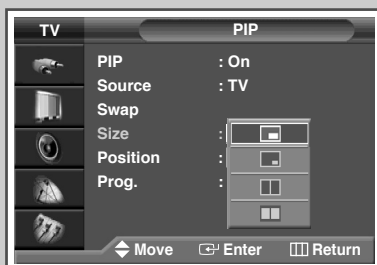
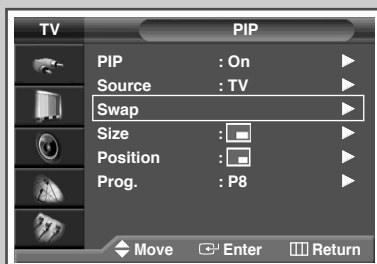
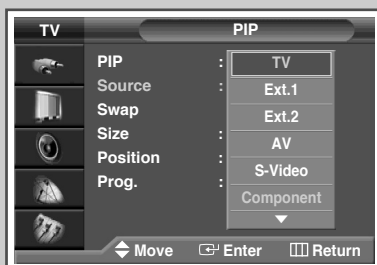
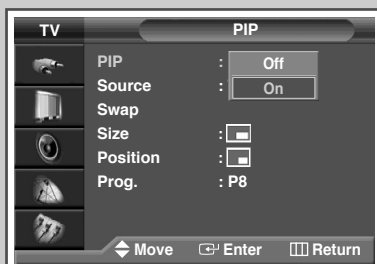
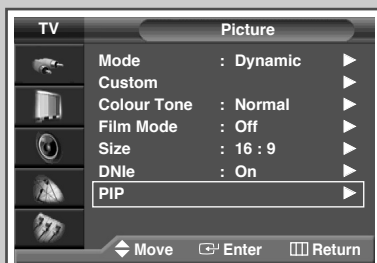



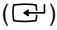

# Viewing the Picture In Picture (PIP)

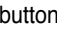
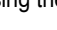
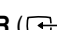
ENG

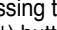

*You can display a sub picture within the main picture of TV program or external A/V devices.*

- 1 Press the **MENU** button.  
Result: The main menu is displayed.
- 2 Press the **▼** or **▲** button to select **Picture**.  
Result: The options available in the **Picture** group are displayed.
- 3 Press the **ENTER** () button.
- 4 Press the **▼** or **▲** button to select **PIP**. Press the **ENTER** () button.  
Result: The options available in the **PIP** group are displayed.
- 5 Press the **ENTER** () button, set the **PIP** to **on** by pressing the **▼** or **▲** button. Press the **ENTER** () button.
- 6 Press the **▼** or **▲** button to select **Source** and press the **ENTER** () button. Select a source of the sub picture by pressing the **ENTER** () button.  
Result: The sources are displayed in the following order:  
**TV - Ext.1 - Ext.2 - AV - S-Video - Component - DVI**
- 7 Press the **▼** or **▲** button to select **Swap**. Press the **ENTER** () button.  
Result: The main picture and sub picture are interchanged.
- 8 Press the **▼** or **▲** button to select **Size**. Select a size of the sub picture by pressing the **ENTER** () button.  
Result: The sizes are displayed in the following order:  
     
(Large) - (Small) - (Double1) - (Double2)  
➤ Select a size of the sub picture by pressing the **▼** or **▲** button. Press the **ENTER** () button.

## Table of PIP Settings

X - This PIP combination is not available.  
O - This PIP combination is available.

	TV	Video	S-VHS	Comp576i	Comp480p~	DVI
TV	X	X	X	X	O	O
Video	X	X	X	X	O	O
S-VHS	X	X	X	X	O	O
Comp576i	X	X	X	X	X	X
Comp480p~	O	O	O	X	X	X
DVI	O	O	O	X	X	X

## Viewing the Picture In Picture (PIP) (continued)

ENG

- 9 Press the ▼ or ▲ button to select **Position**. Press the **ENTER** (↵) button.

**Result:** The positions available are displayed.

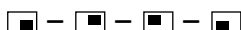

- Select a position of the sub picture by pressing the ▼ or ▲ button. Press the **ENTER** (↵) button.

- 10 Press the ▼ or ▲ button to select **Prog.**. Select the channel that you want to view through sub picture by pressing the **ENTER** (↵) button.

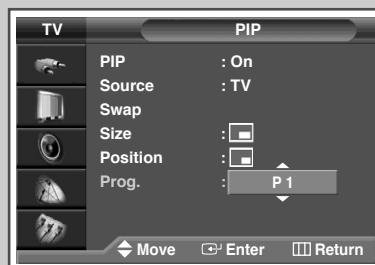
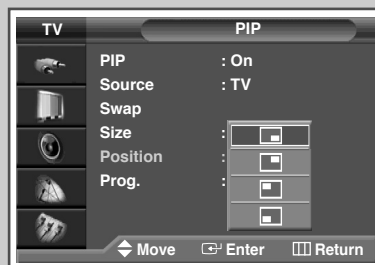

- If the sub picture is no signal and the main picture is output from a Component or DVI signal, the sub picture will be blue. If the main picture is output from a Video signal, the sub picture will be black.



## Using the Digital NR (Digital Noise Reduction) Feature

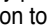

*If the signal received by your television is weak, you can activate this feature to help reduce any static and ghosting that may appear on the screen.*

- 1 Press the **MENU** button.  
Result: The main menu is displayed.
- 2 Press the **▼** or **▲** button until the **Setup** is selected.  
Result: The options available in the **Setup** group are displayed.
- 3 Press the **ENTER** () button.
- 4 Press the **▼** or **▲** button until the **Digital NR** is selected.  
Press the **ENTER** () button.
- 5 Select **off** or **on** by pressing the **▼** or **▲** button. Press the **ENTER** () button to confirm.

## Using the LNA (Low Noise Amplifier) Feature



*This function is very useful in the situation that the TV is used in weak signal. LNA amplifies the TV signal in the weak signal area, but not noise.*

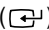
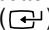
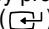

- 1 Press the **MENU** button.  
Result: The main menu is displayed.
- 2 Press the **▼** or **▲** button to select **Channel**.  
Result: The options available in the **Channel** group are displayed.
- 3 Press the **ENTER** () button.
- 4 Press the **▼** or **▲** button to select **Edit**.  
Press the **ENTER** () button.  
Result: The **Edit** menu is displayed.
- 5 Press the **▼** or **▲** button to select **LNA**.  
Press the **ENTER** () button.  
Result: The options available are listed.
- 6 Select **on** or **off** by pressing the **▼** or **▲** button.  
Press the **ENTER** () button to confirm.



- ◆ If the picture is noisy with the **LNA** set to **On**, select **Off**.
- ◆ **LNA** setting is to be made for each channel.
- ◆ Depending on areas, factory mode of **LNA** will be set up as **On** or **Off**.

## Changing the Sound Standard

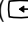
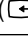
*You can select the type of special sound effect to be used when watching a given broadcast.*

- 1 Press the **MENU** button.  
Result: The main menu is displayed.
- 2 Press the **▼** or **▲** button to select **Sound**.  
Result: The options available in the **Sound** group are displayed.
- 3 Press the **ENTER** (  ) button.  
Result: The **Mode** is selected.
- 4 Press the **ENTER** (  ) button again.
- 5 Select the option by pressing the **▼** or **▲** button. The sound effects are displayed in the following order.  
**Standard - Music - Movie - Speech - Custom.**
- 6 Press the **ENTER** (  ) button to confirm.

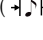
➤ You can also set these options simply by pressing the **S.MODE** (  : Sound Mode) button.

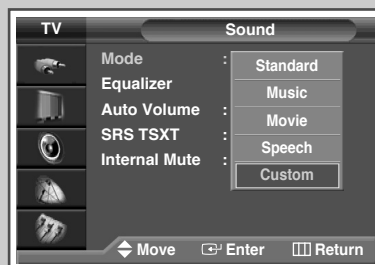
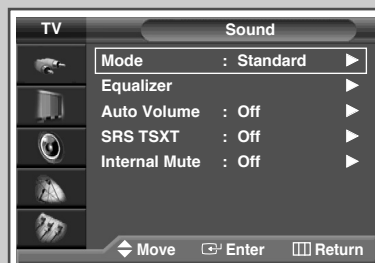

## Adjusting the Sound Settings

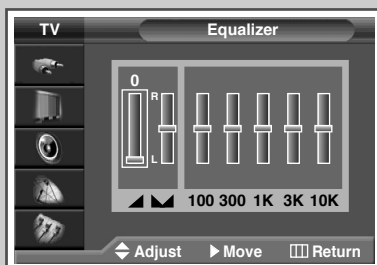
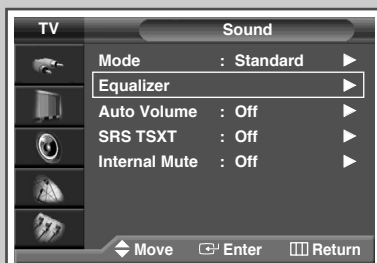

*The sound settings can be adjusted to suit your personal preferences.*

- 1 Press the **MENU** button.  
Result: The main menu is displayed.
- 2 Press the ▼ or ▲ button to select **Sound**.  
Result: The options available in the **Sound** group are displayed.
- 3 Press the **ENTER** (⏏) button.
- 4 Press the ▼ or ▲ button to select **Equalizer**. Press the **ENTER** (⏏) button.  
Result: The **Equalizer** menu is displayed with the current option.
- 5 Select the option (volume, balance, equalizer) to be adjusted by pressing the ◀ or ▶ button. Press the ▼ or ▲ button to reach the required setting.
- 6 When you are satisfied with the settings, press the **MENU** (⏏) button to store them.

➤ If you make any changes to the equalizer settings, the sound standard is automatically switched to the **Custom**.

## Adjusting the Volume Automatically

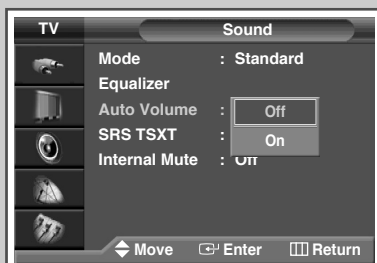
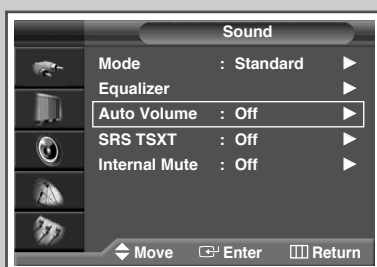

*Each broadcasting station has its own signal conditions, and so it is not easy for you to adjust the volume every time the channel is changed. This feature lets you automatically adjust the volume of the desired channel by lowering the sound output when the modulation signal is high or by raising the sound output when the modulation signal is low.*

- 1 Press the **MENU** button.  
Result: The main menu is displayed.
- 2 Press the ▼ or ▲ button to select **Sound**.  
Result: The options available in the **Sound** group are displayed.
- 3 Press the **ENTER** (⏏) button.
- 4 Press the ▼ or ▲ button to select **Auto Volume**. Press the **ENTER** (⏏) button.
- 5 Select the option (**Off** or **On**) by pressing the ▼ or ▲ button.

## Setting the TruSurround XT

*TruSurround XT is a patented SRS technology that solves the problem of playing 5.1 multichannel content over two speakers. Trusurround delivers a compelling, virtual surround sound experience through any two-speaker playback system, including internal television speakers. It is fully compatible with all multichannel formats.*

- 1 Press the **MENU** button.  
Result: The main menu is displayed.
- 2 Press the **▼** or **▲** button until the **Sound** is selected.  
Result: The options available in the **Sound** group are displayed.
- 3 Press the **ENTER** (**↵**) button.
- 4 Press the **▼** or **▲** button until the **SRS TSXT** is selected. Press the **ENTER** (**↵**) button.
- 5 Press the **▼** or **▲** button to change the setting. (**Off**, **3D Mono** or **Stereo**).

➤ TruSurround XT, SRS and (●●) Symbol are trademarks of SRS Labs, Inc. TruSurround XT technology is incorporated under license from SRS Labs, Inc.

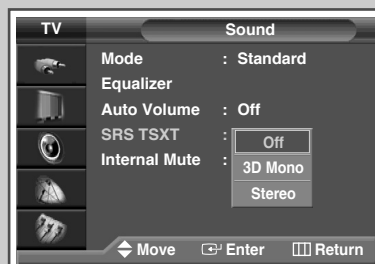
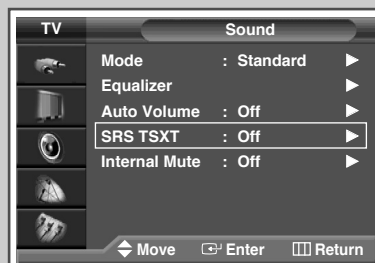

## Selecting the Internal Mute

*If you want to hear the sound through separate speakers, cancel the internal amplifier.*

- 1 Press the **MENU** button.  
Result: The main menu is displayed.
- 2 Press the **▼** or **▲** button to select **Sound**.  
Result: The options available in the **Sound** group are displayed.
- 3 Press the **ENTER** (**↵**) button.
- 4 Press the **▼** or **▲** button to select **Internal Mute**. Press the **ENTER** (**↵**) button.
- 5 Press the **▼** or **▲** button to change the setting. (**On** or **Off**).

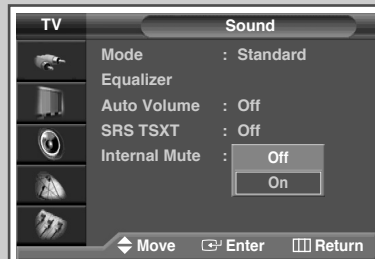
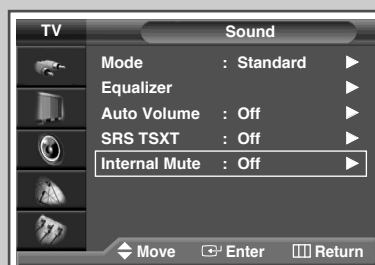

## Selecting the Sound Mode (depending on the model)

ENG

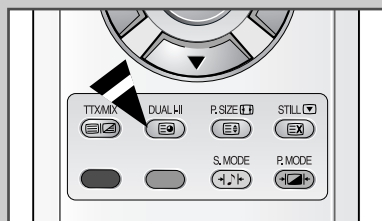

The “DUAL I-II” button displays/controls the processing and output of the audio signal. When power is switched on, the mode is automatically preset to either “Dual-I ” or “Stereo”, depending on the current transmission.

	Type of broadcast	On-screen indication
<b>NICAM Stereo</b>	Regular broadcast (Standard audio)	<b>Mono</b> (Normal use)
	Regular + NICAM Mono	<b>NICAM Mono ↔ Mono</b>
	NICAM Stereo	<b>NICAM Stereo ↔ Mono</b> (Forced mono)
	NICAM Dual-I/II	<b>NICAM Dual-I →</b> <b>NICAM Dual-II →</b> <b>Mono</b>
<b>A2 Stereo</b>	Regular broadcast (Standard audio)	<b>Mono</b>
	Bilingual or Dual-I/II	<b>Dual-I ↔ Dual-II</b>
	Stereo	<b>Stereo ↔ Mono</b> (Forced mono)

- ◆ If the receiving conditions deteriorate, listening will be easier if the mode is set to the **Mono**.
- ◆ If the stereo signal is weak and an automatic switching occurs, then switch to the **Mono**.
- ◆ When receiving a mono sound in the AV mode, connect to the “AUDIO-L” input connector on the side of the television. If the mono sound comes out only from left speaker, press the **Dual I-II** button.



## Setting the Sleep Timer

*You can select a time period of between 30 and 180 minutes after which the television automatically switches to Standby mode.*

- 1 Press the **MENU** button.  
Result: The main menu is displayed.
- 2 Press the ▼ or ▲ button to select **Setup**.  
Result: The options available in the **Setup** group are displayed.
- 3 Press the **ENTER** (↵) button.
- 4 Press the ▼ or ▲ button to select **Time**. Press the **ENTER** (↵) button.  
Result: The options available in the **Time** group are displayed.
- 5 Press the ▼ or ▲ button to select **Sleep Timer**. Press the **ENTER** (↵) button.  
Result: The **Sleep Timer** menu is displayed with the **Min** is selected.
- 6 Select the preset time intervals (**Off**, **30**, **60**, **90**, **120**, **150**, **180**) by pressing the ▼ or ▲ button.  
Press the ◀ or ▶ button to move to the **Activation**.
- 7 When you are satisfied with the settings, select **Activation** to **Yes** or **No** by pressing the ▼ or ▲ button.
- 8 Press the **ENTER** (↵) button to confirm your selection.

- ♦ You can also set these options simply by pressing the **SLEEP** ⏻ button.
- ♦ If the sleep timer is not yet set, **off** is displayed.  
If the sleep timer is already set, the remaining time before which the television switches to Standby mode is displayed.

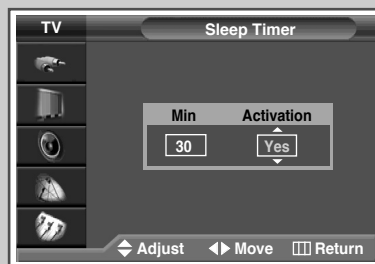
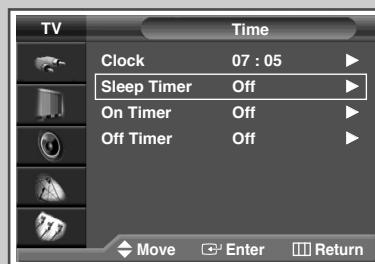



## Setting and Displaying the Current Time

*You can set the television's clock so that the current time is displayed by pressing the "INFO (  )" button. You must also set the time if you wish to use the automatic on or off timers.*

➤ When pressing the "I /  " button (On/Off) on the front of the television, the clock setting will be reset.

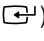
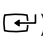

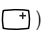
- 1 Press the **MENU** button.  
Result: The main menu is displayed.
- 2 Press the ▼ or ▲ button to select **Setup**.  
Result: The options available in the **Setup** group are displayed.
- 3 Press the **ENTER** (  ) button.
- 4 Press the ▼ or ▲ button to select **Time**. Press the **ENTER** (  ) button.  
Result: The options available in the **Time** group are displayed with **Clock** is selected.
- 5 Press the **ENTER** (  ) button.
- 6 Press the ◀ or ▶ button to move to the hour or minute. Set the hour or minute by pressing the ▼ or ▲ button.
- 7 When you have finished, press the **EXIT** (  ) button to exit.
- 8 Press the **INFO** (  ) button to display the current time.

# Switching the Television On and Off Automatically

ENG

You can set the television's clock and set the On or Off timers so that the television will:

- ◆ Switch on automatically and tune to the channel of your choice at the time you select
- ◆ Switch off automatically at the time you select

➤ The first step is to set the television's clock (refer to "Setting and Displaying the Current Time" on the previous page).

- 1 Press the **MENU** button.  
Result: The main menu is displayed.
- 2 Press the ▼ or ▲ button to select **Setup**.  
Result: The options available in the **Setup** group are displayed.
- 3 Press the **ENTER** (↵) button.
- 4 Press the ▼ or ▲ button to select **Time**. Press the **ENTER** (↵) button.  
Result: The options available in the **Time** group are displayed.
- 5 Press the ▼ or ▲ button to select **On Timer**. Press the **ENTER** (↵) button.  
Result: The options available in the **On Timer** group are displayed.
- 6 Select the **Hour**, **Min**, **Prog.**, **Volume** by pressing the ◀ or ▶ button.  
Set these by pressing the ▼ or ▲ button.
- 7 When you are satisfied with the settings, select **Activation** to **Yes** or **No** by pressing the ▼ or ▲ button.
- 8 Press the **MENU** button.  
Result: The options available in the **Time** group are displayed again.
- 9 Press the ▼ or ▲ button to select **Off Timer**. Press the **ENTER** (↵) button.  
Result: The **Off Timer** menu is displayed.
- 10 Select the **Hour**, **Min** or **Activation** by pressing the ◀ or ▶ button.  
Set these by pressing the ▼ or ▲ button.

## ➤ Absent Power Off

When you set the timer "On", your television will eventually be turned off, if you do not operate any controls during the 3 hours after the TV is turned on by timer. This function is available in only the timer "On" mode and will prevent a leakage accident or overheating, caused by your TV left on for a long time due to the timer "On" (when you are away on holiday, for example).

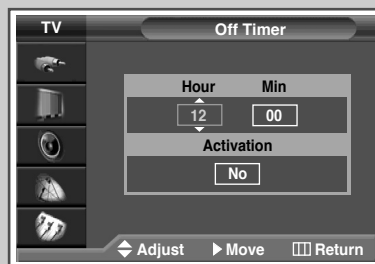
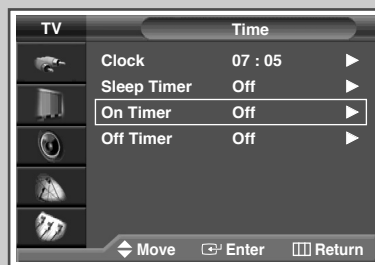









# Viewing an External Signal Source

ENG



*Use the remote control to switch between viewing signal from connected equipment, such as VCR, DVD, Set-Top-boxes and the TV source (broadcast or cable)*

- 1 Press the **MENU** button.  
Result: The main menu is displayed.
- 2 Press the **▼** or **▲** button to select **Input** .  
Result: The options available in the **Input** group are displayed.
- 3 Press the **ENTER** () button.
- 4 Press the **▼** or **▲** button to select **Source List**. Press the **ENTER** () button.  
Result: The options available in the **Source List** group are displayed.
- 5 Press the **▼** or **▲** button to select signal source, then press the **ENTER** () button.  
➤ When you connect equipment to the TV, you can choose between the following sets of jacks : **Ext.1**, **Ext.2**, **AV**, **S-Video**, **Component** or **DVI** on the TV's rear panel.
- 6 Press the **MENU** button again, press the **ENTER** () button to select **Input**.
- 7 Press the **▼** or **▲** button to select **Edit Name** . Press the **ENTER** () button.  
Result: The options available in the **Edit Name** group are displayed.
- 8 Press the **▼** or **▲** button to select external device :  
**Ext.1 - Ext.2 - AV - S-Video - Component - DVI**
- 9 Press the **ENTER** () button.  
Result: The **Edit Name** available are listed.
- 10 Select the name by pressing the **▼** or **▲** button. Press the **ENTER** () button.
- 11 Set other signal sources (**VCR**, **DVD**, **Cable STB**, **HD STB**, **Satellite STB**, **AV Receiver**, **DVD Receiver**, **Game**, **Camcorder**, **DVD Combo** or **DHR**) using the same method as listed above.

- You can also set these options simply by pressing the **TV/VIDEO** () button. If you change the external source while viewing, pictures might take a short period of time to be switched.
- **DHR** : DVD HDD Recorder

## Redirecting an Input to the External Output

*Your television enables you to choose which audio/video signals are output to the external connector.*

- 1 Press the **MENU** button.  
Result: The main menu is displayed.
- 2 Press the ▼ or ▲ button to select **Setup**.  
Result: The options available in the **Setup** group are displayed.
- 3 Press the **ENTER** (↵) button.
- 4 Press the ▼ or ▲ button to select **AV Setup**. Press the **ENTER** (↵) button.  
Result: The **AV Setup** menu is displayed.
- 5 Press the ▼ or ▲ button to select required input (**Ext.2**), then press the **ENTER** (↵) button. Select the source to be directed to the output by pressing the ▼ or ▲ button.
- 6 Press the **ENTER** (↵) button to confirm the change.

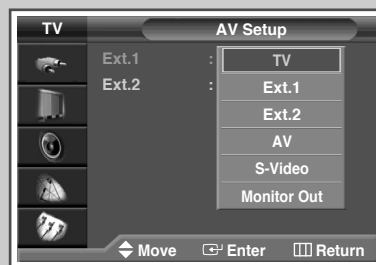
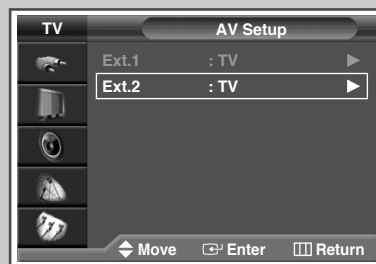

## Teletext Feature

ENG

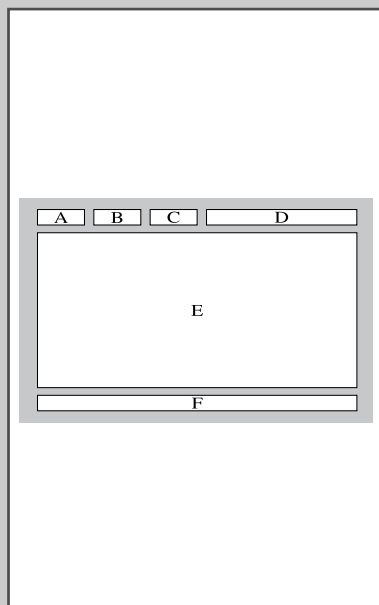

*Most television channels provide written information services via teletext. Information provided includes:*

- ◆ *Television programme times*
- ◆ *News bulletins and weather forecasts*
- ◆ *Sports results*
- ◆ *Travel information*

*This information is divided into numbered pages (see diagram).*

Part	Contents
A	Selected page number.
B	Broadcasting channel identity.
C	Current page number or search indications.
D	Date and time.
E	Text.
F	Status information. FASTEXT information.





➤ Teletext information is often divided between several pages displayed in sequence, which can be accessed by:

- ◆ Entering the page number
- ◆ Selecting a title in a list
- ◆ Selecting a coloured heading (FASTEXT system)

## Displaying the Teletext Information

*You can display Teletext information at any time on your television*

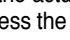
- ☞ For Teletext information to be displayed correctly, channel reception must be stable; otherwise:
- ◆ Information may be missing
  - ◆ Some pages may not be displayed

- 1 Select the channel providing the Teletext service by pressing the **P** or **□** button.
- 2 Press the **TTX/MIX** (  ) button to activate the teletext mode.  
Result: The contents page is displayed. It can be redisplayed at any time by pressing the **□** (index) button.
- 3 Press the **TTX/MIX** (  ) button again.  
Result: The screen will be split into two. This Double Teletext feature lets you view the actual broadcast and teletext information separately on the screen.
- 4 If you wish to display the actual broadcast and teletext information on a single screen, press the **TTX/MIX** (  ) button again.
- 5 To exit from the teletext display, press the **EXIT** (  ) button.

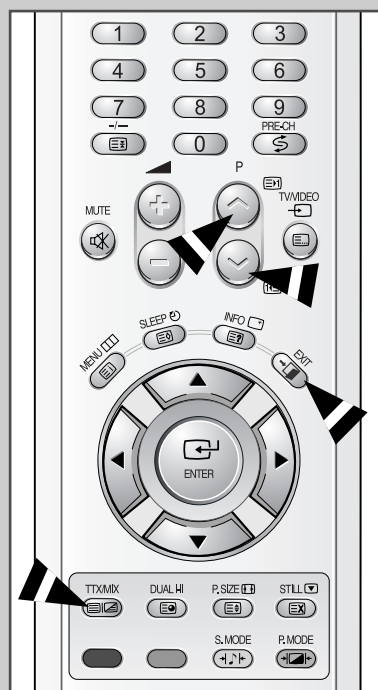

## Selecting Display Options

ENG

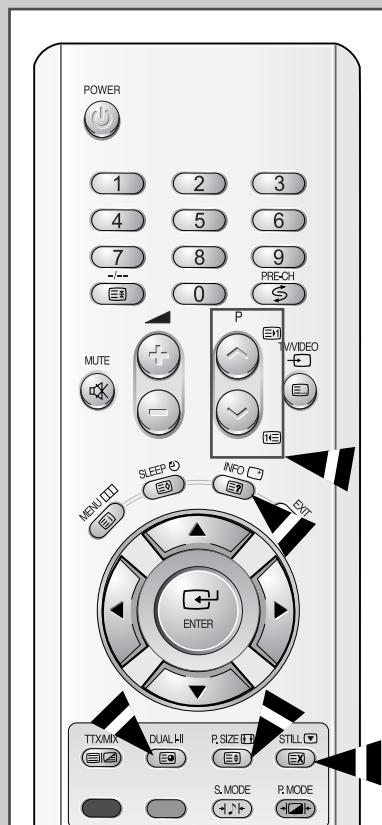







*When you have displayed a Teletext page, you can select various options to suit your requirements.*

To display...	Press the...
◆ Hidden text (answers to quiz games, for example)	[REVEAL] (reveal)
◆ The normal screen	[REVEAL] (reveal) again
◆ A secondary page by entering its number	[SUB-PAGE] (sub-page)
◆ The broadcast when searching for a page	[CANCEL] (cancel)
◆ The next page	[PAGE UP] (page up)
◆ The previous page	[PAGE DOWN] (page down)
◆ Double-size letters in the: <ul style="list-style-type: none"> <li>• Upper half of the screen</li> <li>• Lower half of the screen</li> </ul>	[SIZE] (size) <ul style="list-style-type: none"> <li>• Once</li> <li>• Twice</li> </ul>
◆ The normal screen	• Three times



## Selecting a Teletext Page

*You can enter the page number directly by pressing the numeric buttons on the remote control.*

- 1 Enter the three-digit page number given in the content by pressing the corresponding numeric buttons.  
Result: The current page counter is incremented and the page is then displayed. If the selected page is linked with several secondary pages, the secondary pages are displayed in sequence. To freeze the display on a given page, press the  (hold). Press it again to resume.
- 2 If the FASTEXT system is used by the broadcasting company, the different topics covered on a Teletext page are colour-coded and can be selected by pressing the coloured buttons on the remote control. Press the coloured button corresponding to the topic that you wish to select; the available topics are given on the status line.  
Result: The page is displayed with other coloured information that can be selected in the same way.
- 3 To display the previous or next page, press the corresponding  or  button.
- 4 To display the subpage, see the following steps.
  - ◆ Press the  (sub-page) button.  
Result: The available subpages appear.
  - ◆ Select the required sub-page. Sub-pages can be scrolled by pressing the  or  button.
- 5 When you have finished, press the **EXIT** () button to return to your normal broadcast.

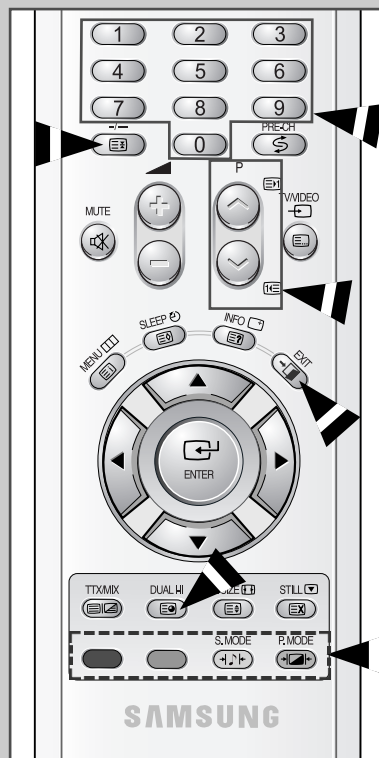

# Connecting to the External Devices

ENG

“MONITOR OUT” are used for the equipment with an RGB output, such as video game devices or video disc players.

## Rear of the TV

(Input/Output)

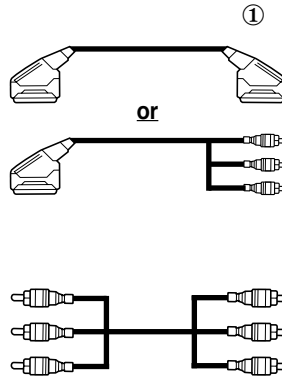
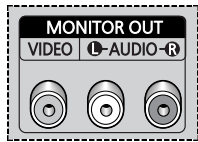
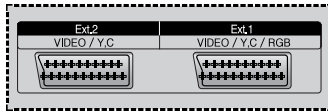

- ① This end can be fitted with:
- ◆ A SCART connector
  - ◆ Three RCA connectors (VIDEO + AUDIO-L/R)

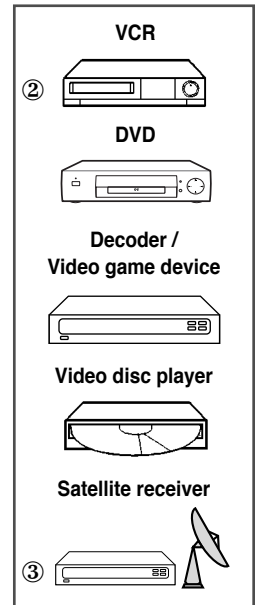

## Input/Output Specification

Connector	Input				Output
	Video	Audio (L/R)	S-Video	RGB	Video + Audio (L/R)
Ext.1	✓	✓	✓	✓	Only TV output is available.
Ext.2	✓	✓	✓		Output you can choose.

## Rear of the TV

(Input/Output)

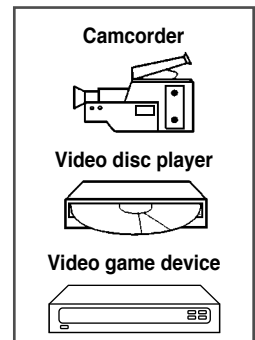
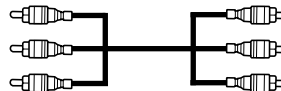
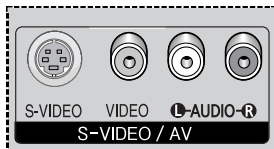

## Connecting to the S-Video Input

ENG

The S-VIDEO and RCA (AUDIO-L/R) connectors are used for equipment with an S-Video output, such as a camcorder or VCR.

### *Rear of the TV*

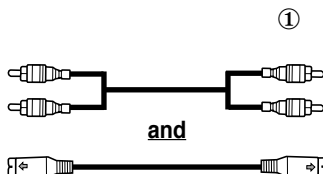

Camcorder

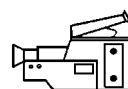

VCR

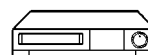

- ① To play picture and sound, both the S-VIDEO and RCA connectors must be used.



Whenever you connect an audio or video system to your television, ensure that all elements are switched off. Refer to the documentation supplied with your equipment for detailed connection instructions and associated safety precautions.

## Connecting to the DVI Input

ENG

The “DVI” (video) and “L-AUDIO-R” connectors are used for equipment with a DVI output.  
(Not Compatible with PC)

### *Rear of the TV*

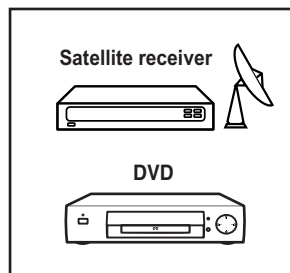
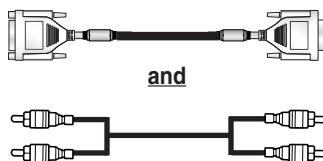
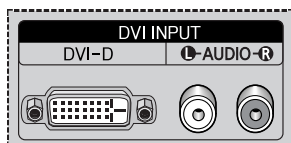

## Connecting to the Component Input

ENG

### *Rear of the TV*

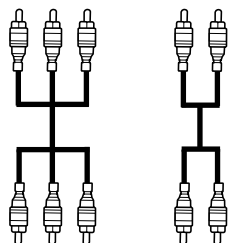
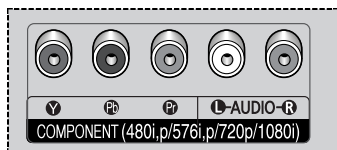

DVD



or

DTV receiver

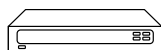

- ① The “**COMPONENT**” connectors are used for DTV receiver or DVD. (480i,p/576i,p/720p/1080i)

## Connecting and Using the Home Theater System

Use the Monitor Out ports of the PDP for Home Theater System Connections.

### *Rear of the TV*

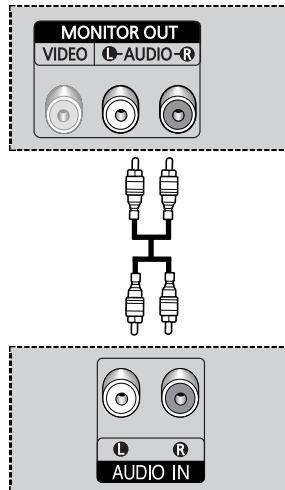

### Connecting the Home Theater System

- ① Connect the monitoring audio out L, and R jacks of the MONITOR OUT on the rear-side connection panel of the PDP TV to the AUDIO IN jacks of the DVD Home Theater System (or AV Receiver) using the audio cable.
- ② Press the **TV/VIDEO** button to select the desired external device connected to the PDP TV.
- ③ If you want to hear the sound through separate speakers, cancel the internal amplifier.

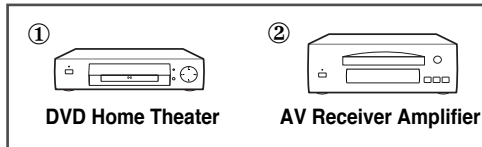

- ◆ Refer to corresponding user's manual from the manufacturer for wiring the speakers to the DVD Home Theater System (or AV Receiver).
- ◆ Disable the PDP TV internal speaker to enjoy the rich sound through the speakers of your Home Theater System.
- ◆ In this case, enjoy the sound from the Home Theater System while the PDP TV does not produce the audio.

### To Display the DVD Home Theater

- ① Turn the PDP on and press the **TV/VIDEO** button to select the **Ext.1** (or **Ext.2**).
- ② Be sure to connect the video cable properly if desired external input (**Ext.1** or **Ext.2**) cannot be selected.
- ③ Play the DVD after activating the DVD Home Theater System.
- ④ Use the volume control of the Home Theater System while watching the PDP using the DVD Home Theater, where the PDP TV does not produce the audio.

## SCART Connector (Ext.1, Ext.2)

- Pins 5, 7, 9, 11, 13, 15 and 16 are used for RGB processing and are only wired on the **Ext.1** connector.

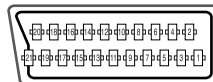

Pin	Signal	Pin	Signal
1	Audio output R	12	-
2	Audio input R	13	Video chassis return (RGB red)
3	Audio output L	14	-
4	Audio chassis return	15	RGB red (EXT1) or chroma input
5	Video chassis return (RGB blue)	16	Blanking signal (RGB switching)
6	Audio input L	17	Video chassis return
7	RGB blue input (EXT1)	18	Blanking signal ground
8	Switching voltage	19	Video output
9	Video chassis return (RGB green)	20	Video or Luminance input
10	AV-Link (EXT1)	21	Screening/chassis return
11	RGB green input (EXT1)		

## DVI Input Connector (24Pin)



Pin	Signal
1	T.M.D.S. Data2-
2	T.M.D.S. Data2+
3	T.M.D.S. Data2/4 Shield
4	T.M.D.S. Data4-
5	T.M.D.S. Data4+
6	Clock (DDC)
7	Data (DDC)
8	Not Connected
9	T.M.D.S. Data1-
10	T.M.D.S. Data1+
11	T.M.D.S. Data1/3 Shield
12	T.M.D.S. Data3-
13	T.M.D.S. Data3+
14	+5V Power
15	5V Grounding
16	Hot Plug Detect
17	T.M.D.S. Data0-
18	T.M.D.S. Data0+
19	T.M.D.S. Data0/5 Shield
20	T.M.D.S. Data5-
21	T.M.D.S. Data5+
22	T.M.D.S. Clock Shield
23	T.M.D.S. Clock+
24	T.M.D.S. Clock-

## Troubleshooting: Before Contacting Service Personnel

ENG

*Before contacting Samsung after-sales service, perform the following simple checks.*

*If you cannot solve the problem using the instructions below, note the model and serial number of the television and contact your local dealer.*

No sound or picture	<ul style="list-style-type: none"><li>◆ Check that the mains lead has been connected to a wall socket.</li><li>◆ Check that you have pressed the "I" button (On/Off) and the <b>POWER</b> (⏻) button.</li><li>◆ Check the picture contrast and brightness settings.</li><li>◆ Check the volume.</li></ul>
Normal picture but no sound	<ul style="list-style-type: none"><li>◆ Check the volume.</li><li>◆ Check whether the volume <b>MUTE</b> (🔇) button on the remote control has been pressed.</li></ul>
No picture or black and white picture	<ul style="list-style-type: none"><li>◆ Adjust the colour settings.</li><li>◆ Check that the broadcast system selected is correct.</li></ul>
Sound and picture interference	<ul style="list-style-type: none"><li>◆ Try to identify the electrical appliance that is affecting the television, then move it further away.</li><li>◆ Plug your television into a different mains socket.</li></ul>
Blurred or snowy picture, distorted sound	<ul style="list-style-type: none"><li>◆ Check the direction, location and connections of your aerial. This interference often occurs due to the use of an indoor aerial.</li></ul>
Remote control malfunctions	<ul style="list-style-type: none"><li>◆ Replace the remote control batteries.</li><li>◆ Clean the upper edge of the remote control (transmission window).</li><li>◆ Check the battery terminals.</li></ul>





---

## **– AFTER SALES SERVICE**

---

- Do not hesitate to contact your retailer or service agent if a change in the performance of your product indicates that a faulty condition may be present.

