

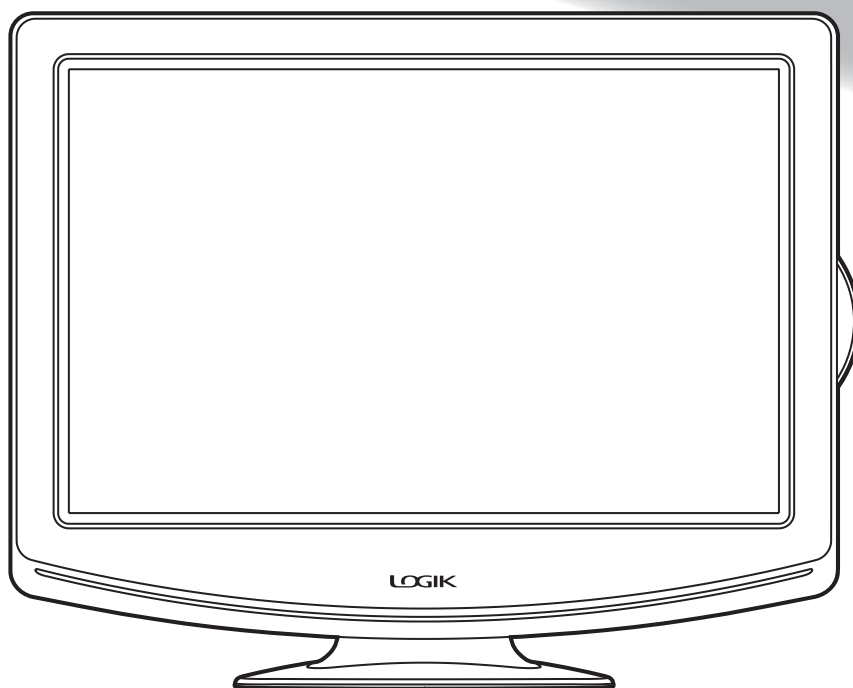



**17" HD Ready Digital LCD TV  
with Integrated DVD Player**



**L17LID648**

# SAFETY PRECAUTIONS

	<b>CAUTION</b> <b>RISK OF ELECTRIC SHOCK</b> <b>DO NOT OPEN</b>	
<p>WARNING: TO REDUCE THE RISK OF ELECTRIC SHOCK, DO NOT REMOVE COVER (OR BACK). NO USER-SERVICEABLE PARTS INSIDE. REFER SERVICING TO QUALIFIED PERSONNEL.</p>		

	<p>The lightning flash with an arrowhead within a triangle alerts you to uninsulated dangerous voltage within the product's enclosure that could cause an electric shock.</p>
	<p>The exclamation point within a triangle alerts you to the presence of important operating, maintenance and servicing instructions in this user's manual.</p>

**WARNING :** TO PREVENT FIRE OR SHOCK HAZARD, DO NOT EXPOSE THIS UNIT TO RAIN OR MOISTURE. DO NOT PLACE OBJECTS FILLED WITH LIQUIDS ON OR NEAR THIS UNIT.

**CAUTION :** DANGER OF EXPLOSION IF BATTERY IS INCORRECTLY REPLACED. REPLACE ONLY WITH THE SAME OR EQUIVALENT TYPE.

<b>CAUTION</b> <b>INVISIBLE LASER RADIATION WHEN OPEN</b> <b>AND INTERLOCKS DEFEATED.</b> <b>AVOID EXPOSURE TO BEAM</b>
--



The symbol for Class II (Double Insulation)



This symbol means that the unit complies with European safety and electrical interference directives.



This product contains a low power laser device.

## PLACEMENT INFORMATION

- Do not use this unit in places which are extremely hot, cold, dusty, or humid.
- Place the unit on a flat and even surface.
- Do not restrict the air flow of this unit by placing it somewhere with poor air flow, by covering it with a cloth, or by placing it on bedding or carpeting.
- Under the environment with radio frequency interference, the picture may be influenced.

## SAFETY INFORMATION

- When connecting or disconnecting the cord, grip the plug and not the AC cord itself. Pulling the cord may damage it and create a hazard.
- When you are not going to use the unit for a long period of time, disconnect the AC cord.
- The mains plug is used as the disconnecting device. It shall remain readily operable and should not be obstructed during intended use. To be completely disconnected from the supply mains, the mains plug of the apparatus should be disconnected from the mains socket outlet completely.
- The apparatus should not be exposed to dripping or splashing and that no objects filled with liquids, such as vases, should be placed on apparatus.
- Leave a minimum of 200mm around the apparatus for ventilation, and 200mm beside the DVD mechanism;
- The ventilation openings should not be impeded by covering with items such as newspaper, table-cloths, curtains etc.
- No naked flame sources such as lighted candles should be placed on the apparatus;
- Attention should be drawn to the environmental aspects of battery disposal;
- The use of apparatus in moderate climates.
- Under the influence of electrostatic phenomenon, the product may malfunction and require user to power reset.

## CONDENSATION INFORMATION

- When the unit is left in a heated room with warm and damp, water droplets may form inside the unit due to condensation, this may cause malfunction of the unit. Let the unit stand for 1-2 hours before turning the power on, or gradually heat the room and let the unit dry before use.

## RATING PLATE LOCATION

- The rating plate is on the back of product.

	<p><b>WARNING:</b> Should any problems occur, disconnect the AC cord and refer servicing to a qualified technician.</p>
---	---

# IMPORTANT SAFETY INSTRUCTIONS

## MAINS PLUG

### UNITS SUPPLIED WITH MOULDED MAINS PLUG

1. If the mains plug fitted to the AC cord supplied is not suitable for your mains outlet it may be necessary to cut it off. Carefully dispose of the severed plug. Under no circumstances must it be inserted into a mains socket, otherwise a dangerous electric shock could result.
2. If the fuse in the fitted mains plug should fail, replace it with a BS1362 approved fuse rated at 3A. Never use the plug without the fuse cover fitted.

### WIRING A MAINS PLUG

As the wires in the mains lead may not correspond with the coloured markings identifying the terminals in your plug proceed as follows:

- The wire which is coloured **blue** must be connected to the **terminal** which is marked with the letter **N** or coloured **black**.
- The wire which is coloured **brown** must be connected to the **terminal** which is marked with the letter **L** or coloured **red**.
- **No connection** is to be made to the **earth terminal** of the plug which is marked with the letter **E** or coloured **green or green and yellow** or marked by the safety  $\perp$  earth symbol.

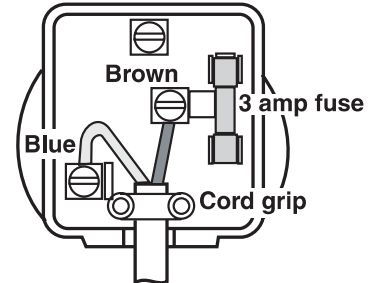

The wires in this mains lead are coloured in accordance with the following code.

**BLUE-NEUTRAL**  
**BROWN-LIVE**

The standard (BS1363) mains plug must be fitted with a 3 Amp fuse approved to BS1362. If any other plug or connection is used a 3 Amp fuse must be fitted in the plug or adaptor or in the distribution board.

### Caution: Moisture Condensation

If the equipment is moved from a cold place to a warm one, water in the air will condense on some parts and may cause damage or malfunction if the equipment is operated.

Allow at least two hours for the equipment to acclimatise before switching it on.

**This unit is designed to operate from a 230V - 240V AC ~ 50Hz mains supply.**

Please note that when the STANDBY/ON switch is in the standby position this does not completely disconnect the unit from the mains supply. If the equipment is not to be used for a day or more, disconnect it at the wall outlet.



This symbol means that the unit is double insulated. No connection to earth is necessary.

## SAFE USE OF YOUR EQUIPMENT

This equipment has been designed and manufactured to meet UK safety standards but like any electrical equipment care must be taken to obtain the best results from the equipment and assure your own safety. Here are a few tips to help you do this:

**READ** this instruction manual before you attempt to use the equipment.

**NEVER** fit makeshift stands or legs with woodscrews. Use only approved supports and fasteners specially designed for the equipment.

**NEVER** let anyone, especially children, push objects into holes, ventilation slots or any other opening; this could result in fatal electric shock!

**ALWAYS** disconnect the AC power cord when you are not going to use the unit for a long period of time.

**ENSURE** adequate ventilation of the equipment is not obstructed, for example by curtains above or soft furnishings underneath it.

**ENSURE** that all electrical connections (including the mains plug, extension leads and interconnections between pieces of equipment) are properly made in accordance with the instructions given. Switch off the main supply when making or changing connections.

**CONSULT** your dealer if you are ever in doubt about the installation, operation or safety of your equipment.

**DON'T** continue to operate the equipment if it is damaged in any way or if it does not function normally.

Withdraw the mains plug and consult your dealer.

**DON'T** leave equipment switched on when it is unattended unless it is part of its normal function to operate in your absence, for example a video cassette recorder with timed recording facility.

**LISTEN** to headphones at moderate volume levels; high volume levels can permanently damage your hearing.

# TABLE OF CONTENTS



<b>PREPARATION</b> .....	<b>2</b>
Safety Precautions .....	2
Important Safety Precautions .....	3
Table of Contents .....	4
Package Contents .....	5
Disc Formats .....	6
Installation .....	7
Getting Started .....	8
LCD TV .....	9 - 10
Remote Control .....	11 - 12
<b>CONNECTIONS</b> .....	<b>13</b>
Connecting a TV Aerial/Cable/Satellite .....	13
Connecting a Power Cord .....	13
Common Interface .....	13
Connecting to devices with a composite (yellow RCA-type) video output .....	14
Connecting to devices with a video input .....	14
Connecting to sources with scart .....	14
Connecting a High Definition (HD) Source (YUV) .....	15
Connecting HDMI .....	16
Using Headphones .....	16
Dobly Digital (For DVD).....	16
<b>USING THE FEATURES</b> .....	<b>17</b>
Basic Operation .....	17
Turning the Unit on for the First Time .....	17
TV / DTV / RADIO Setup .....	18 - 22
TV Setting .....	18 - 19
Electronic Programme Guide (EPG) for DTV .....	19
Audio Language for DTV .....	19
Picture Menu .....	20
Sound Menu .....	20
Time Menu .....	21
Setup Menu .....	21
Lock Menu .....	22
Teletext .....	23
<b>USING THE DVD FEATURES</b> .....	<b>24</b>
Customising the DVD function settings .....	24 - 25
Language setup .....	24
Video setup .....	24
System setup .....	24 - 25
DVD Features .....	26 - 30
<i>CD/DVD operation</i> .....	26 - 27
Playing a disc .....	26
Playing a picture file disc .....	26
Pausing playback (still mode) .....	26
Stopping playback .....	26
Skipping to a different track .....	26
Fast forward/fast reverse .....	27
Slow-motion play (DVD) .....	27
Audio selection (DVD) .....	27
Subtitle selection (DVD) .....	27
Angle Selection (DVD) .....	27
<i>Special Function</i> .....	28
Display function .....	28
Locating a specific title (DVD) .....	28
Locating a specific chapter/track .....	28
Locating a specific time .....	28
<i>Repeat Playback</i> .....	29
Repeating a chapter/title .....	29
Repeating a single track/whole disc .....	29
Repeating a specific section (DVD) (CD) .....	29
<i>DVD Programmable Playback</i> .....	30
Programmable memory .....	30
Title/chapter programmed playback (DVD) .....	30
Maintenance .....	31
<b>TROUBLESHOOTING</b> .....	<b>32 - 33</b>
<b>SPECIFICATIONS</b> .....	<b>34</b>

PREPARATION

CONNECTIONS

USING THE FEATURES

USING THE DVD FEATURES

TROUBLESHOOTING

SPECIFICATION

# PACKAGE CONTENTS

Make sure all of the following contents are included.

- ✓ LCD TV (L17LID648)

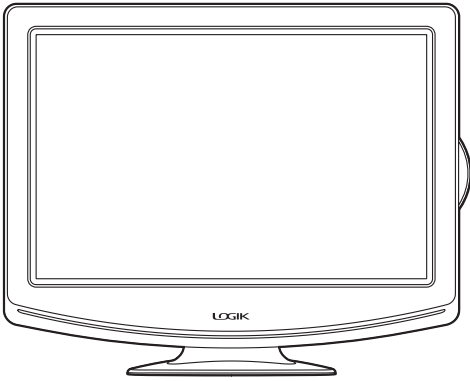

- ✓ Remote Control / AAA batteries x 2 (P/N 043-A55656W170)

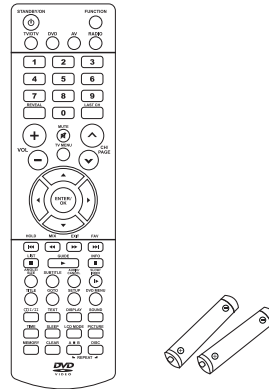

- ✓ LINEOUT cable (P/N 122-000020W102)

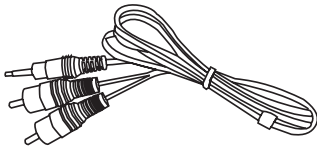

- ✓ YUV SCART adaptor (P/N 138-RGB040W000)

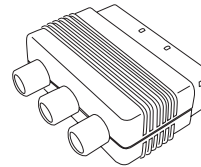

- ✓ User's Manual (P/N 811-711791W040)

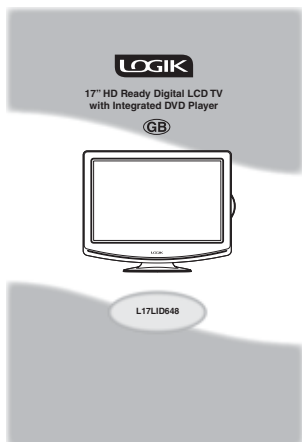

- ✓ Quick Start Guide (P/N 810-711795W040)

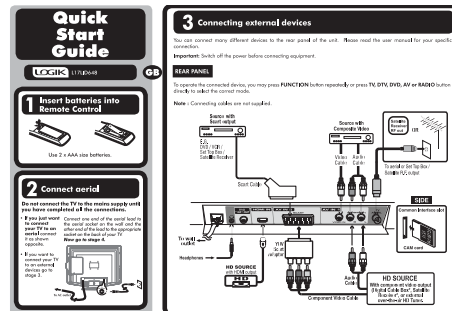

These items are all you need to set up and operate the LCD TV in its basic configuration.



If there are any items missing, please contact Partmaster (UK only).  
Tel: 0870 6001 338

# DISC FORMATS

This unit can playback:



DVDS  
[8CM/12CM  
DISC]



AUDIO CDS  
[8CM/12CM  
DISC]



**CD-R/CD-RW**  
Compatible

## REGION MANAGEMENT INFORMATION

Region Management Information: This unit is designed and manufactured to respond to the Region Management Information that is encoded on DVD discs. If the Region number printed on the DVD disc does not correspond to the Region number of this unit, this unit cannot play that disc.



The region number of this unit is .

## DISC FUNCTION OR OPERATION THAT IS NOT AVAILABLE

When the symbol appears on the screen, it indicates that the function or operation attempted is not available at that time. This occurs because the DVD disc manufacturer determines the specific functions. Certain functions may not be available on some discs. Be sure to read the documentation provided with the DVD.

## ICONS USED ON DVDS

Sample Icons

Note:

- When playing back a CD-G (Graphics) or CD EXTRA disc, the audio portion will be played, but the graphic images will not be shown.

	1. English 2. French	Language selections for audio
	1. English 2. French	Language selections for subtitles
		Screen aspect ratio
		Multiple camera angles
		Region code indicator

## TITLES, CHAPTERS AND TRACKS

- DVDs are divided into “titles” and “chapters”. If the disc has more than one movie on it, each movie would be a separate “title”. “Chapters” are sections of titles.
- Audio CDs are divided into “tracks”. A “track” is usually one song on an Audio CD.

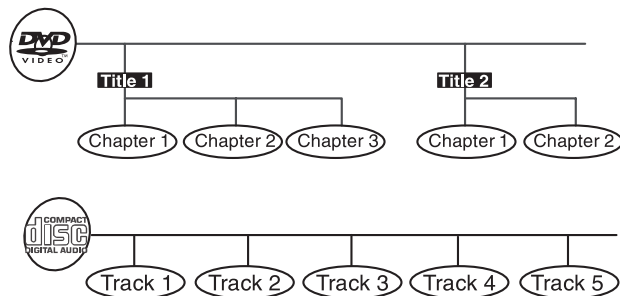

Note:

- Numbers identify each title, chapter, and track on a disc. Most discs have these numbers recorded on them, but some do not.

### Notes on Unauthorized Discs

You may not be able to play back some DVD discs on this unit if they were purchased from outside your geographic area or made for business purposes.

## NOTES ON COPYRIGHT

It is forbidden by law to copy, broadcast, show, broadcast on cable, play in public, or rent copyrighted material without permission.

Apparatus Claims of U.S. Patent Nos. 6,836,549; 6,381,747; 7,050,698; 6,516,132; and 5,583,936 licensed for limited viewing uses only.

This product incorporates copyright protection technology that is protected by U.S. patents and other intellectual property rights. Use of this copyright protection technology must be authorized by Macrovision, and is intended for home and other limited viewing uses only unless otherwise authorized by Macrovision. Reverse engineering or disassembly is prohibited.

## INSTALLING / REMOVING THE BASE STAND

**WARNING:** The LCD Display is very fragile, and must be protected at all times when removing the base stand. Be sure that no hard or sharp object, or anything that could scratch or damage the LCD display, comes into contact with it. Do NOT exert pressure on the front of the unit at any time because the screen could crack.

1. Disconnect all cables or cords connected to the unit.
2. Lay the unit down on a flat surface with the back side facing up. Please make sure to place a soft cushioned material (such as a pillow or thick piece of foam) beneath the screen.

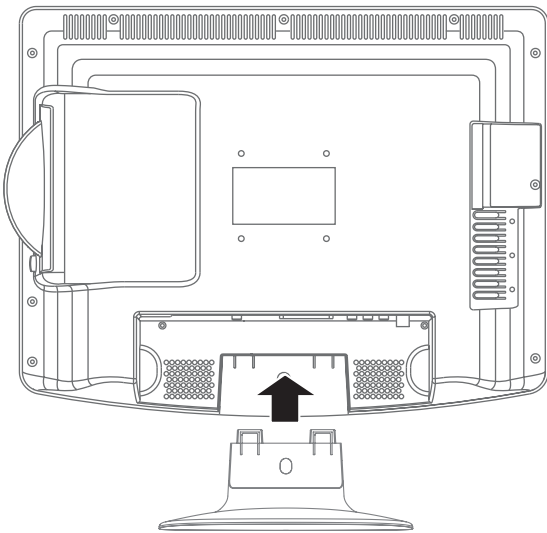

3. To install the base stand, place the base stand on the mounting slot, push the stand till it locks.

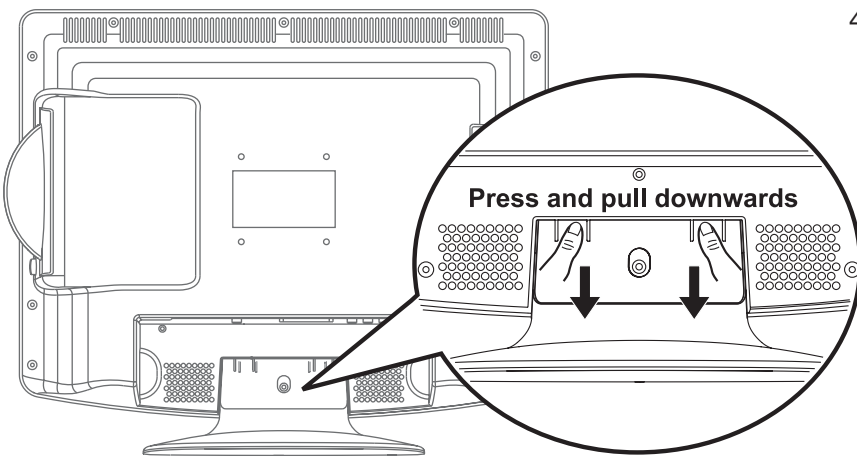

4. To remove the base stand, keep pressing the locking area of the base stand and pull downwards to release the base stand.

## MOUNTING ON THE WALL

This unit is VESA-compliant, and is designed to be wall-mounted with a VESA-compliant 75mm x 75mm mounting kit designed for flat-panel TVs (sold separately). Mount this unit according to the instructions included in the mounting kit.

**Note :**  
Remove the base stand before mounting the unit on the wall.

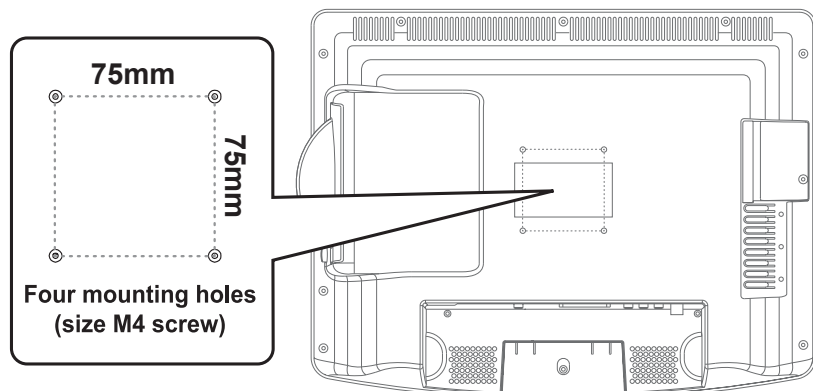

# GETTING STARTED



## USING THE REMOTE CONTROL

- Point the remote control at the REMOTE SENSOR located on the unit.
- When using this unit in a very brightly lit area, the infrared REMOTE CONTROL SENSOR may not work properly.
- The recommended effective distance for using the remote control is about 16 feet (5 metres).

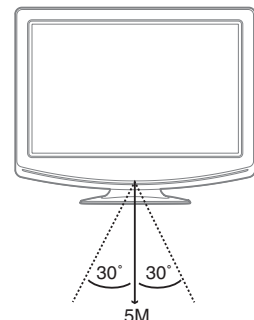

## INSERTING BATTERIES IN THE REMOTE CONTROL

1. Press and lift the back cover up to open the battery compartment of the remote control.
2. Insert two AAA size batteries. Make sure to match the (+) and (-) ends of the batteries with the (+) and (-) ends indicated in the battery compartment. Snap the cover back into place.

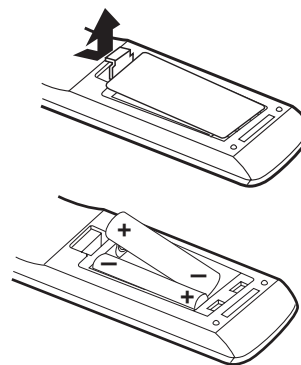

## BATTERY REPLACEMENT

When the batteries become weak, the operating distance of the remote control will be greatly reduced and you will need to replace the batteries.

Note:

- Remove the batteries from the remote control when it is not to be used for a long period. Otherwise it could cause corrosion or battery leakage and may result in physical injury and/or property damage including fire.
- Do not mix old and new batteries. Do not mix ALKALINE, standard (CARBON-ZINC) or rechargeable (NICKEL-CADMIUM) batteries.
- Corrosion, oxidation, battery-leakage and any other gradually acidic defect of this nature will invalidate the guarantee.
- When discarding batteries, environmental problems must be considered and local rules or laws governing the disposal of these batteries must be followed strictly.



### WARNING:

- Do not dispose of batteries in a fire or they may leak and/or explode.
- The battery shall not be exposed to excessive heat such as sunshine, fire or the like.

### CAUTION:

Danger of explosion may be resulted if batteries are incorrectly replaced. Replace only with the same or equivalent type.



## FRONT VIEW

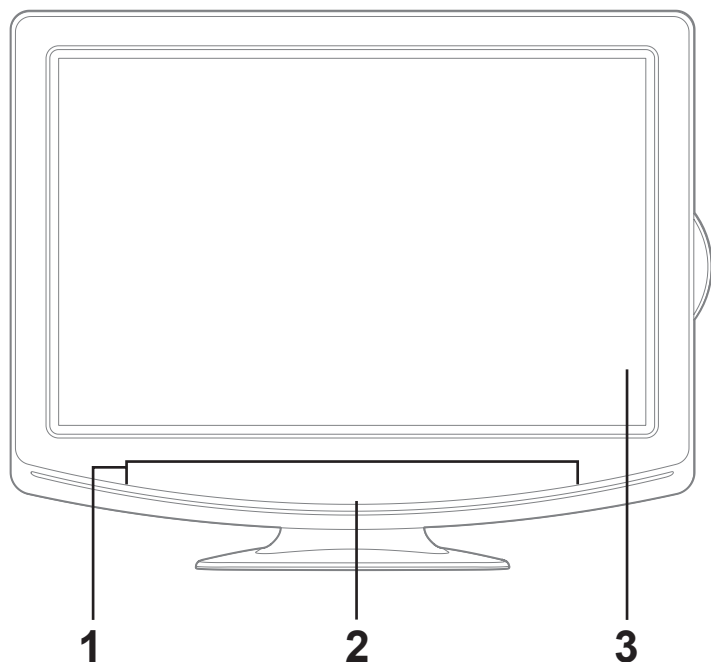

- 1) **Speakers**
- 2) **Remote Sensor/ Standby Indicator**
  - Indicates whether the unit is ON or in STANDBY (OFF) mode.
    - Amber Red Light On: The unit is in STANDBY.
    - Amber Red Light Off: The unit is turned ON.
  - Do not block this sensor or the remote control will not work properly.
- 3) **Colour LCD Screen**

## BACK VIEW

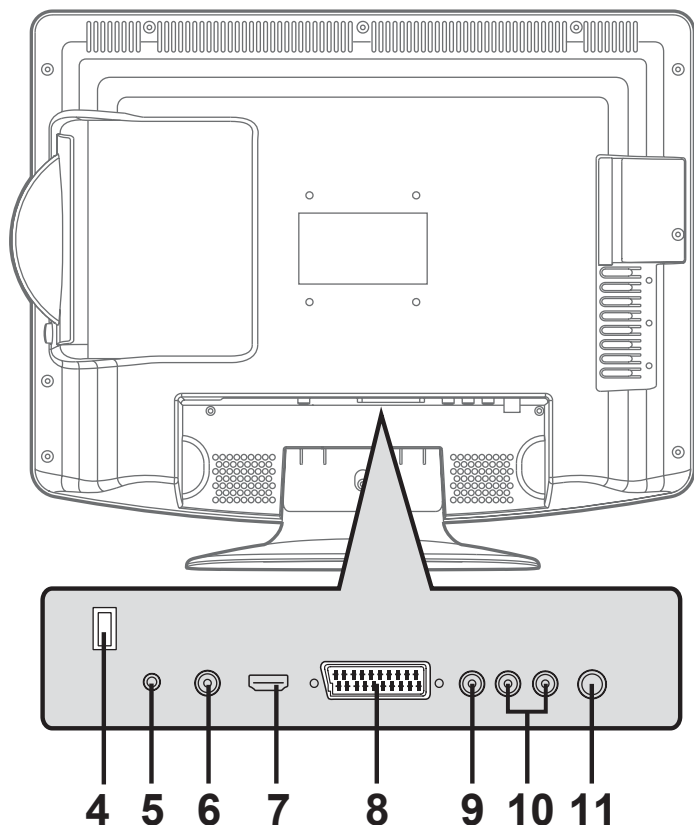

- 4) **Power Cord**
- 5) **PHONES jack**
- 6) **DVD VIDEO OUT jack**
- 7) **HDMI in jack**
- 8) **SCART jack (AV IN 2)**
- 9) **VIDEO IN jack (AV IN 1)**
- 10) **AUDIO IN jacks (Left/Right) (AV IN 1)**
- 11) **TV Aerial port**

# LCD TV

## SIDE VIEW

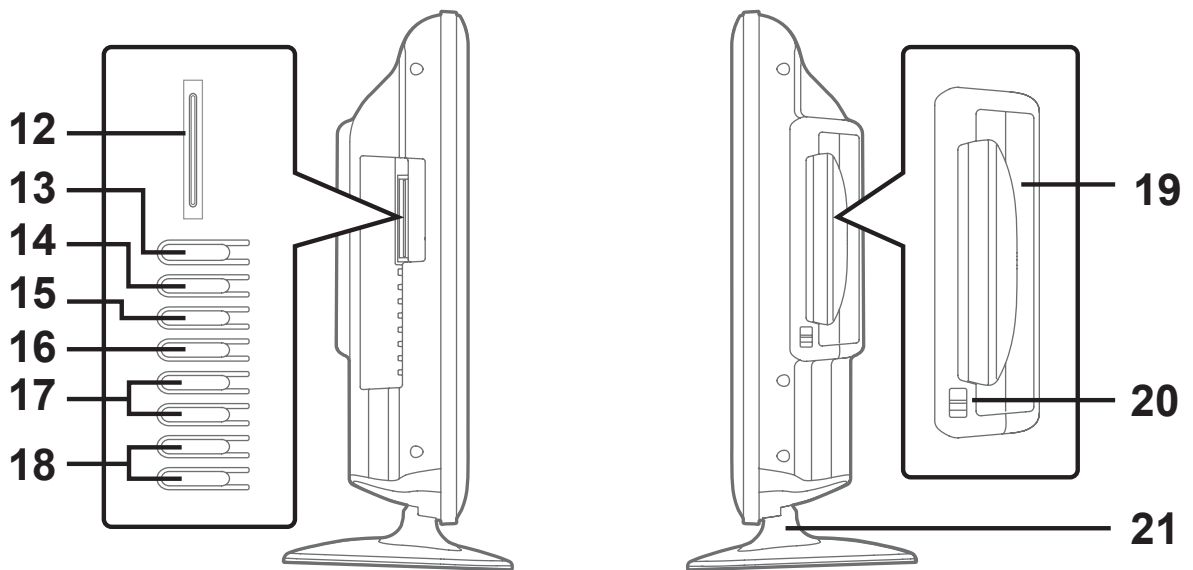

### 12) COMMON INTERFACE slot

### 13) / I button

Turns the unit on and off.

### 14) PLAY button

Press to start or resume playback of a disc.

### 15) MENU button

Press to display the on-screen TV menu.

### 16) FUNCTION button

Select DTV, TV, AV1, AV2/SCART, YUV/SCART, DVD or HDMI.

### 17) CH buttons

Press to change the TV channels and highlight selections (Up & Down) on the menu screen.

#### button

Press to select previous title, chapter or track on a disc.

#### button

Press to select next title, chapter or track on a disc.

### 18) + VOL – controls

Adjust the volume level.

### 19) Disc Door

Push gently to close the disc door.

### 20) button

Press to open the disc door.

### 21) Removable Stand

# REMOTE CONTROL

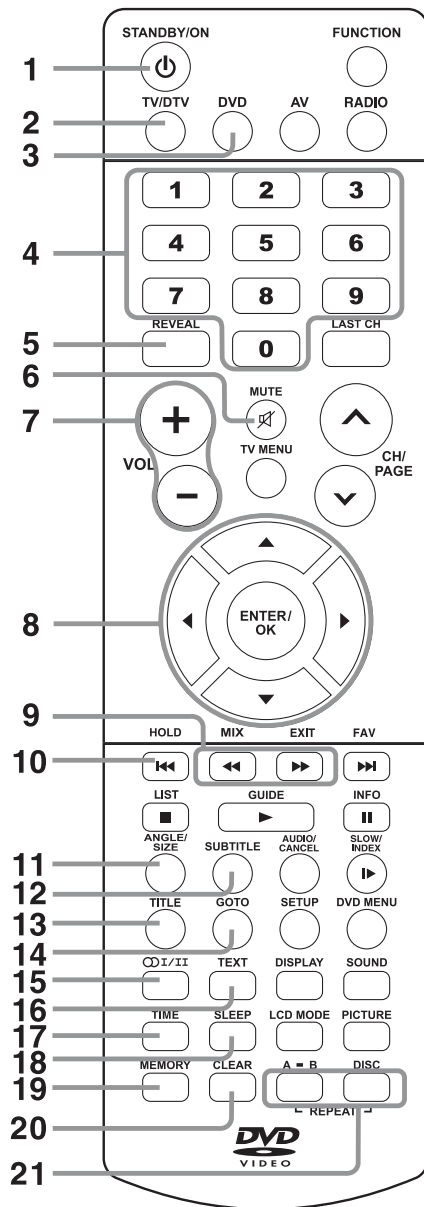

## 1) **STANDBY/ON button**

Press to turn ON the unit or press again to switch to STANDBY (OFF) mode.

## 2) **TV/DTV button**

Press to switch to TV/DTV mode.

## 3) **DVD button**

Press to switch DVD mode.

## 4) **Number (0 - 9) buttons**

Use to change the TV/DTV channels.

## 5) **REVEAL button**

Press to reveal answers on a quiz or game pages from Teletext.

## 6) **MUTE button**

Press to mute the sound.  
Press again to cancel mute.

## 7) **VOLUME + / - buttons**

Press to adjust the volume level.

## 8) **directional pad buttons**

Allow you to highlight selection, adjust setting and confirm selection on the menu screen.

## 9) **MIX button**

Press to select Teletext with a TV programme.

Fast reverse playback.

## 10) **EXIT button**

Press to exit the menu and return directly to normal viewing.

Fast forward playback.

## 11) **HOLD button**

Press to stop the automatic page change from Teletext.

Press to select previous title, chapter or track on a disc.

## 12) **ANGLE button**

Press to switch the camera angle of the video presentation when scenes with multiple camera angles are recorded on a DVD.

## 13) **SIZE button**

Press to set the letters size of teletext on the screen.

## 14) **SUBTITLE button**

Press to select one of the subtitle languages programmed on a DVD/DTV.

## 15) **TITLE Button**

Press to select the title menu screen in DVD mode.

## 16) **GOTO button**

Press to skip directly to a specific location on a DVD/CD.

## 17) **CD I/II button**

Press to select Mono/Stereo or Dual I/ Dual II.

## 18) **TEXT button**

Press to enter the Teletext mode.  
Press again to exit Teletext mode.

## 19) **TIME button**

Enter and exit the TIME menu.

## 20) **SLEEP button**

Press to set the SLEEP timer. The unit will remain ON for the time that is set, and will automatically shut off afterwards.

## 21) **MEMORY button (red button)**

Press to perform title/chapter programmed playback in DVD mode.

## 22) **CLEAR button (green button)**

Press to clear input selections and cancel certain playback functions.

## 23) **REPEAT A-B button (yellow button)**

Press to perform point-to-point repeat playback on a DVD or CD.

## 24) **REPEAT DISC button (blue button)**

Repeat chapter/ title of a DVD.  
Repeat single track or whole CD.

# REMOTE CONTROL

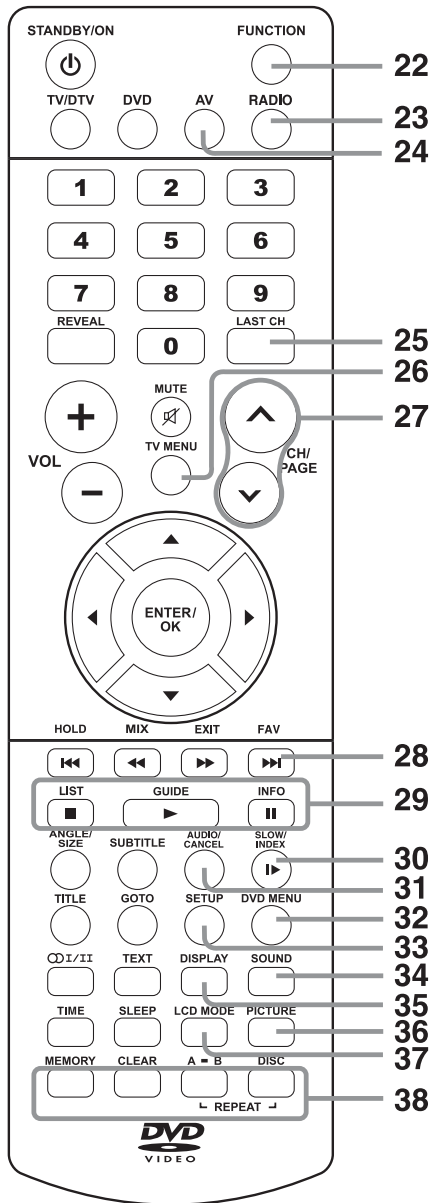

- 22) FUNCTION button**  
Press to switch between DTV, TV, AV1, AV2/SCART, YUV/SCART, DVD or HDMI.
- 23) RADIO button**  
Press to select digital radio programmes. Press again to exit to normal DTV programmes mode.
- 24) AV button**  
Press to select source connected to AV1, AV2/SCART, YUV/SCART or HDMI.
- 25) LAST CH button**  
Press to switch repeatedly between the last two channels displayed.
- 26) TV MENU button**  
Press to display the on-screen TV menu.
- 27) CH/PAGE / buttons**
  - Press to change the TV/DTV channels.
  - Press to go forward or backward the page of Teletext screen in TV mode.
  - Press to go forward or backward the page of Programme Edit & Favourite in TV/DTV mode.

- 28) FAV**  : Press to display the favourites programmes in TV/DTV mode. (You should setup your favourite TV/DTV channels in Programme Edit menu.)
- : Press to select next title, chapter or track on a disc.
- 29) ■ **LIST**** : Press to stop playing a disc.  
**LIST** : Press to display the channel list in TV/DTV mode.
- GUIDE**** : Press to start and resume playback of a disc.  
**GUIDE** : Press to display the Electronic Programme Guide (EPG) in DTV mode.
- INFO**** : Press to pause playback and single frame advance.  
**INFO** : Press to display the channel information in DTV mode.
- 30) **SLOW**** : Press to play a DVD in slow-motion.  
**INDEX** : Press to select the page number of the index from Teletext.
- 31) AUDIO button**  
Press to select audio soundtracks of a DVD or change the output mode of a CD.
- CANCEL button**  
Press to cancel the Teletext menu.
- 32) DVD MENU button**  
Press to enter the main menu of the disc you are watching.
- 33) SETUP button**  
Press to enter and exit the SETUP menu of the DVD player.
- 34) SOUND button**  
Press to select from preset sound settings (Standard, Music, Theatre, Voice, Personal) to match the type of show you are watching.
- 35) DISPLAY button**  
Press to change disc status information displayed on the screen.
- 36) PICTURE button**  
Press to select from preset screen display settings to match the type of show you are watching (Standard, Movie, Dynamic, Soft, Personal).
- 37) LCD MODE button**  
Press to set the size of LCD display between Auto, 16:9, 4:3, Expand, Zoom, LCD Off. LCD Off can be selected when listening to digital radio.
- 38) RED/GREEN/YELLOW/BLUE button**  
Press to select the relevant page quickly from Teletext.

## CONNECTING A TV AERIAL/CABLE/SATELLITE

To view television channels correctly, a signal must be received from one of the following sources:

- An indoor or outdoor aerial
- A cable system
- A satellite system

Note:

For receiving over-the-air TV broadcasts, we recommend that you use an external fixed aerial. Should you require the use of a temporary aerial, please ensure that you purchase an aerial with sufficient ability to receive in weak signal areas. Only when you are in close proximity to a transmitter will a temporary aerial reproduce a signal as strongly as a fixed aerial.

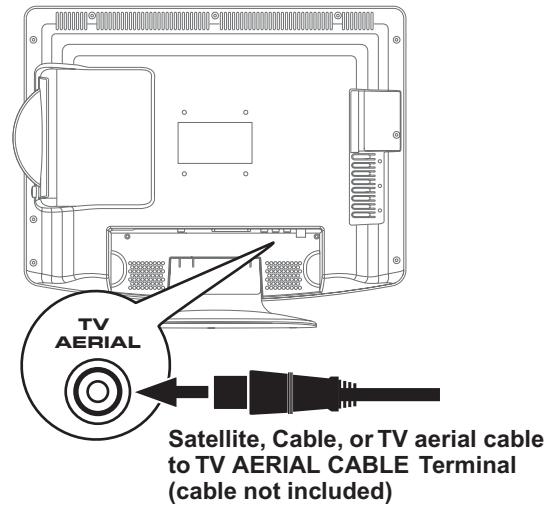

## CONNECTING A POWER CORD

- Connect the AC power cord into a wall outlet.
- Press the **⏻ / I** button on the unit or remote control to turn on the unit.

Note:

- Be sure the AC power cord is disconnected and the TV is switched off before making connections.
- Make sure that all the components are connected correctly.
- When you are not going to use the unit for a long period of time, disconnect the power cord.
- The apparatus should not be exposed to dripping or splashing and that no objects filled with liquids, such as vases, should be placed on apparatus.
- The mains plug is used as the disconnecting device. It should remain readily accessible and should not be obstructed during use. To be completely disconnected from the supply mains, the mains plug of the apparatus should be disconnected from the mains socket outlet completely.

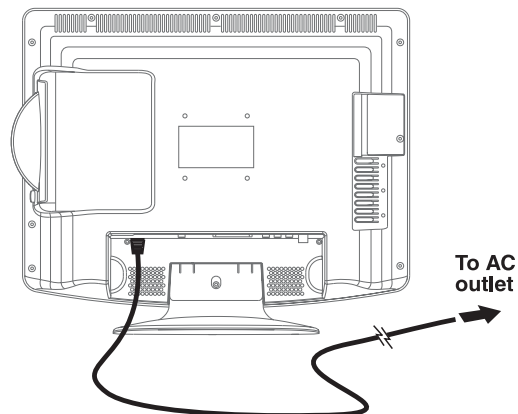

## COMMON INTERFACE

The unit is equipped with a CI slot. The CI slot allows you to insert a CAM (Conditional Access Module) with an appropriate subscription card for some pay for view services.

It is required to subscribe to a pay channel company to view the pay channels of the Digital Terrestrial broadcasting.

Fully insert the CAM (Conditional Access Module) into the CI (Common Interface) slot on the bottom of the unit with its label side facing you.

**Important notes:**

- **Switch off the TV and unplug from the AC power mains before insert or remove the CAM.**
- **The CAM should be correctly inserted, it is impossible to insert fully if reversed. The CAM or the TV terminal may be damaged if the CAM is forcefully inserted.**
- **Some CAMs may require setting up. Refer to the module instruction manual for details of the settings.**

# CONNECTIONS

## CONNECTING TO DEVICES WITH A COMPOSITE (YELLOW RCA-TYPE) VIDEO OUTPUT

To connect to A/V devices such as a VCR, camcorder or video game system.

### - Connect to a VCR / Video Game System / Camcorder

Connect the AUDIO / VIDEO cable (not included) as shown.

Make sure you connect the cable from the other equipment (**AUDIO** and **VIDEO OUT**) to this unit (**AUDIO** and **VIDEO IN**). Press the **FUNCTION** or **AV** button to select AV1 mode.

Note:

Please refer to the user manual for the other equipment for more information.

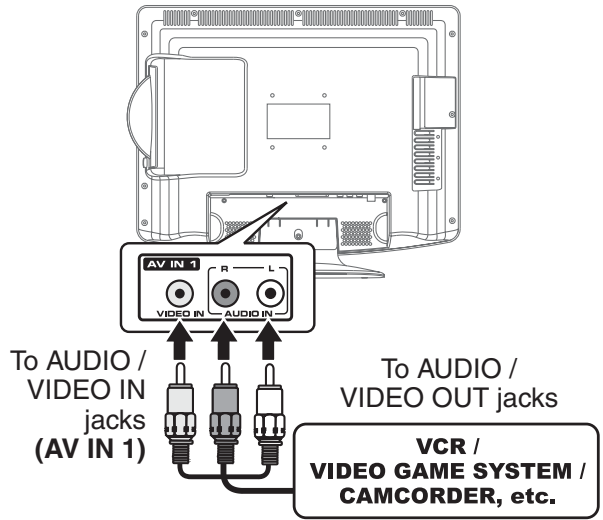

## CONNECTING DEVICES WITH A VIDEO INPUT

Connect the AUDIO cable (included) and VIDEO cable (not included) as shown.

Make sure you connect the cable from the other equipment (**AUDIO** and **VIDEO IN**) to this unit (**Headphone jack** and **VIDEO OUT**). Press the **FUNCTION** or **DVD** button to select DVD mode.

Note:

Please refer to the user manual for the other equipment for more information.

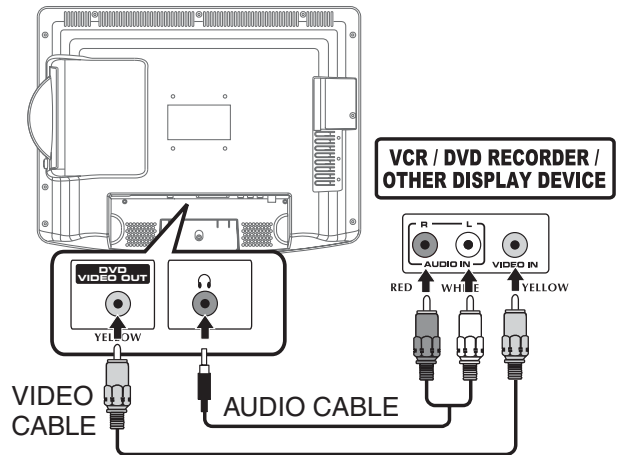

## CONNECTING TO SOURCES WITH SCART

Devices with RGB output must be connected to the SCART input:

Connects the SCART from the source to the corresponding SCART on this unit (SCART cable not included) as shown.

Make sure you connect both to SCART to SCART.

To operate the connected device and play the source, first press the **FUNCTION** or **AV** button to select the AV2/SCART mode.

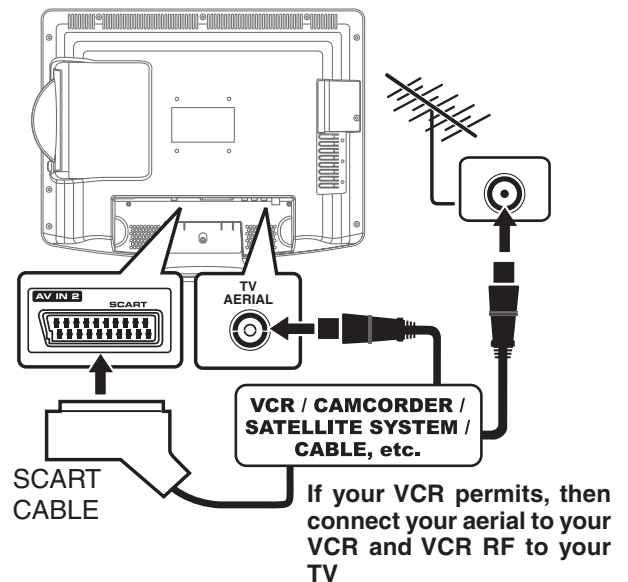

## CONNECTING A HIGH-DEFINITION (HD) SOURCE (YUV)

High-Definition (HD) Devices with component video output must be connected to the YUV input.

Connect the component video cable and audio cable (not included) as shown.

Make sure you connect the YUV Scart adaptor to this unit, then connect component video cable and audio cable from the other equipment (**COMPONENT VIDEO OUT** and **AUDIO OUT**) to this unit (**SCART** and **AUDIO IN**).

To operate the connected device and play the source, first press the **FUNCTION** button to select the YUV/SCART mode.

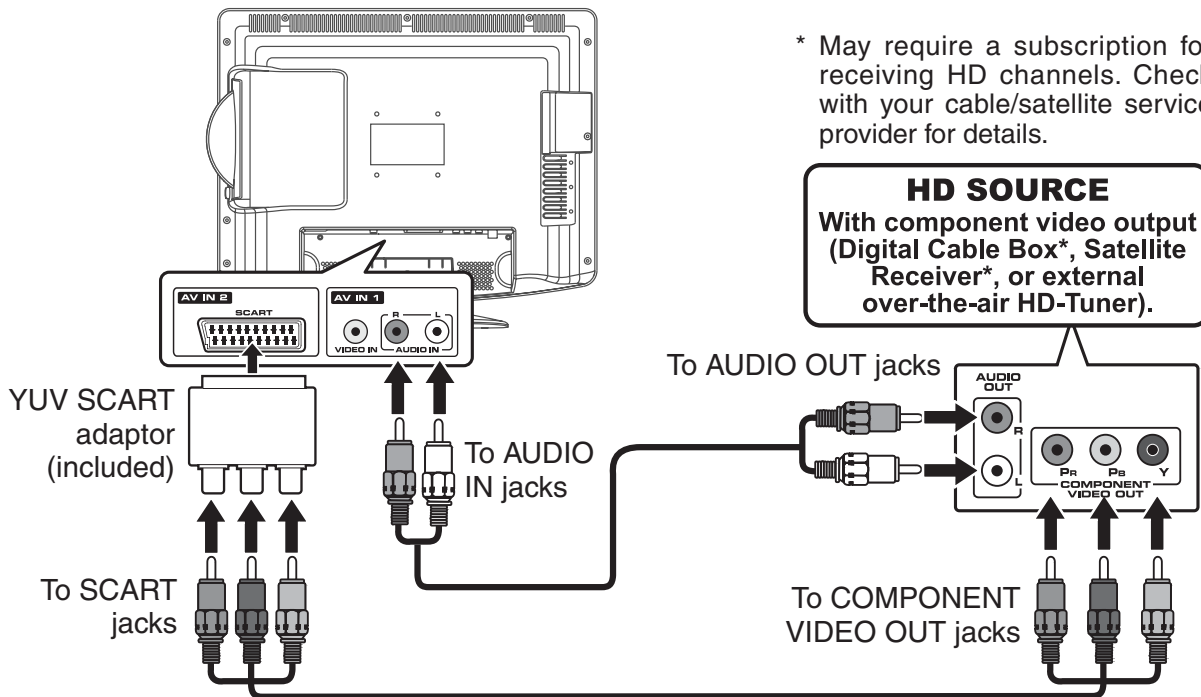

### Note:

When connecting a DVD player to the television, the picture resolution is dependent upon the resolution of both the DVD player and the TV. For best results, select the highest resolution of the DVD up to the TV maximum of 1080p such as for Blu-ray player.

# CONNECTIONS



## CONNECTING HDMI

HDMI (High Definition Multimedia Interface) supports both video and audio on a single digital connection for use with DVD players, DTV, set-top boxes and other digital AV devices. HDMI was developed to provide the technologies of High Bandwidth Digital Content Protection (HDCP) as well as Digital Visual Interface (DVI) in one specification. HDCP is used to protect digital content transmitted and received by DVI-compliant or HDMI-compliant displays.

HDMI has the capability to support standard, enhanced or high-definition video plus standard to multi-channel surround-sound audio. HDMI feature include uncompressed digital video, one connector (instead of several cables and connectors), and communication between the AV source and AV devices such as DTVs.

HDMI, the HDMI logo **HDMI** and High-Definition Multimedia Interface are trademarks or registered trademarks of HDMI licensing LLC.

Connect the HDMI cable (not included) as shown.

Make sure you connect the cable from the equipment (**HDMI OUT**) to this unit (**HDMI IN**).

To operate the connected device and play the source, first press the **FUNCTION** button to select the HDMI mode.

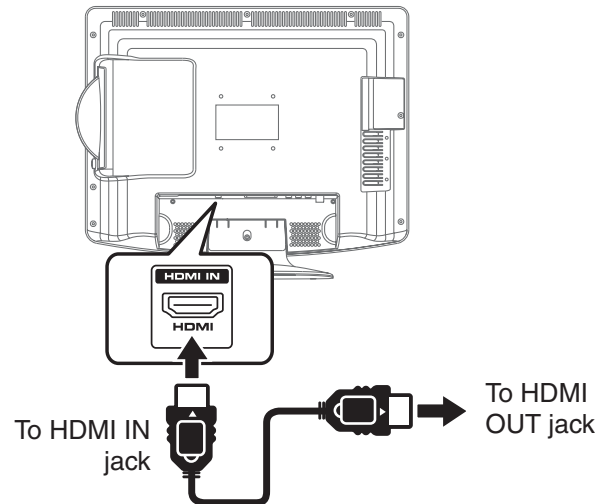

## USING HEADPHONES

- Turn down the volume before connecting headphones to the unit, then adjust the volume to your desired level.
- When headphones are connected, no sound will come from the front speakers.

Note:

- Avoid listening to sound at high levels for prolonged periods of time. This may be harmful to you and may cause hearing loss.

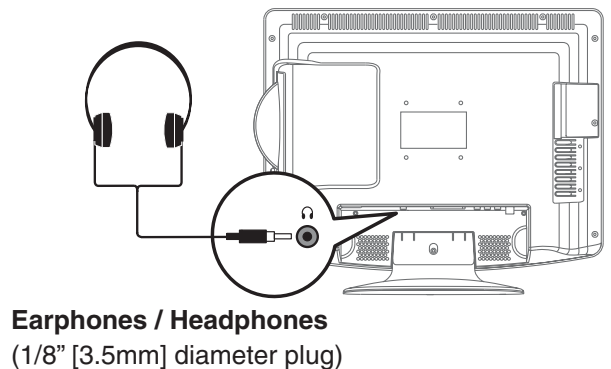

## DOLBY DIGITAL (FOR DVD)

Dolby Digital is a sound system developed by Dolby Laboratories Inc. This unit automatically recognizes DVDs that have been recorded with Dolby Digital.

Not all Dolby Digital sources are recorded with 6 channels.

Some sources marked Dolby Digital may be recorded in Dolby Surround, a 2 channel system. Look for this logo on your unit.

Manufactured under license from Dolby Laboratories.

'Dolby' and the double-D symbol are trademarks of Dolby Laboratories.





## TURNING THE UNIT ON FOR THE FIRST TIME

The first time you turn the unit on, it will go straight into Auto scan mode. Simply follow the screen prompts as below to tune in the channels.

1. Use the ◀/▶ button to select the screen menu language you prefer.
2. Use the ▼ button to move to Auto Tuning, press the **ENTER/OK** button to enter Auto Tuning menu.
3. Use the ◀/▶ button to select the Country you are in.
4. Use the ▼ button to move to Start. Press the **ENTER/OK** button confirm Start. The system will automatically start to scan and preset all available programmes.
5. After scanning has finished, the TV will display the first programmes stored of DTV programme.



## TURNING THE UNIT ON

When the AC power cord is connected, the standby indicator lights on. Press the **⏻/⏻** button to turn the unit on, the standby indicator will blink for about 10 seconds for loading, and will finally light off until the above screens shown. Press the **FUNCTION** button to select the desired mode (DTV, TV, AV1, AV2/SCART, YUV/SCART, DVD or HDMI). If you select DVD mode, the DVD logo will appear on the screen.

Note:

When the unit is not going to be used for a long time, disconnect the AC power supply cord from AC outlet.

# TV / DTV / RADIO SETUP

## TV SETTING (only in ATV or DTV or RADIO mode)

1. Press the **FUNCTION** or **TV/DTV** button to select DTV/ TV mode; or press **RADIO** button to select DTV digital radio programmes.
2. Press the **TV MENU** button.
3. Use the the ◀ or ▶ button to select the TV Setting.
4. Use the ▲ or ▼ button to select the options (**Auto Tuning, DTV Manual Tuning, ATV Manual Tuning, Programme Edit, CI Information**), press the **ENTER/OK** button to enter the settings.
5. Press the **TV MENU** button to return to previous menu, repeat step 4 to adjust other settings.
6. To exit the setup menu and return to the normal screen, press the **EXIT** button.

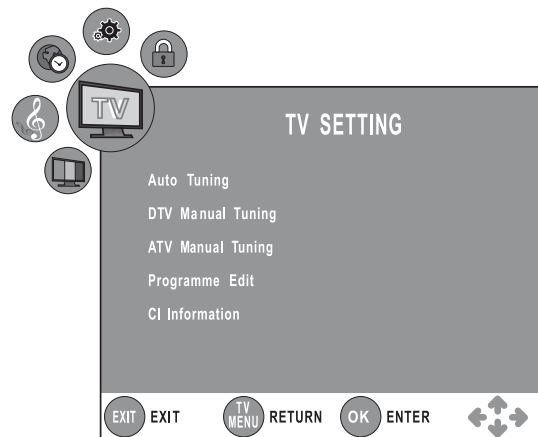

- **Auto Tuning** : Automatically scan, sort and store all available programmes.
- **DTV Manual Tuning** : Perform manual search for DTV (Digital TV) programmes.
- **ATV Manual Tuning** : Perform manual search and fine tune for ATV (Analog TV) programmes.
- **Programme Edit** : All channels stored are listed in the Programme Edit menu, you can edit the channels by the following steps:
  1. Use the ▲ or ▼ button to select a channel. (Press the **CH/PAGE** ▲ / ▼ button to skip to previous/next page.)
  2. Press the **RED / GREEN / YELLOW / BLUE** button or the **FAV** button to edit the channel.
    - **DELETE**  
Press the **RED** button to delete the selected channel, press the **ENTER/OK** button to confirm. Press the **TV MENU** button to stop delete.
    - **RENAME (for ATV mode only)**  
Press the **GREEN** button to rename the selected channel. Use the ▲ or ▼ button to select the characters to represent the station name, use the ◀ or ▶ button to move the next position of character, press the **TV MENU** button to confirm.
    - **MOVE (for ATV mode only)**  
Press the **YELLOW** button and use the ▲ or ▼ button to move the selected channel, then press the **TV MENU** button to confirm.
    - **SKIP**  
Press the **BLUE** button to skip or not skip the selected channel.
    - **FAV (Favourite)**  
Press the **FAV** button to set or cancel the selected channel as one of the favourite programmes.
- **CI Information**  
Display CAM and Smart card information; select the language if available.



## ELECTRONIC PROGRAMME GUIDE (EPG) FOR DTV

While watching a DTV programme, you can press the **GUIDE** button to display the Electronic Programme Guide (EPG) menu, and check for programme information.

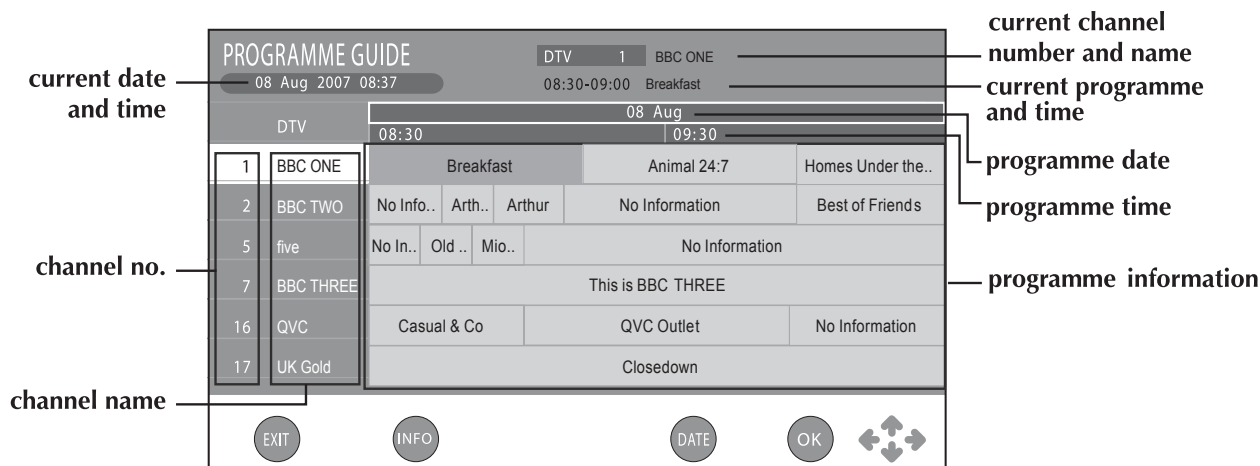

- Programme time and name will be displayed, use the ◀ ▶ ▼ ▲ button select a programme, press the **INFO** button to display detailed information if available. Press the **INFO** button again to return.
- Press the **YELLOW** button to highlight programme date, use the ◀ / ▶ button to display information for other dates. Press the **YELLOW** button again to return
- Press the **ENTER/OK** button to confirm the selected channel.
- Press the **EXIT** button to exit the Electronic Programme Guide (EPG) menu.

Note:  
Guide information display may be different according to the DTV programmes.

## AUDIO LANGUAGE FOR DTV

While watching a DTV programme, you can press the  $\odot$ I/II button to display the Audio Language menu, and select audio language, audio format and sound track.

- Use the ▲ or ▼ button to select an audio language or audio format if available, press the ◀ or ▶ button to select sound track between L/R (Stereo), L/L (Mono Left) and R/R (Mono Right). Press the **ENTER/OK** button to confirm.
- Press the  $\odot$ I/II or **EXIT** button to exit the Audio Language menu.

Note :  
For analogue TV, press the  $\odot$ I/II button to select Mono / Stereo or Dual I / Dual II directly.

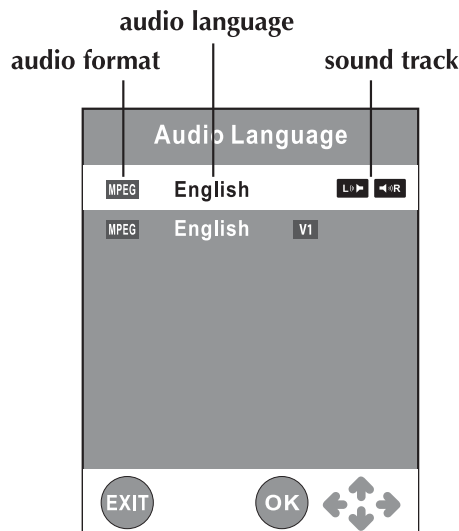

# TV / DTV / RADIO SETUP

## PICTURE MENU

1. Press the **TV MENU** button.
2. Use the **▲** or **▼** button to select the options (Picture Mode, Contrast, Brightness, Colour, Sharpness, Tint, Colour Temp), adjust them by using the **◀** or **▶** button.
3. Press the **TV MENU** button to return to previous menu.
4. To exit the setup menu and return to the normal screen, press the **EXIT** button.

### • **Picture Mode**

Select from four preset screen display settings (Standard, Movie, Dynamic and Soft), or select Personal in which your own settings of Contrast, Brightness, Colour and Sharpness are stored.

You can also select Picture Mode simply by pressing the **PICTURE** button on the remote control.

### • **Contrast**

Adjust the contrast of the picture. The black portions of the picture become richer in darkness and the white become brighter.

### • **Brightness**

Adjust the brightness of the picture.

### • **Colour**

Adjust the colour of the picture.

### • **Sharpness**

Adjust the sharpness level to improve detail in the picture.

### • **Tint (only for AV mode with NTSC signal)**

Adjust the tint of the picture. (Toward purple/Toward green).

### • **Colour Temp**

Select the colour temperature of the picture. Select Normal (balanced)/ Warm (red white)/Cold (blue white) mode.

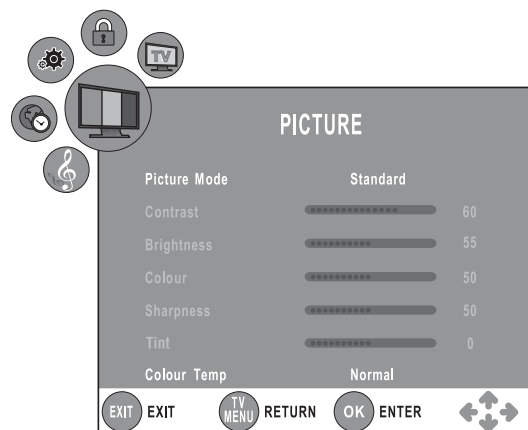

## SOUND MENU

1. Press the **TV MENU** button.
2. Use the **◀** or **▶** button to select the **SOUND**.
3. Use the **▲** or **▼** button to select the options (**Sound Mode, Treble, Bass, Balance**), adjust them by using the **◀** or **▶** button.
4. Press the **TV MENU** button to return to previous menu.
5. To exit the setup menu and return to the normal screen, press the **EXIT** button.

**Experiment with different sound settings until you find the settings you prefer.**

### • **Sound Mode**

Select from four preset sound settings (Standard, Music, Theatre and Voice), or select Personal in which your own settings of Treble, Bass and Balance are stored.

You can also select Sound Mode simply by pressing the **SOUND** button on the remote control.

### • **Treble**

Adjust the treble range.

### • **Bass**

Adjust the bass range.

### • **Balance**

Adjust the balance level toward the left or right speakers.

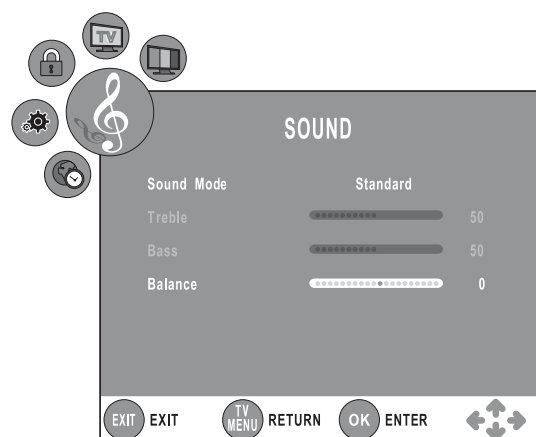

## TIME MENU

1. Press the **TV MENU** button.
2. Use the ◀ or ▶ button to select the **TIME**.
3. Use the ▲ or ▼ button to select the options (**Clock, Sleep Timer, Time Zone**), adjust them by using the ◀ or ▶ button.
4. Press the **TV MENU** button to return to previous menu.
5. To exit the setup menu and return to the normal screen, press the **EXIT** button.

- **Clock**

Press the **ENTER/OK** button to enter the Clock menu, use the ▲ ▼ ◀ ▶ button to set Date, Month, Year, Hour and Minute.

- **Sleep timer**

Select the time to turn the unit to Standby mode automatically: Off -> 5min - - - -> 90min -> 120min.

- **Time Zone**

Select your time zone.

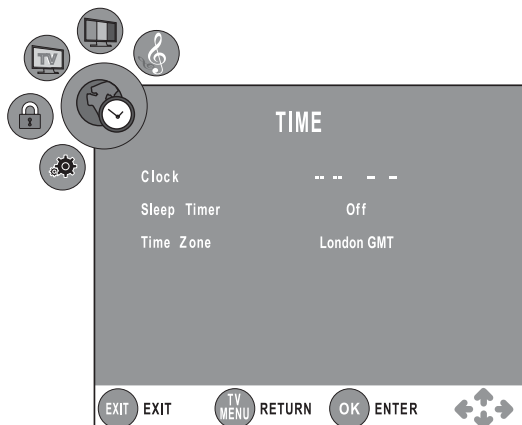

## SETUP MENU

1. Press the **TV MENU** button.
2. Use the ◀ or ▶ button to select the **SETUP**.
3. Use the ▲ or ▼ button to select the options (**Language, Audio Language, Subtitle Language, Restore Setting**), adjust them by using the ◀ or ▶ button. (In PC mode, select PC Setup and press the **ENTER/OK** button to enter the settings.)
4. Press the **TV MENU** button to return to previous menu.
5. To exit the setup menu and return to the normal screen, press the **EXIT** button.

- **Language**

Select your preferred On Screen Display language.

- **Audio Language**

Select your preferred audio language. (Available for digital channels if multiple audio languages are broadcasted.)

- **Subtitle Language**

Select your preferred subtitle language or turn off subtitle. (Available for digital channels if multiple subtitle languages are broadcasted.)

- **Restore Setting**

Press the **ENTER/OK** button to restore the system settings to the factory default.

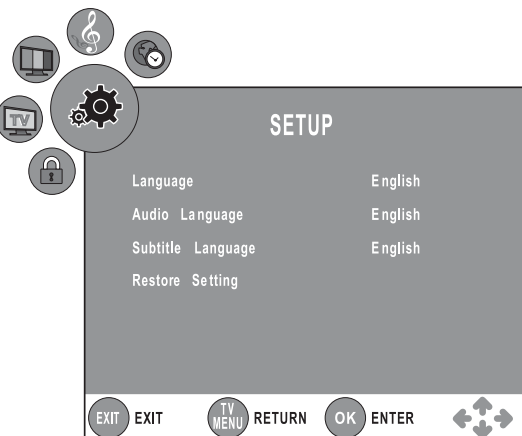

# TV / DTV / RADIO SETUP

## LOCK MENU

1. Press the **TV MENU** button.
2. Use the ◀ or ▶ button to select the **LOCK**.
3. Press the **ENTER/OK** or ▼ button to enter, enter password to proceed.  
*(The default password is 0000.)*
4. Use the ▲ or ▼ button to select the options (**Lock System, Change Password, Block Programme, Parental Guidance**), press the **ENTER/OK** or ◀ or ▶ button to adjust.
5. Press the **TV MENU** button to return to previous menu.
6. To exit the setup menu and return to the normal screen, press the **EXIT** button.

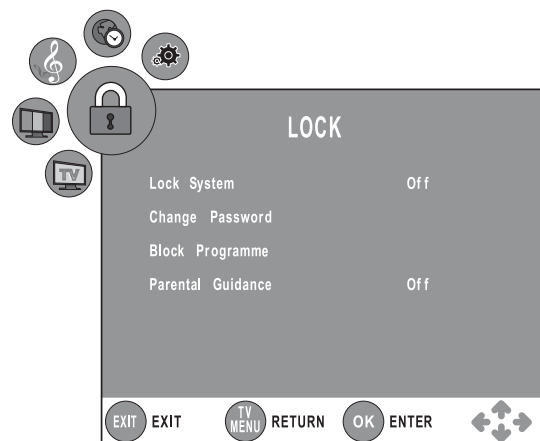

- **Lock System**

Lock System is designed to prevent accidentally retuning the TV and losing channels. When the Lock System is "ON", a valid password is required if the TV is to be retuned.

- **Change Password**

If you change the password, please remember your password.

**If you forget the password, enter " 8888 " to unlock parental control.**

- **Block Programme**

This is designed to prevent unsuitable programmes for children to be watched.

Press the ▲ or ▼ buttons to select a programme, then press the **GREEN** button on the remote control to block or unblock the programme.

- **Parental Guidance**

Select a censorship level to censor for your children accordingly to their ages and block the programmes. (Off, level 4, ..., level 18)

Note:

This system will only work if the correct information is transmitted by the TV channel.

Teletext is an information system that displays text on your TV screen. Using the Teletext control buttons you can view pages of information that are listed in the teletext index.

### Please Note

On Screen Display is not available in text mode. The contrast, brightness and colour cannot be changed but the volume control is still available.

Analog and Digital text look very different and operate differently.

For Analogue text press the **TEXT** button in ATV mode. For digital text, press the **TEXT** button in DTV mode.

## TO ENTER TEXT MODE

### Please Note

Make sure the TV channel you are watching transmits teletext. If not “No Teletext” sign will be shown on the screen.

In TV mode, press the **TEXT** button. The text page will appear, normally the index page.

## TO EXIT TEXT MODE

Press the **TEXT** button again to exit and the TV will return to the channel you were watching.

## TO SELECT A PAGE OF TEXT

Find the number of the page in the index and enter it using the Number buttons. The number of the page will appear on the top left corner of the screen.

The page counter will search for your page. When it finds it, the page will be displayed.

To move to the next page of text, press the **CH/PAGE**  button.

To move to the previous page, press the **CH/PAGE**  button.

To return to the index page, enter the “100” by using the Number buttons.

## MIX

To view a page of the text whilst watching a TV programme press the **MIX** button. The text will be superimposed over the TV programme.

Press the **MIX** button again to return to the text page.

## PAGE SEARCH WHILST WATCHING TV

In Text mode press the **CANCEL** button.

Enter the page number you want using the Numeric buttons.

The top line of the text page will appear whilst the text searches for your page. When the page is found the number will remain in the top left hand corner of the screen.

## DOUBLE HEIGHT TEXT

If you have difficulty reading the text on the TV you can double the height of the text.

Press the **SIZE** button. The top half of the page will be displayed in double height text.

Press the **SIZE** button again. The bottom half of the page will be displayed in double height text.

Press the **SIZE** button again to return to the full page.

## PAGE STOP

If the page of text you have selected contains sub pages, these sub pages will automatically be displayed in order with a delay to allow you to read the page.

To stop the move to the next sub page, press the **HOLD** button. “” will appear on the top left corner of the screen.

To continue moving through the sub pages, press the **HOLD** button again.

## TO REVEAL INFORMATION

Press the **REVEAL** button to reveal concealed information (quiz answers etc.).

Press the **REVEAL** button again to conceal the information again.

## FASTTEXT

At the bottom of the teletext screen is a row of subject headings in red, green, yellow and blue.

The remote control has a row of colour buttons corresponding to the row of coloured subjects on the screen.

Pressing one of the colour buttons will take you directly to the page corresponding to the subject heading.

# CUSTOMISING THE DVD FUNCTION SETTINGS

## LANGUAGE SETUP

1. In Stop mode, press the **SETUP** button.
2. Use the **▲** or **▼** button to select the option Language Setup, then press the **▶** button to move the highlight bar on OSD Language. (Note that Audio, Subtitle and DVD Menu can be activated by pressing the **■ STOP** button twice.)
3. Use the **▶** button to move the highlight bar, then use the **▲** or **▼** button to select your preferred language, and press the **ENTER/OK** button to confirm.
4. Press the **◀** button to go back to the previous menu. Repeat steps 2 and 3 to adjust other options.
5. To exit the SETUP MENU and return to the normal screen, highlight the Exit Setup Mode (  ) and press the **ENTER/OK** button.

Note :

- Some DVDs may not play in the audio language you selected. A prior language may be programmed on the disc.
- Some DVDs may be set to display subtitles in a language other than the one you selected. A prior subtitle language may be programmed on the disc.
- Some DVDs allow to change subtitle selections only via the disc menu. If this is the case, press the DVD MENU button and choose the appropriate subtitle from the selection on the disc menu.
- Some DVDs may not included your pre-selected language. In this case, the DVD player automatically displays disc menus consistent with the disc's initial language setting.

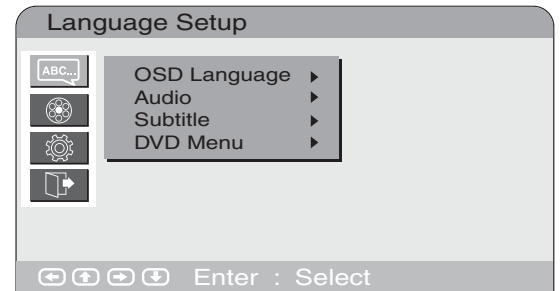

## VIDEO SETUP

1. In Stop mode, press the **SETUP** button.
2. Use the **▲** or **▼** button to select the Video Setup.
3. Press the **▶** button to highlight the **TV TYPE**.
4. Use the **▲** or **▼** button to select the desired TV type.
5. To exit the SETUP MENU and return to the normal screen, highlight the Exit Setup Mode (  ) and press the **ENTER/OK** button.



### TV Display

#### Pan Scan

- When wide-screen video is played, this mode clips the right and left sides of the image so that it can be viewed on a conventional screen.
- Some wide-screen DVDs that do not permit Pan Scan playback are automatically played in Letter Box mode (black bands at top and bottom of screen).

#### Letter Box

- When wide-screen video is played in this mode on a conventional screen, black bands appear at the top and bottom of the screen.

#### Wide-screen

- This is the correct mode for playing wide-screen videos on a wide-screen.

Note :

- The displayable picture size is preset on the DVD discs. Therefore the playback picture of some DVDs may not conform to the picture size you select.
- When you play DVDs recorded in the 4:3 aspect ratio, the playback picture will always appear in the 4:3 aspect ratio regardless of the TV shape setting.

Cut off when a wide-screen video image is played.

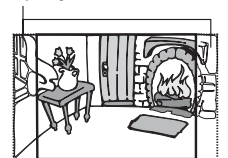

Pan Scan



Letter Box



Wide-screen



# CUSTOMISING THE DVD FUNCTION SETTINGS

## SYSTEM SETUP

1. In Stop mode, press the SETUP button.
2. Use the ▲ or ▼ button to select the System Setup option.
3. Press the ► button to highlight the Default.
4. Use the ▲ or ▼ button to select the desired setup option.
5. To exit the SETUP MENU and return to the normal screen, highlight the Exit Setup Mode (  ) and press the ENTER/OK button.

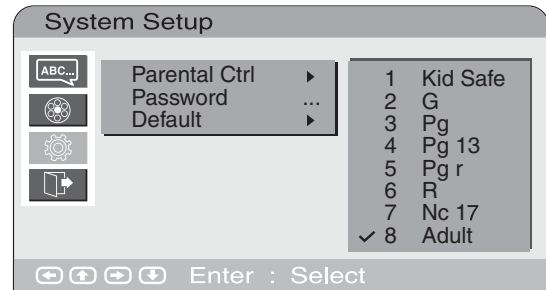

## Parental Control

DVDs are rated according to their content and some are equipped with a password function. The contents allowed by parental lock level and the way a DVD is controlled may vary from disc to disc. For example, if the disc allows, you could lockout violent scenes unsuitable for children or you could lock out playback of the disc altogether.

**You cannot play password function equipped DVDs rated higher than the level you selected unless you cancel the parental lock function.**

The parental lock levels are equivalent to the following ratings.

Level 1 : Kid Safe	Level 5 : PG-R
Level 2 : G	Level 6 : R
Level 3 : PG	Level 7 : NC-17
Level 4 : PG-13	Level 8 : Adult

## Password

Use ▲ or ▼ button to shift and select **PASSWORD**, use ► button to “Change”, then press the **ENTER/OK** button. Enter your 4-digit security code until to OK. Press the **ENTER/OK** button.

**If you forget the password, you can erase your current password by pressing number button 8 on the remote four times, then press the ENTER button to confirm the setting (PASSWORD : 8 8 8 8).**

## Default

It takes 3-5 seconds to reset the unit to the factory default.



# DVD FEATURES



- Press the **⏻ / I** button to turn the unit on.
- Press the **FUNCTION** or **DVD** button to select the DVD mode.

## DVD OPERATION

This owner's manual explains the basic instructions of this unit. Some DVDs are produced to limit operation during playback. For example, many DVDs do not allow users to skip government warnings, or in some cases previews or other features. This is not a defect in the unit. Refer to the instruction notes of discs.

“” may appear on the screen during operation. A “” means that the desired operation is not permitted by the unit or disc.

## PLAYING A DISC

1. Press the **▼** button to open the disc door on the right side of main unit.
2. Hold the disc by its edge and gently push it onto the spindle, with the label side facing the front, until you hear a “click”.
3. Push disc door gently to close it.  
It takes a short while for your unit to load the disc. After loading, the unit will automatically either bring you to the main menu of DVD, or start playing the DVD. If the unit does not automatically start playing the DVD, press the **▶ PLAY** button on the remote control.

## PLAYING A PICTURE FILE DISC

This unit can play JPG picture files recorded on CD-R and CD-RW discs.

1. Push down the **▼** button to open the disc door.
2. Hold the disc by its edge and gently push it onto the spindle, with the label side facing the front, until you hear a “click”.
3. Push the disc tray to close the disc door.
4. Press the **■ STOP** button to go to the folder list.
5. Press the **▲** or **▼** button to highlight a file to play. Press the **▶ PLAY** button to start playback.

Note:

- You can press the **⏸ PAUSE** button to interrupt playback, and press the **▶ PLAY** button to resume playback.
- Press the **ANGLE** button on the remote control to rotate the picture orientation by 90°.

## PAUSING PLAYBACK (STILL MODE)

Press the **⏸ PAUSE** button. To resume normal playback, press the **▶ PLAY** button. Each time you press the **⏸ PAUSE** button, the picture advances one frame on DVD movie.

## STOPPING PLAYBACK

Press the **■ STOP** button at the location where you want to interrupt playback. To resume playback at the position where the disc was stopped, press the **▶ PLAY** button.

If you press the **■ STOP** button twice, the unit's memory will be cleared and pressing the **▶ PLAY** button will reset the disc to the beginning.

## SKIP (FORWARD / REVERSE)

- Press the **⏮ PREV** button to go back to previous chapters/tracks.
- Press the **⏭ NEXT** button to advance chapters/tracks.
- For audio CD disc, use the number buttons (remote control only) to jump straight to that track number.

## FAST FORWARD / FAST REVERSE

1. Press the ◀◀ or ▶▶ button when a disc is playing.

- The disc begins a fast scan at two times normal (x2) speed.
- Each time the ◀◀ / ▶▶ button is pressed, the speed of the fast scan changes.

▶▶ x2 → ▶▶ x4 → ▶▶ x8 → ▶▶ x16 → ▶▶ x32      ◀◀ x2 → ◀◀ x4 → ◀◀ x8 → ◀◀ x16 → ◀◀ x32

2. Press the ▶ **PLAY** button when you have reached the desired point to resume playback at normal speed.

## SLOW-MOTION PLAY (DVD)

1. In Play mode, press the ▶ **SLOW** button on remote control. Each time the ▶ **SLOW** button is pressed, the speed of slow-motion playback changes in the following sequence:

▶ x1/2 → ▶ x1/4 → ▶ x1/8 → ▶ x1/16 → ▶ x1/32

2. Press the ▶ **PLAY** button to return to the normal playback speed.

## AUDIO SELECTION (DVD)

In some discs, the sound is recorded in two or more formats.

Ⓞ): **D D 6CH English 1/3**

Follow the directions below to select the type of playback.

1. While a disc is playing, press the **AUDIO** button to show the current audio format number.
2. Press the **AUDIO** button repeatedly to select the desired audio format.

Note :

- If only one audio format is recorded, the number does not change.
- About two seconds later, playback continues in the new audio format.

## SUBTITLE SELECTION (DVD)

1. While a DVD is playing, press the **SUBTITLE** button to display the current language setting.

**Subtitle : English 1/5**

2. Press the **SUBTITLE** button repeatedly to select the desired subtitle language.

Note :

- If only one language is recorded, the language does not change.
- About two seconds later, playback continues with the new subtitle you selected.
- The number of languages recorded differs depending on the disc.
- If no button is pressed within a few seconds, playback continues without changing the current subtitle.
- This function can only be used for discs on which subtitles have been recorded in multiple languages.
- On some DVDs, subtitles are activated from the main menu of the DVD. Press the **DVD MENU** button to activate the main menu.

## ANGLE SELECTION (DVD)

Some DVDs contain scenes which have been shot from a number of different angles. For these discs, the same scene can be viewed from each of these different angles.

1. While you are playing a DVD with different angles recorded, press the **ANGLE** button to view the number of the current angle available.

2. Press the **ANGLE** button repeatedly to change the scene to the next angle in those recorded.

- About two seconds later, playback continues from the new angle you selected.
- If no button is pressed within 10 seconds, playback continues without changing the current angle.

Note :

- This function can only be used for discs on which scenes shot from multiple angles have been recorded.
- If only one angle is recorded, “” is displayed.

 1/3

Sequence of angle shots  
(Example)



# DVD FEATURES

## SPECIAL FUNCTIONS DISPLAY (DVD)

While the disc is playing, press the **DISPLAY** button repeatedly to display information on operation status.

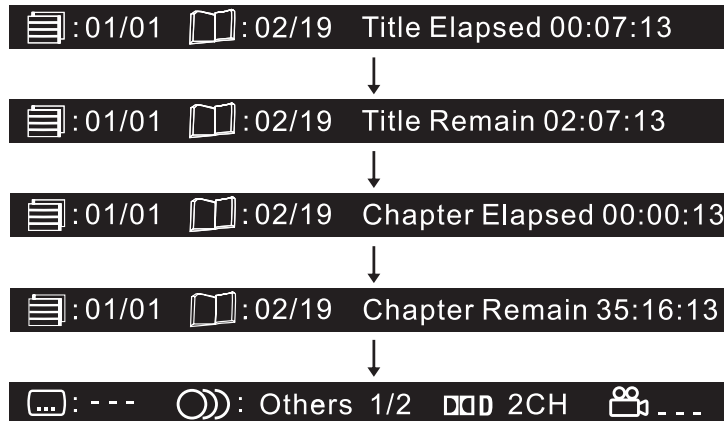

## LOCATING A SPECIFIC TITLE (DVD)

If a DVD contains title numbers, you can locate a specific title by directly selecting a title number.

1. In stop mode, press the **GOTO** button.
2. Press the ◀ or ▶ button to highlight a specific field and press the corresponding number button(s) for the title you want.
3. Press the **ENTER/OK** button to confirm. Playback starts from the selected title.



## LOCATING A SPECIFIC CHAPTER / TRACK

If you know the chapter / track number you want to play, you can locate a specific chapter / track by directly selecting a chapter / track number.

1. Press the **GOTO** button to search for your desired chapter / track.
2. Press the ◀ or ▶ button to highlight a chapter / track then press the corresponding number button(s) for the chapter /track you want.
3. Press the **ENTER/OK** button to confirm. Playback starts from the selected chapter / track.



## LOCATING A SPECIFIC TIME

You can move to a specific location by entering its corresponding time (hours, minutes, seconds)

1. Press the **GOTO** button.
2. Press the **GOTO** button again, a screen shown as right will be displayed on the screen. Enter the corresponding number buttons for the setting point you want.
3. Press the **ENTER/OK** button to confirm. Playback starts from the selected location.



Note :

- Some discs may not respond to this process.
- Some scenes may not be located as precisely as you specified.
- This method for accessing specific locations is available only within the current title of the DVD disc.

## REPEAT PLAYBACK

For DVD, you can play a specific title or chapter repeatedly. (Title repeat, chapter repeat, A-B repeat)

### 1. Repeating a chapter

You can play the same chapter repeatedly.

While the disc is playing, press the REPEAT DISC button (blue button) until the “ Chapter” indicator displays on the screen. The current chapter is played repeatedly.

### 2. Repeating a title

You can play the same title repeatedly.

While the disc is playing, press the REPEAT DISC button (blue button) until the “ Title” indicator displays on the screen. The current title is played repeatedly.

### 3. To resume normal playback

While the disc is playing, press the REPEAT DISC button (blue button) until the “ Off” indicator displays on the screen.

For CD, you can play a single track or an entire disc repeatedly. (Single track repeat, entire disc repeat, and A-B repeat)

### 1. Repeating a single track

You can play the same track repeatedly.

While the disc is playing, press the REPEAT DISC button (blue button) until the “ Track” indicator displays on the screen. The current track is played repeatedly.

### 2. Repeating an entire disc



While the disc is playing, press the REPEAT DISC button (blue button) until the “ All” indicator displays on the screen. The entire disc is played repeatedly.

### 3. To resume normal playback

Press the REPEAT DISC button (blue button) until the “ Off” indicator displays on the screen.

## Repeating a specific section (DVD / CD)

You can play a specific section repeatedly for DVD and CD.

1. While the disc is playing, press the REPEAT A-B button (yellow button) at the beginning of the section (“ Repeat A” is displayed) you want to play repeatedly.
2. Press the REPEAT A-B button (yellow button) again at the end of the section (“ Repeat A-B” is displayed) you want to play repeatedly.
3. The unit will immediately begin replaying your selection.

### To resume normal playback

4. While the disc is playing, press the REPEAT A-B button (yellow button) until the “ Repeat Off” indicator displays on the screen.

Note:

- A-B repeat can only be used within the same title for DVD and same track for CD.
- The A-B repeat function does not operate in scenes where different camera angles are recorded in DVD.

# DVD FEATURES



## PROGRAMMABLE MEMORY

The two types of programmed playback provided by this unit is title/chapter programmed playback.

### Title/Chapter programmed playback

1. Press the **MEMORY** button in **PLAY** mode. A screen will be shown as right.
2. Press the **▶** button to highlight the Title. Press the **▲** or **▼** button to choose the desired title. Press the **▶** button again to highlight the Chapter. Press the **▲** or **▼** button to choose the desired Chapter. Press the **ENTER/OK** button to confirm. The highlight bar will move to the next item automatically.
3. Repeat step 2 to add additional titles and chapters.
4. Press the **▶ PLAY** button to start the programmed playback.

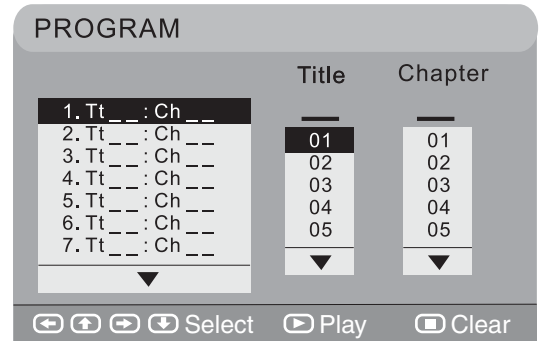
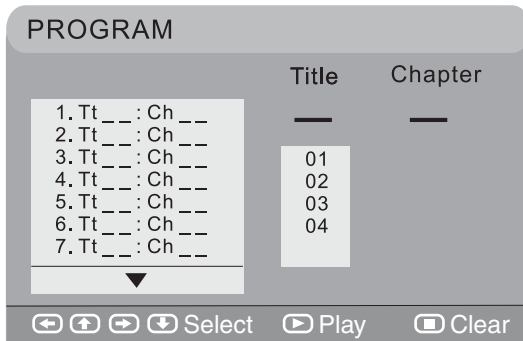

## CLEANING THE DISC

A defective or dirty disc inserted into the unit can cause sound to drop out during playback.

Handle the disc by holding its inner and outer edges.

- Do NOT touch the surface of the unlabeled side of the disc.
- Do NOT stick paper or tape on the surface of the disc.
- Do NOT expose the disc to direct sunlight or excessive heat.
- Clean the disc before playback. Wipe the disc from the centre outward with a cleaning cloth.
- NEVER use solvents such as benzene or alcohol to clean the disc.
- Do NOT use irregular shape discs (example : heart shaped, octagonal, etc.). They may cause malfunctions.

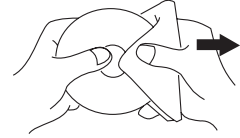

## CLEANING THE UNIT

- Be sure to turn the unit off and disconnect the AC power cord before cleaning the unit.
- Wipe the unit with a dry soft cloth. If the surfaces are extremely dirty, wipe clean with a cloth which has been dipped in a weak soap-and-water solution and wrung out thoroughly. Then wipe it with a dry cloth.
- Never use alcohol, benzene, paint-thinner, cleaning fluid or other chemicals. Do NOT use compressed air to remove dust.

## IMPORTANT NOTE

Before shipping the unit, remove any disc from the disc compartment.

# TROUBLESHOOTING GUIDE

PREPARATION

CONNECTIONS

USING THE FEATURES

USING THE DVD  
FEATURES

TROUBLESHOOTING

SPECIFICATION

## SYMPTOM

## CAUSE (AND REMEDY)

No power.

- Check that the AC power cord is connected.
- The unit is not turned on.

The remote does not function.

- Remove any obstacles between the remote and the unit.
- Use the remote near the unit.
- Point the remote at the remote sensor on the unit.
- Replace the batteries in the remote with new ones.

## TV

Why have I lost some/all of my channels?

- It happens sometimes, if you have a weak signal. Usually it just means you'll need to rescan your digital box or TV. And once you've done it, you should get all the Freeview channels available to you. If problems persist you may need to get your aerial checked. Contact your local aerial installer.

Why do I get 'blocking' on my digital picture?

- In most cases, blocking is caused by a reception problem - either the signal is too weak or there is some kind of interference. Contact your local aerial installer.

Can I watch Freeview using a portable set-top aerial?

- Some, but only a few, homes may be able to use a set top aerial. However, for a much better reception, we strongly recommend you use a rooftop aerial.
- If you do not have access to a rooftop aerial - for example, if you rent a flat and the aerial is the responsibility of your landlord, or if you're using a second TV in the bedroom and don't want the hassle and expense of extension cables - a set-top aerial may be your only option.

What type of aerial do I need?

- If you are installing a new aerial, we recommend a wideband rooftop aerial rather than a loft aerial. Loft aerials generally receive a weaker digital signal and are more likely to get interference from other electrical equipment in the home. We suggest you have an aerial survey done before getting an aerial upgrade.  
Talk to your retailer or contact your local aerial installer.

Bad Picture (snow, multiple images, distortion, blurry)

- Check the location of the aerial and adjust it if necessary.
- Make sure the aerial cable is firmly connected.
- Make sure all input cables are firmly connected.

Black and white picture.

- Check the PICTURE MENU within the TV/DTV/RADIO SETUP.
- Check to make sure the programme you are watching is broadcast in Colour and not Black & White.

No picture or sound.

- Make sure the unit is plugged in and turned on.
- Make sure TV mode is selected.
- Make sure LCD off is not selected.
- Try a new channel to check for possible station trouble.
- Make sure the aerial is connected properly.
- Increase the volume.

Coloured patches of picture.

- Make sure there are no unshielded electrical devices nearby that are causing interference.



## SYMPTOM

## CAUSE (AND REMEDY)

### TV

Function key does not respond correctly.

- Under the influence of electrostatic phenomenon, the product may malfunction and require user to power reset.
- Unplug and re-plug the AC power cord.

No sound is output from the HDMI out.

- Check the connection between this unit and the HDMI out jack of other equipment.
- See if the TV supports this 480p/576p/720p/1080i DVD system.
- Check your TV system setup correctly.
- Make sure your TV supports HDCP (High Bandwidth Digital Content Protection).

### DVD

No sound or only a very low-level sound is heard.

- Make sure that you select DVD mode.
- The system is in pause mode. Press the ► **PLAY** button to return to normal PLAY mode.
- Fast-forward or fast-reverse is performed. Press the ► **PLAY** button to return to normal play mode.
- The unit is too hot, shut off the unit for 30 minutes to cool it down.

No picture.

- The region number of the disc doesn't match the region number of this unit.



The picture is not clear.

- Clean the disc.
- The disc is scratched.

Severe hum or noise is heard.

- The plugs and jacks are dirty. Wipe them with a cloth slightly moistened with alcohol.
- Clean the disc.

The disc does not play.

- There is no disc inside ("No Disc" appears on the screen).
- Insert the disc correctly with the playback side facing frontwards.
- Clean the disc.
- A non-valid disc has been inserted. The unit and disc region number are incompatible.
- Condensation may have formed inside the unit due to a sudden change in temperature. Wait about an hour for it to clear and try again.
- It may not be possible to play CD-R/RW or DVD-R/RW in all cases due to the type of disc or condition of the recording. If you are having trouble playing a certain disc, remove the disc and try a different one. Improper formatted disc will not play on this DVD player.

No audio output during DVD playing.

- Press **AUDIO** button to select the desired audio format.

# SPECIFICATIONS



MODEL		L17LID648
LCD Panel	Panel Size	17" TFT LCD
	Brightness	180 cd/m <sup>2</sup>
	Contrast Ratio	400:1
Max. Resolution		1440 x 900
Input Connector	VIDEO/AUDIO(L/R)	1
	SCART	1
	HDMI IN	1
	DVD VIDEO OUT	1
	COMMON INTERFACE SLOT	1
	EARPHONE	1
	TV AERIAL TERMINAL	1
HDMI version		1.3a
Power Source		AC 230V-240V, 50Hz
Power Consumption		42W, standby < 1W
Dimension		440 x 129 x 366 mm
WEIGHT		3.40 kg

PREPARATION

CONNECTIONS

USING THE FEATURES

USING THE DVD FEATURES

TROUBLESHOOTING

SPECIFICATION

***Design and specifications are subject to change without notice.***



Visit [Partmaster.co.uk](http://Partmaster.co.uk) today for the easiest way to buy electrical spares and accessories. With over 1 million spares and accessories available we can deliver direct to your door the very next day.

Visit [www.partmaster.co.uk](http://www.partmaster.co.uk)  
or call  
**0870 6001 338**  
*(UK customers only)*  
Calls charged at National Rate.

Note : If you require a replacement for any of the items listed below, please quote their corresponding part number:	
Replacement Part	Part Number
Remote control	043-A55656W170
Lineout cable	122-000020W102
YUV SCART adaptor	138-RGB040W000
Quick Start Guide	810-711795W040
User's Manual	811-711791W040



Symbol on the product or in the instructions means that your electrical and electronic equipment should be disposed at the end of its life separately from your household waste. There are separate collection systems for recycling in the EU.

For more information, please contact the local authority or your retailer where you purchased the product.