

HITACHI
Inspire the Next

Instruction Manual

**19"/22" HD Ready LCD TV with Built-in
Digital Tuner and DVD Player**

L19D01 UB/UW/CB/CW

L22D01 UB/UW/CB/CW



GB

Safety Warnings

SOME DO'S AND DON'TS ON THE SAFE USE OF EQUIPMENT

This equipment has been designed and manufactured to meet international safety standards but, like any electrical equipment, care must be taken if you are to obtain the best results and safety is to be assured.

DO read the operating instructions before you attempt to use the equipment.

DO ensure that all electrical connections (including the mains plug, extension leads and inter-connections between the pieces of equipment) are properly made and in accordance with the manufacturer's instructions. Switch off and withdraw the mains plug before making or changing connections.

DO consult your dealer if you are ever in doubt about the installation, operation or safety of your equipment.

DON'T remove any fixed cover as this may expose dangerous voltages.

DON'T obstruct the ventilation openings of the equipment with items such as newspapers, tablecloths, curtains, etc. Overheating will cause damage and shorten the life of the equipment.

DON'T allow electrical equipment to be exposed to dripping or splashing, or objects filled with liquids, such as vases, to be placed on the equipment.

DON'T place hot objects or naked flame sources such as lighted candles or nightlights on, or close to equipment. High temperatures can melt plastic and lead to fires.

DON'T use equipment such as personal stereos or radios so that you are distracted from the requirements of traffic safety.

DON'T listen to headphones at high volume, as such use can permanently damage your hearing.

DON'T leave equipment switched on when it is unattended unless it is specifically stated that it is designed for unattended operation. Switch off using the switch on the equipment and make sure that your family knows how to do this. Special arrangements may need to be made for infirm or handicapped people.

DON'T continue to operate the equipment if you are in any doubt about it working normally, or if it is damaged in any way - switch off, withdraw the mains plug and consult your dealer.

ABOVE ALL

NEVER let anyone especially children push anything into holes, slots or any other opening in the case - this could result in a fatal electric shock

NEVER guess or take chances with electrical equipment of any kind...it is better to be safe than sorry!

***Note:** This product is exclusively available through Dixons Stores Group. In the unlikely event of a problem with your product please return to the store where your purchase was made.*

Safety Warnings



Power Source

The TV set should be operated only from a **100-240V~, 50/60Hz** outlet. Ensure that you select the correct voltage setting for your convenience.

Power Cord

Do not place the set or a piece of furniture on the power cord (mains lead) or pinch the cord. Handle the power cord by the plug. Do not unplug the appliance by pulling from the power cord and never touch the power cord with wet hands, as this could cause a short circuit or electric shock. Never make a knot in the cord or tie it with other cords. Power cords should be placed in such a way that they are not likely to be stepped on. A damaged power cord can cause fire or give you an electric shock. If it becomes damaged and needs to be replaced, it should be done by qualified personnel.

Moisture and Water

Do not use this device in a humid and damp place (avoid the bathroom, the sink in the kitchen, and near the washing machine). Do not expose this device to rain or water, as this may be dangerous and do not place objects filled with liquids, such as flower vases, on top. Avoid from dripping or splashing. If any solid object or liquid falls into the cabinet, unplug the TV and have it checked by qualified personnel before operating it any further.

Cleaning

Before cleaning, unplug the TV set from the wall outlet. Do not use liquid or aerosol cleaners. Use soft and dry cloth.

Ventilation

The slots and openings on the TV set are intended for ventilation and to ensure reliable operation. To prevent overheating, these openings must not be blocked or covered in anyway.

Heat and Flames

The set should not be placed near to open flames and sources of intense heat such as

an electric heater. Ensure that no open flame sources, such as lighted candles, are placed on top of the TV. Batteries should not be exposed to excessive heat such as sunshine, fire or the like.

Lightning

In case of storm and lightning or when going on holiday, disconnect the power cord from the wall outlet.

Replacement Parts

When replacement parts are required, make sure that the service technician has used replacement parts, which are specified by the manufacturer or have the same specifications as the original one. Unauthorized substitutions may result in fire, electrical shock or other hazards.

Servicing

Please refer all servicing to qualified personnel. Do not remove the cover yourself as this may result in an electric shock.

Waste Disposal

Instructions for waste disposal:

- Packaging and packaging aids are recyclable and should principally be recycled. Packaging materials, such as foil bags, must be kept away from children.
- Batteries, including those, which are heavy metal-free, should not be disposed of with household waste. Please dispose of used battery in an environment friendly manner. Find out about the legal regulations, which apply in your area.
- The cold cathode fluorescent lamp in LCD PANEL contains a small amount of mercury; please follow the local laws or regulations for disposal.

Disconnecting the Device

The mains plug is used to disconnect TV set from the mains and therefore it must remain readily operable.

Contents



■	Preparation	1
	Safety Warnings	1
■	Chapter 1 Introducing the LCD TV	4
	Package Contents	4
	Setting Your LCD TV	5
	Your LCD TV	6
	Remote Control	10
■	Chapter 2 Installing the LCD TV	13
	Connecting a TV Cable or Anterial	13
	Connecting an External DVD Player	16
	Connecting a VCR	17
	Connecting a TV box and satellite Receiver	18
	Connecting an Audio Receiver	29
	HDMI	20
	Using Conditional Access Module (CAM)	21
■	Chapter 3 Using The Features	22
	Basic Operation	22
	OSD Menu Operation	23
	The Audio Settings	23
	The Picture Setting	24
	The Setup Settings	25
	The Option Setting	26
■	Chapter 4 Using The TV Features	
	EPG (TV guide)	27
	Channel Installation	28
	Child Lock	29
	Channel Edit	30
	CI Information	31
■	Chapter 5 Using The DVD Features	32
	Using The Built-In DVD	32
	To Set Up Parental Control	33
	Picture CD Operations	34
■	Troubleshooting	35
■	Specifications	36
	Key Features	36
	Display Modes	37
	Specifications	38

Chapter 1 Introducing the LCD TV

Package Contents

Make sure all of the following contents are included.

- LCD TV

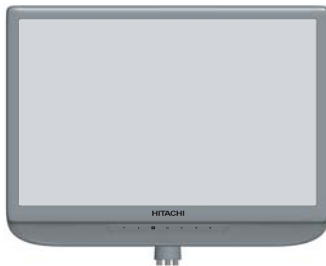

- Bottom Stand



(P.N.: FAEBAC05013)

- Remote Control/
AAA Batteries x 2



(P.N.: DQ795800202)

- Power Cord
(for UK model)



(P.N.: DM333181J45)



(for EU model)

(P.N.: DM33B181009)

- Screws/zipper bag



(P.N.: HADK9006029)

- User's Manual

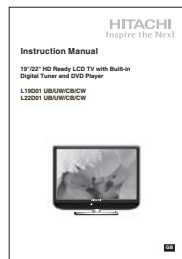

(P.N.: HDE9AC03012)

- Quick Start Guide

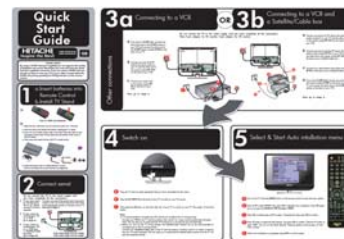

(P.N.: HDE9AC03012)

These items are all you need to set up and operate the LCD TV in its basic configuration.



Make sure all of the following contents are included. If there are any missing item, please return this product to the original place of purchase.

How to install the TV Stand

! Ensure the TV stand is still attached with the bottom foam packaging material in the package.

Read all instructions before continuing with the stand installation.

a. Open the box, and make sure all necessary parts are in the box. The package contains:

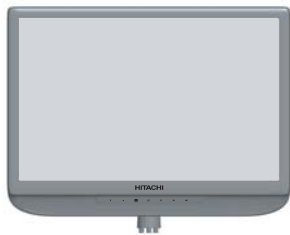

LCD TV



STAND

b. Peel off/ remove the plastic film before installing the TV stand.

c. Cover an even stable surface with a soft cloth. Place the LCD TV unit face-down on the cloth. Fit the stand onto the bottom of the LCD TV unit as shown:

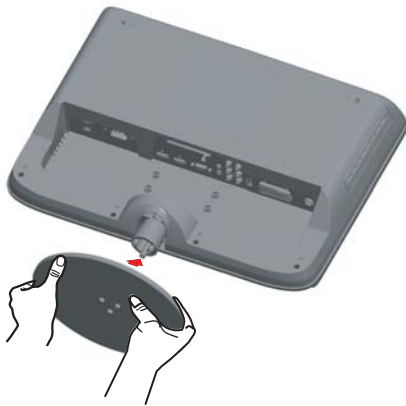

d. Then push until stand into the LCD TV's stand socket.

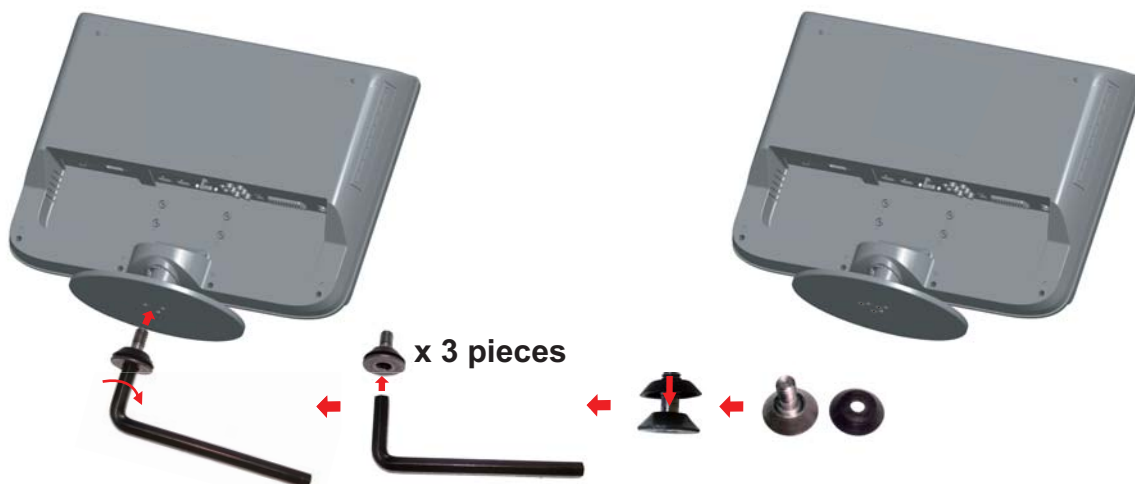

e. Attach the base to the TV stand with the 3 screws that are provided and ensure that they are tightened.

Your LCD TV



How to setup the TV

- 1 Use an antenna cable to connect to the LCD TV's ANT. terminal (refer to page 15).
- 2 Insert the 2 batteries supplied in remote control.

Step1 Press and lift the back cover up to open the battery compartment of the remote control.



Step2 Insert two AAA size batteries. Make sure to match the (+) and (-) ends of the batteries with the (+) and (-) ends indicated in the battery compartment. To close the battery compartment cover, slide the cover in the direction of an arrow till it clicks shut.



Do not use caustic cleaners (porcelain, stainless steel, toilet, or oven cleaner etc.) on the TV and remote control, as they may be damaged.

Handling the Remote Control

- Improper use could cause corrosion or battery leakage and may result in physical injury and/or property damage including fire.
- Never mix used and new batteries in the device.
- Replace all the batteries in a device at the same time.
- Remove the batteries if the remote control is not going to be used for an extended period of time.
- To avoid possible failure, read the following instructions and handle the remote control properly.
- Do not drop or cause impact to the remote control.
- Do not spill water or any liquid on the remote control.
- Do not place the remote control on a wet object.
- Do not place the remote control under the direct sunlight or near sources of excessive heat.

NOTE: Remove the battery from remote control handset when it is not to be used for a long period. Otherwise it can be damaged due to battery leakage.

- 3 Connect another external A/V device (refer to page 15-19).

Effective range

Your remote control can be activated from up to the LCD TV 5m away when pointed directly at the receiver.

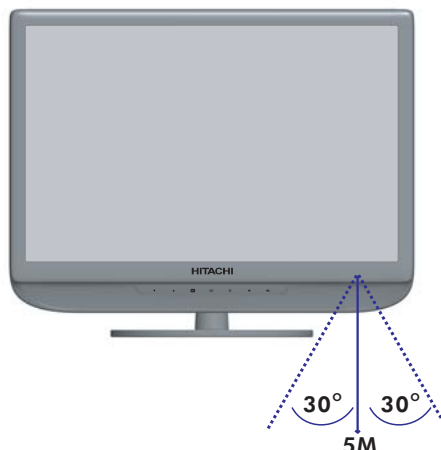

Front View and Controls

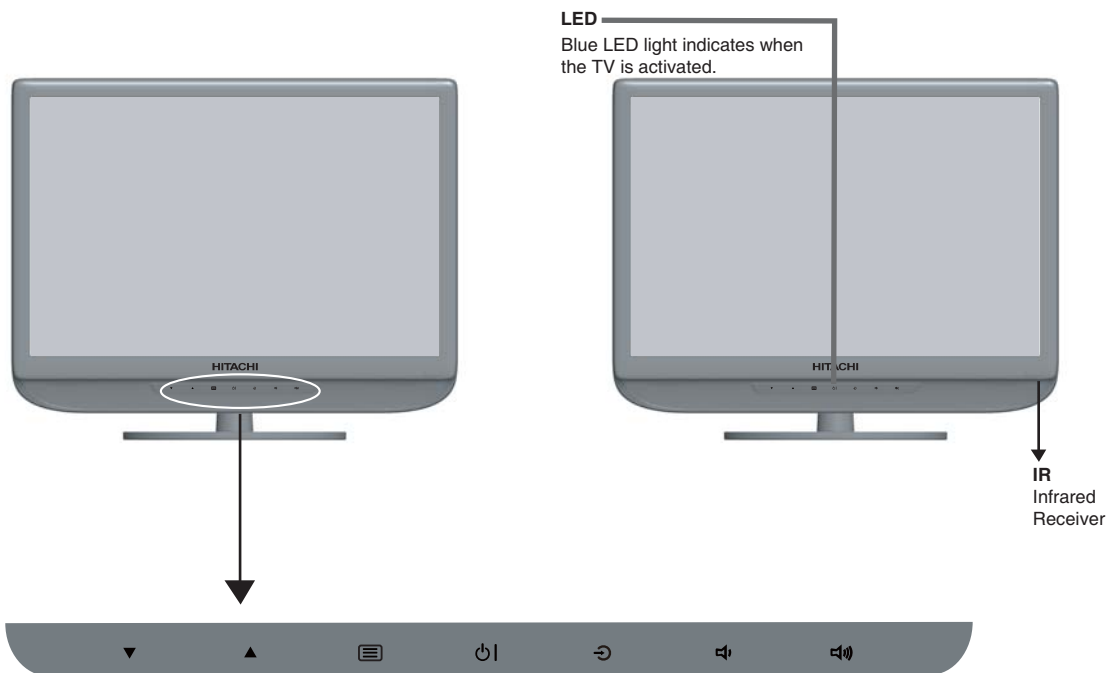

- **▼/▲**
Scan up and down through channels. Work as up-down navigation of sub-menu items when in the OSD mode.
- **☰**
Press once to display the OSD (on screen display), press again to turn the OSD off.
- **⏻**
Turn the LCD TV on and into standby mode.
- **↵**
Choose from different input signal sources. Work as Enter key selection when in the OSD mode.
- **🔊/🔇**
Adjust the volume up and down. Work as left-right navigation of main menu items and change values for when in the OSD mode.

Your LCD TV



Rear View and Sockets

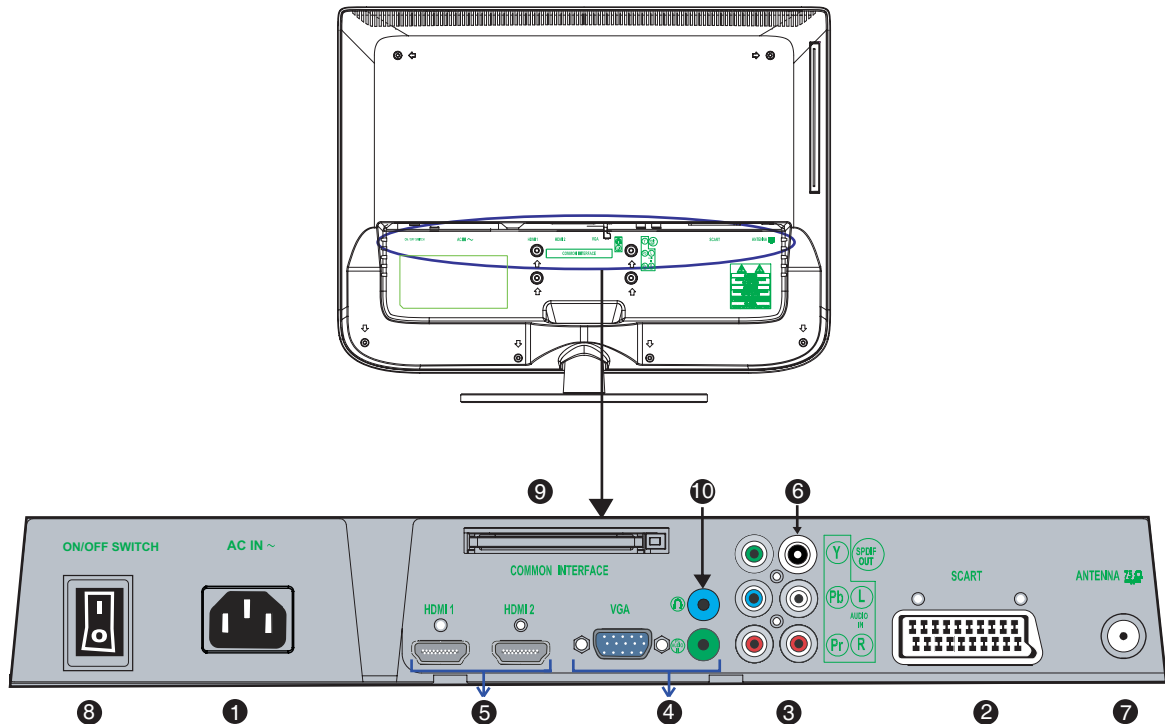

ITEM	DESCRIPTION
1 AC IN ~	Connect the AC power cord to this socket
2 SCART	Connect to external equipment with SCART socket. This SCART input allows audio and CVBS/RGB of an external device to be shown on your TV.
3 Y, Pb, Pr /AUDIO(L/R)	Connect to the component (Y, Pb, Pr) video sockets HDTV, or video equipment.
4 VGA /PC AUDIO IN	Connect to a PC or other devices with a VGA interface.
5 HDMI IN	Connect to devices with a HDMI interface.
6 SPDIF OUT	Connect to external digital audio equipment. (Only for DVD mode)
7 ANTENNA	Connect TV aerial here.
8 SWITCH	Control power ON / OFF of the unit. " " mark for Power ON ; "O" mark for Power OFF.
9 COMMON INTERFACE	Allow to use Conditional Access Module (CAM). [See page 21]
10	Connect to the external earphone for private listening.

Side View and Controls

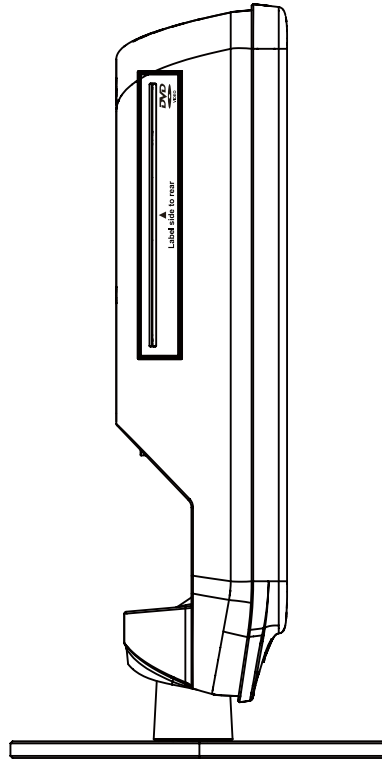

ITEM	DESCRIPTION
SLOT-TYPE DVD PLAYER	Any of the following disc types are playable on the DVD player: CD-R, CD-RW, DVD-R, DVD-RW, DVD+R, and DVD+RW. (DVD mode) (Support 8-inch size Disk only)

Note:

Play may be impossible in some cases due to the condition of the recording, disc types, and disc qualities.

Your Remote Control

Your Remote Control

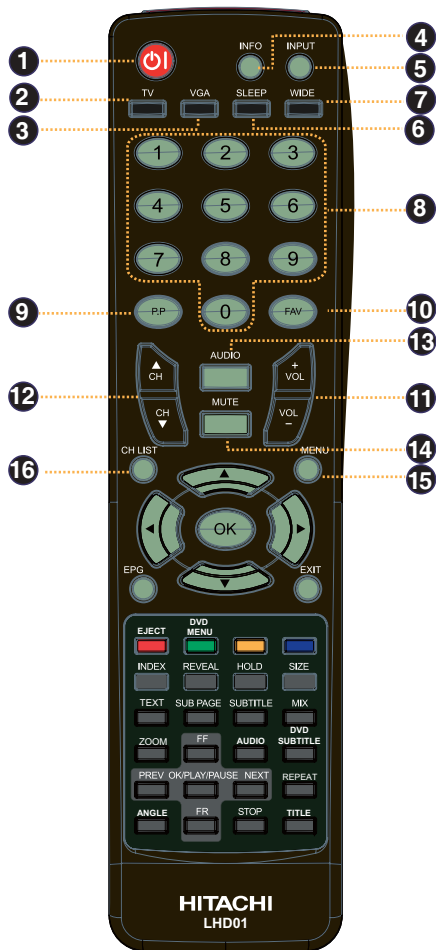

- 1 POWER**
Turn the LCD TV on and into standby mode.
- 2 TV**
Direct access of TV input.
- 3 VGA**
Direct access of VGA input
- 4 INFO**
Press once to display a variety of information such as the current channel and the input source.
- 5 INPUT**
Select the signal sources: TV-> (SCART)-->(YPbPr) -> HDMI1 -> HDMI2-> VGA-> DVD
- 6 SLEEP**
Cycle through the LCD TV sleep timer: OFF, 30, 60, 90 or 120 mins.
- 7 WIDE**
Select the view mode:
16:9, Automatic, Full Screen, 4:3
- 8 0-9**
Select and switch to a channel by using **0-9** buttons.
- 9 P.P**
Return to last source or TV program
- 10 FAV**
Display the favorite list menu
- 11 VOL.+/-**
Increase and decrease volume.
- 12 CH. ▲/▼**
Change the channels up and down.
- 13 AUDIO**
Change the audio language or audio channel.
- 14 MUTE**
Mute and restore your LCD TV sound.
- 15 MENU**
Display the OSD menu on the screen.
- 16 CH.LIST**
Display the channel list menu.

Your Remote Control

Your Remote Control

17 ▲▼◀▶ OK

The TV navigation buttons allow you to move, select a variety of information such as the current channel and the input source.

18 EPG

Turn EPG on/off.

19 EXIT

Exit the OSD menu (On Screen Display).

20

Access the TELETEXT items or correspond to the differently coloured page numbers.

EJECT

Press to eject the disc

DVD MENU

Press the button to display the DVD disc menu.

21 INDEX / REVEAL / HOLD / SIZE

INDEX

Display the main index in Teletext mode.

REVEAL

Reveal hidden information such as the answer to a quiz in Teletext mode.

HOLD

To hold the Teletext page when viewing multi-page information. Press Hold again to return to automatic page update.

SIZE

Display the top, bottom or all of page to easily read in Teletext mode.

22 TEXT / SUB PAGE / SUBTITLE / MIX

TEXT

Turn Teletext On / Off or Run/Terminate MHEG application.

SUB PAGE

Select the sub-page directly in Teletext mode.

SUBTITLE

Press the SUBTITLE button to display the subtitle which is broadcast with the program on the screen.

MIX

Turn Teletext in MIX mode.

23 AUDIO / DVD SUBTITLE

AUDIO

Change the audio language or audio channel. (DVD mode)

DVD SUBTITLE

Press the button to change subtitling feature. (DVD mode)



Effective range: The remote can control the LCD TV from up to 5m away when pointed directly at the receiver.

Your Remote Control



Your Remote Control

24 ZOOM

Zoom-In/Zoom-Out the displayed frame. (DVD mode)

25 FF, FR, PREV, NEXT, OK/PLAY/PAUSE (▲/▼/◀/▶/OK)

The DVD navigation buttons allow you to move, select a variety of information such as the DVD disc menu. (DVD mode)

FF/FR

Press to advance or rewind playback rapidly. (DVD mode)

PREV

Press to skip to the beginning of the currently played chapter or track. (DVD mode)

NEXT

Press to skip to the beginning of the next chapter or track. (DVD mode)

OK/PLAY/PAUSE

Press to start playback or pause. (DVD mode)

26 REPEAT

Press to repeat the chapter or track. (DVD mode)

27 TITLE

Press the button to display the DVD title content. (DVD mode)

STOP

Press to stop playback. (DVD mode)

28 ANGLE

Allow you to view the different angle. (DVD mode)



Chapter 2 Installing the LCD TV



Connecting a TV Cable or an Antenna

Refer to the owner's manual of any external equipment for connection procedures.

When connecting any external equipment, do not connect any AC power cords to wall outlets until all other connections are completed.

Cable TV (CATV) Connection

- **Some cable TV companies offer premium pay channels. Since the signals of these premium pay channels are scrambled, a cable TV converter/descrambler is generally provided to the subscriber by the cable TV company. Your cable TV provider will advise you on how to connect the cable TV box to your TV.**

Disconnecting from the Mains



The **STANDBY**  button on the front view and also on the remote control is only used for turning on the TV to standby mode, it does not disconnect the device from the mains supply.

To completely disconnect the main voltage, please switch off the power switch on the rear of the TV, or remove the power plug from the socket.

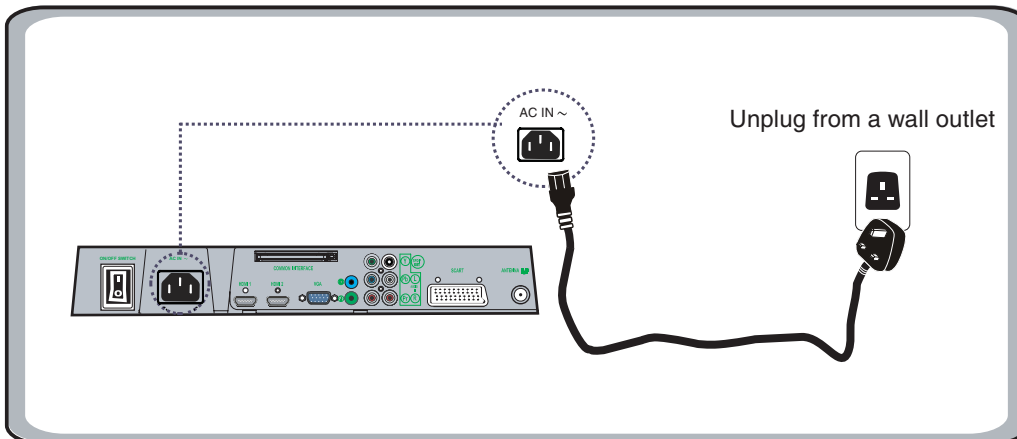
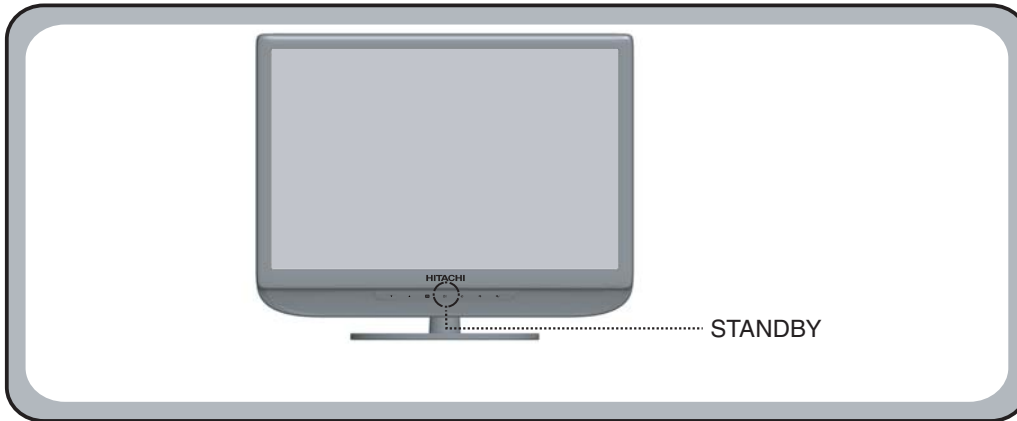



Connecting a TV Cable or an Antenna

Refer to the owner's manual of the external equipment to be connected. When connecting external equipment, do not connect any AC power cords to wall outlets until you have completed all the connections.

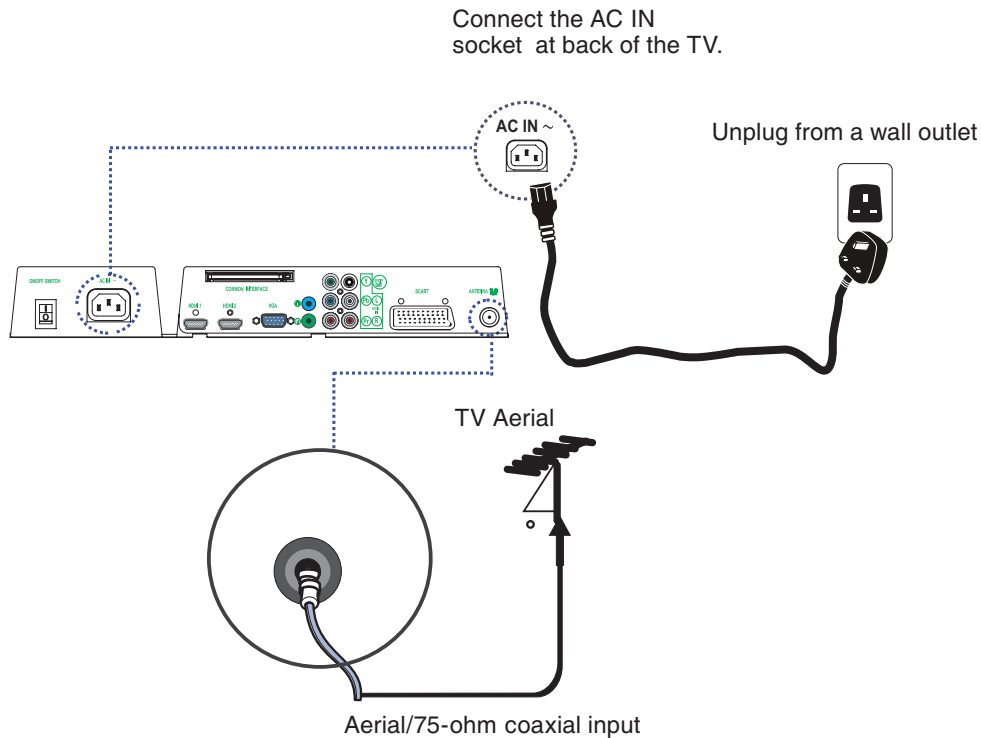
Basic Connection: Connecting an aerial



- 1 Connect your existing TV aerial to the Aerial input socket on the TV. The Aerial input socket can be connected with the ATV/DTV Aerial. A good quality outdoor aerial is recommended.
- 2 Insert the supplied mains cable to the mains socket located on the rear of the TV. Connect the other end of this cable to the mains socket.
- 3 Connect all AC power sources before turning on the power switch at the back of the TV.
- 4 Turn the POWER SWITCH in position "I" of rear TV, and the red light will show on the front panel of the TV.
- 5 Press the **STANDBY**  button on your remote to turn on your LCD TV. The red light will change to blue light.
 - a. Press **MENU** button on the remote to enter Control Menu. Press **▲** or **▼** to select SetUp.
 - b. Press the **OK** button to confirm the entry of the submenu. Auto Installation will highlight in red, then press **OK** button to confirm and input the PIN "0000" to the submenu. Press **▲** or **▼** to select your chosen country, and press **OK** to confirm the selection. Press **▼** button again to start the search. Press **OK** to enter the submenu, then select **YES** and **OK** to start the scanning.
 - c. After a few minutes, you will see the TV programmes briefly as each channel is received and stored in the memory. When it is completed, press CH. **◀/▶** buttons to view the stored channels.
 - d. To power off press the **STANDBY**  button, and the  blue illuminated symbol will change to red.

Connecting an External DVD Player

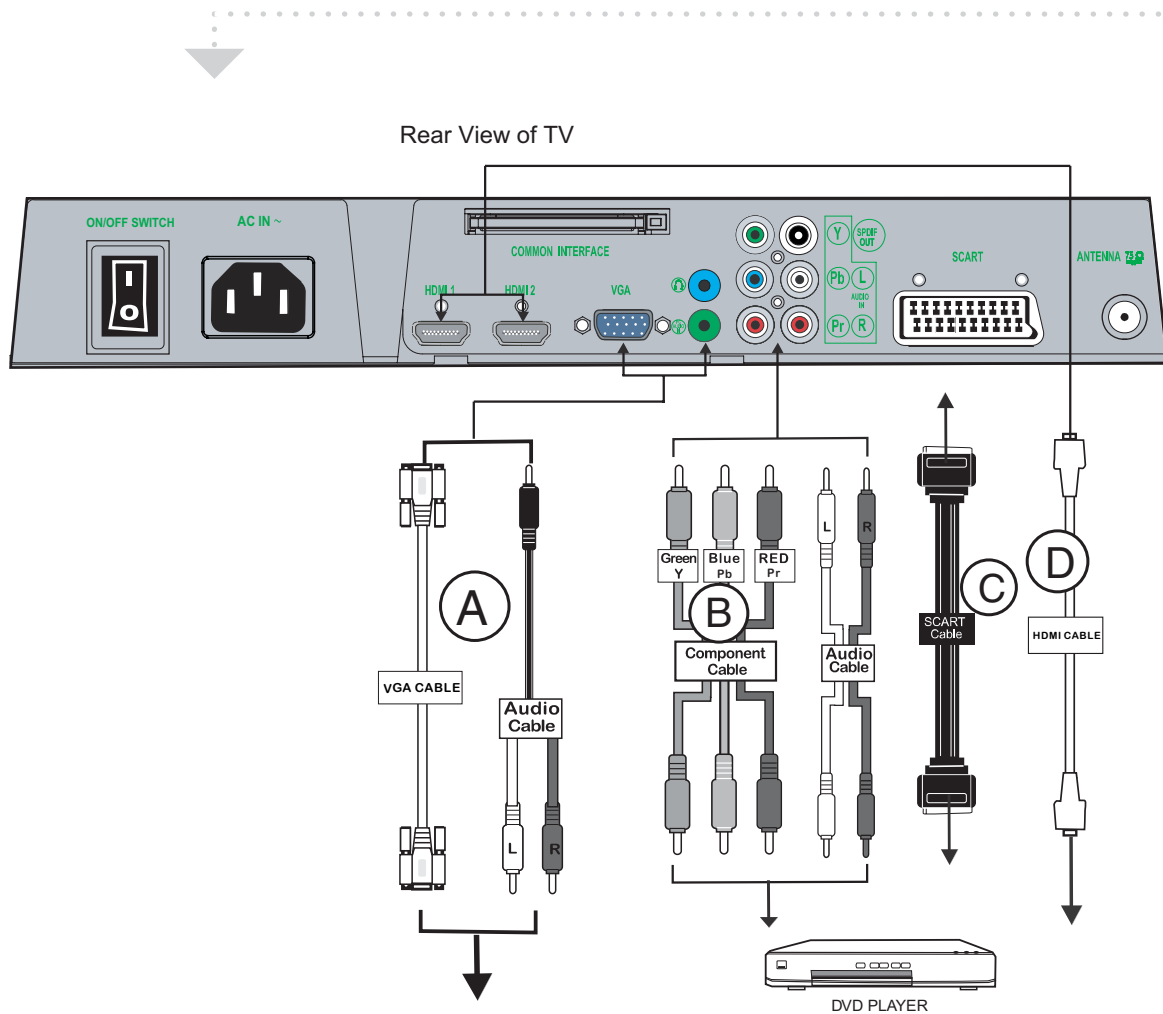

After connecting an aerial to your LCD TV and connecting the mains cable to the TV

- 1** **METHOD A**
Use a VGA 15 pins cable to connect the TV Cable Box's RGB output sockets to your LCD TV.
Use a 3.5mm socket to RCA adapter cable for connecting audio.

METHOD B
Use a Component cable to connect the AV (Y Pb Pr) sockets on the DVD player to your LCD TV.
Use an Audio cable to connect the DVD's audio output sockets to your LCD TV.

METHOD C
Use a SCART cable to connect the DVD's SCART socket to the LCD TV's SCART socket.

METHOD D
Use a HDMI cable to connect the Satellite Receiver HDMI connector to your LCD TV.
- 2** Connect all AV power sources before turning on the power switch of the LCD TV or other connected equipments.
- 3** Press the **STANDBY**  button to turn on your LCD TV.
- 4** To watch DVD, press the **INPUT** to Select DVD Mode.

Connecting a VCR

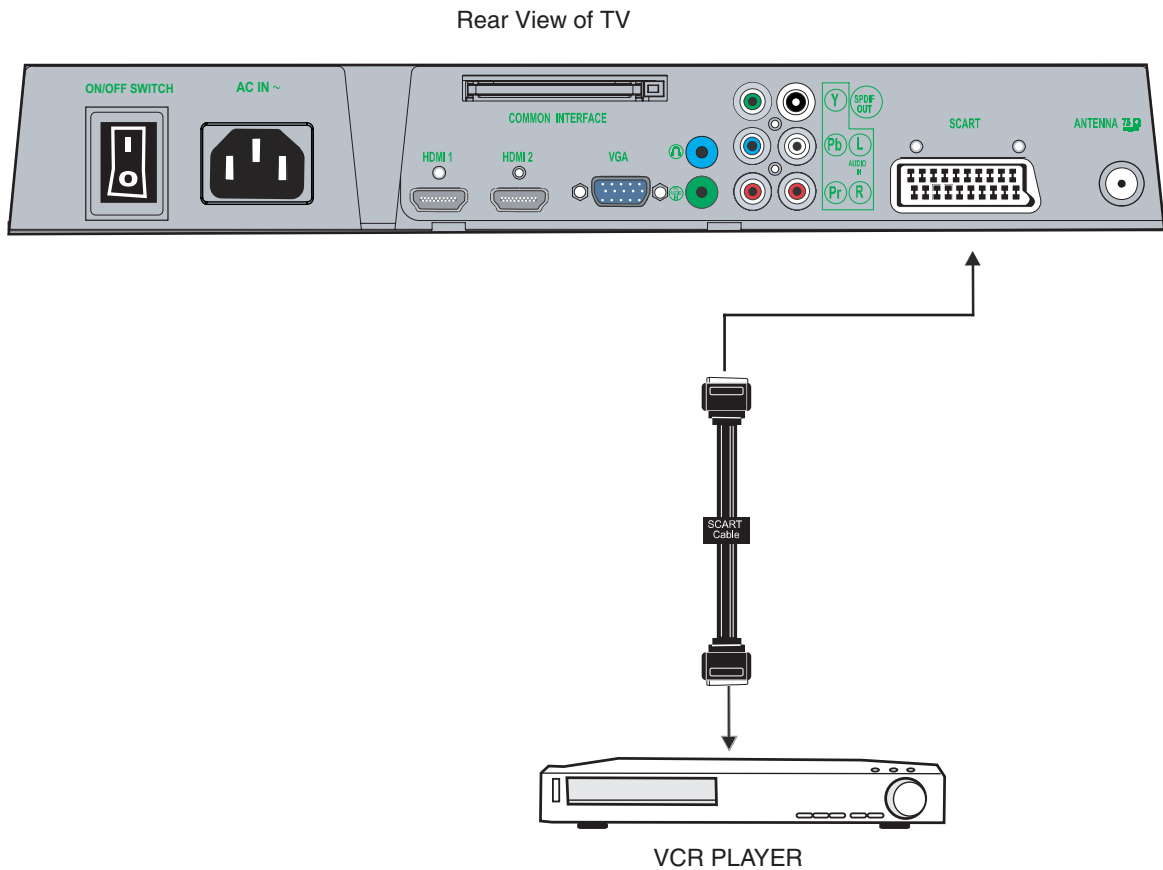

- 1 METHOD (AV1)**
Use a SCART cable to connect the VCR's SCART socket to the LCD TV 's SCART socket.
- 2** Connect all AV power surces before turning on the power switch of the LCD TV or other connected equipments.
- 3** Press the **STANDBY**  button to turn on your LCD TV.
- 4** To watch VCR, press the **INPUT** button to select SCART.

Connecting a TV Cable Box or Satellite Receiver

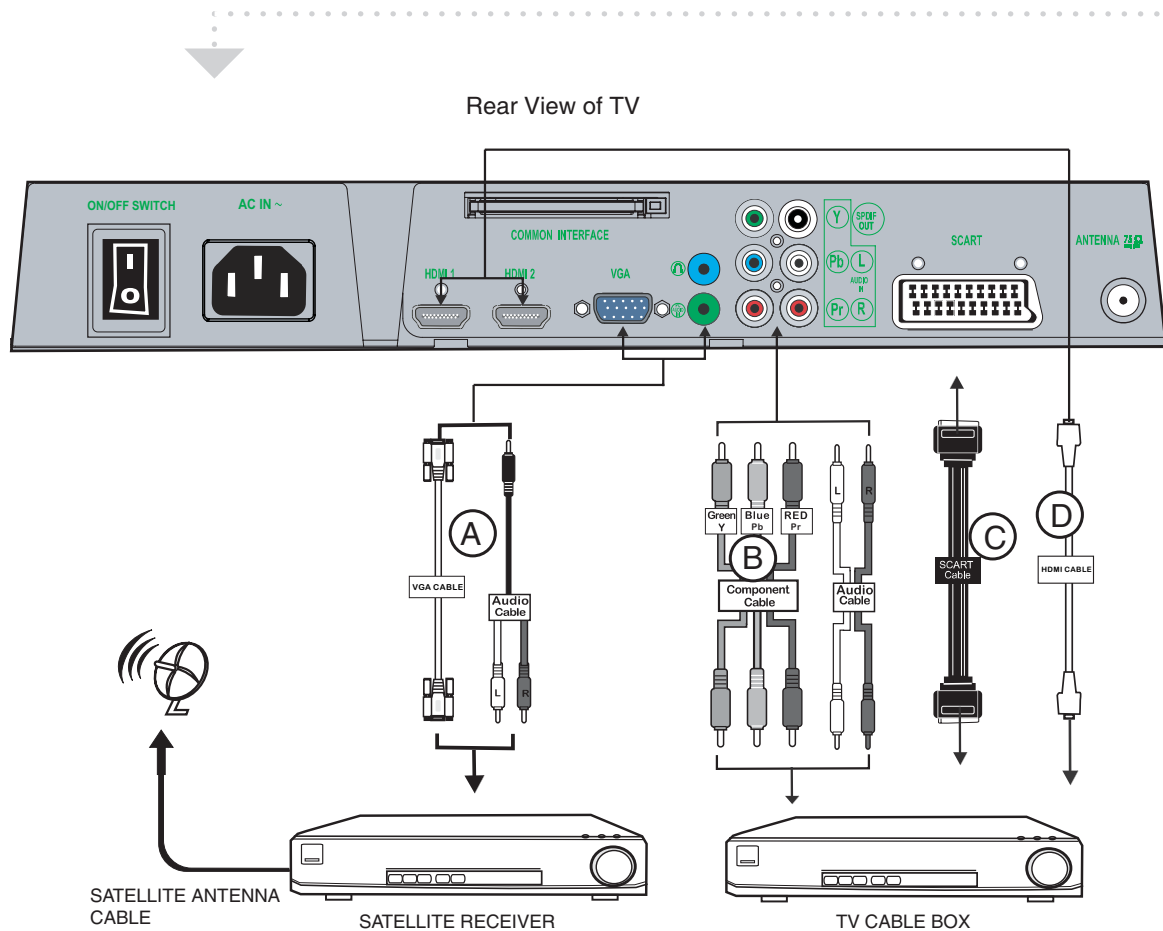

- 1 Method A :**
Use a VGA 15 pins cable to connect the TV Cable Box's RGB output sockets to your LCD TV. Use a 3.5mm socket to RCA adapter cable for connecting audio.

Method B :
Use a Component cable to connect the Y/Pb/Pr sockets on the TV Cable Box to your LCD TV. Use an Audio cable to connect TV cable box's audio output sockets to LCD TV.

Method C :
Use a SCART cable to connect the TV Cable Box's SCART socket to the LCD TV's SCART socket.

Method D :
Use a HDMI cable to connect the Satellite Receiver HDMI connector to your LCD TV.
- 2** Connect all AV power sources before turning on the power switch of the LCD TV or other connected equipments.
- 3** Press the **STANDBY**  button to turn on your LCD TV.
- 4** To watch TV cable box, press the **INPUT** button to select SCART, AV (Y Pb Pr) , HDMI1, HDMI2, and VGA.

Connecting an Audio Receiver

For better sound quality, you may want to play the LCD TV audio through your stereo system.

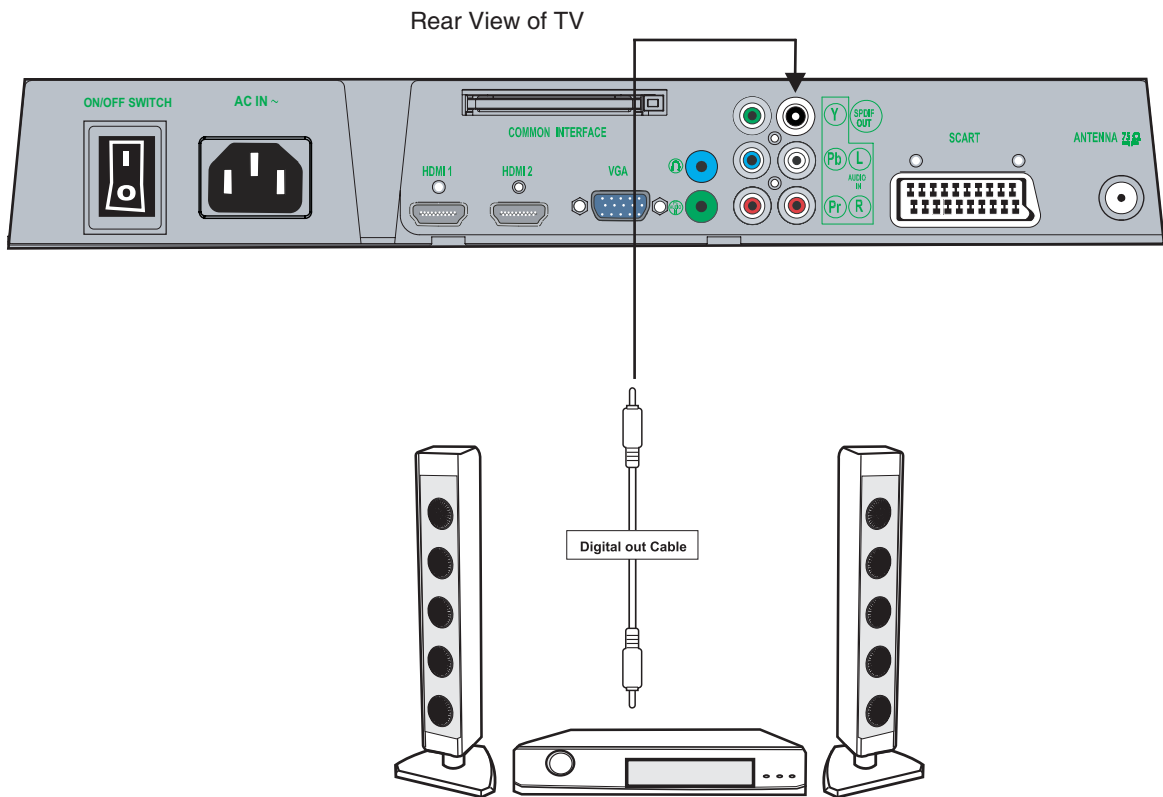

- 1 Use coaxial cable to connect the audio receiver's coaxial LINE-IN sockets to LCD TV's SPDIF OUT sockets (Only for DVB-T).
- 2 Connect all AV power sources before turning on the power switch of the LCD TV or other connected equipments.
- 3 Press the **STANDBY**  button to turn on your LCD TV.

HDMI



- This TV can accept High-Definition Multimedia Interface (HDMI).
- This TV SET supports HDCP (High-Bandwidth Digital Content Protection) Protocol for TV SET (480p, 576p, 720p, 1080i) modes.
- When you connect to the output of an HD ready player (DVD Player, Set Top Box or PC) switch to the HDMI function and the TV will automatically detect the resolution used by the HDMI source.
- To get the best picture quality, adjust the DVD Player or Set Top Box output resolution to 1280 x 720p.
- To get the best picture quality, adjust the PC graphics card to 1024 x 768, 60Hz.

How to connect

If Source Devices have HDMI Output , connect to the HDMI socket located at the rear of the TV using the HDMI Cable supplied with your external device. (HDMI sends Digital Video and Audio with one cable.)

Cable sample



HDMI Cable
(not supplied with the product)

Using Conditional Access Module (CAM)

The **Conditional Access Module (CAM)** menu provides access to functions contained on the CAM. The module can be inserted into the **Common Interface (CI)** slot located at the backside (facing downwards) of the TV.

A **conditional access module (CAM)** is an electronic device, usually incorporating a slot for a smart card, which equips a DVB television or set-top box with the appropriate hardware facility to view conditional access content that has been encrypted using a conditional access system. They are normally used with direct broadcast satellite services, although the UK digital terrestrial pay TV supplier Top Up TV also uses CAMs.

Note

This Conditional access module (CAM) does not come with the TV set. It can only be obtained when you subscribe to service providers like Pay TV or other service providers.

IMPORTANT

Always switch the TV off before inserting or removing the module.

Inserting the CAM

1. Switch off the TV.
2. Some modules come with a viewing card. When using this type of module, first insert the viewing card into the module. Ensure that the arrow on the viewing card faces the arrow of the module before inserting into the module slot.
3. Insert the module into the Common Interface (CI) slot on the TV at the rear panel.
4. Switch on the TV.
5. Press the **MENU** key to display the OSD menu.
6. Use the **▲/▼** key to highlight “**Setup**” menu and press the **OK** key.
7. Press the **▲/▼** key to enter into the “**CI information**” menu and press the **OK** key
8. Press **▲/▼/OK** key as indicated on the screen to access the CAM's functions.

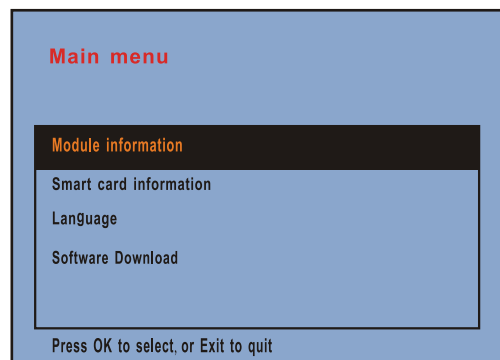

IMPORTANT

If no module is inserted, the Conditional Access Module menu will display "Scrambled Program". If the module is not inserted properly, a warning message will show on the screen to remind the users. If you have inserted a module, please ensure it is fully inserted in the correct manner as mentioned in Step 2 above. The functions that now appear on screen are dependent on the contents of the selected Conditional Access Module in your country. Refer to the instruction supplied with the module or contact the vendor.

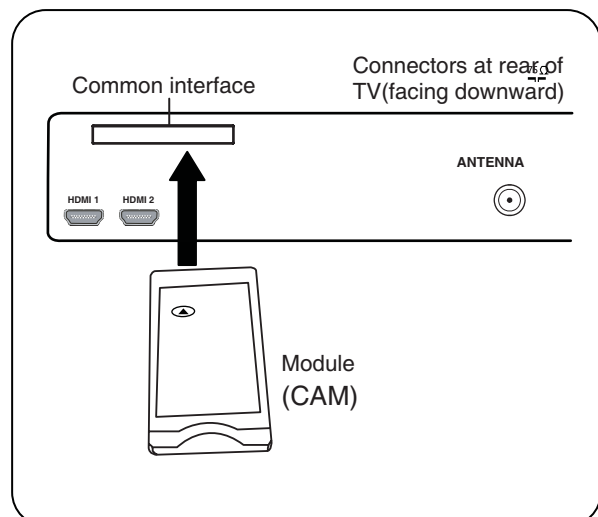

Chapter 3 Using The Features

BASIC OPERATION

Tuning in the TV channels

- After connecting an aerial to your LCD TV and connecting the mains cable to the TV and 100-240V AC mains socket, turn the POWER SWITCH on (the I position) at the rear panel of the TV, and the red light will show on the front centre panel of the TV.
- Press the **STANDBY** button, and the red light will change to blue and the Installation screen will show:

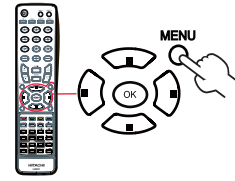

MENU → **Audio** → **Setup** → **Auto installation** → **PN "0000"** → **Country select** → **Start Search** → **OK**

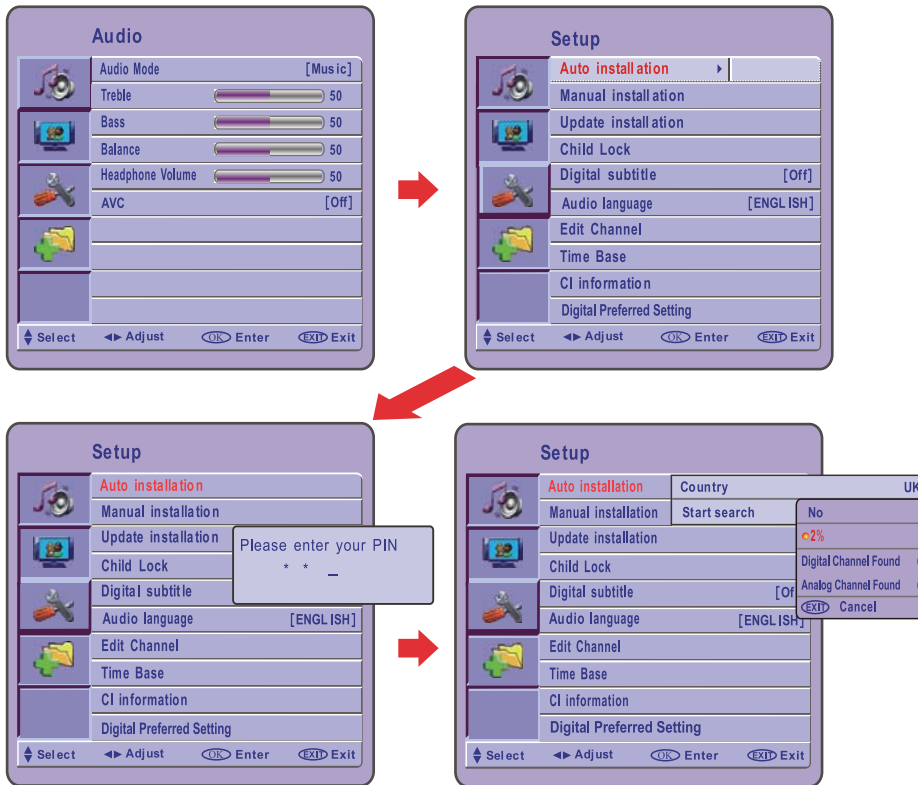

1. Make sure an aerial is fitted then press **MENU** button on the remote to start the "Auto Installation". (The default PIN is "0000")
 2. After a few minutes, you will see the TV programs briefly as each channel is received and stored in the memory.
- To power off press the **STANDBY** button, the blue light will change back to red.

Selecting a Source

- Press the **INPUT** button to display the function required (TV/SCART/AV(YPbPr)/HDMI1/HDMI2/VGA).

Select TV Channel

- Press the **CH.** ▲/▼ buttons on the remote control or the ▲/▼ buttons on the LCD TV to change the TV channels.
- You can directly select the TV channel required by pressing 1, 2, or 3 etc on the remote button pad.

Adjusting the Volume

- Press the **VOL.** +/- buttons on the remote control or the 🔊/🔇 buttons on the LCD TV to adjust the volume.



Note

Adjust the volume level to its minimum first, and then slowly increase the volume to your desired level.

To Mute the Sound

- Press **MUTE** and the sound cuts off.
- To turn mute off, press the **MUTE** button again, or simply press the **VOL. +/-** buttons.

Sleep Timer

- Press the **SLEEP** button continuously to select the sleep timer or turn the sleep timer from the OFF, 30, 60, 90 or 120 minutes. When the LCD TV has reached the set time, it will automatically turn off. If the TV has no input signal, it will automatically power down to standby after 15 minutes

OSD Menu Operation

1 The main menu provides access to the following menus:



Audio	Adjust Audio setting such as Audio Mode, Treble, Bass, Balance, Headphone Volume AVC(Auto Volume Control)
Picture	Adjust picture setting such as Picture Mode, Contrast, Brightness, Colour, Hue(NTSC), Sharpness, Phase, Colour Temp, Digital Processing.
Setup	Adjust Channel setting such as Auto Installation, Manual Installation, Update Installation, Child Lock, Digital subtitle, Digital language, Edit Channel, Time Base and CI information.
Option	Adjust preferences such as OSD language, Sleep Timer and Default.

2 Press the **MENU** button on the remote control. The main menu will appear on the screen.

3 Use **▲/▼** buttons to highlight your main menu option, then press **OK** button to enter your selected option.

Use **▲/▼** buttons to highlight an option of the sub-menu. Use **◀/▶** buttons to change the value of the item. Press the **EXIT** button to exit menu.

Audio

Use the Audio setting menu to adjust the audio quality which best corresponds to your listening requirements. The Audio Menu includes the following options:



Audio Mode	There are five options available: Movie/ Multimedia/ Music /Speech/Personal.
Treble	Adjust treble for enhancement of high frequency output.
Bass	Adjust Bass for enhancement of low frequency output.
Balance	Adjust the balance of the left or right speaker.
Headphone Volume	Adjust the Headphone volume.
AVC	Auto Volume control

OSD Menu Operation

Picture

Use the Picture setting menu to adjust the picture quality which best corresponds to your viewing requirements. The Picture Menu includes the following options:

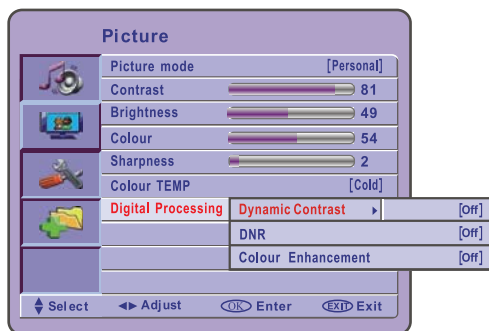

OPTION	DESCRIPTION
Picture Mode	Custom: Select for user's settings. The items of video can be adjusted when the picture mode is for user's settings except advanced item. There are six options available: <ul style="list-style-type: none"> ECO Brilliant and sharp picture settings with economical energy consumption. Rich Brilliant and sharp picture settings suitable for bright environment. Natural Reference mode for living room conditions and average signals. Soft Intended for bad-quality signals. Suitable for living room viewing. Multimedia Best for multimedia graphical applications. Personal Pictures settings are set to your preference.
Contrast	Adjust the difference between the brightness and darkness regions of the picture.
Brightness	Adjust to increase or decrease the brightness.
Colour	Allows to adjust the colour from 0 to 100.
Hue (NTSC)	Allows you to adjust the colour tint of the picture.(Only for NTSC)
Sharpness	Adjust to sharpen or soften the picture.
Colour TEMP	Allows you to adjust the Colour Temperature to be Cool, Warm, Normal.
Digital Processing	Allows you to adjust the following to be Off, Min, Mid, or Max.: <ul style="list-style-type: none"> Dynamic Contrast DNR (Dynamic Noise Reduction) Colour Enhancement

OSD Menu Operation

Setup

Use this Setup menu to Setup Channel. Use the ▲/▼ buttons to highlight the required setting. Press OK button to select the function. Use ◀/▶ buttons to adjust the settings. Press OK button to save the adjustment.



Auto Installation	Allows to do the Channel Installation automatically. Country: Belgium, Czech Rep, Denmark, Finland, France, Germany, Greece, Hungary, Italy, Netherlands, Norway, Poland, Portugal, Slovakia, Spain, Sweden, Switzerland, UK, and Others.
Manual Installation	Allows you to adjust the manual search by hand if signal is too weak or picture is blurry. Country: Please refer to the above Country listing in Auto Installation section. System: Allow you to select the sound standard : DK PAL D/K (East Europe) . BG PAL B/G (Europe / East Europe). I PAL I (U.K. / Ireland) . L SECAM L (France) . Programme Analog search Digital search
Update Installation	Allows you to update the channel.
Child Lock	Allows you to select the childlock to be on or off. (Default password is 0000.) Allow you to select the Age Rating and to change Password.
Digital subtitle	Set the Audio and Subtitle language under User Settings.
Audio language	Set the Audio and Subtitle language under User Settings.
Edit Channel	Allows you to edit the channel list: Rename: Allow you to rename the channel Uninstall: Allow you to skip the channel
Time Base	Allows you to set the Date and Time. The Daylight Savings feature will allow you to observe the Summer Time, and the TV will calculate the clock adjustment for it.
CI Information	Allows to view the CI information.
Digital Preferred Setting	Allows you to set up preferred Audio / Subtitle



OSD Menu Operation



(Only for VGA)



Auto Adjust	Allows to auto synchronize VGA signal.
H-Position	Allows you to adjust the Horizontal Position of the picture.
V-Position	Allows you to adjust the Vertical Position of the picture.
Frequency	Allows you to improve focus clarity and image stability.
Phase	Allows you to improve focus clarity and image stability.

Option

Use this Option setting menu to set up some features: OSD language, Sleep Timer, and OSD Reset.



Language	Allows you to select the OSD to be English / French / Italian / Danish / Finnish / Slovak / Swedish / Greek / Polish / Czech / Hungarian / Norwegian.
Sleep	Allows you to select the sleep timer to be Off, 30 min, 60 min, 90 min, or 120 min.
Default	Allows you to restore back to the factory settings.

EPG (TV Guide)

The TV guide is an Electronic Programme Guide that provides you with a quick and easy way to view a complete list of digital programmes as you would in a newspaper or TV magazine. You can navigate through the list of digital programmes and obtain detailed information on the programmes.

- 1 Press the **EPG** key on Remote Control to display the TV guide :

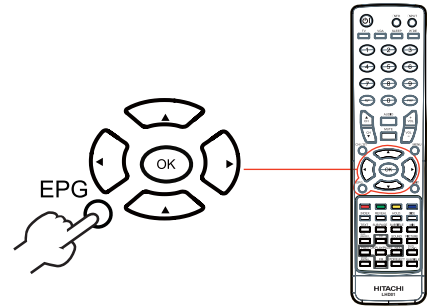

A list of all the digital programmes in the currently selected channel list is displayed.

- 2 Use the **▲/▼** keys to select a programme.
- 3 The TV guide features are displayed at the bottom of the screen. Use the coloured keys **Red** and **Blue** on the remote control to activate them.

(**EPG** is an information system broadcast by certain channels which can be consulted like a newspaper. It also offers access to subtitles for viewers for more details.)

- 4 Press the **EPG** key or **EXIT** key to exit the menu.

Setting up your list of Favourite Channels

This menu enables you to create a Favourite List with your preferred TV channels and radio stations.

- 1 Press **FAV** button on the Remote Control to enter into the favourites list menu.
- 2 Use **◀** to add this programme into the Favourite List. (ATV means analogue channels)
- 3 Use **▶** to delete the programme from the Favourite List.
- 4 Press **OK** to confirm section.
- 5 Press the **FAV** key or **EXIT** key to exit the menu.

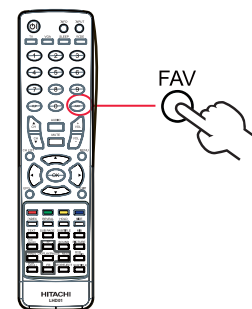

Using The TV Features

CHANNEL INSTALLATION

Use these options (Auto Installation, Manual Installation, and Update Installation) if you have moved to another location or want to rescan for new channels.

Press the **MENU** button on the remote control or the **MENU** button on the control panel. Use the **▲/▼** keys to select Setup function.

Auto Installation

This menu allows you to automatically search for all the programmes available in your region.

If you want the TV to do auto search for the channels, use the **▲/▼** buttons to highlight the **Auto Installation** and press **OK** button to confirm. You can choose the installation type by using the **▲/▼** buttons. Press the **OK** button to start the installation process. The new channels will be listed in the channel list. (The default PIN is "0000")

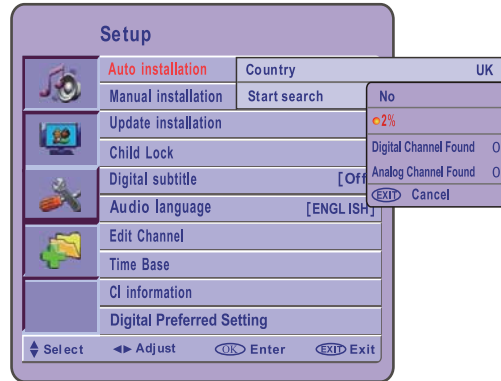

Manual Installation

If you want to install the channels by yourself, use the **▲/▼** buttons to highlight the **Manual Installation** option, and press **OK** button to install manually. First, you should choose the installation type - **Manual Installation**, then you will see the following menu. (The default PIN is "0000")



Update Installation

If you want to update current channels and would like to keep existing channels.

First, you should choose the installation type - **Update Installation**, then you will see the following menu. (The default PIN is "0000")



Using The TV Features

Child Lock

The program will be locked when you select the On option in the Child Lock menu.

- 1 To display the channel that you would like to Lock.
- 2 Press the **MENU** button on the remote control or the **MENU** button on the control panel. Use the **▲/▼** keys to select Setup function then press **OK** key to access.
- 3 Press the **▲/▼** keys to select the Child Lock then press **OK** key to access.
- 4 Enter the Default PIN number "0000".
- 5 Press **▲/▼** and **OK** keys to select On or Off option.
- 6 Press **OK** key again to activate/deactivate your chosen option.
- 7 To return to previous menu, press the **EXIT** key.
- 8 To exit the menu, press the **EXIT** key.

The TV can still be operated by using the remote control. Please enter the PIN. (The default PIN is "0000") Or you can select the Change Password mode to change the password.

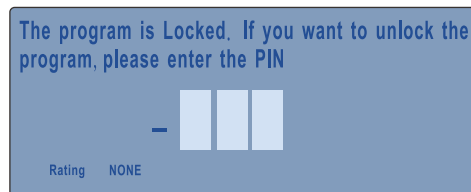

(The default PIN is "0000")



Note

Record your password in some secure, easy-to-find place. We assume no responsibility for lost, misplaced or forgotten passwords.

Digital Subtitle

Allow you to select the subtitle language in digital channels.

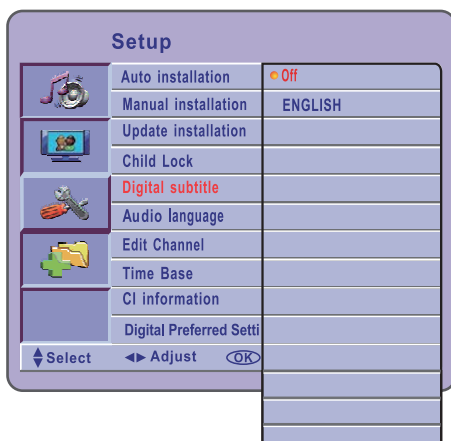

Using The TV Features

Audio Language

Allow you to select the audio language in digital channels.



Channel List

When you finish **CHANNEL INSTALLATION**, you can press **CH LIST** key on the Remote Control to view all channels. Use the **▲/▼** keys to select a programme.

(ATV means analogue channels)

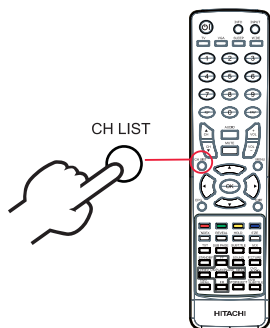

CHANNEL EDIT

First, you should choose the Setup menu and highlight **Edit Channel**, then you will see the following menu. Press **OK** to enter.

Naming of Channel

If preferred, you can assign a name to the TV channel.

- 1 Press the **▲/▼** keys to select the channel you want to rename.
- 2 Press the **RED** key to enter Rename mode. Press again to Cancel the Rename mode
- 3 Press the **▲/▼** keys to select the characters and press the **◀/▶** keys to move around the name display area.
- 4 Press **OK** key to store the new name.
- 5 To return to previous menu, press the **EXIT** key.

(ATV means analogue channels)



Uninstall of Channel

This feature allows you to skip programmes that you do not watch.

- 1 Press the **▲/▼** keys to select the channel you want to Uninstall.
- 2 Press the **GREEN** key to uninstall. Press the **GREEN** key again to cancel the uninstallation.
- 4 Press **OK** key to store the new setting.
- 5 To return to previous menu, press the **EXIT** key.

Using The TV Features

Time Base

Allow you to set the system time:

Date and Time: User Settings.

Time zone: allow you to adjust and offset local time

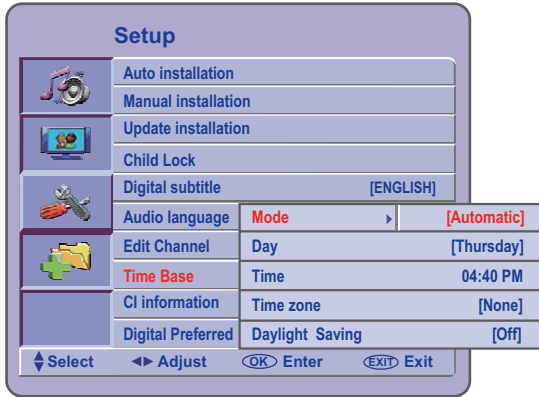

CI Information

Note: CAM Module and Card must be inserted prior viewing the CI information.

Allow you to view the CI information.

1. Press the MENU key to display the OSD menu.
2. Use the ▲/▼ key to highlight “**Setup**” menu and press the **OK** key.
3. Press the ▲/▼ key to enter into the “**CI information**” menu.
4. Press **OK** key as indicated on the screen to access the CAM’s functions

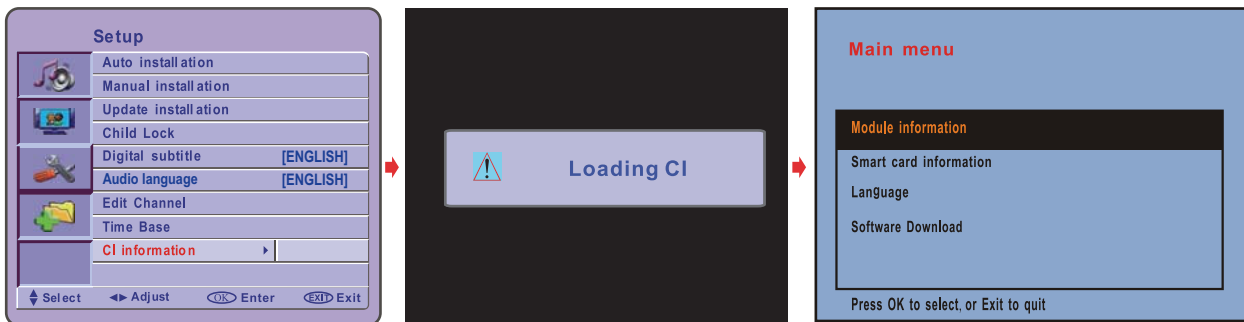

Chapter 5 Using The DVD Features

Using The Built-In DVD

TO INSERT A DISC

Select DVD function before inserting the disc to the player.
Play movies and other content on DVD, and audio CD.

Note:

Insert a disc with label side facing to rear of TV

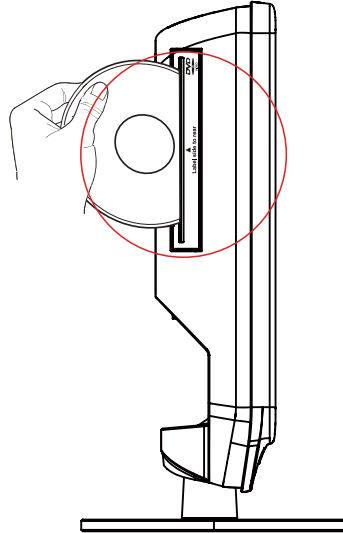

TO REMOVE A DISC

When removing the disc, please press the **EJECT** button on the remote control.

1. Turn your LCD TV on.
2. Select Input to DVD.
3. Insert a disc with mirror side facing front of TV (CD-R, CD-RW, DVD-R, DVD-RW, DVD+R, or DVD+RW).
4. After the disc is inserted, it will show the content of the disc automatically.
5. If DVD player does not automatically play the disc, press the DVD navigation buttons including **DVD MENU**, **FF**, **FR**, **PREV**, and **NEXT** buttons on the remote control to select play content, and press **OK/PLAY/PAUSE** button on the remote control to start playing.

Note:

Play may be impossible in some cases due to the condition of the recording, disc types, and disc qualities.

Using The DVD Features

TO SET UP PARENTAL CONTROL (DVD mode)

1. Press the **MENU** key to display the OSD menu.
2. Use the **▲/▼** key to highlight “**Setup**” menu and press the **OK** key.
3. Press the **▲/▼** key to highlight the “**Parental Control**” menu and press the **OK** key.
4. Enter the Default PIN number "0000".
5. Press **▲/▼/OK** keys to select the options.

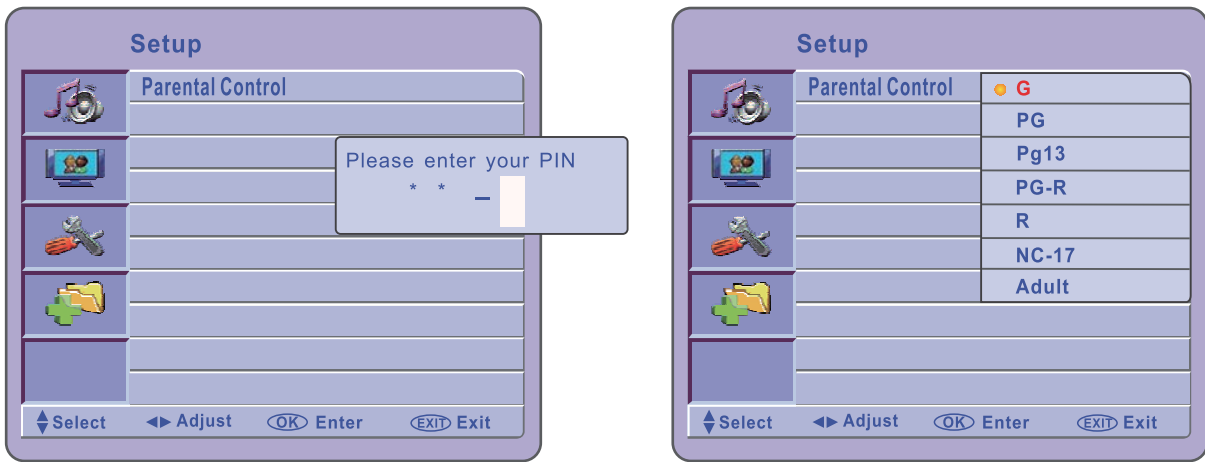

DVD Supports following formats:

1. (CVR/VBR) byte rate range: 32 kbps~ 320 kbps.
WMA byte rate range: 32kbps~192 kbps (Sample Rate)
2. JPG picture maximum resolution:
Baseline JPG: 3072 X 2048
3. *.MPG, *.DAT MP video format, same as VCD.

Note: This DVD player does not support MP3 audio files.

Picture CD Operations

Picture CD Operations

Playing Picture CD or JPEG files

The DVD player is compatible to Kodak Picture CD and discs containing JPEG / MPEG1 / MPEG2 image files (with .JPG file extension). This function is similar to playback function.

Upon loading a Kodak Picture CD JPEG files, TV screen will display the following :

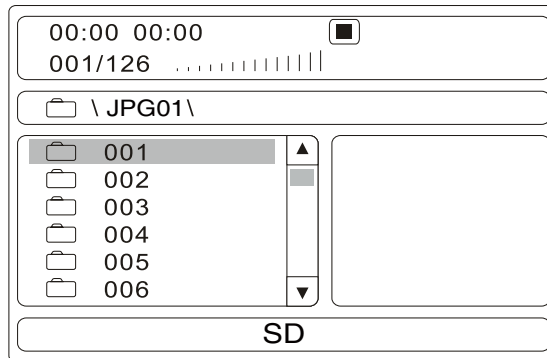

Operations:

Picture selection & Preview:

Press **FF/FR** buttons to select the target picture and press **OK/PLAY/PAUSE** button to show. The player will show the preview of the picture in preview area once the cursor stops.

Rotate Picture:

You can use **FF/FR** buttons to rotate current showing picture.

Previous and Next selection:

You can press **PREV** button to show previous picture or **NEXT** button to show next picture manually.

Slide Show:

The player will automatically play pictures in slide show mode if the disc containing more than one picture.

Press **FF/FR** buttons to change the current slide show mode when playing pictures.

Press **STOP** button to stop the current picture, press **DVD MENU** button to returns to the previous menu.



Before consulting service personnel, check the following chart for a possible cause of problem and for a possible solution.

TV will not turn on

- 1 Make sure the power cord is plugged in.
- 2 The batteries in the remote control may be exhausted.
- 3 Replace new and same brand batteries.

No picture, no sound

- 1 Check the interface cable between TV and antenna / cable TV.
- 2 Press the **STANDBY**  button on the remote.
- 3 Press the **INPUT** button repeatedly on the remote to select the connected video sources.

Poor picture, sound OK

- 1 Check the interface cable between TV and antenna / cable TV.
- 2 Try another channel, the station may have broadcast difficulties.
- 3 Adjust the Brightness / Contrast options in the Picture Menu.

Picture OK, poor sound

- 1 Sound may be muted. Press the **MUTE** button on the remote.
- 2 Press the **VOL.+** button to increase the volume.

Audio noise

- 1 Move any infrared equipment away from the TV.

DVD Troubleshooting

DVD will not read the disc

- 1 Check if the disc is turned over.
- 2 Check if there is any oil sludge on the disc.
- 3 Check if there is any obvious vestige on the disc
- 4 Try to play the disc on other DVD to check whether it is has contents

DVD does not have the signal

- 1 Check whether it is in DVD source signal.

Disc error Display on screen

- 1 Press the eject button again.
- 2 Make sure the Disc move out from the slot.

DVD Does not work.

- 1 Try to change to other mode, and then change back to DVD mode.
- 2 Try to switch off the main switch, and turn it back on after one minute.

Specifications



KEY FEATURES

Various Audio/Video terminals for external equipment connection

- 1 SCART input terminals
- 1 set of component Video input terminals
- 1 VGA / Audio input terminal
- 2 HDMI / Audio input terminals
- 1 Headphone terminal
- 1 SPDIF OUT socket (DVD SPDIF OUT)

High Definition Multimedia Interface (HDMI)

- High Definition Multimedia Interface (HDMI) is a small, user-friendly interconnect that can carry up to 10.2 Gbps of combined video and audio in a single cable. This system eliminates the cost, complexity and confusion of multiple cables used to connect current A/V systems.

HDTV Component Video Inputs

- Offers the best video quality for DVD (480p and 576p) and digital set-top-box (HD 1080i, 720p) connections.

Built-in ATV and DTV Tuners

- The built-in DTV tuner allows the reception of DVB-T broadcasting without the addition of a set-top box.

Slot-type DVD player

Teletext Function

NICAM/FM Mono Function

Manual search

Sleep-Timer

Support CI function

HD Ready

HD Ready logo is a Trademark of EICTA.



HDMI, the HDMI Logo and High-Definition Multimedia Interface are trademarks or registered trademarks of HDMI Licensing LLC.



Dolby and the double-D symbol are registered trademarks of Dolby Laboratories.

DISPLAY MODES

The screen resolution has been optimized during production for the display modes listed below. If the signal from the system equals the standard signal mode, the screen adjusts automatically. If the signal from the system is not equal to the standard signal mode, adjust the screen resolution by referring to your Video Card's user guide, otherwise there may be no video.

Y Pb Pr Mode

Resolution	Vertical Frequency (Hz)	Aspect Ratio
480P: 720 x 480	60	16:10 (Wide), 4:3
480I: 720 x 480		16:10 (Wide), 4:3
576P: 720 x 576	50	16:10 (Wide), 4:3
576I: 720 x 576		16:10 (Wide), 4:3
720P: 1280 x 720	50	16:10 (Wide), 4:3
	60	
1080I: 1920 x 1080	50	16:10 (Wide), 4:3
	60	16:10 (Wide), 4:3

VGA Mode

Resolution	Vertical Frequency (Hz)	Aspect Ratio
640 x 480	60	16:10 (Wide), 4:3
	75	
	75	
800 x 600	60	16:10 (Wide), 4:3
	75	
	75	
1024 x 768	60	16:10 (Wide), 4:3
	70	
	75	

HDMI Mode

Resolution	Vertical Frequency (Hz)	Aspect Ratio
480P: 720 x 480	60	16:10 (Wide)
576P: 720 x 576	50	16:10 (Wide)
720P: 1280 x 720	50	16:10 (Wide)
	60	
1080I: 1920 x 1080	50	16:10 (Wide)
	60	

Specifications

MODE	L19D01 UB/UW/CB/CW	L22D01 UB/UW/CB/CW
Panel System	19 inch LCD panel	22 inch LCD panel
Display Resolution	1440 pixels (horizontal) x900 pixels (vertical)	1680 pixels (horizontal) x 1050 pixels (vertical)
Television System	PAL I, B/G, D/K SECAM L	PAL I, B/G, D/K SECAM L
Brightness	300 cd/m ²	300 cd/m ²
Contrast Ratio	1000:1	1000:1
Inputs / Output		
Standby Power (<1W)	0.7	0.7
SCART	1	1
HDMI	2	2
VGA	1	1
PC Audio In	1	1
Earphone	1	1
Y Pb Pr	1	1
Digital SPDIF Out	1	1
ANT In	1	1
Speaker Power	3 W+3 W	3 W+3 W
Power Source (MAX)	100-240 V~, 50/60 Hz, 60 W	100-240 V~, 50/60 Hz, 60 W
Dimension (W x D x H)	450 x 181 x 361.1 mm	517.8 x 181 x 406.9 mm
Net weight	5.8 Kg	6.7 Kg

Features and specifications are subject to change without notice.



The mark above is in compliance with the Waste Electrical and Electronic Equipment Directive 2002/96/EC (WEEE). The mark indicates the requirement NOT to dispose the equipment including any spent or discarded batteries as unsorted municipal waste, but use the return and collection systems available.

If the batteries or accumulators included with this equipment, display the chemical symbol Hg, Cd, or Pb, then it means that the battery has a heavy metal content of more than 0.0005% Mercury, or more than 0.002% Cadmium or more than, 0.004% Lead.



Visit Partmaster.co.uk today for the easiest way to buy electrical spares and accessories. With over 1 million spares and accessories available we can deliver direct to your door the very next day.

Visit www.partmaster.co.uk
or call
0870 6001 338
(UK customers only)
Calls charged at National Rate.

NOTE:

For a replacement Remote Control for this product, please quote part number **845-045-TM3XBH**

For a replacement Power cord for this product, please quote part number **600-151-5000-SIH**

For a replacement SCART Adapter for this product, please quote part number **412-SCA-0001H**

For a replacement Video cables for this product, please quote part number **621-151-2000H**

For a replacement Audio cables for this product, please quote part number **621-151-60002H**

NOTE:

This product is exclusively available through Dixons Stores Group. In the unlikely event of a problem with your product please return to the store where your purchase was made.

For product help or out of guarantee support:
Dixons customers please call: 08701 54 55 60
Currys customers please call: 08701 54 55 70
(All calls charged at national rates)

Quick Start Guide

HITACHI
Inspire the Next

L19D01 UB/UW/CB/CW
L22D01 UB/UW/CB/CW

GB

PLEASE NOTE:

By using a SCART lead (not supplied) you can improve the quality of playback and sound. Remember you must still have the aerial lead (not supplied) connected. If you are using a SCART lead you should not have to tune your TV to your video, instead select the SCART channel by pressing the TV/Input button on the remote control.

1 Insert batteries into Remote Control



Use 2 x AAA size batteries.

2 Connect aerial

Do not connect the TV to the mains supply until you have completed all the connections.

- If you just want to connect your TV to an aerial connect it as shown opposite. **Now go to stage 4.**
- If you want to connect your TV to a VCR go to stage 3a.
- If you want to connect your TV to a VCR and a Satellite/Cable box then go to stage 3b.

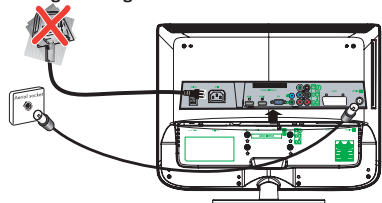

3-pin mains plug for UK model
2-pin mains plug for EU model

3a Connecting to a VCR

OR

3b Connecting to a VCR and a Satellite/Cable box

Do not connect the TV to the mains supply until you have completed all the connections.
Note: 2-pin mains plug for EU model; 3-pin mains plug for UK model.

A If you have a SCART lead, connect one end of the lead to the SCART socket on your VCR and connect the other end to the SCART socket marked SCART on the back of your TV.

B Connect one end of the RF lead to the aerial socket on your TV and the other end to the socket marked RF OUT on the back of your VCR.

C Connect your aerial lead to the socket marked RF IN on the back of your VCR.

Now go to stage 4.

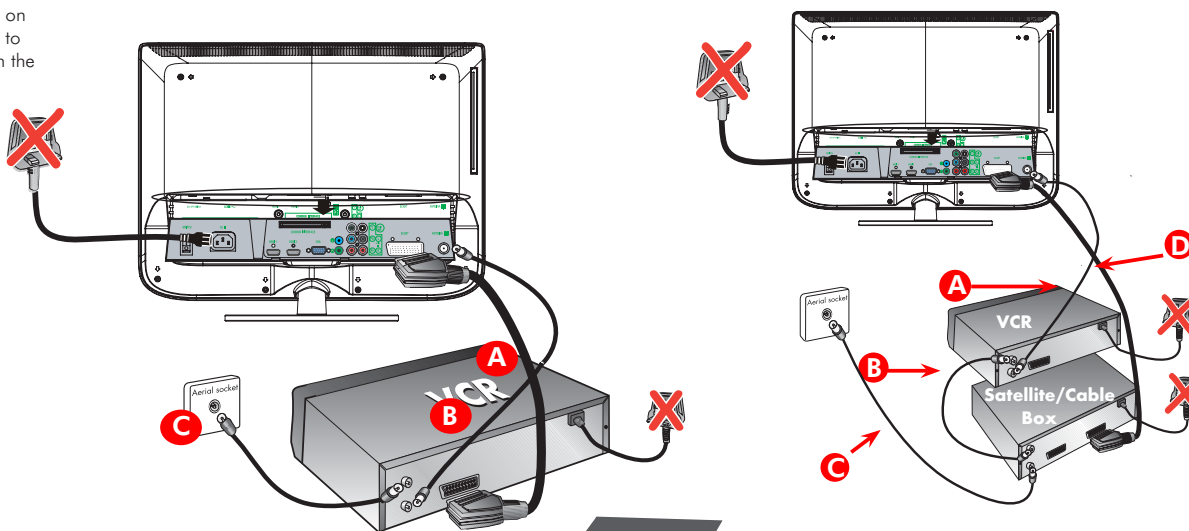

A Connect one end of an RF lead to the aerial socket marked RF IN on your TV and the other end to the socket marked RF OUT on the back of your VCR.

B Connect one end of another RF lead to the aerial socket marked RF IN on your TV and the other end to the socket marked RF OUT on the back of your Satellite/Cable box.

C Connect your aerial lead to the socket marked RF IN on the back of your Satellite/Cable box.

D If you have SCART leads connect one end to the socket marked SCART on the back of your TV, and connect the other end to the SCART socket on the back of your VCR.

Now go to stage 4.

4 Switch on



A Plug your TV and any other equipment that you have connected into the mains.

B Press the AC SWITCH on the back of your TV to switch on your TV's power.

C Then press the **POWER** button on the front side view of your TV to switch on your TV. The screen will be blue screen.

Note:

- It is recommended to complete the VCR channel set up before the TV tuning process. Connect your VCR to the TV and the antenna, then switch it on. Insert a pre-recorded tape and press PLAY. This can help you to easily find the VCR channel as it will play the pre-recorded tape.
- Before you start up the TV tuning process, the Satellite/Cable channel set up are recommended to complete prior to the TV tuning process. Connect your Satellite/Cable box to the TV and the antenna, and then switch it on. Select a channel that you will easily recognise. This can help you to easily find the satellite/cable channel since the TV will play that selected channel.

5 Select & Start Auto installation menu



A Turn on the TV. Press the MENU button on the remote control to enter the menu option.

B Press **▲/▼** to select **SETUP**, then press **OK** to highlight Auto Installation. Press **OK** again for you to input the **DEFAULT PIN Number "0000"**.

C Press **OK**, and then press **▲/▼** to select **Country** first, then press **OK** to confirm.

D Press **▼** button to select the Start Search, and press **OK** to confirm. Press the **▼** button to select **"YES"**. The unit will start **Auto Search**. Please be patient as this process will take a few minutes.

E When Auto Installation is completed, press **EXIT** to exit the screen.

6 Skip(Uninstall) a Channel



- Press the **MENU** button on the remote control to enter the menu option.
- Press **▼/▲** to select **SETUP**, and press **OK** to enter the **SETUP** screen.
- Press **▼/▲** to select **Edit Channel**, press **OK** to enter **Edit Channel** screen.
- Press **▼/▲** to select the channel which you want to skip (uninstall). Press the Green button to skip(uninstall) that channel.
- Press green key again to unskip the selected channel.

7 Rename a Channel

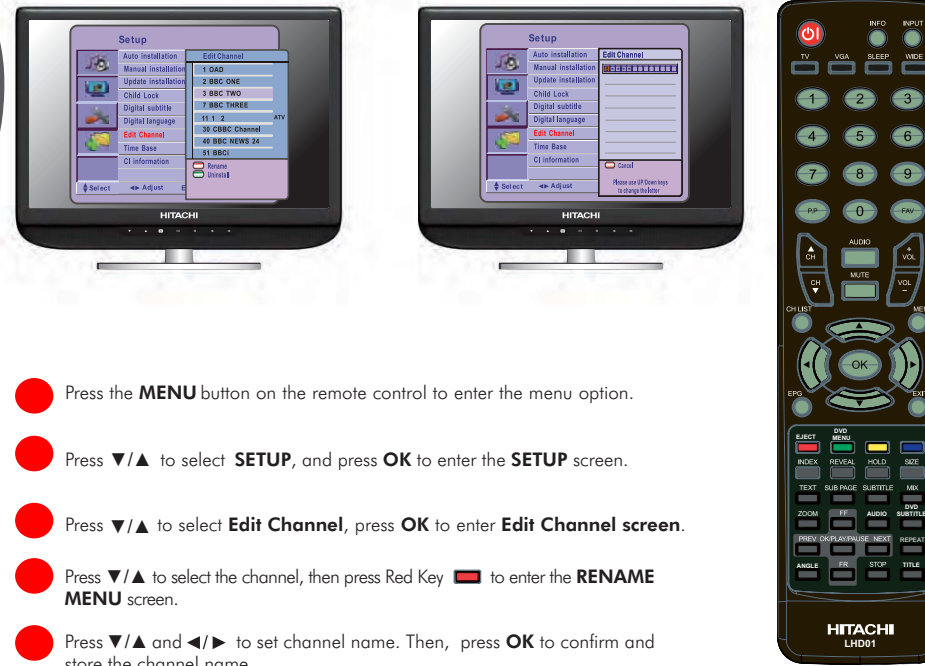

- Press the **MENU** button on the remote control to enter the menu option.
- Press **▼/▲** to select **SETUP**, and press **OK** to enter the **SETUP** screen.
- Press **▼/▲** to select **Edit Channel**, press **OK** to enter **Edit Channel** screen.
- Press **▼/▲** to select the channel, then press Red Key to enter the **RENAME MENU** screen.
- Press **▼/▲** and **◀▶** to set channel name. Then, press **OK** to confirm and store the channel name.

8 Using The Built In-DVD

TO INSERT A DISC

Select DVD function before inserting the disc to the player.
Play movies and other content on DVD, VCD, SVCD, and audio CD.

Note:
Insert a disc with label side facing to rear of TV

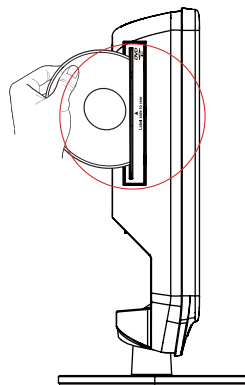

TO REMOVE A DISC

When removing the disc, please press the **EJECT** button on the remote control.

1. Turn your LCD TV on.
2. Select DVD by repeatedly pressing INPUT button.
3. Insert a disc with mirror side facing front of TV (CD-R, CD-RW, DVD-R, DVD-RW, VCD, SVCD, DVD+R, or DVD+RW).
4. After the disc is inserted, it will show the content of the disc automatically.
5. If DVD player does not automatically play the disc, press the **DVD MENU** and **FF, FR, PREV, NEXT** buttons on the remote control to select play content, and press **OK/PLAY/PAUSE** button on the remote control to start playing.

9 DVD Functions

- 1 **EJECT**
Press to eject the disc (DVD mode)
- DVD MENU**
Press the button to display the DVD disc menu. (DVD mode)
- 2 **ZOOM**
Zoom-In/Zoom-Out the displayed frame. (DVD mode)
- 3 **FF, FR, PREV, NEXT, OK/PLAY/PAUSE (▲/▼/◀/▶/OK)**
Allow you to move, select a variety of information such as the DVD disc menu. (DVD mode). These are the DVD navigation buttons.
FF/FR
Press to advance or rewind playback rapidly. (DVD mode)
PREV
Press to skip to the beginning of the currently played chapter or track. (DVD mode)
NEXT
Press to skip to the beginning of the next chapter or track. (DVD mode)
OK/PLAY/PAUSE
Press to start playback or pause. (DVD mode)
- 4 **AUDIO / DVD SUBTITLE**
AUDIO
Change the audio language or audio channel. (DVD mode)
DVD SUBTITLE
Press the button to change subtitling feature. (DVD mode)
- 5 **REPEAT**
Press to repeat the chapter or track. (DVD mode)
- 6 **TITLE**
Press the button to display the DVD title content. (DVD mode)
STOP
Press to stop playback. (DVD mode)
- 7 **ANGLE**
Allow you to view the different angle. (DVD mode)



Checklist...

You should have...

- Put the two AAA size batteries in your remote control.
- Connected your TV to an aerial or VCR and/or VCR Satellite/Cable box.
- Switched on your TV and any other connected equipment.
- Tuned in all available channels.
Channel 1 BBC1
Channel 2 BBC2
Channel 3 ITV
Channel 4 CH4
Channel 5 CH5
Channel 6 Satellite/Cable
Channel 7 VCR

Basic functions

- 1 After connecting the aerial to your LCD TV and connecting the mains cable to the TV and mains socket, press **AC SWITCH** on the rear panel of the TV.
- 2 A red LED indicator will show on the front panel of the TV.
- 3 Press the **STANDBY** button, and the red LED indicator will change to blue.

- 4 To power off, press the **STANDBY** button again, and the blue LED indicator will change to red.

In the interests of safety and to avoid unnecessary energy consumption, never leave your TV in standby while unattended for long periods of time, eg. overnight, while on holiday or while out of the house.

Changing channels

Press the **NUMBER** buttons to go directly to a channel e.g. press the number **1** button to go to channel 1. For a channel number above 9, for instance, channel 12 press the number **1** button quickly followed by the number **2** button. To move up and down the channels in order press the **CH.▲** or **CH.▼** button.

Adjusting the volume

Press the **VOL.+** button to increase the volume. Press the **VOL.-** button to decrease the volume.

Selecting Teletext

Press the **TEXT** button to select Teletext function. Press the button again to deactivate the function. After you pressed the **TEXT** button and the TV is in Teletext function, press **MIX** to allow you to read the Teletext and still see the picture on your TV.

NB. MIX function is only operative on analogue TV.
 This symbol on the product or in the instructions means that your electrical and electronic equipment should be disposed at the end of its life separately from your household waste. There are separate collection systems for recycling in the EU.
For more information, please contact the local authority or your retailer where you purchased the product.

