

20LD2450

# HITACHI

Inspire the Next

Instructions for use

**GB**

Bruksanvisning

**N**

Bruksanvisning

**S**



# HITACHI

**!** IMPORTANT - If placing TV into cabinet or alcove, ensure there is at least a 100mm (10cm) gap to the sides, rear and top of the TV. This is to allow for adequate ventilation during operation. Please read the main Users Guide for more safety information before installation.

### 1

#### insert the batteries into your handset

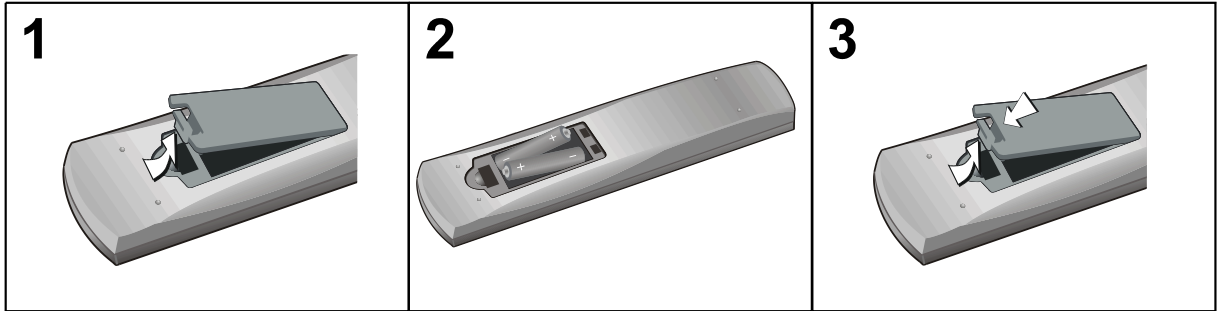

Rear view

### 2a

#### either connect the aerial straight to your TV...

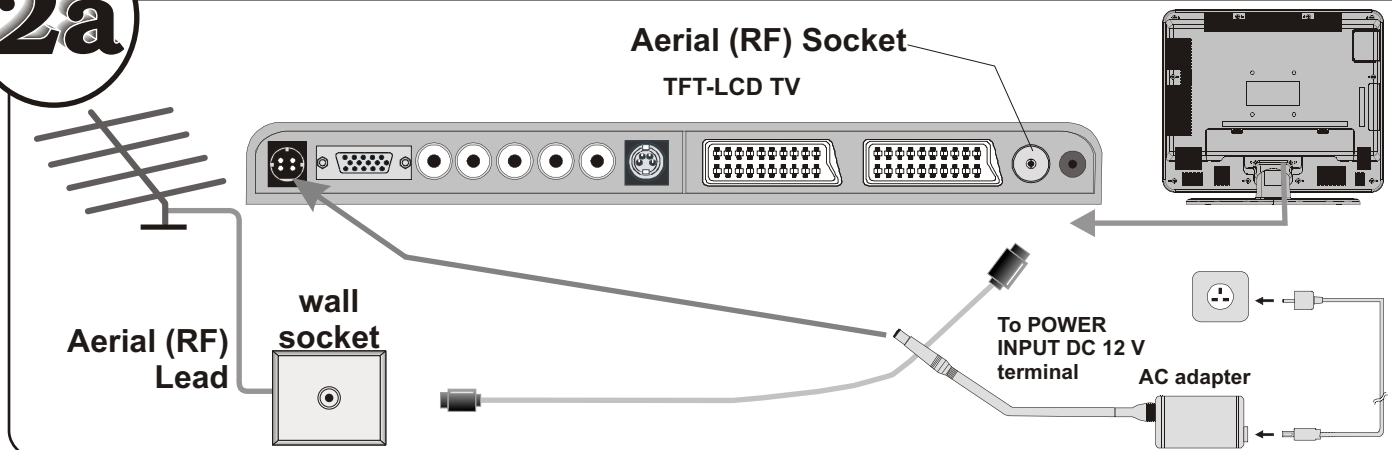

### 2b

#### ...or connect the aerial through a VCR...

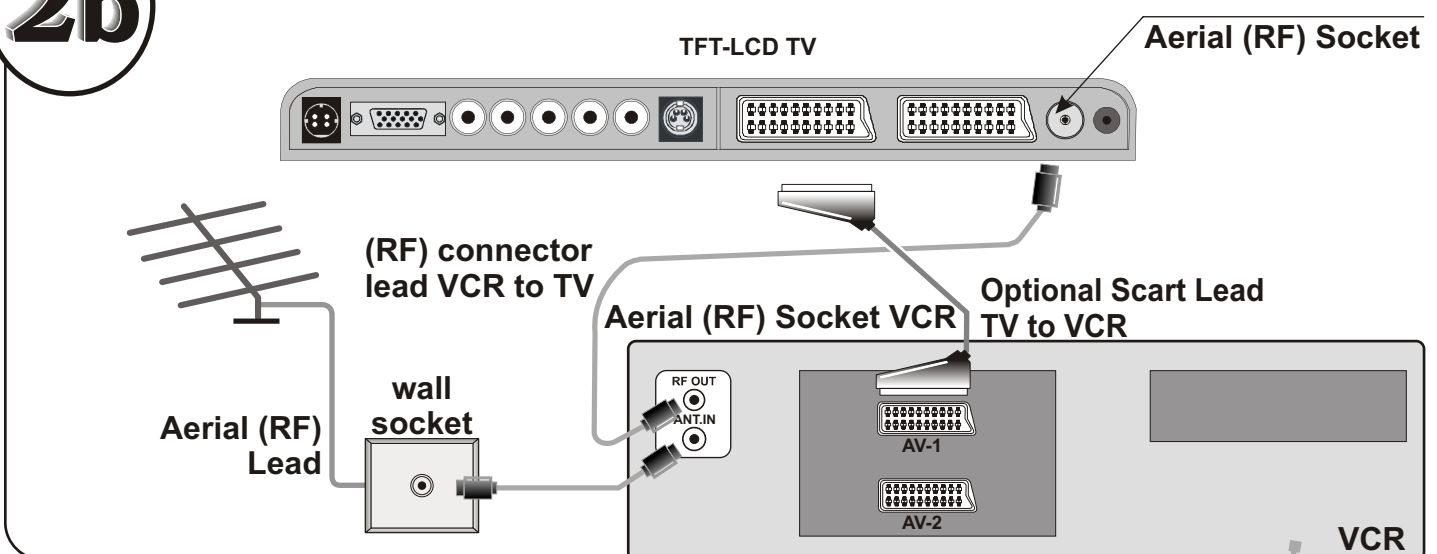

• It is recommended that a scart lead should be fitted between your TV and VCR to enhance your picture and sound quality. Scart leads are essential if you have a stereo TV and VCR and wish to obtain stereo sound from your equipment. These leads can be purchased from your Hitachi dealer or any good High Street electrical retailer.

2c

...or through a satellite decoder...

EU

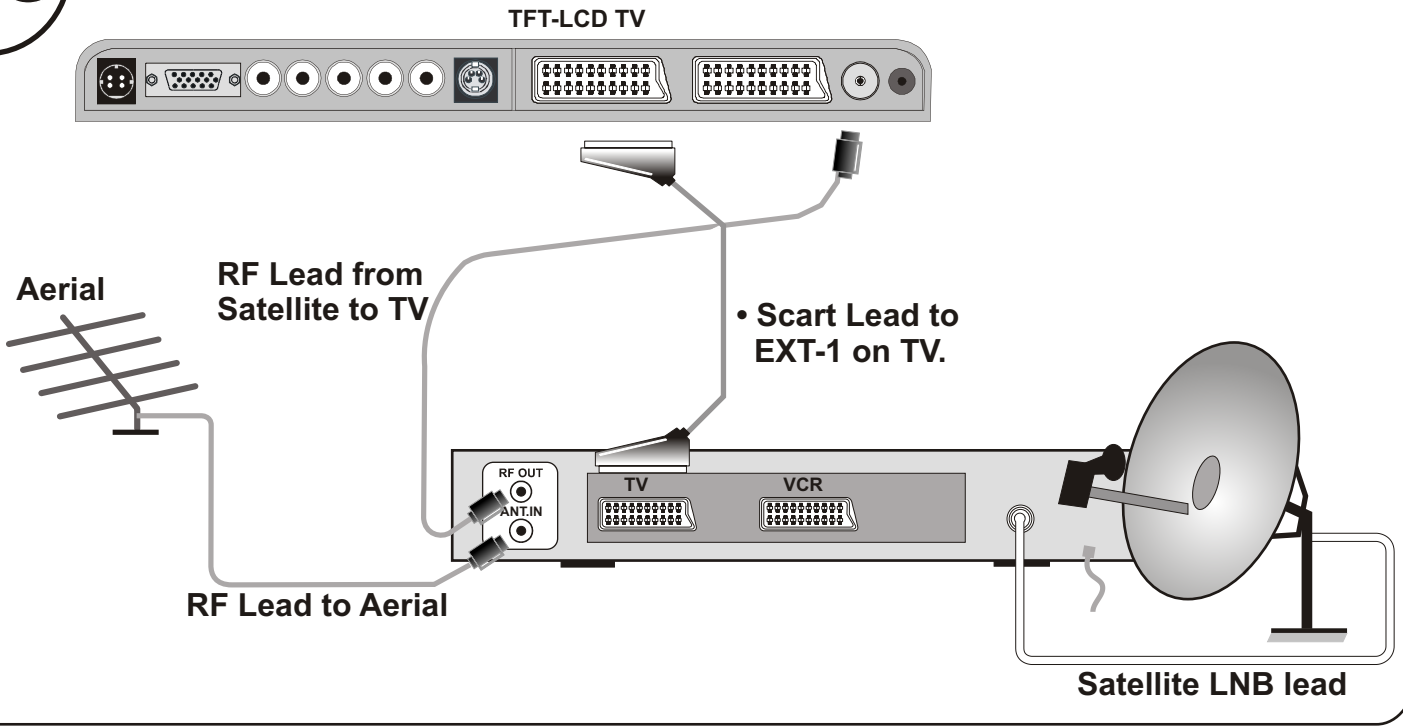

2d

...or through a VCR and satellite decoder.

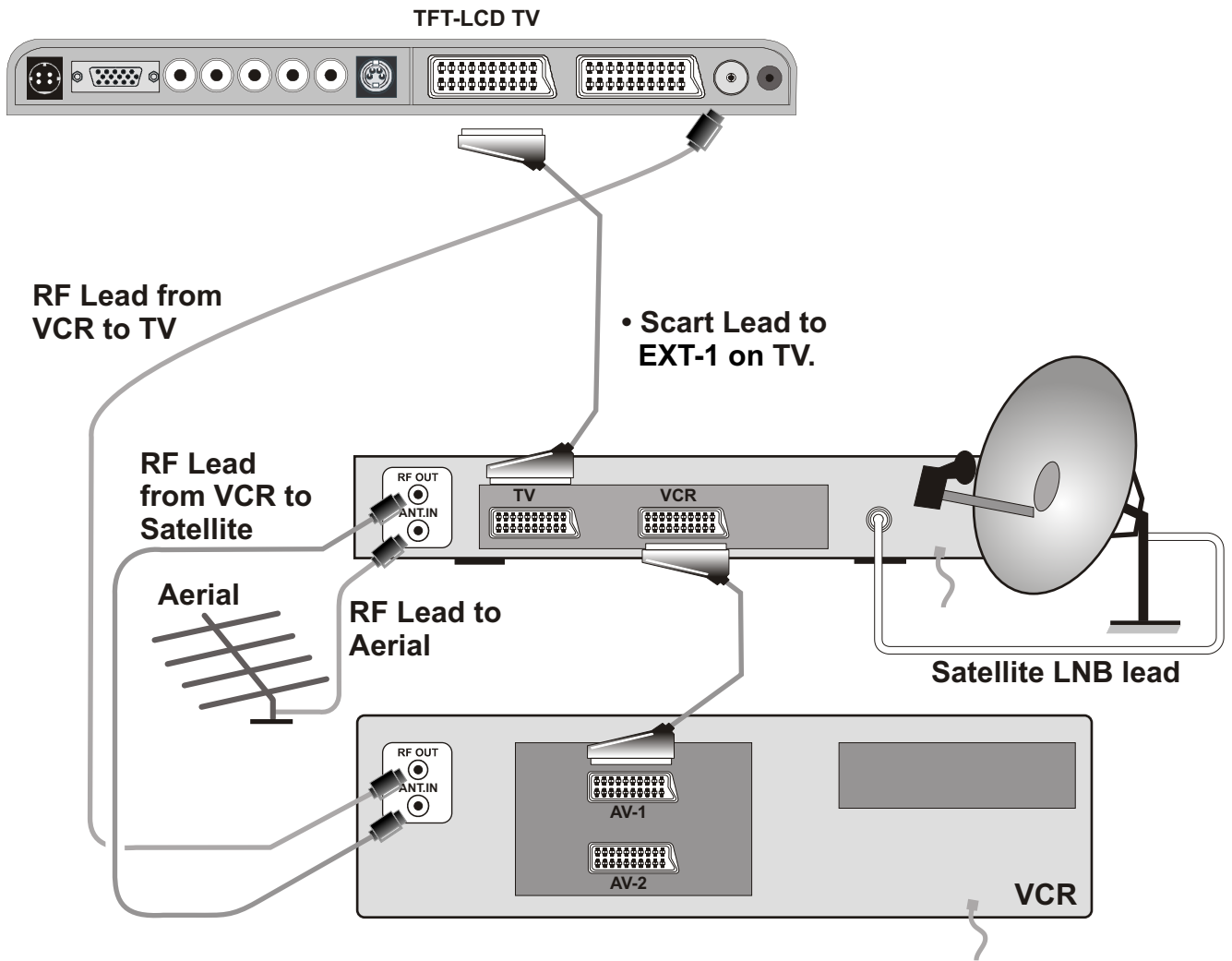

# 3

## connect the TV plug to the mains socket

EU

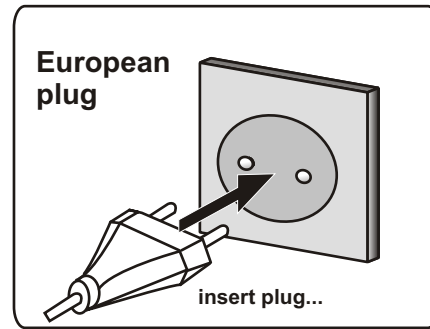
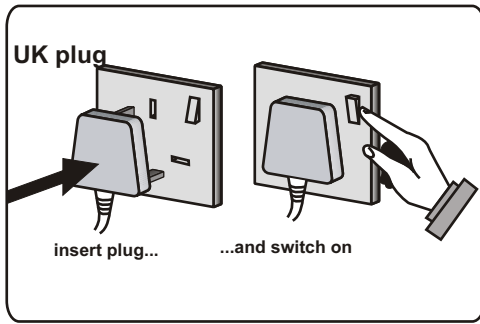

# 4

## switch your TV on by pressing the On/Off button

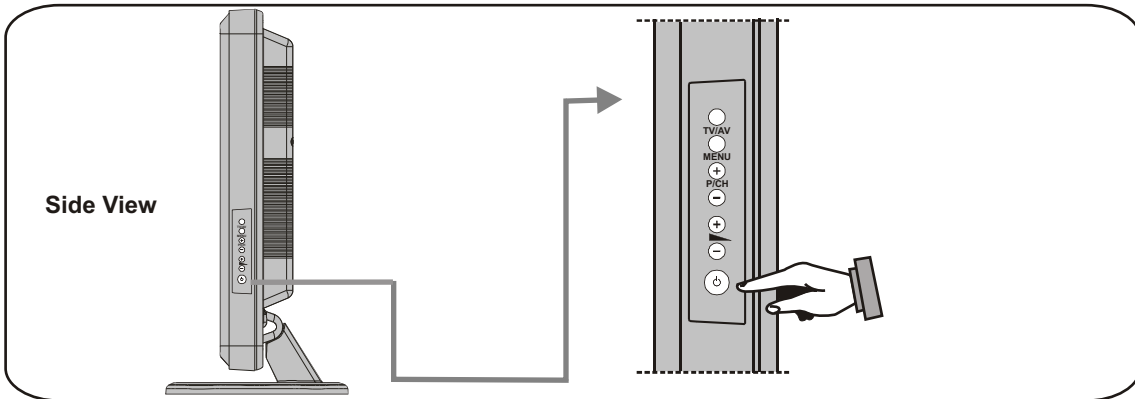

**NB:** When the set is first switched on, the set will be in standby and the indicator on the front of the set will illuminate red. Press the channel up down (P- , P+) or numeric buttons (1, 2, 3, ...) to operate.

### basic functions of remote control

**menu M**  
Press this button to enter the main menu of the TV and again to exit the menu and return to normal TV operation.

To select a programme number.

Volume Down

Volume Up

Programme Down

Programme Up

**Cursor left**  
This Button is used to move the menu selection box left or change a highlighted selection.

**cursor up**  
Use this button to move the menu selection box up.

**cursor down**  
Use this button to move the menu selection box down.

**cursor right**  
This Button is used to move the menu selection box right or change a highlighted selection.

## important note before starting Auto Setup

If you have a Video Cassette Recorder or a Satellite receiver connected to your TV please ensure that they are switched on before automatic tuning begins. In the case of a VCR, insert a pre-recorded tape and begin playback of your equipment. These measures ensure that all your external equipment is tuned in during the Auto Setup procedure.

# 5

## start A.P.S. (Auto Programming System)

**1** First select the language by using the “◀” or “▶” buttons on the remote control.

**2** Use the “▲” or “▼” to select Country. Select the country by using “◀” or “▶” buttons on the remote control

**3** Press "OK" button on the remote control to start A.P.S. The set will tune in all available channels.

**4** If you wait until the end of A.P.S., Program Table is displayed with the programmes found and located. Press TV on the Remote Control to remove the menu and start viewing TV.

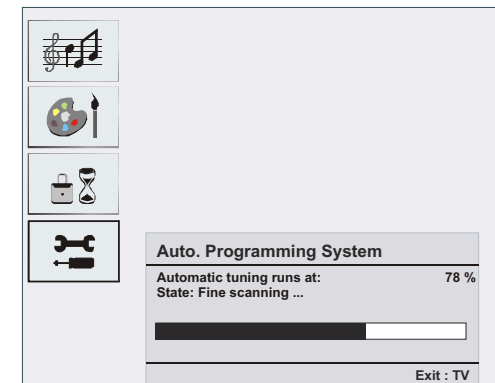
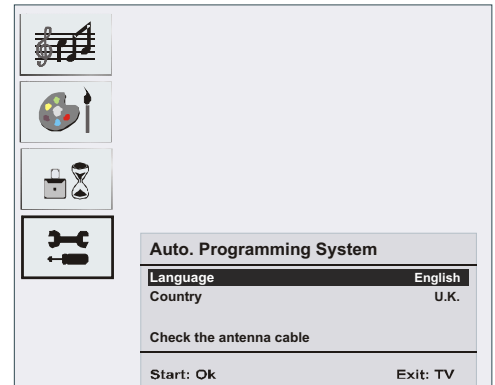

## important note.

Once the TV has found all your local stations, they are then automatically assigned a programme number and name, if available from the broadcast.

If you would like to change the programme number or order, please refer to the Program Menu section of the instruction book.

# Contents

|   |    |
|---|----|
| Installation of device on the wall (optional) ..... | 1  |
| Remote Control Buttons .....                        | 2  |
| LCD TV .....  | 2  |
| Connect Peripheral Equipment .....                  | 3  |
| Peripheral Equipment Connections .....              | 3  |
| Preparation .....                                   | 4  |
| Safety Precautions .....                            | 4  |
| Before Switching On Your TV .....                   | 6  |
| Menu Map .....                                      | 7  |
| Switching The TV ON/OFF .....                       | 8  |
| Navigating the Menu System .....                    | 8  |
| Menu System .....                                   | 8  |
| PC Mode .....                                       | 12 |
| Other Features .....                                | 13 |
| Teletext .....                                      | 13 |
| Connect Peripheral Equipment .....                  | 14 |
| Tips .....  | 15 |
| Appendix A: AerialConnection .....                  | 15 |
| Specifications .....                                | 16 |
| Appendix B: PC Input Typical Display Modes .....    | 17 |
| UK Guarantee .....                                  | 18 |

## Installation of device on the wall (optional)

### Installation Of The TFT TV To The Wall

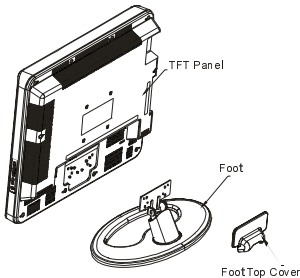

1- To install the TFT TV on the wall, first of all, the stand assembly should be removed. Unscrew the 4 screws that attach the stand top cover and the 4 screws that attach the stand to the TFT panel and remove the stand assembly from the TFT panel.

2- Place the 4 plastic pins to the circular screw holes at the rear of the TFT and screw them to the TFT panel with 4 (M4 x 10) screws.

3- Decide the place on the wall where the TFT panel would be placed. Level and mark with a pencil the 4 mounting points on the wall hanger. Drill holes for the plastic anchors and then fix the wall hanger with 4 screws (4 x 30).

4- Raise the TFT panel and hang it to the holes on the wall bracket from the 4 hanging screws at the rear of the TFT panel.

#### IMPORTANT

1. Please follow the installation instructions carefully as failure to do so may result in injury or damage to the set.

2. If you do not feel confident in carrying out the installation yourself, please ask a specialist installer to carry out the installation for you.

3. The wall anchors provided are for solid (brick, concrete etc) walls only. For all other wall types please obtain the correct fixings for the wall type from your hardware retailer. If you are unsure which anchors to use, please seek professional advice.

4. To avoid potential injury it is advisable to have assistance from another person to carry out this installation.

5. Hitachi assumes absolutely no responsibility for injuries or damages that may occur due to improper installation and handling

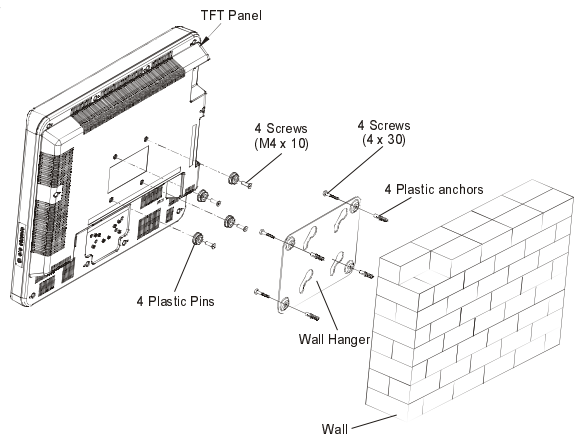

# Remote Control Buttons

- ① = Stand By
- ② 0 - 9 = Direct Programme
- ③ = Menu
- ④ -- = Double Digit
- ⑤ **V** + / - = Volume + / -
- ⑥ **P** + / - = Programme + / -
- ⑦ = Cursor Up
- ⑧ = Cursor Right
- ⑨ = Cursor Left
- ⑩ OK = OK
- ⑪ = Cursor Down

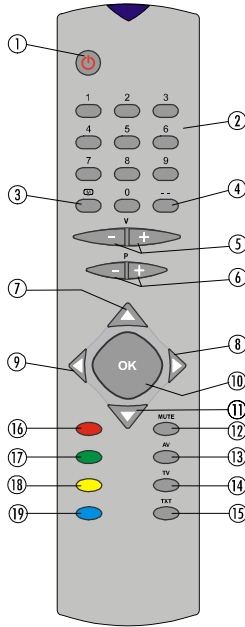

- ⑫ **MUTE**: Mute
- ⑬ **AV** = External Source (TV, EXT1, EXT2, EXT3, SVHS, PC)
- ⑭ **TV** = TV / Quit Menu
- ⑮ **TXT** = Teletext
- ⑯ **Red (SOUND)** = Sound
- ⑰ **Green (PICTURE)** = Picture Menu
- ⑱ **Yellow (FEATURE)** = Feature Menu
- ⑲ **Blue (INSTALL)** = Installation Menu

# LCD TV

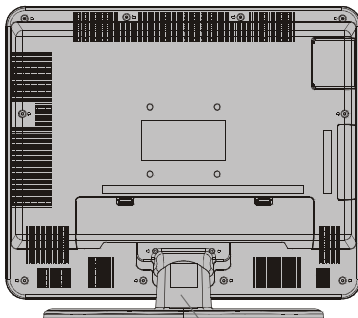
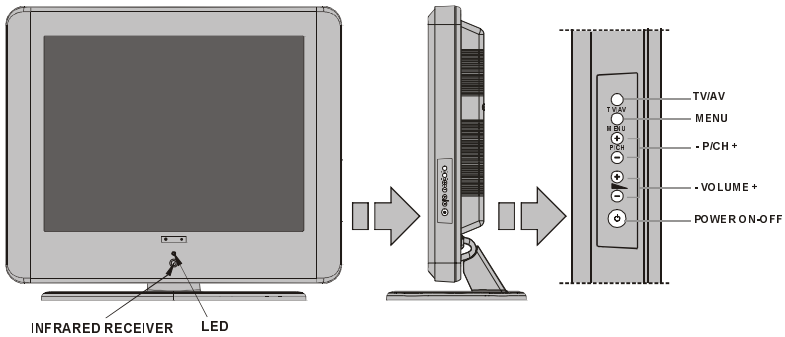

STAND TOP COVER

## Connect Peripheral Equipment

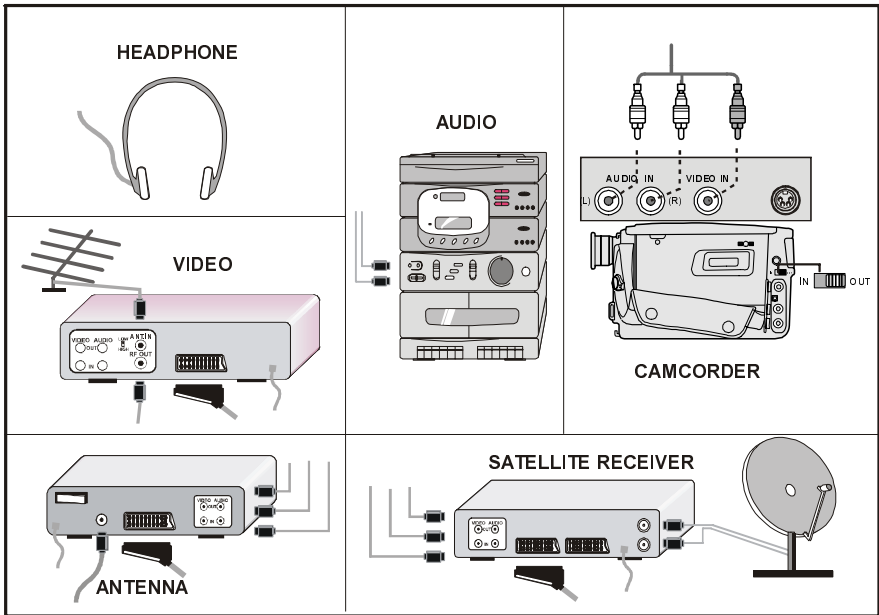

## Peripheral Equipment Connections

- Ⓐ DC 12 V 
- Ⓑ PC INPUT
- Ⓒ AUDIO LINE OUT (L, R)
- Ⓓ AUDIO INPUT (L, R)
- Ⓔ VIDEO INPUT
- Ⓕ S-VHS INPUT
- Ⓖ SCART 2
- Ⓗ SCART 1
- Ⓘ ANTENNA
- Ⓙ HEADPHONE

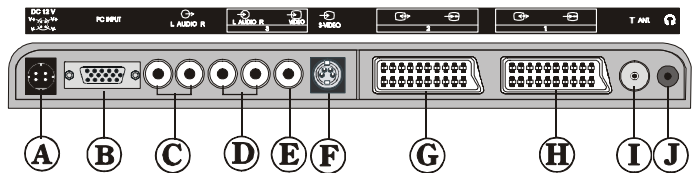
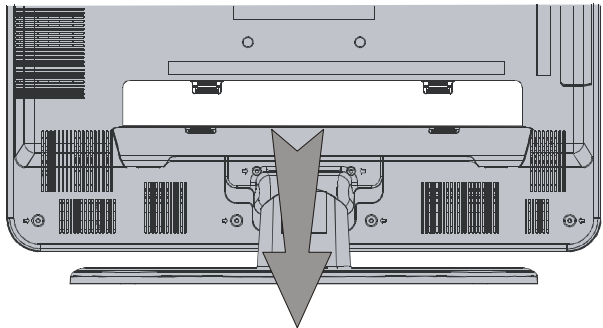



## Preparation

For ventilation, leave a space of at least 10 cm free all around the set. To prevent any fault and unsafe situations, please do not place any objects on top of the set.

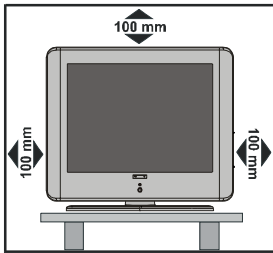

This set can be used in tropical and/or moderate climates.

## Features

- Remote controlled colour television.
- 100 programmes from VHF, UHF bands or cable channels can be preset.
- It can tune cable channels.
- Controlling the TV is very easy by its menu driven system.
- It has 2 Scart sockets for external devices (such as video, video games, audio set, etc.)
- Stereo sound system (German+Nicam).
- Full function Teletext .  
Fastext (10 Pages), TOP text.
- Favorite Channel
- Headphone connection.
- A.P.S. (Automatic Programming System).
- All programmes can be named.
- Forward or backward automatic tuning.
- Sleep timer.
- Child Lock.
- Automatic sound mute when no transmission.
- NTSC Playback.
- AV in and S-VHS in are available.
- It has VGA connector for external devices such as computer.
- AVL (Automatic Volume Limiting)
- When no valid signal is detected, after 5 minutes the TV switches itself automatically to stand-by mode.
- PLL (Frequency Search)
- PC Input
- Plug&Play for Windows 9X, ME, 2000, XP
- Audio Line Out

## Panel Features

- High resolution, 20" TFT LCD display.
- Contrast ratio (typical): (800:1)
- Brightness (typical): 450 cd/m<sup>2</sup>
- Response time (typical): 25 msec.
- Viewing angle (typical): 178° (horizontal) and 178° (vertical).
- 8-bit color depth, display 16.7 M colors.

## Safety Precautions

Please read the following recommended safety precautions carefully for your safety.

## IMPORTANT SAFETY INFORMATION ON OPERATING YOUR TV

### Do's and Don'ts

#### DO's

This Television has been designed and manufactured to meet international safety standards, but like any electrical equipment, care must be taken if you are to obtain the best results and safety is to be assured.



**DO** read the operating instructions before you attempt to use the equipment.

**DO** consult your dealer if you are in any doubt about installation, operation or safety of your equipment.

**DO** be careful with glass panels or doors on equipment.

This TV is supplied with a fitted mains plug. This plug must not be cut off as it may contain a special radio interference filter, the removal of which could lead to impaired performance. If you wish to extend the lead, obtain an appropriate safety approved extension lead or consult your dealer.

Observe the manufacturers instructions when connecting extension leads to the TV. Check the fuse rating on the new plug, this should be fitted with a 5 Amp fuse which conforms to either ASTA or BSI (BS1 362) approvals, these are easily identifiable by either

the  or  symbols. If you are in any doubt about the installation of an extension lead, please consult a competent electrician.

#### DON'Ts

**DON'T** continue to operate the equipment if you are in any doubt about it working normally, or if it is damaged in any way switch off, withdraw the mains plug and consult your dealer.

**DON'T** place water filled vessels on top of T.V. cabinets.

**DON'T** remove any fixed cover as this may expose dangerous voltages.

**DON'T** leave equipment switched on when it is unattended unless it is specifically stated that it is designed for unattended operation or has a stand-by mode. Switch off using the switch on the equipment and make sure your family know how to do this. Special arrangements may need to be made for infirm or handicapped people.

**DON'T** use equipment such as personal stereos or radios so that you are distracted from the requirements of traffic safety. It is illegal to watch television whilst driving.

**DON'T** obstruct the ventilation of the equipment, for example with curtains or soft furnishings. Overheating will cause damage and shorten the life of the equipment.

**DON'T** use makeshift stands and **NEVER** fix legs or stands to the TV with any screws other than those provided - to ensure complete safety always use the manufacturers approved stand with the fixings provided.

**DON'T** allow electrical equipment to be exposed to rain or moisture.

## **ABOVE ALL**

- **NEVER let anyone, especially children push anything into holes, slots or any other opening in the case - this could result in a fatal electric shock.**
- **NEVER guess or take chances with electrical equipment of any kind - it is better to be safe than sorry!**

## **1. Power**

- Always use the provided AC adaptor.
- Operate only from the power source specified on the AC adaptor.
- In use, the AC adaptor gets heat on the surface of the case. It is normal, not defective.
- Do not cover the case of AC adaptor with any material while it is in operation. Leave 15 cm space (minimum) around the AC adaptor.
- The rating information and safety caution of the AC adaptor are on its case.

**Warning:** When the device is not in use for a long time, disconnect from power.

## **2. Power Cord**

Do not place the set, a piece of furniture, etc. on the power cord (mains lead) or pinch the cord. Handle the power cord by the plug Do not pull out the plug by tugging the cord and never touch the power cord when your hands are wet as this could cause a short circuit or electric shock Never make a knot in the cord or tie it with other cords. The power cords should be placed in such a way that they are not likely to be stepped on A damaged power cord can cause fire or give you an electric shock. When it is damaged and needs to be changed, it should be done by qualified personnel.

## **3. Moisture and Water**

Do not use this equipment in a humid and damp place (avoid the bathroom, the sink in the kitchen, and near the washing machine). Do not expose this equipment to rain or water, as this may be dangerous and do not place objects filled with liquids, such as flower vases, on top of the set. Avoid from dripping or splashing. If any solid object or liquid falls into the cabinet, unplug the set and have it checked by qualified personnel before operating it any further.

## **4. Cleaning**

Before cleaning, unplug the adaptor from the wall outlet. Do not use liquid or aerosol cleaners. Use soft and dry cloth.

## **5. Ventilation**

The slots and openings on the back cover are intended for ventilation and to ensure reliable operation. To prevent overheating, these openings must not be blocked or covered in any way.

## **6. Heat and Flames**

The set should not be placed near to naked flames and sources of intense heat, such as an electric heater. Ensure that no naked flame sources, such as lighted candles, are placed on top of the set.

## **7. Lightning**

In case of storm and lightning or when going on holiday, disconnect the power cord from the wall outlet.

## **8. Replacement Parts**

When replacement parts are required, be sure the ser-

### **Be sure to ground the connection properly.**

Connect the ground terminal of the AC adaptor with the ground terminal provided at the power outlet using the enclosed power cord. If the provided plug does not fit your outlet, consult an electrician for replacement of the obsolete outlet.



Surely connect  
the ground wire.

vice technician has used replacement parts which are specified by the manufacturer or have the same specifications as the original one. Unauthorised substitutions may result in fire, electrical shock, or other hazards.

## 9. Servicing

Please refer all servicing to qualified personnel. Do not remove the cover yourself as this may result in an electric shock.

### Instructions for waste disposal:

- *Packaging and packaging aids are recyclable and should principally be recycled. Packaging materials, such as foil bag, must be kept away from children.*
- *Batteries, including those which are heavy metal-free, should not be disposed of with household waste. Please dispose of used batteries in an environmentally sound manner. Find out about the legal regulations which apply in your area.*
- *Cold cathode fluorescent lamp in LCD PANEL contains a small amount of mercury, please follow local ordinances or regulations for disposal.*

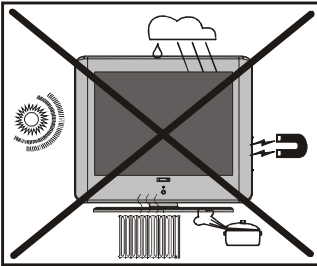

**“The mains plug of the power supply is used as disconnect device and therefore shall remain readily operable.”**

**Warning:** To prevent injury, this device must be securely attached to the floor/wall in accordance with the installation instructions.

“The LCD panel is very high technology product with about a million thin film transistors, giving you fine picture details. Occasionally, a few non-active pixels may appear on the screen as a fixed point of blue, green or red. Please note that this does not affect the performance of your product.”

**“DO NOT LEAVE YOUR TV AT STAND-BY OR OPERATING WHEN YOU LEAVE YOUR HOUSE”**

**“In order to avoid possible accidents, please do keep children away from the moving gear located at the rear bottom side of your TV.”**

## Before Switching On Your TV

### Power Connection

**IMPORTANT :** The TV set is designed to operate on 220-240V AC. For this, an adaptor is used which gives 12V DC voltage.

### Connections To The Aerial Input Socket

- Connect the aerial or cable TV plug to the Aerial input socket located at the rear of the TV and connect the cable plug coming out from the TV out socket located on the devices (VCR, DVB etc.) to this socket as well.

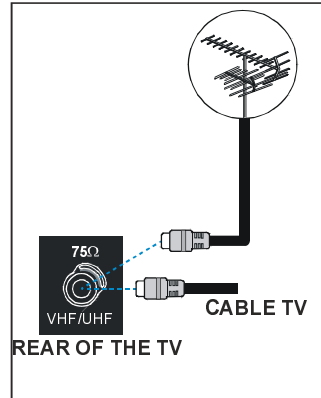

### Inserting Batteries In The Remote Control Handset

**WARNING :** Remote control batteries are included. A plastic protector is used to disconnect the batteries in order to prevent the battery life from reducing. Please remove the plastic protector before the first use.

### Inserting The Battery In The Remote Control Handset

- Remove the battery cover located on the back of the handset by gently pulling backwards from the indicated part.
- Insert two **AAA (R03)** or equivalent type batteries inside.
- Replace the battery cover.

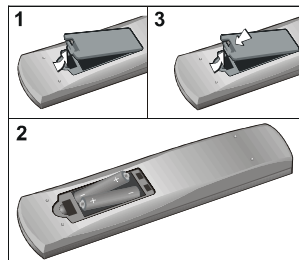

# Menu Map

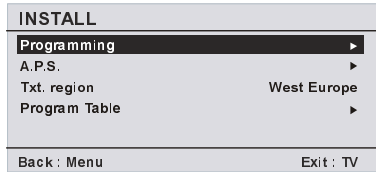
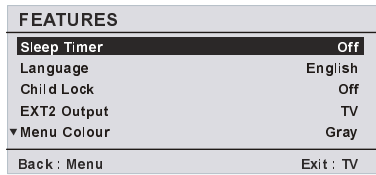
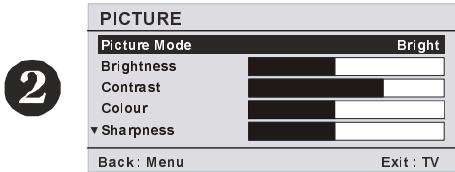
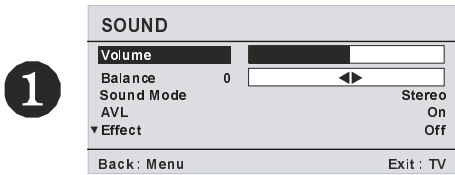

## 1 SOUND MENU

- Volume
- Balance
- Sound Mode
- AVL
- Effect
- Equalizer
- Mode
- HP Volume
- Store

## 2 PICTURE MENU

- Picture Mode
- Brightness
- Contrast
- Colour
- Sharpness
- Colour Temp
- Room Lightning
- Picture zoom
- Store

## 3 FEATURES MENU

- Sleep Timer
- Language
- Childlock
- EXT2 Output
- Menu Colour
- Favorite Mode

## 4 INSTALL MENU

- Programming
  - Programme
  - Band
  - Channel
  - Standard
  - Colour System
  - Search
  - VCR Mode
  - Decoder
  - Store
- APS
  - Auto Programming System
- Txt. Region
- Program Table

*A menu map is provided above. For details of the items, refer to relevant explanations in the "MENU SYSTEM".*

Note: Remove the battery from remote control handset when it is not to be used for a long period. Otherwise it can be damaged due battery leakage.

## Switching The TV ON/OFF

### To switch the TV on:

Your TV will switch on in two steps:

1- Connect the DC 12V lead to the DC 12V socket at the rear of the TV. Connect one end of the AC power cord assembly to AC adaptor and the other end to a mains wall socket. Press Power On/Off button on the right side of the TV. Then the TV switches itself to stand-by mode.

2- To switch on the TV from stand-by mode either:

Press a digit button on the remote control so that a programme number is selected, or Press the "-P/CH" or "P/CH+" button on the TV or press the "P-" or "P+" button on the remote control, so that last mode switched off is selected.

By either method the TV will switch on. When the TV is operated for the first time, the following screen appears:

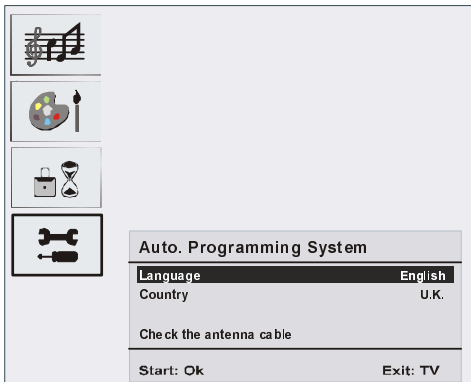

For more information on this process, see "Install Menu" section.

### To switch the TV off:

- Press the "⏻ (stand-by)" button on the remote control, so the TV will switch to stand-by mode.

To power down the TV completely, press Power On/Off button or unplug the power cord from the mains socket.

The AC adaptor will still be active; to completely disconnect the set from the mains, remove the plug from the mains wall socket.

## Navigating the Menu System

For displaying menu options

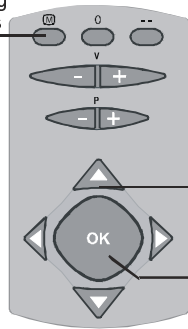

For navigation

To confirm choices

- Press **M** to display the menu.
- Press "▼" or "▲" button to select an icon. Press "▶" for more options.
- Use "▼" or "▲" button to highlight.
- Press "◀" or "▶" buttons to change the settings. Press **OK** to set as default.
- To exit the menu or return from sub-menu screen, press **M**.

## Menu System

### Sound Menu

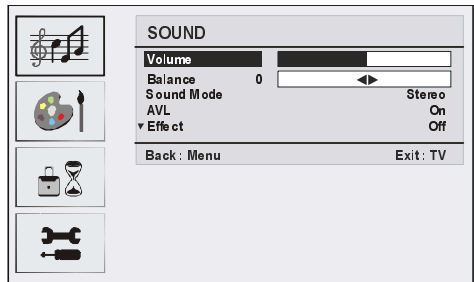

### Volume/HP Volume

- By pressing ▲ / ▼ select **Volume / HP Volume**.
- Press ◀ / ▶ button to change the level of the selected option.

### Balance

- By pressing ▲ / ▼ select **Balance**.
- Press ◀ / ▶ button to change the level of the balance. Balance level can be adjusted between -32 and 32.

### Sound Mode

- By pressing ▲ / ▼ select **Sound Mode**.
- Press ◀ / ▶ button, you can select Mono, Stereo,

Dual I or Dual II mode, only if the selected channel supports that mode.

## AVL

- By pressing ▲ / ▼ select **AVL**.
- Press ◀ / ▶ button to set the AVL to on or off.

## Effect

- By pressing ▲ / ▼ select **Effect**.
- Press ◀ / ▶ button to set Effect to on or off.

## Equalizer

- By pressing ▲ / ▼ select **Equalizer**.
- Press ◀ / ▶ button to change the Equalizer setting. In equalizer menu, the mode can be changed to **Flat**, **Speech**, **Music**, **Personal** and **Jazz**. Select the desired frequency by ▲ / ▼ button and increase or decrease the frequency gain by pressing ◀ / ▶ button.

**Note:** Equalizer menu settings can be altered only when the Sound Mode is in Personal.

## Store Program

- By pressing ▲ / ▼ button, select **Store**.
- Press ▶ or "OK" button to store the adjustments. "Stored" will be displayed on the screen.

## Picture Menu

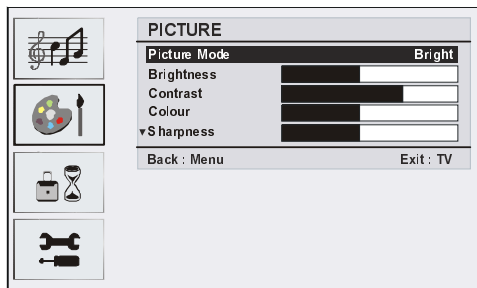

### Picture Mode

- By pressing ▲ / ▼ button, select **Picture Mode**.
- Press ◀ / ▶ button to choose from one of these options: **Bright**, **Standard**, **Soft** and **Manual**.

### Brightness/Contrast/Colour/Sharpness/Hue

- By pressing ▲ / ▼ button, select the desired Option.
- Press ◀ / ▶ button to set the level.

**Hint:** Hue is displayed in picture menu when the TV receives an NTSC signal.

### Colour Temp

- By pressing ▲ / ▼ button select **Colour Temp**.
- Press ◀ / ▶ to choose from one of these options:

**Cool**, **Normal** and **Warm**.

## Room Lightning

- By pressing ▲ / ▼ button select **Room Lightning**.
- By pressing ◀ / ▶ button, you can select one of these options: **Normal**, **Bright** and **Movie**.

## Picture Zoom

- By pressing ▲ / ▼ button select **Picture Zoom**.
- Use ◀ / ▶ buttons, to change picture zoom to **Auto**, **4:3** and **Wide**.

## Store Program

- By pressing ▲ / ▼ button select **Store**.
- Press ▶ or "OK" button to store the adjustments. "Stored" will be displayed on the screen.

## Features Menu

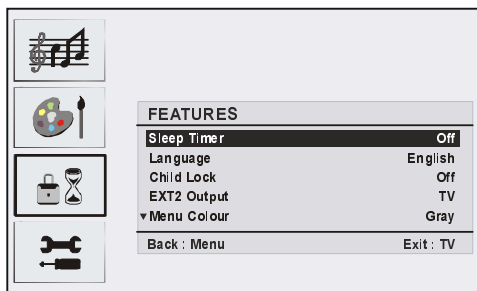

### Sleep Timer

- By pressing ▲ / ▼ select "Sleep Timer".
- Press ◀ / ▶ button to set the Sleep Timer.

The timer can be programmed between Off and 120 minutes in steps of 10 minutes.

### Language

- By pressing ▲ / ▼ button, select **Language**.
- Use ◀ / ▶ button to select the language.

### Child Lock

- By pressing ▲ / ▼ select **Child Lock**.
- Press ◀ / ▶ button to set the Child Lock on or off. When on is selected, the TV can only be controlled by the remote control handset. In this case the control panel buttons, except the Standby button, will not work. Hence, if one of these buttons is pressed, "Child Lock On" will be displayed on the screen.

### EXT2 Output

- By pressing ▲ / ▼ select **EXT2 Output**.
- Use ◀ / ▶ button, to set Ext-2 Out to **TV**, **EXT1**, **EXT3** or **SVHS**.

## Menu Colour

- By pressing ▲ / ▼ select **Menu Colour**.
- Use ◀ / ▶ button to change menu background to **Transparent** or **Gray**.

## Favourite Mode

- By pressing ▲ / ▼ select **Favourite Mode**.
- Use ◀ / ▶ button to set Favourite mode on or off (See Channel List menu Favourites).

## Install Menu

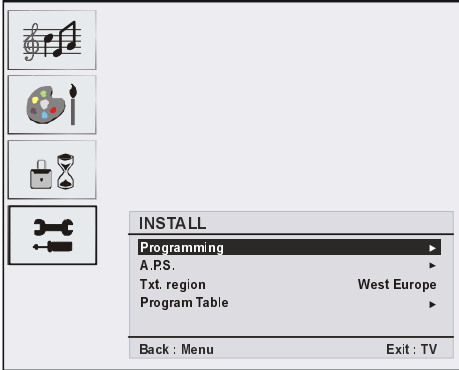

## Programming

- By pressing ▲ / ▼ select **Programming**.
- After pressing “▶” button, programming menu appears on the screen.

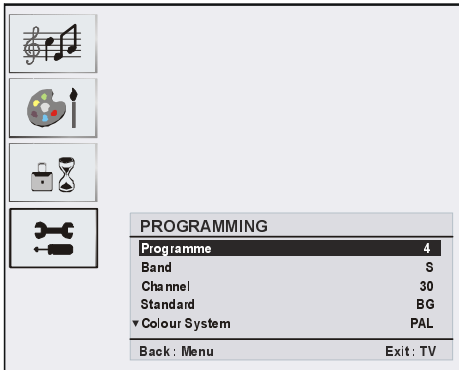

## Programme

- By pressing ▲ / ▼ select **Programme**.
- By pressing “◀” / “▶” button, you can select the program number. You can also enter a number via digit buttons on the remote control. There are 100 program storage between 0 and 99.

## Band

- By pressing ▲ / ▼ select **Band**.

- By pressing “◀” / “▶” button, you can change the channel type to **C** or **S**.

## Channel

- By pressing ▲ / ▼ select **Channel**.
- Use “◀” / “▶” buttons to change the channel number. You can also enter a number via digit buttons on the remote control.

## Standard

- By pressing ▲ / ▼ select **Standard**.
- Use “◀” / “▶” button to change the standard to **B/G**, **D/K**, **I** or **L/L**'.

## Colour System

- By pressing ▲ / ▼ select **Colour System**.
- Use ◀ / ▶ button to change the colour system to **PAL**, **SECAM** or **AUTO**.

## Search

- By pressing ▲ / ▼ select **Search**.
- Press ◀ / ▶ button to start search. The search will stop when a signal is found.

**Note:** If you press the buttons with one-step moves, a frequency of 0.25 Mhz will be advanced. However if you press the buttons continually, it will advance automatically. To stop searching at a certain time, you may press ▲ / ▼ buttons.

## VCR Mode

- By pressing ▲ / ▼ select **VCR mode**.
- Use ◀ / ▶ buttons to set VCR Mode on or off.

**Hint:** If you want to watch a DVD, then you have to set this item to “off”.

## Decoder

You can use this mode to connect any decoder to your TV.

- By pressing ▲ / ▼ select **Decoder**
- Press the ◀ / ▶ buttons to turn it ON or OFF.

When you switch the Decoder setting to OFF, EXT1 output will be muted. In this case, EXT1 output will not be available to display video. If it is switched ON, the EXT-1 output will be the selected video source. Any decoder can be connected to EXT1 to unscramble required video signal.

**Hint:** Decoder setting should be stored separately for each programme.

## Store

- By pressing ▲ / ▼ button select **Store**.
- Press ▶ or “OK” button to store the adjustments. “Stored” will be displayed on the screen.

## A.P.S.

- By pressing ▲ / ▼ button select **A.P.S.**
- Press “▶” button to enter the A.P.S. menu. A.P.S. menu appears on the screen.

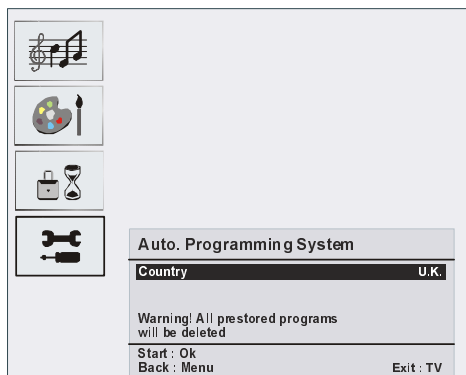

## A.P.S. (Auto Programming System) Country

Press ◀ / ▶ button to select your country. If you want to exit from A.P.S. function, press the “TV” button. For going back, press “(M)”.

When you press OK button for starting APS, all stored programs will be erased and the following screen will be displayed.

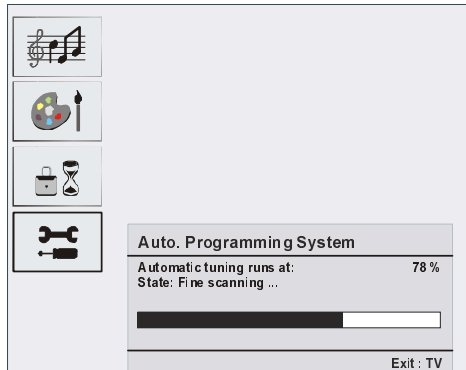

Whenever you press the “TV” button, A.P.S. function stops and Channel table appears on the screen.

If you wait until the end of A.P.S., Channel table is displayed with the programmes found and located.

## Teletext Region

- By pressing ▲ / ▼ button select **Teletext Region**.
- Using ◀ / ▶ buttons in the Install menu, select your Teletext region. There are five options to select : **West Europe, East Europe, Turk/Gre, Cyrillic and Arabic/Hebrew.**

## Install menu in AV modes

The following screen appears in the install menu:

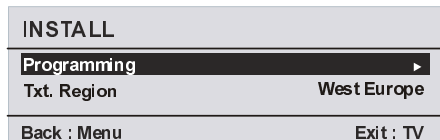

## Programming

- By pressing ▲ / ▼ select **Programming Mode**.
- After pressing “▶” button, programming menu appears on the screen.

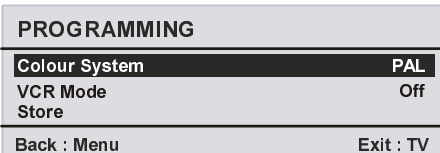

## Colour System

- By pressing ▲ / ▼ select **Colour System**.
- By pressing “◀” / “▶” button, you can change the colour system to **PAL, SECAM or AUTO**.

## Program Table

| Program Table |       |     | P01   |
|---------------|-------|-----|-------|
| P01           | BBC 1 | P11 | ..... |
| P02           | C 04  | P12 | ..... |
| P03           | ..... | P13 | ..... |
| P04           | ..... | P14 | ..... |
| P05           | ..... | P15 | ..... |
| P06           | ..... | P16 | ..... |
| P07           | ..... | P17 | ..... |
| P08           | ..... | P18 | ..... |
| P09           | ..... | P19 | ..... |
| P10           | ..... | P20 | ..... |

| Delete | Move  |
|--------|-------|
| Name   | A.P.S |

Exit : TV

By moving the cursor in four directions you can reach 20 programmes in the same page. You can scroll the pages up or down by pressing the navigation buttons to see all the programmes in TV mode (except the AV mode). By cursor action, programme selection is done automatically.

## Name:

To change the name of a programme, select the programme and press the YELLOW button.

The first letter of the selected name turns blue. Press



▲ / ▼ button to change that letter and ◀ / ▶ button to select the other letters. By pressing the YELLOW button, you can store the name.

### Move:

Select the programme that you want to insert by navigation buttons. Press the GREEN button. By navigation buttons, move the selected programme to the decided programme space and press the GREEN button again.

### Delete:

To delete a programme, press the RED button. Pressing the RED button again erases the selected programme from the programme list, and the programmes below shift one up.

### APS (Auto Programming System)

When you press the BLUE button for APS, Auto Programming System Menu will appear on the Screen.

### Favourite Mode:

You can set various channels as favourites so that only the favourites are navigated. To set a favourite, use navigation buttons to select a channel and then press the "TXT" item. The channel selected as a favourite appears in the Program Table with a

favourites icon (😊) against the channel name. For removing a favourite, carry out the same operation. To exit, press MENU.

Favourite mode must be set to on in the features menu.

## PC Mode

### Installation

- Power off both Computer and Display before making any connections.
- Set your PC's resolution correctly before connecting to the TV. See the table on Appendix page.
- Use 15-pin display cable to connect a PC to the LCD TV. (D-SUB)

### Menu System in PC mode

#### Sound Menu/Feature Menu

The items in these menus are described in **Sound & Feature Menu** explained in "Menu System".

#### PC Picture Menu

By pressing ▲ / ▼ button, select the second icon. PC Picture menu appears on the screen.

Brightness, Contrast and Colour Temperature adjustments in this menu are identical to adjustments defined in TV picture menu in "MENU SYSTEM".

#### Geometry Menu

By pressing ▲ / ▼ button, select the fourth icon. Geometry menu appears on the screen.

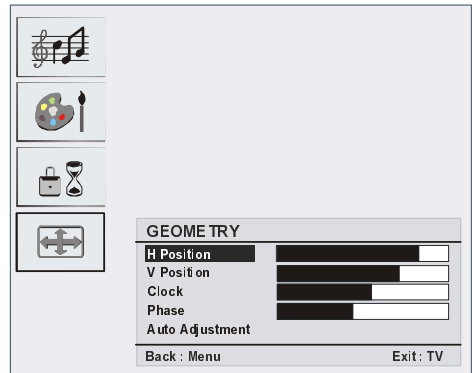

#### H (Horizontal) Position

This item shifts the image horizontally to right hand side or left hand side of the screen.

- By pressing ▲ / ▼ button select **H. position**.
- Use ◀ / ▶ button to adjust the value.

#### V (Vertical) Position

This item shifts the image vertically towards the top or bottom of the screen.

- By pressing ▲ / ▼ button select **V. position**.
- Use ◀ / ▶ button to adjust the value.

#### Clock

Clock adjustments correct interference that appear

as vertical banding in dot intensive presentations like spreadsheets or paragraphs or text in smaller fonts.

- Use ◀ / ▶ button to adjust the value.

### Phase

Depending on the resolution and scan frequency that you input to the TV Set, you may see a hazy or noisy picture on the screen. In such a case you can use this item to get a clear picture by trial and error method.

- Use ◀ / ▶ button to adjust the value.

### Auto Adjustment

If you shift the picture horizontally or vertically to an unwanted position, use this item to put the picture into correct place automatically.

- Select **Auto Adjustment** item by using ▲ / ▼ buttons.
- Press ▶ or “OK” button.

**Warning:** Auto position adjustment recommended to be done with the full screen image for the proper adjustment.

### Sound in PC mode

Connect the PC's Audio output to the TV's **Audio Input** sockets with an audio cable.

## Other Features

### TV Status

**Programme Number**, **Programme Name**, **Sound Indicator** and **Zoom Mode** are displayed on the screen when a new programme is entered.

### Mute Indicator

It is placed in the upper side of the screen when enabled.

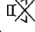

To cancel mute, there are two alternatives; the first one is pressing the  button and the second one is increasing/decreasing the volume level.

### AV Modes

By pressing the AV button you can switch your TV to AV modes (except being in teletext). Pressing this button consecutively will switch the TV in one of the optional AV modes: **TV**, **EXT1**, **EXT2**, **EXT3**, **SVHS**, **PC**. To remove source osd from screen press “TV” or “**M**” button. In order to quit the AV Mode, press the **TV** or the “**P+**, **P-**” button.

## Menu System in AV Modes

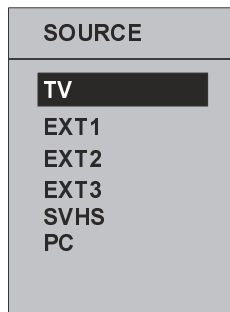

### Sound/Picture/Features/Install Menu

The items in these menus are described at **Sound**, **Picture**, **Features** and **Install Menu** explained in “Menu System”.

## Teletext

Teletext is an information system that displays text on your TV screen. Using the Teletext information system you can view a page of information on a subject that is available in the list of contents (index).

On screen display is not available in text mode.

Contrast, brightness or colour control is not available, but volume control is available in text mode.

### To operate Teletext

- Select a TV station on which Teletext is being transmitted.
- Press (TELETEXT) “TXT” button. Usually the list of contents (index) is displayed on the screen.

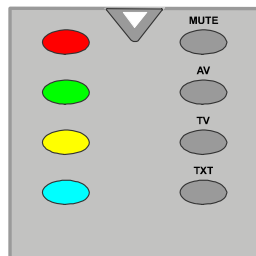

### To select a page of Teletext

- Press the appropriate digit buttons for the required Teletext page number.

The selected page number is displayed at the top left corner of the screen. The Teletext page counter searches until the selected page number is located, so that the desired page is displayed on the screen.

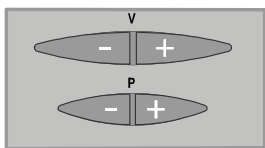

- Press “**P+**” button to move the Teletext screen forward one page at a time.
- Press “**P-**” button to move the Teletext screen backward one page at a time.

## Fastext

Your TV supports the 10 page Teletext system. When the page number of any of the 10 pages in memory is entered, the system will not search for the requested page; instead it will display the page automatically. If the requested page is not in memory, the system will search for the requested page number and save the 10 pages including the requested page into memory after finding it.

### For Fastext

The subject-heading for the information may have a particular colour.

- Press an appropriate **RED, GREEN, YELLOW** or **BLUE** button in order to reach the relevant page quickly.

## TOP text

TOP text mode of operation will be activated automatically according to the transmission.

- If TOP text transmission is present, colour coded buttons will appear in status row.
- If TOP text transmission is not present, status row will not appear.

The subject-heading for information may be located in colored box.

In Top mode the “**-P**” or “**P+**” commands will request the next or previous page respectively. If TOP text transmission is not available, in case of operation of these commands, wraparound occurs. For example page 100 appears to be one greater than page 199.

## Connect Peripheral Equipment

### Via The Scart

The TV has 2 Scart sockets. If you want to connect peripherals (e.g. video, decoder, etc.) which have Scart sockets to the TV, you can use SCART socket of the TV.

**Note:** *If an external device is connected via the Scart sockets, the TV will automatically switch to AV mode. If both sockets are employed at the same time, SCART 1 becomes the preferential.*

### Via Aerial Input

If the device you want to connect does not have a Scart socket, you should connect it to the Aerial input of the TV.

**If the VCR is connected via Aerial input, it is suggested to use Programme 0.**

### Decoder

If you are subscribed to cable TV offers, the organisation will supply you a corresponding decoder unit to allow the programmes to be unscrambled.

*For further information consult your dealer.*

### Connect a decoder with an aerial socket to the TV

- Connect the aerial cable.

### Connect a decoder without an aerial socket to the TV

- Connect the decoder to the EXTERNAL socket of TV with a RCA cable. Through the SCART/RCA socket of the decoder, you may attain a better display resolution.

### TV And Video Recorder

- Connect the aerial cables.

Better picture quality can be obtained if you also connect a Scart cable to **SCART** sockets.

### Playback NTSC

- Connect NTSC VCR player to a Scart socket of the TV.

Then, press the “**AV**” button to select EXT1 or EXT2.

### Copy Facility

Source selection for **VCR** recording.

- Select **Feature** menu.
- Select **SCART 2 Out** by pressing ◀ / ▶ button.
- For copying the picture that comes from the tuner, select SCART 1.

## Camera And Camcorder

### To Connect To AV Input

Connect your camera or camcorder to AV input of the TV.

- Connect your equipment to the TV via **VIDEO** (yellow), **AUDIO R** (red) and **AUDIO L** (white) inputs. You must connect the jacks into the input with the same colour.

### To Connect To S-VHS Input

Connect your camera or camcorder S-VHS input of the TV.

- Connect your equipment to the TV via S-VHS input and audio inputs of AV inputs by using S-VHS cables.

## Connect The Decoder To The Video Recorder

Some video recorders have a special Scart socket for decoder.

- Connect a Scart cable to the Scart socket of your decoder and to the special Scart socket of your video recorder. Refer to the booklet of your video recorder.

## Connecting Headphones

Use the stereo headphone socket of the TV, to connect headphones.

*Note: If you want to connect more equipment to your TV, consult your dealer.*

## Audio Lineout

To connect the sound of your TV to an external amplifier, use the Audio Line output sockets.

## Tips

### Care Of The Screen

Clean the screen with a slightly damp, soft cloth. Do not use abrasive solvents as they may damage the TV screen coating layer.

### Poor Picture

Have you selected the correct TV system? Is your TV set or house aerial located too close to non-earthed audio equipment or neon lights, etc.?

Mountains or high buildings can cause double pictures or ghost images. Sometimes you can improve the picture quality by changing the direction of the aerial.

Is the picture or Teletext unrecognisable? Check if you have entered the correct frequency.

The picture quality may degrade when two peripherals are connected to the TV at the same time. In such a case, disconnect one of the peripherals.

### No Picture

Is the aerial connected properly? Are the plugs connected tightly to the aerial socket? Is the aerial cable damaged? Are suitable plugs used to connect the aerial? If you are in doubt, consult your dealer.

**No Picture** means that your TV is not receiving a transmission. Have you selected the correct button on the remote control? Try once more.

### Sound

You can not hear any sound. Did you perhaps interrupt the sound, pressing the  button?

Sound is coming from only one of the speakers. Is the balance set to one extreme? See **Sound** menu.

### Remote Control

Your TV no longer responds to the remote control. Perhaps the batteries are exhausted. If so you can still use the local buttons at the bottom of the TV.

## Appendix A: Aerial Connection

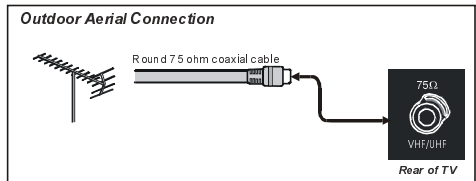

## Specifications

### TV BROADCASTING

PAL/SECAM B/G D/K K' I/I' L/L'

### RECEIVING CHANNELS

VHF (BAND I/III)

UHF (BAND U)

HYPERBAND

CABLE TV (S1-S20/ S21-S41)

### NUMBER OF PRESET CHANNELS

100

### CHANNEL INDICATOR

On Screen Display

### RF AERIAL INPUT

75 Ohm (unbalanced)

### OPERATING VOLTAGE

12V DC.

### AUDIO

German+Nicam Stereo

### AUDIO OUTPUT POWER ( $W_{RMS.}$ ) (%10 THD)

2 x 3

### POWER CONSUMPTION (W)

60W

1.2 W (Stand-by)

### PANEL

4:3 display, 20" Screen Size

### DIMENSIONS (mm)

| DIMENSIONS (mm) |     |     |             |              |
|-----------------|-----|-----|-------------|--------------|
| D               | L   | H   | Weight (kg) |              |
| 220             | 530 | 466 | 9           | With foot    |
| 88              | 530 | 437 | 7,6         | Without foot |

## Appendix B: PC Input Typical Display Modes

The display has a maximum resolution of 800 x 600, frequency range of 56-75 Hz.

The following table is an illustration of some of the typical video display modes.

| Mode | Resolution |          | Frequency (Hz) |          |
|------|------------|----------|----------------|----------|
|      | Horizontal | Vertical |                |          |
| 1    | 640        | 480      | 60             | IBM, VGA |
| 2    | 720        | 400      | 70             | IBM, VGA |
| 3    | 800        | 600      | 56             | VESA     |
| 4    | 800        | 600      | 60             | VESA     |
| 5    | 640        | 480      | 72             | VESA     |
| 6    | 640        | 480      | 75             | VESA     |
| 7    | 800        | 600      | 72             | VESA     |
| 8    | 800        | 600      | 75             | VESA     |
| 9    | 1024       | 768      | 60             | VESA     |
| 10   | 1024       | 768      | 70             | VESA     |
| 11   | 1024       | 768      | 75             | VESA     |
| 12   | 1280       | 720      | 60             | VESA     |
| 13   | 1280       | 768      | 60             | VESA     |

OPTIONAL

### Information for users applicable in European Union countries



This symbol on the product or on its packaging means that your electrical and electronic equipment should be disposed at the end of life separately from your household wastes. There are separate collection systems for recycling in EU. For more information, please contact the local authority or the dealer where you purchased the product.

# Your Guarantee of Excellence

Thank you for purchasing this Hitachi Television.

In the unlikely event that this product should develop a fault, we undertake to replace or repair any part of the product which fails due to a manufacturing defect within 12 months of the date of purchase provided that:

- i) The product has been installed and used only in accordance with the instructions supplied with the product
- ii) The product has not been repaired, maintained, or modified by any person other than an Hitachi authorised engineer
- iii) The product serial number has not been removed or altered

This guarantee does not apply to product acquired second hand or for commercial or communal use

This guarantee does not cover the replacement of exhausted batteries, the adjustment of user controls, or aerial alignment.

Any parts replaced under this guarantee shall become the property of Hitachi Europe Ltd.

Please note that evidence of the date of purchase will be required before any service under this guarantee is carried out.

**THIS GUARANTEE DOES NOT AFFECT YOUR STATUTORY RIGHTS.**

**IN ALL CASES OF DIFFICULTY PLEASE CONSULT YOUR HITACHI DEALER**

# HITACHI

## Inspire the Next

Hitachi, Ltd.  
Consumer Business Group  
Shin-Otemachi Bldg 5f, 2-1, Otemachi 2-Chome,  
Chiyoda-Ku, Tokyo 100-0004 Japan

### HITACHI EUROPE LTD.

Consumer Affairs Department  
PO Box 3007  
Maidenhead  
Berkshire SL6 8ZE  
**UNITED KINGDOM**  
Tel: 0870 405 4405  
Email: consumer.mail@hitachi-eu.com

### HITACHI EUROPE GmbH

Munich Office  
Dornacher Strasse 3  
D-85622 Feldkirchen bei München  
**GERMANY**  
Tel: 089-991 80-0  
Fax: 089 - 991 80 -224  
Hotline: 0180 - 551 25 51 (12ct/min.)  
Email: dmg-mun.service@hitachi-eu.com

### HITACHI EUROPE S.r.l.

Via T. Gulli n.39  
20147 MILAN  
**ITALY**  
Tel: 02 487861  
Fax: 02 48786381  
Servizio Clienti  
Tel. 02 38073415  
Email: customerservice.italy@hitachi-eu.com

### HITACHI EUROPE S.A.S

Lyon Office  
Digital Media Group  
94 Quai Charles de Gaulles, 69006 Lyon  
**FRANCE**  
Tel: 04 72 14 29 70  
Fax: 04 72 14 29 99  
Email: france.consommateur@hitachi-eu.com

### HITACHI EUROPE LTD.

Benelux Branche Office  
Bergensesteenweg 421  
1600 Sint-Pieters-Leeuw  
**BELGIUM**  
Tel : 0032/2 363 99 01  
Fax: 0032/2 363 99 00  
Email : info@hitachi.be

### HITACHI EUROPE LTD.

Kodanska 46  
101 00 Praha 10  
**CZECH REPUBLIC**  
Tel : 234 064 512  
Fax: 234 064 213  
Email : dmg.eeu@hitachi-eu.com

### HITACHI EUROPE S.A.

364, Kifissias Ave. & 1, Delfon Str.  
152 33 Chalandri  
Athens  
**GREECE**  
Tel: 1-6837200  
Fax: 1-6835694  
Email: dmgservice.gr@hitachi-eu.com

### HITACHI EUROPE S.A.

Gran Via Carles III, 86 Planta 5ª  
Edificios Trade - Torre Este  
08028 Barcelona  
**SPAIN**  
Tel: 93 409 2550  
Fax: 93 491 3513  
Email: atencion.cliente@hitachi-eu.com

### HITACHI EUROPE AB

Box 77  
S-164 94 KISTA  
**SWEDEN**  
Tel: 08 562 711 00  
Fax: 08 562 711 11  
Email: csgswe@hitachi-eu.com

### HITACHI EUROPE AB

(Norway Branch Nuf)  
Strandveien 18  
1366 Lysaker  
**NORWAY**  
Tel: 67519030  
Fax: 67519032  
Email: csgnor@hitachi-eu.com

### HITACHI EUROPE AB

Egebækvej 98  
2850 Nærum  
**DENMARK**  
Tel: 43 43 60 50  
Fax: 43 43 60 51  
Email: csgden@hitachi-eu.com

### HITACHI EUROPE AB

Lars Sonckin kaari 16  
FIN-02600 ESPOO  
**FINLAND**  
Tel: 010-8503085  
Fax: 010-8503086  
Email: info.finland@hitachi-eu.com