

INSTRUCTION MANUAL

19" Wide screen LCD TV with DVB & DVD

Model No.: C 1997F

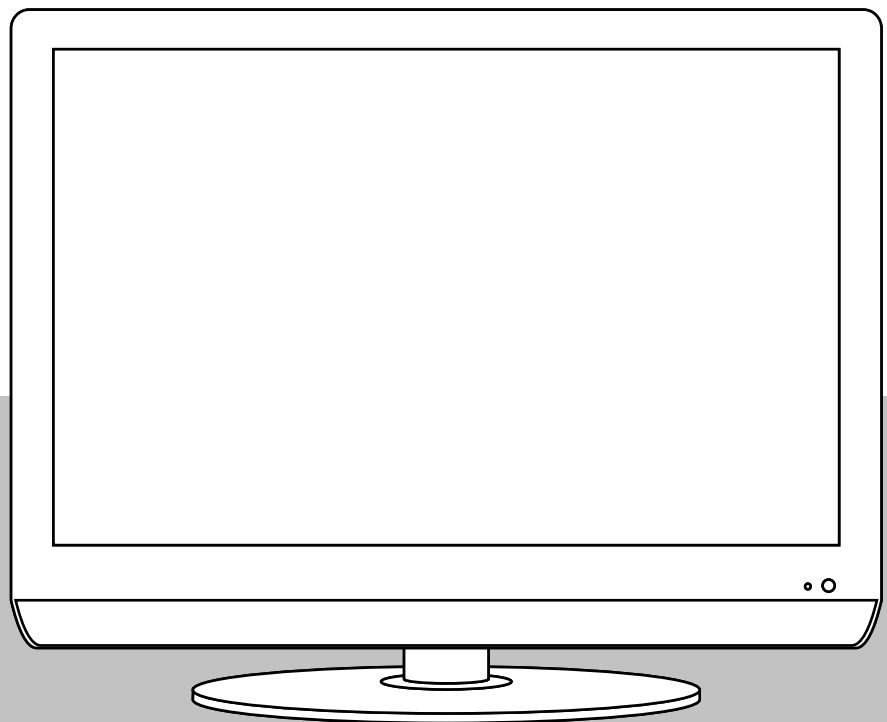

Read all of the instructions before using this TV and keep the instruction manual in a safe place for future reference.

LCD Screen

Although the LCD screen is made with high-precision technology and 99.99% or more of the pixels are effective, black dots may appear or bright points of light (red, blue or green) may appear constantly on the LCD screen and is not a malfunction.

Safety Precautions

- Caution 1
- Safety Information 2

User Guidance Information

- Names of each part(Front View) / Accessories 3
- Names of each part(Back View) 4
- Remote control 5-6
- Precautions / How to use remote control 7

Basic Use

- Powering the LCD TV / Selecting input source 8

Application

- CustomizingTV SETTINGS 10
- Customizing the PICTURE Settings 12
- Customizing the SOUND Settings 13
- Customizing the SETUP Settings 14
- Customizing the EXTRAS Settings 15
- DVD operation 16
- Disc care 20

Maintenance and Service

- Trouble shooting 21
- Specifications 22



The lightning flash with arrowhead symbol, within an equilateral triangle is intended to alert the user to the presence of un-insulated "dangerous voltage" within the products enclosure that may be of sufficient magnitude to constitute a risk of electric shock to the persons.



The exclamation point within an equilateral triangle is intend to alert the user to the presence of important operating and maintenance (servicing) instructions in the literature accompanying the appliance.

Correct disposal of this Product



"Correct Disposal of Product"

Produced after 13 August 2005. Waste electrical should not be disposed of with household waste. Please recycle where facilities exist. Check with your local authority or retailer for recycling advice.



This unit is a "CLASS 1" laser product. This product uses a visible laser beam which could cause hazardous radiation exposure. Ensure the recorder is operated as instructed. Do not remove any covers or look into the DVD drawer opening whilst power is applied. Do NOT modify or adjust any controls that may affect laser emissions. Should the appliance become faulty consult a qualified technician.



This appliance complies with European Safety and Electrical directives

To ensure reliable and safe operation of this equipment, please read carefully all the instructions in this user guide, especially the safety information below.

Electrical safety

- The TV set should only be connected to a mains supply which matches that stated on the label on the mains adaptor
- To prevent overload, don't share the same mains supply socket with too many other items of equipment.
 - Do not place any connecting wires where they may be stepped on or tripped over.
 - Do not place heavy items, which may damage the leads, on them.
 - Hold the Mains plug, not the wires, when removing from a socket.
 - During a thunderstorm or while leaving the TV for long periods, disconnect the aerial (if outdoor) and mains adaptor from the supply.
 - Do not allow water or moisture to enter the TV or mains adaptor. Do NOT use in wet or moist areas such as Bathrooms, steamy kitchens or near swimming pools.
- Pull the plug out immediately, and seek professional help if:
 - the mains plug or cable is damaged
 - liquid is spilt onto the set, or if it is accidentally exposed to water or moisture
 - anything accidentally penetrates the ventilation slots
 - the set doesn't work normally.
 - Do NOT remove the safety covers. There are no user serviceable parts inside. You may invalidate the warranty. Qualified personnel must only service this apparatus.
 - To avoid battery leakage, remove exhausted batteries from the remote control handset, or when not using for a long period.
 - Do NOT break open or throw exhausted batteries on a fire.

Physical safety

- Do NOT block ventilation slots in the back cover. You may place the TV in a cabinet, but ensure at least 5cm (2") clearance all around.
- Do NOT tap or shake the TV screen, you may damage the internal circuits. Take good care of the remote control, do not drop.
- To clean the TV use a soft dry cloth. Do NOT use solvents or petrol based fluids. For stubborn stains, you may use a damp soft cloth with dilute detergent.

Getting Started

Names of each part

Front View

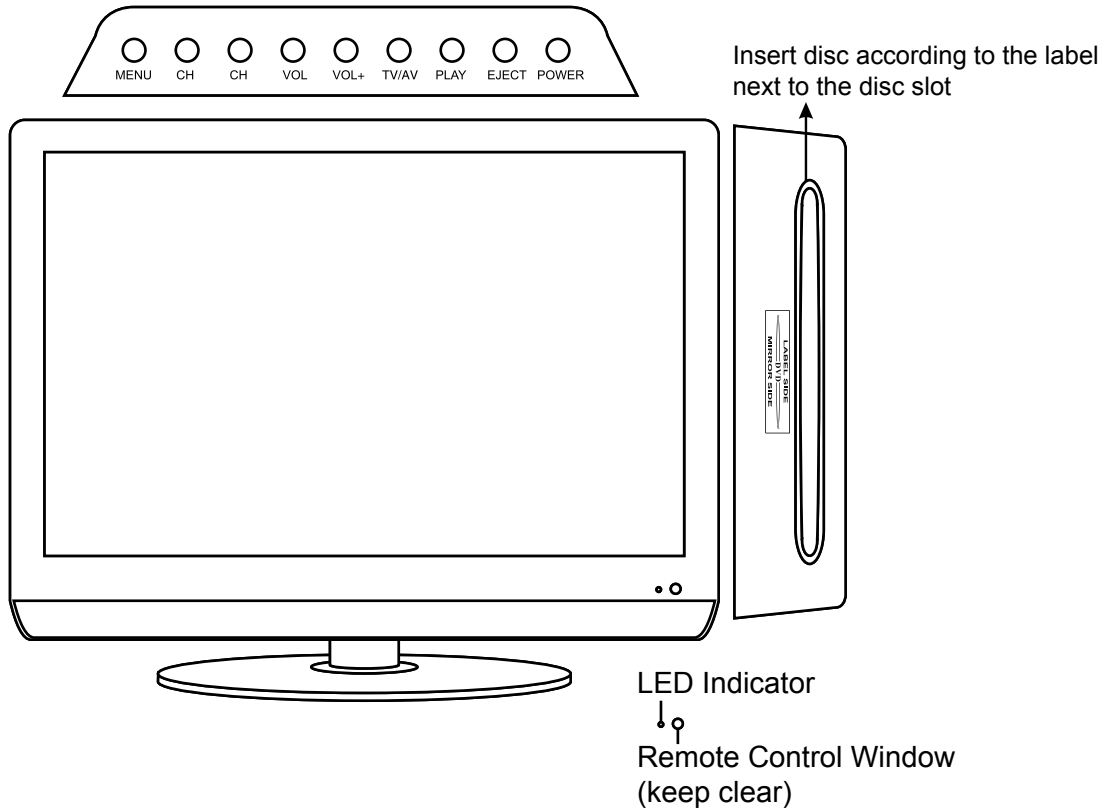

Accessories

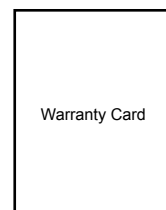
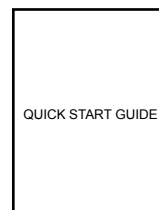
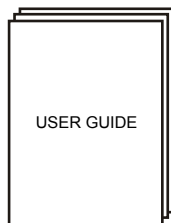

Remote Control

Power cable

Batteries for Remote Control

USER GUIDE

QUICK START GUIDE

Warranty Card

Connections

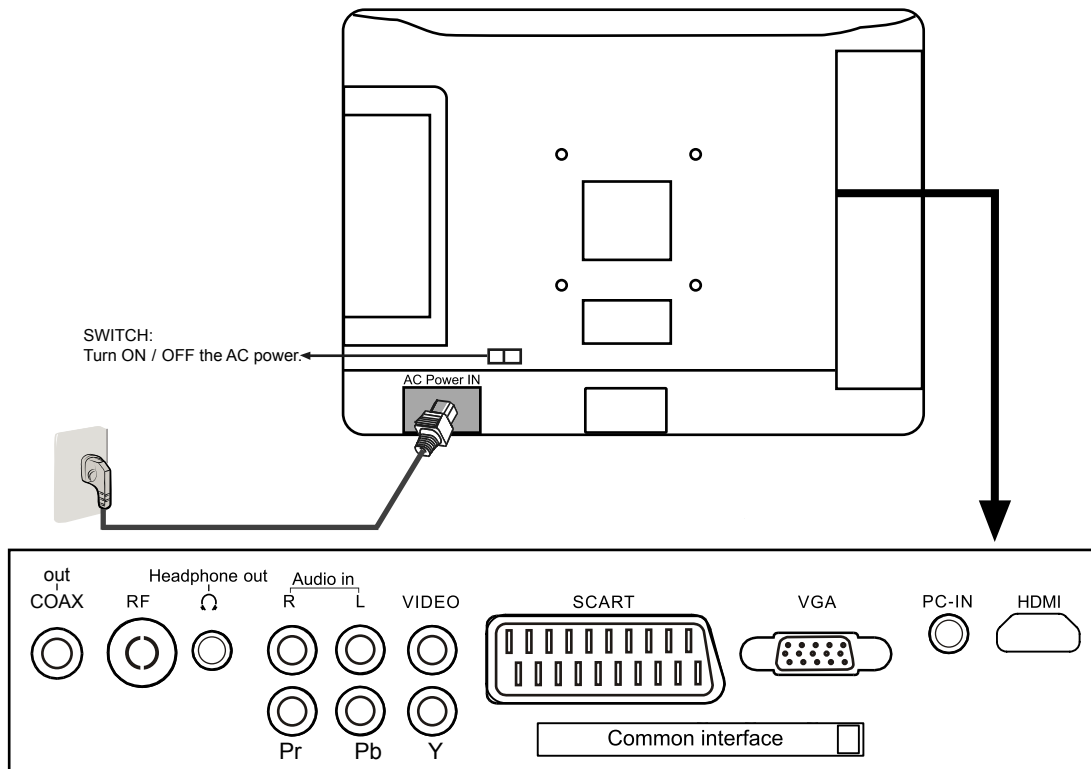

Name	Function Description
AC POWER IN	Connect to power supply 100 - 240V AC 50/60HZ
HDMI	Connect to the HDMI socket of your DVD or Satellite Box
VGA IN	Connect to the PC VGA output to display PC graphics
SCART	Connect to the scart input / output of external equipment
S-Video IN	Connect to the S-Video output of external equipment
(AUDIO)L/R IN	Audio signal input for AV
PC Audio IN	PC audio input
Ω Headphone	Connect headphone
RF	Connect to Aerial, Tuner input 75 Ohm Coaxial Socket.
COAX out	Output to Audio amplifier
Common Interface	CI slot (Pay as you view card slot)
YPbPr	Connect to the YPbPr output on external equipment.

Wall Mounting

The TV is provided with mounting holes for a VESA 75mm approved wall mounting bracket (NOT SUPPLIED). Remove the screws holding the base to the base bracket and lift the base away (do not remove the base mounting bracket). Mount the VESA bracket using 4 x M4x 10 Iso metric threaded screws (not supplied). Do not use screws longer than 10 mm, damage will occur to the internal parts. Fit the wall bracket securely following the manufacturers instructions.

● Functions of remote control buttons

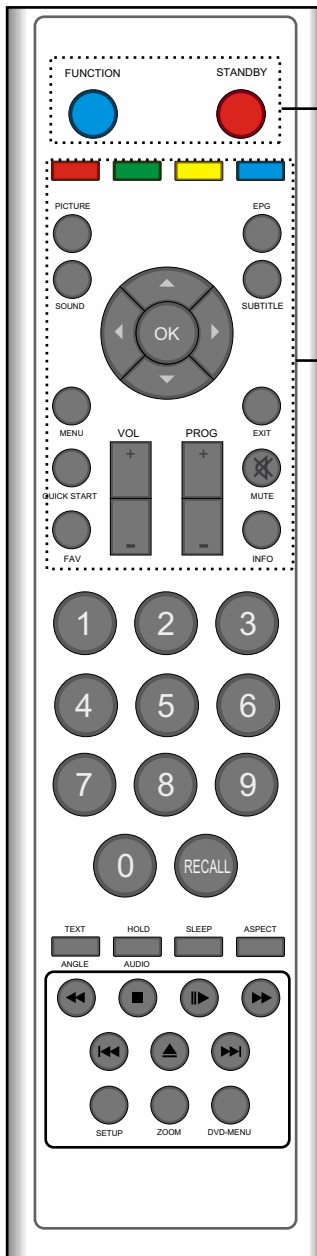

FUNCTION

Press to display the input source menu.(see page 14)

STANDBY

Turn the TV on/standby.

Colour buttons: short cuts-follow the coloured links in the text.

PICTURE: Select the picture mode.

SOUND: Select the sound mode.

EPG: Electronic Programme Guide (DTV only).

SUBTITLES: For DTV and DVD only.

Cursor left/right/up/down: Cursor buttons used in menus.

OK: Confirm Button / Display channel list.

MENU: System setup menu.

QUICK START: To tune in your TV.

FAV: Means favorite, to display the favorite channel list defined by you.

EXIT: Exit the OSD menu.

MUTE: Mutes the Audio.

INFO: Displays now and next brief information.

VOL+/-: Adjust the volume.

PROG+/-: Skip through the channels.

Remote Control

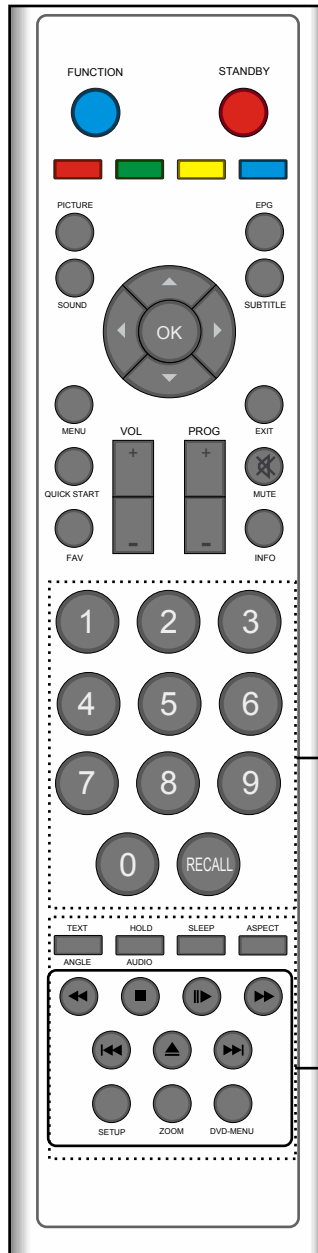

0-9

Choose channel directly. Number buttons for DVD.

RECALL: Return to the previous channel viewed.

TEXT: Turn off/on the Teletext display.

HOLD: Hold or carry on the current subpage.

SLEEP: Standby timer.

ASPECT: Press to change the display mode of the - screen.

ANGLE: Select DVD picture angle.

AUDIO: To select audio language.

◀◀ : DVD fast reverse

■ : stop DVD program.

||▶ : play/pause DVD program.

▶▶ : DVD fast forward.

◀◀ : DVD previous chapter.

▲ : load/eject DVD disc.

▶▶ : DVD next chapter.

SETUP: DVD setup menu

ZOOM: adjust picture size in DVD mode.

DVD-MENU : DVD Disc Menu.

Avoiding Remote Control Problems

1. Check the polarity (+,-) of the batteries in the remote control.
2. Check that the batteries have power.
3. Check that the LCD TV is powered and that it is properly plugged in.

Inserting Batteries in the Remote Control

1. Open the cover completely.
2. Insert the two supplied batteries (AA, 1.5V). Ensure that the polarities (+ and -) of the batteries are aligned correctly.
3. Slide back the cover.

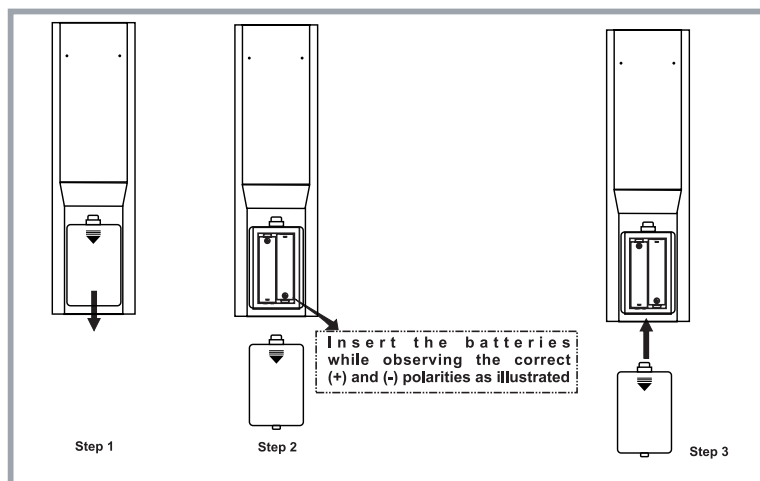

⚠ CAUTION : Use the correct batteries to avoid damage to the remote control.
Dispose of used batteries according to the national code (Recycling program).

How to use remote control

- The remote control should be operated within 30feet(7m) and 30° to the left and the right of the IR receiver at the front of the LCD TV.

Powering the LCD TV

Power On / Off the LCD TV

Power Switch On / Off 

Press the power switch to setting  and the standby indicator will light red.

To turn on the LCD TV

Press the power button on the LCD TV or the Standby button on the remote control, the standby indicator will light green.

To turn off the LCD TV

Press the power button on the LCD TV or the Standby button on the remote control, the standby indicator will light red.

To turn the LCD TV off completely press the power switch to setting  and the standby indicator light will extinguish.

When you initially turn on the LCD TV you will see the first time installation menu as below:

Please make sure the TV aerial is plugged into the RF socket at the rear of the tv.

Press the OK button on the remote control to start the tuning procedure. This process will find all available ATV and DTV channels and store them.

By pressing the Quick Start button the first time installation can be recalled at any time.



Selecting Input Source

You can select the input source menu by pressing the function button on the remote control or the TV / AV button on the LCD TV.

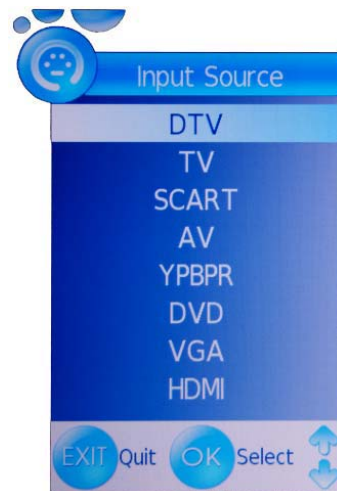
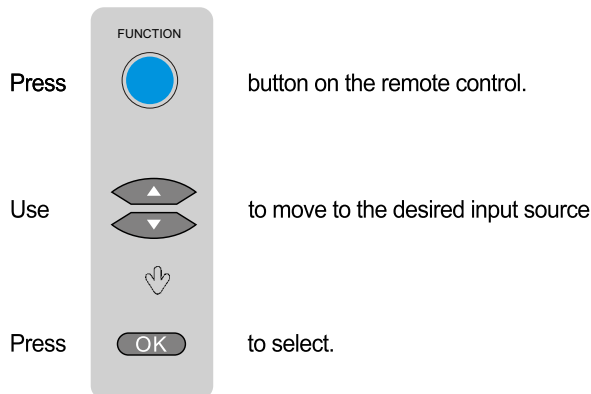

Operating the Menu

1. Turn the LCD TV on
2. Press the MENU button on the Remote Control.
3. Use the ◀ and ▶ buttons to navigate through the menu.
4. Press the EXIT button to exit the Menu.

TV SETTINGS MENU

Allows you to search channels and set up a variety of channel options.
(Select TV source)



PICTURE MENU:

Allows you to make adjustments to your picture settings.
(select TV source for example)



SOUND MENU:

Allows you to customize the sound options and effects.
(Select TV source for example)

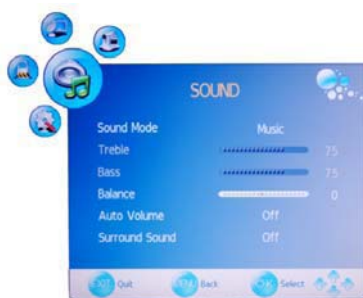

SETUP MENU:

Allows you to setup a variety of setup options.
(Select TV source)



EXTRAS MENU:

Allows you to set up a variety of lock/time and setup options.
(Select TV source)



Note: Use the left right up down navigation buttons to select the required options in the menus.

Customizing the TV Settings



Use the ◀ and ▶ buttons to select the **TV SETTINGS** menu(as the picture above), press ▼ button to enter the menu.

The TV SETTINGS menu includes the following options :

Auto Scan

Press ◀ and ▶ buttons to select the Country, and press ▼ and ▲ buttons to select “Start”, and press OK button to start auto tuning.

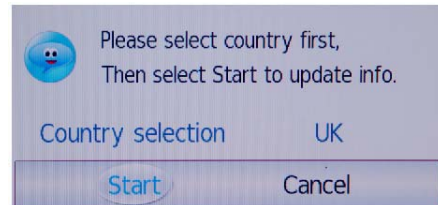

DTV Manual Scan

Press ▶ button to enter the submenu.
Press ◀ or ▶ button to select a channel and press OK button to start search.

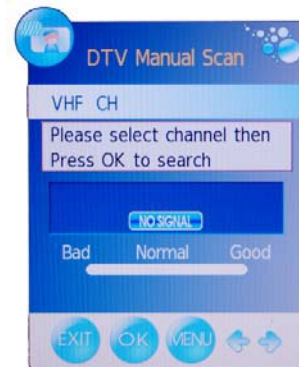

Customizing the TV Settings

ATV Manual Tuning

Press ► button to enter the submenu.

Storage To

Select a position to store the program.

Current CH

Select a program you want to tune.

Search

Press ◀ and ▶ buttons to manual search.

Fine-Tune

Press ◀ and ▶ buttons to fine-tune.

Skip

Select "Yes" to skip the program when you scan the programs by CH+/-

Frequency

Display the current channel's frequency.

Press RED button to save all the setups you have changed.



Program Edit: Press ► button to enter the submenu as the following picture.

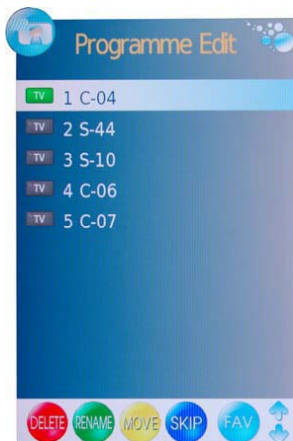

Delete: Select a channel and press the red rectangular button on the remote control, Delete will appear on the right of the program edit menu next to the channel you have chosen. Press the red rectangular button again to confirm the delete, the channel will be deleted. However if you decide not to continue to delete press the menu button to quit.

Rename: Select a program, and press GREEN button, then you can use ◀ and ▶ buttons to select the position of the program's name you want to change, and press ▼ and ▲ buttons to change the character, press ◀ or ▶ button to confirm the change. Press menu to exit and it will automatically save the current setting. (It can only rename ATV program.)

Move: Select a program, and press YELLOW button, then you can use ▼ and ▲ buttons to change the position of the program, press YELLOW again to confirm the change. Press menu to exit and it will automatically save the current set.

Skip: Select a channel and press the blue rectangular button to label the channel, as long as the channel has a skip label it will be skipped when searching through the channels with the Prog+ /Prog- buttons.

FAV: Select a program, press FAV button to set the program as the favorite channel.

Note: The function RENAME and MOVE can not be used in DTV mode.

CI Information

Please contact your "pay per view" provider who can supply a viewing card and cam unit with instructions for their use.



Customizing the PICTURE Settings



Use the ◀ and ▶ buttons to select the **PICTURE** menu(as the picture above), press ▼ button to enter the menu.

The PICTURE menu includes the following options :

Picture Mode	Choose from Standard, Dynamic, User and Mild.
Contrast	Controls the difference between the brightest and darkest regions of the picture.
Brightness	Controls the overall brightness of the picture
Colour	Control the colour.
Sharpness	Increase this setting to see crisp edges in the picture; decrease it for soft edges .
Tint	Controls the tint (NTSC mode only).
Colour Temperature	Choose from Standard, Cool, User and Warm.
Aspect Ratio	Choose from Auto, 4:3, 16:9, Zoom1 and Zoom2.
Noise Reduction	Reduce any interference noise by selecting “ON”.

Customizing the SOUND Settings

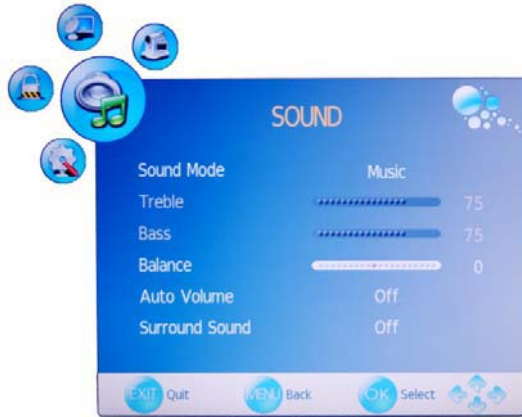

Use the ◀ and ▶ buttons to select the **SOUND** menu(as the picture above), press ▼ button to enter the menu.

The SOUND menu includes the following options :

Sound Mode	Allows you to select among: Standard, Music, Movie, Sports and User.
Treble(Can be adjusted when the sound mode is User)	Controls the relative intensity of higher pitched sounds.
Bass(Can be adjusted when the sound mode is User)	Controls the relative intensity of lower pitched sounds.
Balance	To adjust the balance of the left and right sound track, or turn off the volume of the left and right sound track.
Auto Volume	Control the volume of the program automatically when you turn on the function by selecting "On".
Surround Sound	Turn on/off the surround sound function by selecting "on"/"off".

Customizing the SETUP Settings

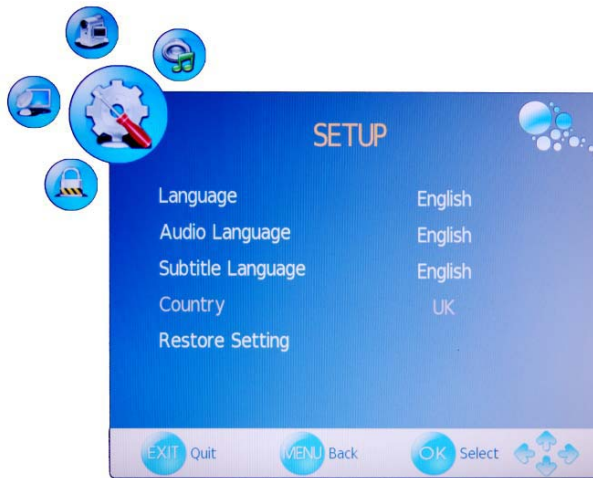

Use the ◀ and ▶ buttons to select the **OPTION** menu(as the picture above), press ▼ button to enter the menu.

The SETUP menu includes the following options:

Language	Allows you to select menu language.
Audio Language (can be selected in tv mode)	Allows you to select audio language.
Subtitle Language (can be selected in tv mode)	Allows you to select subtitle language.
Country	Defaulted to UK.
Reset Setting	Press ▶ button to restore factory default.

Customizing the EXTRAS Setting

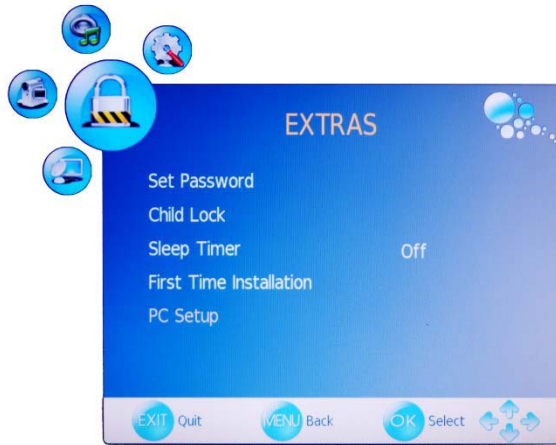

Use the ◀ and ▶ buttons to select the **EXTRAS** menu(as the picture above), press ▼ button to enter the menu.

The EXTRAS menu includes the following options :

Set Password	Set pin code. The default is 0000. If the Pin code has been changed you must enter the present code. New : Enter the new password. Confirm: Enter the new password and press OK to complete the change.
Child Lock	Lock the channel, you have to enter the code to view the channel. Use ▲/▼ button to select the channel, and press the green button on the remote control to set, and there will be a "🔒" on the channel, press the green button again to cancel.
Sleep Timer	Allows you to setup the sleep timer among: 10min, 20min, 30min, 60min, 90min, 120min, 180min, 240min and off.
First Time Installation	<p>* Please ensure that the aerial is connected to the connector labelled "RF" on the rear of the TV. Press "OK" to start the tuning process.</p> <p>* You can select "Language"(OSD display language), When you have selected, press ◀/▶ buttons to select "OK".</p>



PC Setup(only in VGA mode)

Press ▶ button to enter the submenu to adjust the picture of the screen.



DVD Operation

Turn on your TV then use the Function Button on the remote control or the TV / AV button on the TV to select DVD mode. If there is no disc in the DVD players the screen will show "NO DISC".

Place a disc

Insert a disc as instructed by the label next to the disc slot.

Do not touch the playing surface.

Hold the disc around the outside with your fingers and place the disc into the slot. The player will automatically draw the disc into the player.

To "Eject" the disc, press the "▲ / Eject" button on the TV or on the remote control.

Play

The contents of each disc vary, as to how the disc was authored and what features are included. Some discs start playing as soon as they have been read, some need "Play" selecting in the Menu. Different play modes are offered, such as Menu Play, Sequence Play and other modes.

Using the Display Feature

1. Compatible with DVD, SVCD, VCD, CD, HD-CD, WMA, Digital Audio disc discs.
2. Loading and playing DVDs (two pages)
 - Press INFO button once to show the first page:
 - "Disc Type, Title * / * (the playing title / total titles), Chapter * / * (the playing chapter / total chapters), Elapsed Time of the Disc".
 - Press the button again to show the second page:
 - "Language * / * (the serial number of playing language / the amount of optional languages) or Off, Language Type, Audio Type, Subtitle * / * (the serial number of playing subtitle / the amount of optional subtitles) or Off, Angle * / * (the serial number of playing angle / the amount of optional angles) or Off".
 - Press the button for the third time, the display menu fades out.
3. Loading and playing SVCD discs (two pages)
 - Press INFO button once to show the first page:
 - "Disc Type, Track * / * (the playing track / total tracks), Mute, PBC, Repeat Mode, Elapsed Time of the Playing Track".
 - Press the button again to show the second page:
 - "Language * / * (the serial number of playing language / the amount of optional languages) or Off, Language Type, Audio Type, Subtitle * / * (the serial number of playing subtitle / the amount of optional subtitles) or Off".
 - Press the button for the third time, the display menu fades out.
4. Loading and playing VCD
 - Press INFO button once to show the first page:
 - "Disc Type, Track * / * (the playing track / total tracks), Mute, PBC, Repeat Mode, Elapsed Time of the Playing Track".
 - Press the button again, the display menu fades out.
5. Loading and playing CD, HD-CD, WMA, Digital Audio / JPEG discs
 - Press INFO button once to show the first page:
 - "Disc Type, Track * / * (the playing track / total tracks), Mute, Repeat Mode, Elapsed Time of the Playing Track".
 - Press the button again, the display menu fades out.

Subtitles

1. Compatible with DVD, SVCD discs.
2. Press the Subtitle button on the remote once, and the subtitle info banner appears
3. When a DVD or SVCD is recorded with subtitles, you can use the Subtitle feature to view the subtitles on-screen. By default, subtitles are off. The info banner will display Subtitle Off.
4. To display subtitles, press the Subtitle button again. The default language with its responding serial number will be displayed in the info banner and subtitles will be displayed in that language. There are 8 supported subtitles: Chinese, English, Japanese, French, Spanish, Portuguese, Germany and Latin. With each consecutive press of the Subtitle button, the subtitle switches. For example, "Language Icon: [1 English DTS 6CH] or [Off]" (the availability of the subtitles are disc-dependent). To turn subtitles off, press the Subtitle button until Subtitle Off is displayed.

DVD Operation

Zoom In the Video Image

1. Compatible with DVD, SVCD, VCD, JPEG discs.
2. The Zoom Function allows you to enlarge the video image.
3. Press Zoom repeatedly to activate the function and choose the required zoom factor: Zoom 2, Zoom 3, Zoom 4, Zoom 1/2, Zoom 1/3, Zoom 1/4, Zoom Off.

Digital Audio Disc

1. Compatible with Digital Audio discs
2. The player will search the disc directory automatically and display the contents on screen.
3. The player will then start to play the first track, of the selected directory.
4. To change directories use the direction buttons.

DVD System Operation

System operation will define the setting of the set; these definitions will be stored until you change them again.

General Steps of Setup Menu

1. Pause or Stop the player. Press **SETUP** on the remote control. The main menu will be shown as below.

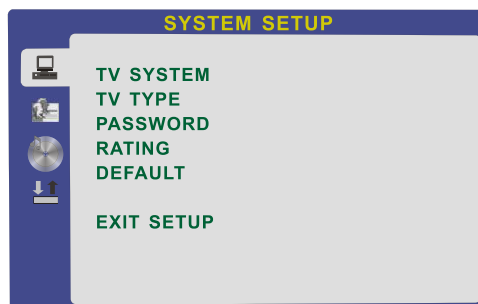

2. Press the **▲/▼** buttons to select the Icon of the desired section, e.g. "TV System" and press **▶** button to open that section.
3. Press **▲/▼** to select the desired feature and again press **▶** button to open that section.
4. Press **▲/▼** to select the desired feature and then press "OK" to select the new setting.
- 5 To exit the menu, press "SETUP" or **▼** to select EXIT SETUP and then press "OK"

When launching the setup routine, the pressing of the following buttons will turn off the setup menu, while the choices that have been changed will be saved.

Menu specification

1. SYSTEM SETUP

The system setup options are illustrated below:

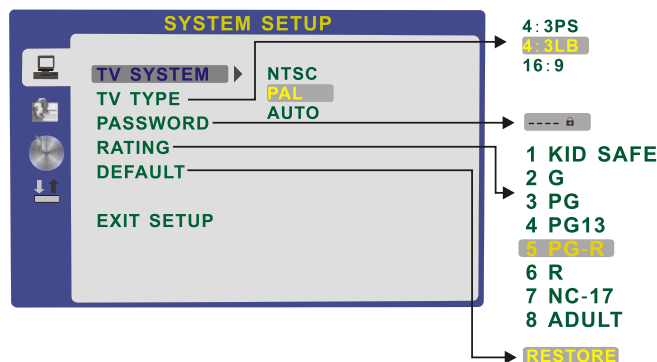

DVD Operation

TV SYSTEM

According to the Color system of your TV, select proper TV TYPE.

PASSWORD

The password option is initialized as locked. You cannot set the ratings limit or change the password.

To enable these features you must unlock the Password. The default password is "0000". Using the ▲/▼ button, move the highlight to "PASSWORD", press the ► button and enter "0000". You will see the padlock symbol open. You may now change the RATING or put in a new password number.

If the Lock symbol is BLUE you must press the ► button to enter the lock field, the lock symbol will change to YELLOW, you may now enter a new 4 digit number. Please remember or write down the new Password and keep safe.

RATING

The Rating feature is a rating limit feature, like movie ratings. This helps you to control what DVD the family watches. There are 8 levels of selection, from KIDS SAFE to ADULT. Adult is the "play all" selection.

2. LANGUAGE SETUP

The language setup options are illustrated below:

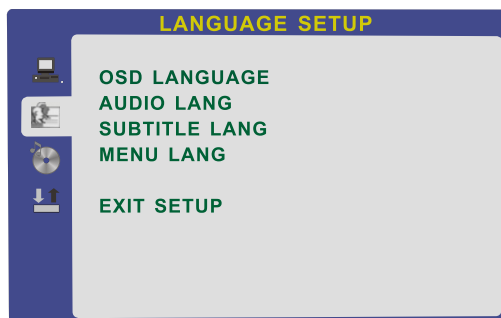

- OSD LANGUAGE: The OSD will display in the language you choose.
- AUDIO LANG: If the disc you are playing has the language you choose, it will output audio in that language.
- SUBTITLE LANG: If the disc you are playing has the language you require you may select this either in the Menu or using the "SUBTITLE" button on the Remote control. You may also switch this OFF.
- MENU LANG: If the disc you are playing has the language you require you may select this.

3. AUDIO SETUP

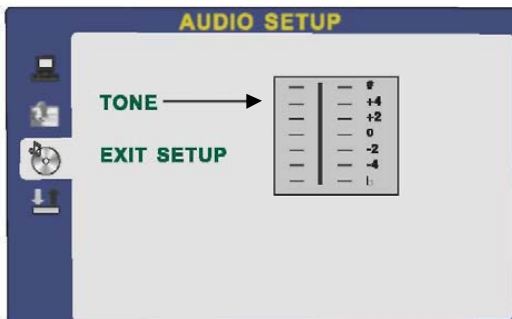

- TONE: Use the ▲/▼ button to move the scroll and adjust the tone.

DVD Operation

4. DIGITAL SETUP

The video setup options are illustrated below:

- DYNAMIC RANGE: Use the ▲/▼ button to move the scroll and adjust the dynamic range.
- DUAL MONO: Choose the mode of the audio output.
- There are four modes: STEREO, MONO L, MONO R, MIX MONO.

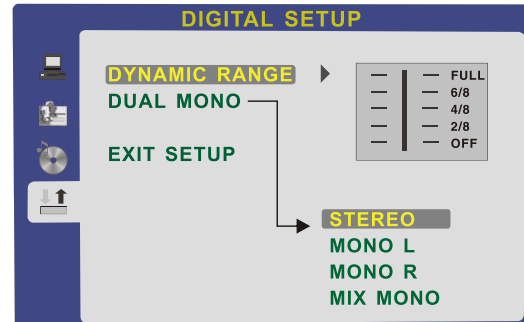

Disc Care

Disc Care

About Disc Terms

Title

Generally, pictures or music compressed on a DVD are divided into several sections, "title".

Chapter

The smaller section unit of picture or music in a DVD under the title, usually one title is comprised of one or more chapters and each of them is numbered for easy searching, but some discs may not have a recording chapter.

Track

A segment of picture or music on a CD, Each track is numbered for searching.

Care of Disc

Video disc contains high-density compressed data that needs proper handling.

1. Hold the disc with fingers by outer edge and/or the center spindle hole. Do not touch the discs surface.
2. Do not bend or press the disc.

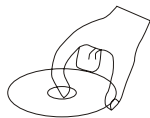

3. Do not expose the disc to direct sunlight or heating sources, Store discs in cabinet vertically, and in dry condition.

Prevent exposure to:

Direct sunlight

Heat or exhaust from a heating device

Extreme humidity

Clean the disc surface with a soft, dry cleaning cloth, Wipe the disc surface gently and radially from center toward the outer edge.

Do not apply thinner, alcohol, chemical solvent, or sprays when cleaning. Such cleaning fluids will permanently damage the disc surface.

Trouble shooting

- Do not use other functions that are not mentioned in this user's manual.
- In case a problem occurs with your LCD TV, please take the following steps first.
- If you still have the problem, turn the power off and contact your dealer or an authorized service center.

Problem	Action
No power to TV.	Check all connections.
The screen appears too slowly after the power is turned on.	This problem occurs for a brief time in the process of image elimination processing in order to hide temporary screen noise that occurs when the power is turned on. But if the screen does not come after 1 minute contact your dealer or an authorized service center.
Screen is too bright or too dark.	Perform brightness adjustment or Contrast adjustment.
Screen is too large or too small.	Adjust the screen size.
Stripes appear on the screen and it shakes.	Stop using wireless telephones, hair driers and electric drills.
The screen does not move.	Press the PAUSE button. Check if the Pause button is pressed on external equipment.
Screen appears, Voice is not heard	<ol style="list-style-type: none"> 1. Press the "MUTE"button. 2. Increase the sound level by pressing volume adjustment button. 3. Check if sound terminal of external input is connected properly. 4. Check if audio cables are connected properly. 5. Select and check the other input. <p>If the sound still does not work and the other channels are the same after you have done as the above, contact your dealer or an authorized service center.</p>
Remote control does not work	<ol style="list-style-type: none"> 1. Check if main power is On. 2. Check that the batteries of the remote controller were loaded properly. 3. Check to see if any obstacle exists between the LCD TV and the remote control , then remove it, if any. 4. If the batteries have no power, replace them with two new batteries.

- This LCD TV is for household use and registered as harmless on electromagnetic waves.
- Therefore, you can use it in every location as well as residential areas.

Specifications

TV

TV System	PAL/SECAM, BG/DK/I
Screen size	19"(diagonal)
Resolution	1440x900pixels (RGB)
Aerial input	75 Ω (unbalanced)
Audio output power	2x3 W
Power Consumption	AC 100-240V 50/60Hz 60W
Weight	4.60 Kg

Remote control

Type	infrared
Control distance	5m
Control angle	30° (horizontal)
Batteries	2 x 1.5 V, size AA
Dimensions	48 x 168 x24 mm
Weight	70 g (without battery)