

AT2758ML  
AT3258ML  
User Guide

<b>Important safety instructions</b>	<b>3</b>
Disposal instructions	5
<b>Your LCD TV overview</b>	<b>6</b>
Front and side panels	6
Rear panel view	7
Remote control	8
Enjoying analog and digital TV	11
<b>Connecting devices</b>	<b>13</b>
Basic connections	13
Connecting a DVD, VCR or audio/video equipment	14
TV-out	15
Connecting a camera, camcorder or game console	15
Connecting a PC or notebook computer	16
Connecting a USB storage device	16
Selecting the input source	17
<b>Channel controls</b>	<b>18</b>
Channel list	18
Favourite channel list	18
Programme information	19
Electronic programme guide	20
Navigating the EPG (for Digital TV mode)	21
Time shifting (digital channels only)	21
Record programs to a USB storage device (digital channels only)	22
<b>Playing multimedia files from a USB storage device</b>	<b>23</b>
Connecting a USB storage device	23
<b>OSD Menus</b>	<b>27</b>
OSD navigation	27
OSD Menu settings	28
<b>Troubleshooting</b>	<b>35</b>
There is no picture or sound	35
Picture is not clear	35
Picture is too dark, too light or tinted	35
Remote control does not work	35
<b>PC input signal reference chart</b>	<b>36</b>
<b>Product specifications</b>	<b>37</b>
<b>Wall mount preparation / removing the base</b>	<b>39</b>

Acer AT2758ML/AT3258ML

Model number: \_\_\_\_\_

Serial number: \_\_\_\_\_

Date of purchase: \_\_\_\_\_

Place of purchase: \_\_\_\_\_



HDMI, the HDMI logo and High-Definition Multimedia Interface are trademarks or registered trademarks of HDMI Licensing LLC.



Digital Video  
Broadcasting

DVB is a registered trademark of the DVB Project.

# Important safety instructions

---

Read these instructions carefully. Please put them somewhere safe for future reference.

1. Only use attachments/accessories specified by the manufacturer.
2. Use only with the cart, stand, tripod, bracket, or table specified by the manufacturer, or sold with the apparatus. When a cart is used, use caution when moving the cart/apparatus combination to avoid injury from tip-over.
3. Unplug this apparatus during lightning storms or when unused for long periods of time.
4. Do not install this equipment in a confined space such as a book case or similar unit.
5. No naked flame sources, such as lighted candles, should be placed on the apparatus.
6. If the remote control will not to be used for a long time, remove the batteries. Use the remote control carefully. Do not drop the remote control on the floor. Keep it away from moisture, direct sunlight, and high temperatures.
7. Used or discharged batteries must be properly disposed of or recycled in compliance with all applicable laws. For detailed information, contact your local solid waste disposal authority.
8. Follow all warnings and instructions marked on the product.
9. Unplug this product from the wall outlet before cleaning. Do not use liquid cleaners or aerosol cleaners. Use a damp cloth for cleaning.
10. Do not use this product near water.
11. Do not place this product on an unstable cart, stand or table. The product may fall, sustaining serious damage.
12. Slots and openings are provided for ventilation; to ensure reliable operation of the product and to protect it from overheating, these openings must not be blocked or covered. The openings should never be blocked by placing the product on a bed, sofa, rug or other similar surface. This product should never be placed near or over a radiator or heat register or in a built-in installation unless proper ventilation is provided.
13. This product should be operated from the type of power indicated on the marking label. If you are not sure of the type of power available, consult your dealer or local power company.
14. Do not allow anything to rest on the power cord. Do not locate this product where the cord will be stepped on.
15. If an extension cord is used with this product, make sure that the total ampere rating of the equipment plugged into the extension cord does not exceed the extension cord ampere rating. Also, make sure that the total rating of all products plugged into the wall outlet does not exceed the fuse rating.



16. Never push objects of any kind into this product through cabinet slots as they may touch dangerous voltage points or short-out parts, which could result in a fire or electric shock. Never spill liquid of any kind on the product.
17. Do not attempt to service this product yourself, as opening or removing covers may expose you to dangerous voltage points or other risks. Refer all servicing to qualified service personnel.
18. Unplug this product from the wall outlet and refer servicing to qualified service personnel under the following conditions:
  - a When the power cord or plug is damaged or frayed.
  - b If liquid has been spilled into the product.
  - c If the product has been exposed to rain or water.
  - d If the product does not operate normally when the operating instructions are followed. Adjust only those controls that are covered by the operating instructions. Improper adjustment of other controls could result in damage; extensive work by a qualified technician might then be required to restore the product to normal condition.
  - e If the product has been dropped or the case has been damaged.
  - f If the product exhibits a distinct change in performance, indicating a need for service.
19. Use only the proper type of power supply cord set (provided in your accessories box) for this unit. Always disconnect the power cord from the wall outlet before servicing or disassembling this equipment.
20. Do not overload an electrical AC outlet, power strip, or convenience receptacle. The overall system load must not exceed 80% of the branch circuit rating. If power strips are used, the load should not exceed 80% of the power strip input rating.
21. Some products are equipped with a three-wire electrical grounding-type plug that has a third pin for grounding. This plug only fits into a grounded electrical outlet. This is a safety feature. Make sure the AC outlet is properly grounded. Do not defeat the safety purpose of the grounding-type plug by trying to insert it into a non-grounded outlet. If you cannot insert the plug into the outlet, contact your electrician to replace the obsolete outlet.
22. Do not use this LCD TV in the workplace in accordance with BildscharbV, and maintain ample distance from it when watching. Watching a big-screen TV too close can cause eyestrain.
23. This TV is designed for home entertainment purposes only. Make sure there is sufficient distance between you and the TV when you are viewing content to avoid harming your eyes.



.....  
**The grounding pin is an important safety feature. It is possible to receive an electric shock from a system that is not properly grounded.**  
 .....



The grounding pin also provides good immunity ability against unexpected noise that interferes performance of this product and is produced by other nearby electrical devices.

## Disposal instructions

Do not throw this electronic device into the rubbish bin / container when discarding. To minimize pollution and ensure utmost protection of the global environment, please recycle.

For more information regarding WEEE, please refer to <http://global.acer.com/about/environmental.htm>.



**Соответствует сертификатам,  
обязательным в РФ**

Compliant with Russian regulatory certification.



**ME61**

# Your LCD TV overview

## Front and side panels

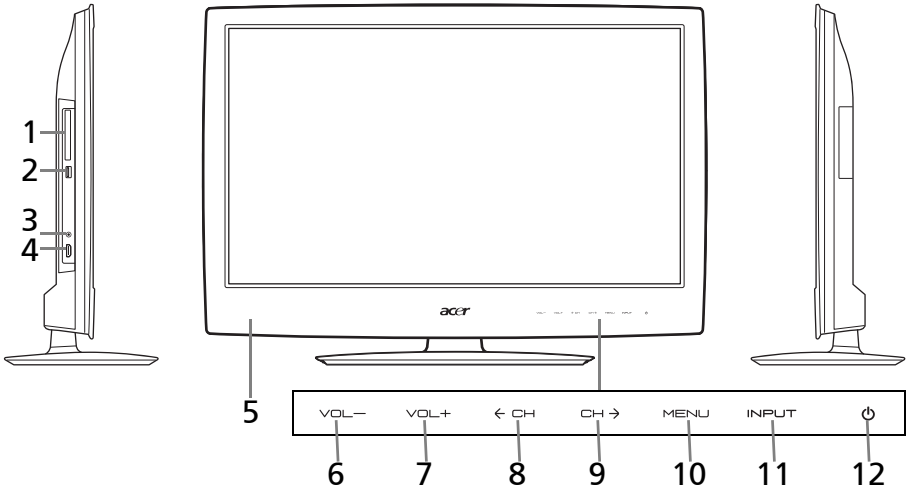

**Note:** The control buttons are touch-sensitive. Simply touch the area to activate the function.

No.	Item	Description
1	Common interface	Insert a common interface module here. A module may be required by certain channels (e.g. some pay-per-view channels).
2	USB port	Your TV can play multimedia files from a USB storage device, or use it to record or pause live TV. See "Connecting a USB storage device" on page 16.
3	Earphone	Insert a 3.5 mm headphone jack here.
4	HDMI port	See "Connecting devices" on page 13.
5	Remote control receiver	Receives signals from the remote control.
6	Volume down	When the OSD is on, functions the same as the Left arrow.
7	Volume up	When the OSD is on, functions the same as the Right arrow.
8	Channel down	When the OSD is on, functions the same as the Down arrow.
9	Channel up	When the OSD is on, functions the same as the Up arrow.

No.	Item	Description
10	Menu key	Turns the OSD menu ON and OFF.
11	Source (Input) key	Press to change input source. When the OSD is on, press this button to confirm selection.
12	Power button	Press to turn the TV ON and OFF.

## Rear panel view

No.	Item
1	AC-in
2	VGA-in + PC Audio-in
3	AV in-COMPONENT + Audio L/R
4	SCART
5	AV in-CVBS, Audio L/R
6	Hybrid tuner (supports analog and digital signals)
7	SPDIF out
8	HDMI ports

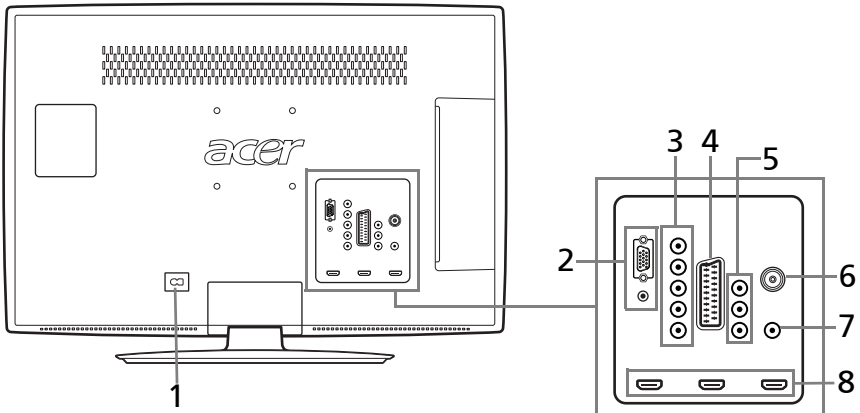

# Remote control

## Setting up the remote control

1. Open the cover on the back of the remote unit.
2. Insert two AA batteries (supplied) to match the polarity indicated inside the battery compartment.

## General keys

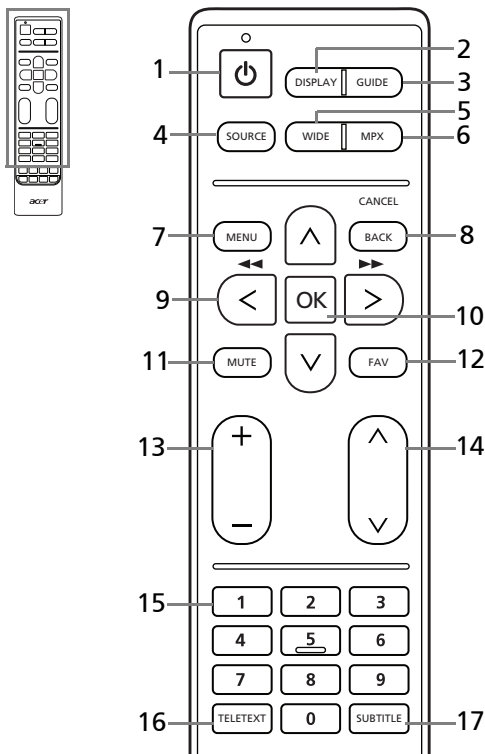

No.	Item	Description
1	POWER	Press to turn your TV on/off.
2	DISPLAY	Press to display or change input/channel information (dependent on input/source type).
3	GUIDE	Press to launch Electronic Programme Guide (EPG) mode (Digital TV mode only). See "Electronic programme guide" on page 20.
4	SOURCE	Press to select correct source/input mode. See "Selecting the input source" on page 17.



No.	Item	Description
5	WIDE	Press to toggle scaling mode between 4:3, 16:9 and different Letterbox modes (1, 2, 3). Wide Detect is also available when viewing digital TV, HDMI and SCART signals.
6	MPX	Press to display and select the audio signal.
7	MENU	Press to open or close the Menu.
8	Back/CANCEL	Press to back to previous Menu.
9	Directional keys	On certain models, the left and right directional keys also function as rewind and fast-forward keys when viewing multimedia files.
10	OK/ENTER/ CH LIST	ENTER: Press to confirm channel number selection. CH LIST: Press to launch the channel list. See "Channel list" on page 18.
11	MUTE	Press to toggle audio on and off.
12	FAV	Press to display the favorite channel list.
13	VOL (+/-)	Press to increase or decrease the volume.
14	CH (up/down)	Press to sequentially select the TV channel.
15	Number keys	Press 0 - 9 on the remote control to select a channel.
16	TELETEXT/MIX	Press to switch from TV/AV to Teletext mode. Press to overlay teletext page on the TV image.
17	SUBTITLE	Press to view subtitles on the screen.

## Teletext keys

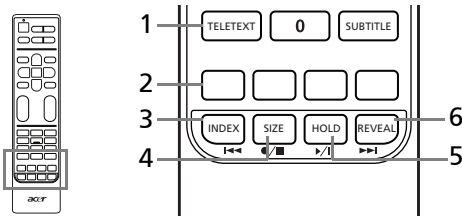

No.	Item	Description
1	TELETEXT/MIX	Press to switch from TV/AV to Teletext mode. Press to overlay teletext page on the TV image.
2	Colour buttons (R/G/Y/B)	Operates corresponding button on the teletext page.
3	INDEX	Press to go to the index page.
4	SIZE	Press once to zoom teletext page to 2X. Press again to resume.
5	HOLD	Press to pause the current teletext page.
6	REVEAL	Press to reveal hidden teletext information.

# Multimedia keys

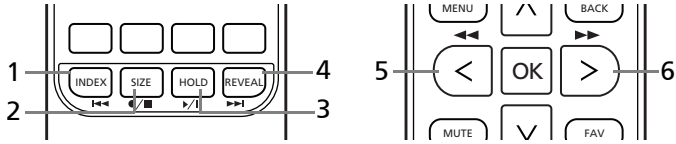

No.	Item	Description
1	Previous Track	Press to go to the beginning of a track, or the previous track.
2	Stop	Start recording a programme if a USB storage device is connected. Press to stop playback or recording.
3	Play/Pause	Press to start playing the selected track, or pause a track if it is already playing.
4	Next track	Press to skip to the next track if multiple tracks have been selected.
5 & 6	Rewind & Fast forward	You may use the left and right directional buttons to fast forward or rewind. Press the button again to increase how fast playback advances (x2/x4/x8/x16). Press the Play/Pause button to resume playback.

# Enjoying analog and digital TV

There are a few steps to perform when you first use your TV.

## Getting started watching your TV

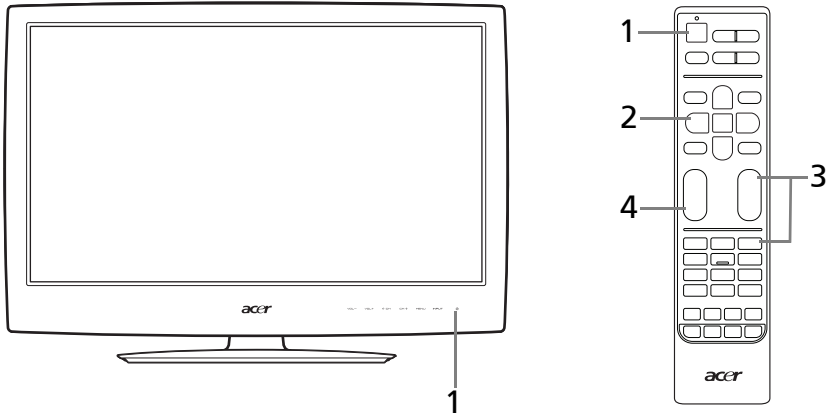

### 1. Setup

- a Connect the power and antenna cable to the TV. See "Basic connections" on page 13.
- b Insert the batteries in the remote control. See "Setting up the remote control" on page 8.

### 2. Power

- a Press the touch-sensitive power button beneath the screen OR press the power button or channel up/down button on the remote control.
- b Wait a few seconds for the TV to warm-up.

### 3. Installation guide

The first time you switch on the TV, you will be asked to select the language and scan for channels.

Press the **OK** key to begin the setup process.



**Tip:** You can also adjust these settings using the front control panel. See "Front and side panels" on page 6.

- a Select the setup language you prefer.
- b Please select the correct country for signal reception.
- c Select Home mode.
- d Ensure that antenna cable is connected correctly before proceeding.
- e Scan for digital channels and analog channels.
- f Setup is now complete. You are ready to begin watching TV.

#### 4. Changing channels

- a Press 0 - 9 on the remote control to select a channel. To allow you to enter channels with more than one digit, the channel changes after 2 seconds. Press **OK** to select the channel immediately.
- b Pressing the channel ( CH ) up / down button on the remote control will also change the channel.

#### 5. Adjusting the volume

Adjust the volume level using the ( VOL ) up / down button on the remote control.



.....  
**Note:** Setup may vary due to local broadcast differences.  
.....

# Connecting devices

---

## Basic connections

### Connecting the power cord

1. Connect the AC cord into the AC input on the back of the set.
2. Connect the plug to the wall outlet as shown.

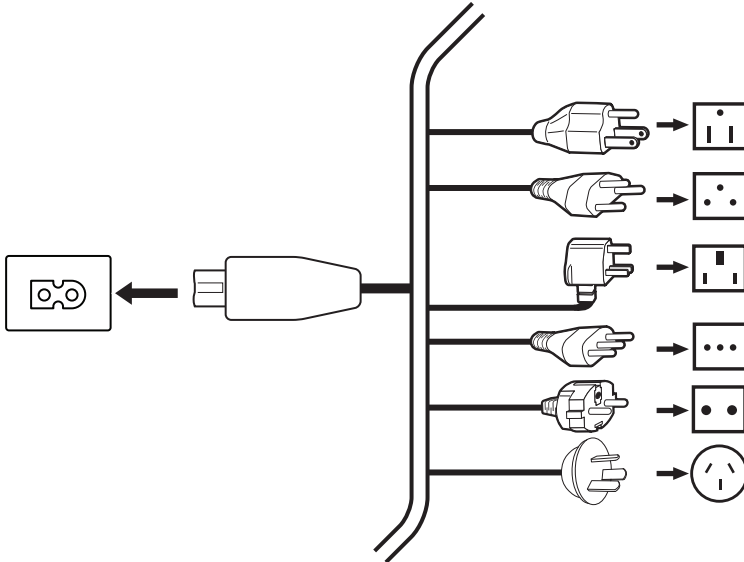

### Connecting an antenna/cable

Connect the antenna cable to the appropriate antenna terminal on the back of the TV set as shown below.

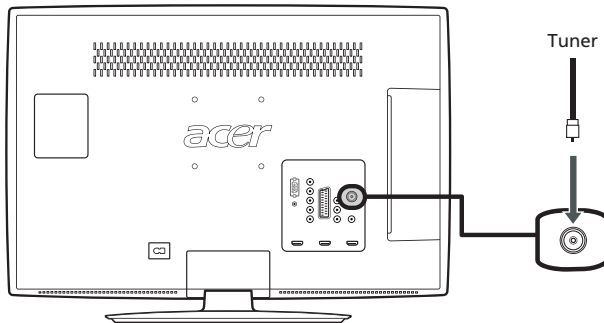

# Connecting a DVD, VCR or audio/video equipment

Connect your DVD player, VCR or audio/video equipment using the appropriate port located at the rear of your LCD TV as shown below.

## Source-in

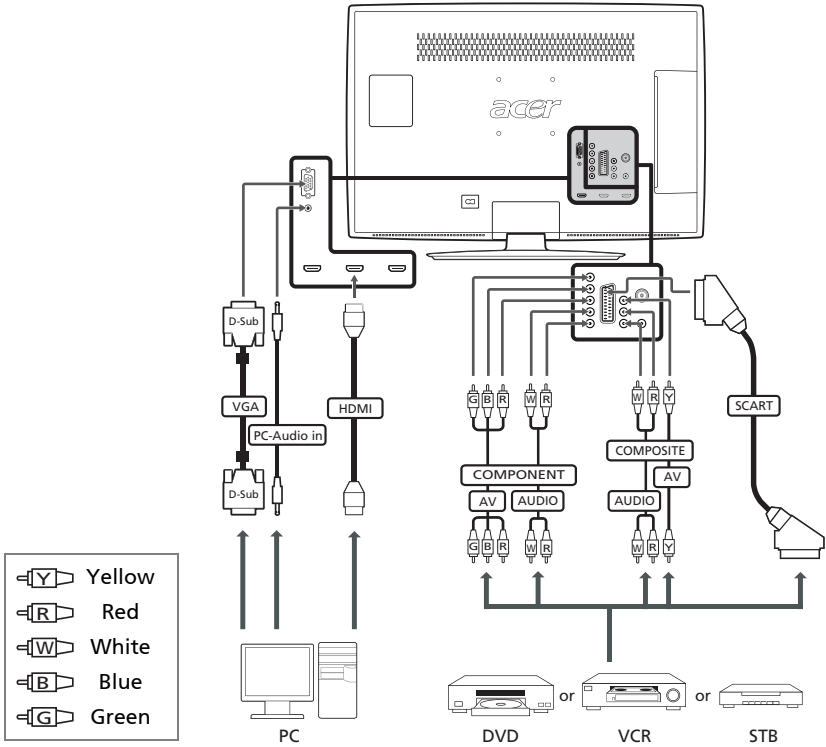

Acer recommends the following priority for connection types:  
HDMI -> COMPONENT -> SCART -> Composite.

# TV-out

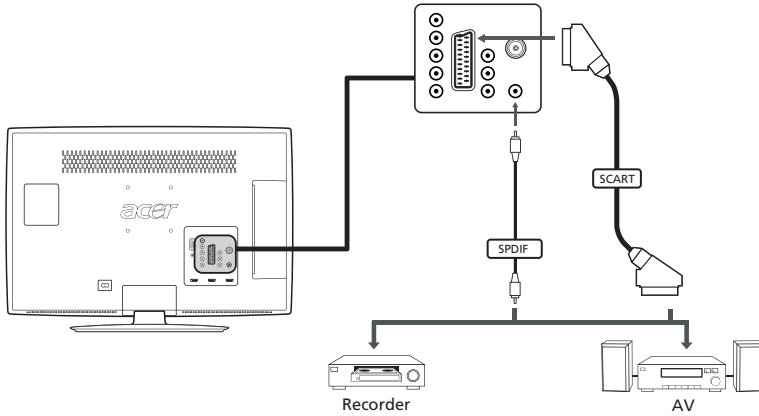

## Connecting a camera, camcorder or game console

Connect your camera or camcorder to the video/audio ports on the TV set as shown below.

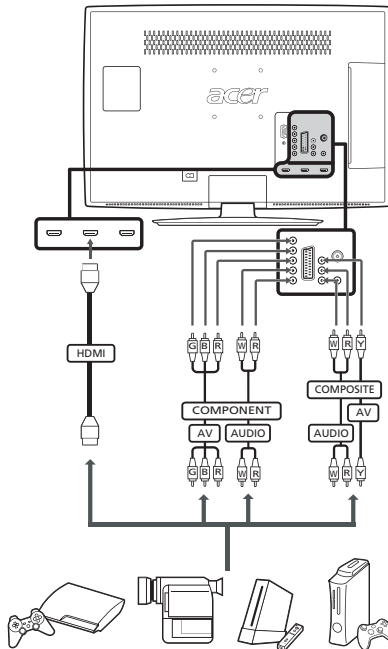

# Connecting a PC or notebook computer

To display PC output on your TV, connect your PC or notebook computer to the TV as shown below.

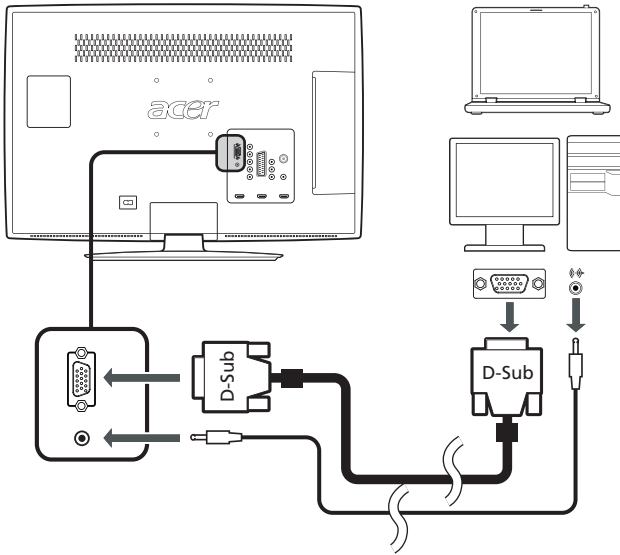

For VGA connections, Acer recommends setting your PC's external monitor resolution to match the screen resolution. See "Product specifications" on page 37.

# Connecting a USB storage device

To display multimedia content on your TV, connect the USB device to the TV as shown below.

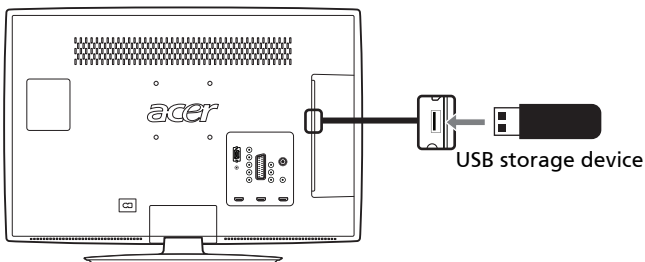



# Selecting the input source

Once you have connected your antenna or external equipment to the TV, you need to select the correct input source.

Press the **SOURCE** button on the remote control to see the list of available source connections:

- TV
- SCART
- Component
- PC-RGB
- AV
- HDMI1
- HDMI2
- HDMI3
- HDMI4
- Multimedia (USB)

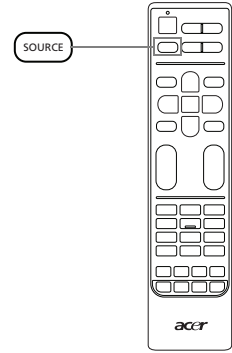

Press the **SOURCE** button or the up and down directional keys to change the selection.



**Tip:** Some options may be hidden at the bottom of the source list. Press the down button, or the **SOURCE** button, until the options are visible.

Input Source	
✓	TV
	AV
	Component
	SCART
	VGA
	HDMI 1
	HDMI 2
	HDMI 3

# Channel controls

## Channel list

Channel list allows you to quickly find the TV channel you are searching for.

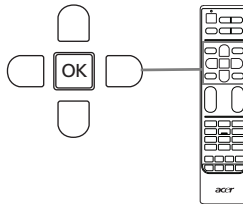

To open the channel list feature:

1. Press the **OK** key on the remote control.  
This will bring up the channel list menu.
2. The current channel will be highlighted.

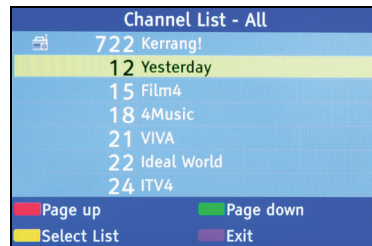

3. Use the up and down directional keys to navigate the list and press the **OK** key to select the channel you wish to watch.
  - Use the yellow key to switch between the digital and analogue channel lists.
  - Use the blue key to exit the list.

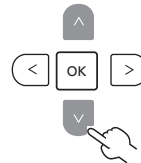

## Favourite channel list

The favourite channel list allows you to store your favourite TV channels and flick between them at the touch of a button.

To set a favourite channel, follow the steps described on this page.

## Storing favourite channels

1. Press the **MENU** key on the remote control to open the OSD menu. See "OSD Menu" on page 27.



- Use the directional keys to navigate to the **Channel management** menu.

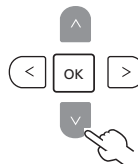

- Select **Channel edit**, then **Favourite list**.

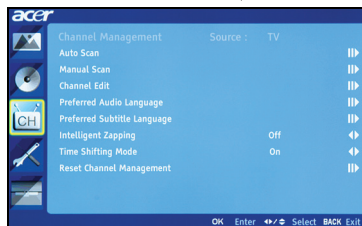

- Navigate to a channel and press **OK** to add or remove it from your favourite channels.

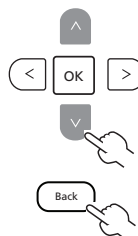

- Press the **BACK** key on the remote control to exit.

## Viewing your favourite channels

On the remote control, press the **FAV** key to display the next favourite channel defined in the favourite channel menu.



## Programme information

Press the **DISPLAY** key to see information about the current programme (if available).

a — Lesley Joseph narrates this affectionate look at the unlikely pin-ups of the 1970s music scene, from Gilbert O'Sullivan and Barry White to Leo Sayer and 1/2

b — Yesterday

c — Kings of 70s Romance

d — 12:00 - 13:00 English Stereo

e — 13:00 - 14:00 A History of Britain by Simon Schama

f — ★

g — SD

h — English 576i SD

- Programme summary**  
Use the up or down directional keys to see the entire summary.
- Channel title**
- Programme title**

- d **Programme time**
- e **Next scheduled programme**
- f **Subtitle** (and subtitle language)  
If 'STTL' is displayed press the **SUBTITLE** key to display subtitles.
- g **Audio language**
- h **Video definition**

## Electronic programme guide

The electronic programme guide (EPG) is an onscreen service available on digital and cable TV that provides information about scheduled broadcast programmes on all digital channels by time, title and channel.

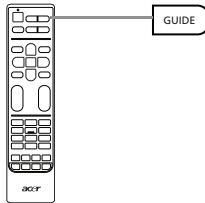

## Guide screen

There are four main areas of the EPG screen:

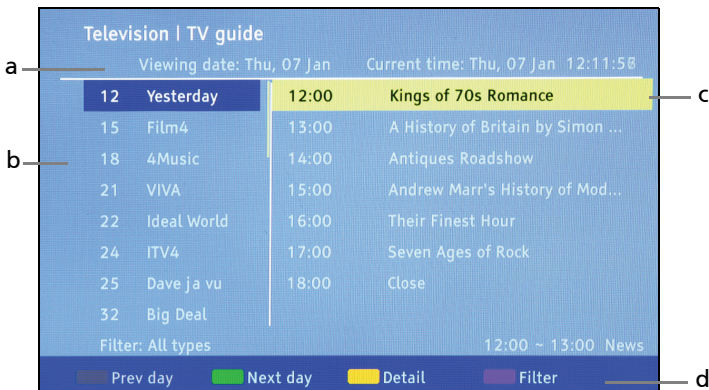

- a The top of the screen shows the date and time.
- b The section on the left shows all names for digital channels. Use the up or down directional keys to switch to the previous or next channel.
- c The section on the right shows the start time and title for programmes in the selected channel. Press the yellow key to see the start and finish times, any age rating and a summary.
- d The bottom of the screen shows additional options for changing the list of programs and channels.

# Navigating the EPG (for Digital TV mode)

1. Press the **GUIDE** key on the remote control.
2. Use the directional keys to navigate around the EPG menu and press **OK** to select your highlighted option.



## Time shifting (digital channels only)

Your TV allows you to temporarily store ('time shift') a program to a USB storage device (digital channels only); this allows you to pause the program, and later resume playback from that point.

1. Connect a USB storage device to the USB port on your TV. See "Connecting a USB storage device" on page 16.
2. While viewing a digital TV channel, press **PAUSE** to start the time shift function. If the USB storage device has not been configured for use with your TV, select **Auto** in the window that is displayed.
3. Use left and right direction keys to rewind and fast-forward the time-shifted program.
4. Press **BACK** to disable time shifting.



.....  
**Note:** The USB storage device must have at least one gigabyte (GB) of free space to store time shifting information. It is recommended you use an empty USB device.

If a Sleep timer had been set before activating the time shift function, the timer will be suspended.  
.....



.....  
**Warning:** Do not remove the USB storage device while time shifting is active. Disable time shifting before removing the device from the USB port.  
.....



.....  
**Note:** 180 minutes of 480i content, or 30 minutes of 1080i content, requires approximately four gigabytes (GB) of memory.

The time shift function cannot store more than four gigabytes of time shift information. Once four gigabytes of data has been stored, the time shift function will delete the stored data and restart storing content. This occurs even if more storage is available.  
.....

# Record programs to a USB storage device (digital channels only)

Your TV allows you to record digital TV programs to a USB storage device.

1. Connect a USB storage device to the USB port on your TV. See “Connecting a USB storage device” on page 16.
2. While viewing a digital TV channel, press **STOP/REC** to start recording the program. A confirmation message will be displayed for a short duration.
3. A progress indicator in the lower-left corner of the screen shows the duration of the recording.
4. Press **STOP/REC** again to stop recording the program.
5. Use the multimedia player to view your recorded programs (see “Playing multimedia files from a USB storage device”). Recorded files are stored in the “PVR” folder.



.....  
**Warning: Some USB storage devices may not support to the time shifting or recording functions. Please use a different storage device.**  
.....

# Playing multimedia files from a USB storage device

---

## Connecting a USB storage device

Connect the USB storage device to the USB port on your computer. See "Connecting a USB storage device" on page 16.

Press the **Source** button on the remote control and select **Multimedia**.

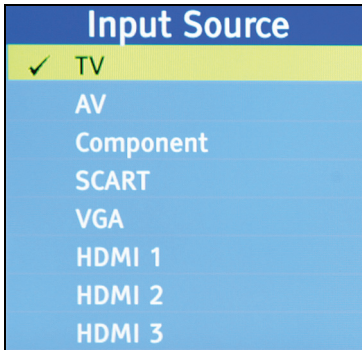
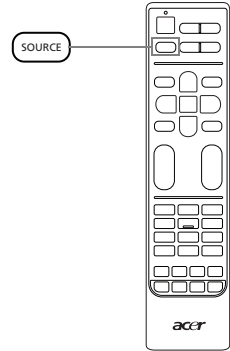

.....  
**Tip:** The Multimedia option may be hidden at the bottom of the source list. Press the down button, or the Source button, until the option is visible.  
.....

## Selecting multimedia (pictures, music or video)

The first screen allows you to select the type of media you want to access.

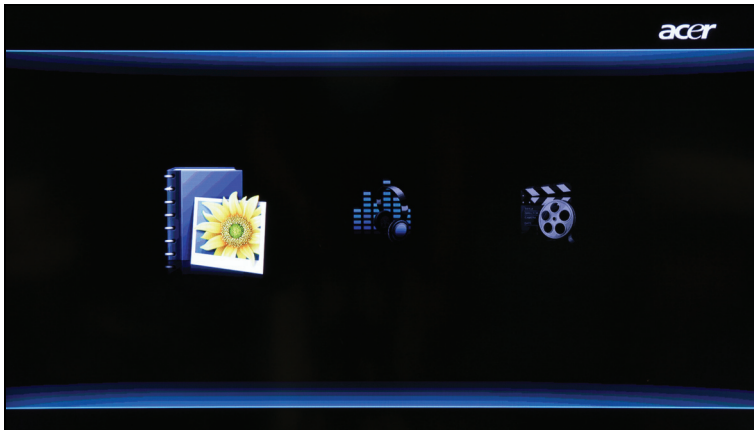

Use the left and right directional buttons to select **Pictures**, **Music** or **Videos** and press the **OK** button to access the USB storage device.

If you want to change the selected media type, press **MENU** to return to this screen.

## Navigating your USB storage device

There are three main areas of the multimedia screen:



### a Status bar

The top of the screen shows the type of media being viewed: **Pictures**, **Music** or **Movie**, with some information about the selected file. To change the selected media type, press **MENU** to return to the selection screen.

### b Navigation menu

The middle of the screen shows the contents of the USB device. Use the directional keys and press **OK** to open a file or folder.



.....  
**Note:** Only files that match the selected media type are displayed.  
.....

Press the **BACK** button to return to the folder that contains the folder being viewed.

### c File option bar

The bottom of the screen shows additional options for the file being viewed, such as volume level or special functions for the coloured buttons on the remote control.



.....  
**Note:** When playing a movie or viewing photos, the top and bottom bars will disappear after a short delay.  
.....



## Picture files

Select a picture and press **OK** to open it. Picture files will be shown in a slideshow, each picture will be displayed for a short duration. Press **Play/Pause** to pause the display on a specific photo.



Press **Previous** ('Index') or **Next** ('Reveal') to return to the previous picture, or to view the next picture.

Press **BACK** or return to the folder navigation list

## Music files

Select a music file and press **OK** to open it. Press **Play/Pause** to pause a track.



Press **Previous** ('Index') or **Next** ('Reveal') to skip to the previous track or advance to the next track in the folder.

Press and hold the left and right directional buttons to advance or rewind in a track. Press **BACK** to return to the folder navigation list and preview screen.

# Video files

Select a video file and press **OK** to open it. Press **Play/Pause** to pause a movie.



Press **Previous** ('Index') or **Next** ('Reveal') to skip to the previous video or advance to the next video in the folder.

You can use the left and right directional buttons to advance or rewind in a video. Press the button again to increase how fast the track advances or rewinds (x2/x4/x8/x16).

Press **BACK** to return to the folder navigation list and preview screen.

## Leaving multimedia storage display

Simply stop playback and press **SOURCE** on the remote control to select a different source type.



.....  
**Do not remove the USB storage device while a media file is playing. Stop playback and switch to a different source before removing the device from the USB port.**  
.....

# OSD Menu

Many of the advanced settings and adjustments are available through using the OSD (onscreen display) menus:

- **Picture settings** (page 28),
- **Sound settings** (page 29),
- **Channel management** (page 31),
- **Settings** (page 32),
- **Advanced** (page 33).

## OSD navigation

Basic operations required to navigate these menus are described in this section.

### Navigating the OSD with the remote control

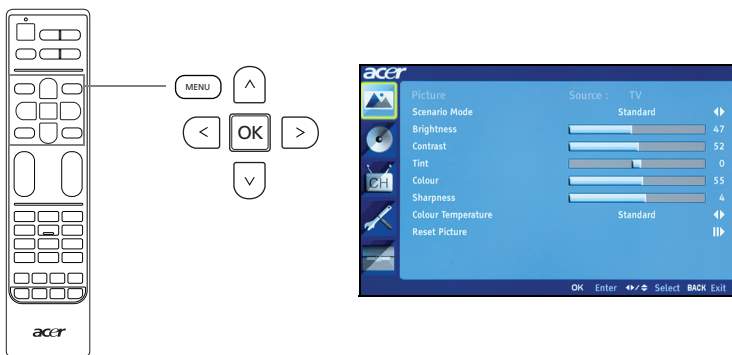

**Tip:** You can also interact with these menus using the front panel controls. Please see “Front and side panels” on page 6 for details.

There are five main OSD menus. These are: **Picture settings**, **Sound settings**, **Channel management**, **Settings** and **Advanced**. Use the following method to navigate these menus.

1. Press the **MENU** button on the remote control or the **MENU** button on the control panel.
2. Select your desired menu by using the up and down directional keys to switch between the five menus. Press **OK** or the right directional key to enter a menu. Press **BACK** or the left directional key to return to the menus.

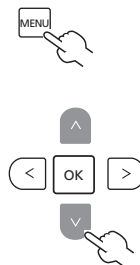

- Use the directional keys to interact with the menu. The up / down directions will scroll through the menu options, while left / right will adjust the different settings.

Press **MENU** to exit.

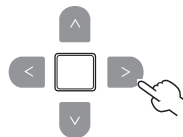

**Note:** The options available on the OSD may vary depending on the TV signal source and model. Some digital options may not be available with an analog signal and vice versa.

## OSD Menu settings

Several menus are available:

### Picture settings

Open the **Picture** menu as described on page 27. This menu provides the following settings:



### Scenario mode

Scenario mode provides preset viewing modes designed to give you the best picture quality when watching a particular kind of programme. These provide preset values for brightness, contrast, hue colour and sharpness. There are pre-defined audio and video settings for optimal enjoyment of the following scenarios: Standard, Movie, Game, Sport, Concert, User, NICE.

Mode	Information
Standard	Standard mode allows you to watch your favourite channels with sharp, brilliant imagery via adaptive brightness and contrast adjustments.
Movie	For comfortably enjoying movies at home, Movie mode displays dim scenes in clear detail; compensates for colour; and smoothly presents motion images. This is accomplished through optimal Gamma correction plus saturation, brightness and contrast adjustments.
Sport	Sport mode is suited for outdoor sports programmes, with accurate background depth and clear gradation between the bright, outdoor playing field and darker auditoriums. Sports mode also brilliantly enhances colours and presents swiftly moving pictures without residual images. All of this is achieved via specific Gamma corrections and saturation adjustments.
Concert	Concert mode places you in a virtual concert hall, opera house or other dim environment by means of adaptive brightness and contrast adjustments.

Mode	Information
Game	Game mode carefully details the exquisite graphics of modern video games, providing lifelike entertainment while protecting your eyesight by adjusting brightness and contrast.
User	User mode allows you to save your favourite video settings.
NICE	NICE changes picture parameters automatically according to current TV conditions, including source type, timing format, content category on DTV, and viewing distance (page 34).

## Brightness

Change the brightness of the image.

## Contrast

Change the contrast of the image.

## Tint

Change the tint of the image.

## Colour

Change the colour depth of the image.

## Sharpness

Change the sharpness of the image.

## Colour temperature

This setting adjusts the colour temperature of the image. You can set it to Standard, Cold, User or Warm depending on your preference. With the User setting, you may change the colour values individually.

## Reset picture

Return all picture settings to default values, removing any changes.

## Sound settings

Open the **Sound** menu as described on page 27. This menu provides the following settings:

### Scenario mode

Scenario mode provides preset audio modes designed to give you the best sound quality when listening to a particular kind of programme. These provide preset values for treble and bass. There are pre-defined audio and video settings for optimal enjoyment of the following scenarios: Standard, Movie, Game, Sport, Concert, User, NICE.



Mode	Information
Standard	Standard mode allows you to watch your favourite channels with sharp, brilliant imagery via adaptive brightness and contrast adjustments, and listen to clear-sounding audio.

<b>Mode</b>	<b>Information</b>
Movie	For comfortably enjoying movies at home, Movie mode displays dim scenes in clear detail; compensates for colour; and smoothly presents motion images. This is accomplished through optimal Gamma correction plus saturation, brightness and contrast adjustments. Movie mode makes the most of high-definition movie soundtracks.
Game	Game mode carefully details the exquisite graphics of modern video games, providing lifelike entertainment while protecting your eyesight by adjusting brightness and contrast. What's more, Game mode provides a heightened audio experience.
Sport	Sport mode is suited for outdoor sports programmes, with accurate background depth and clear gradation between the bright, outdoor playing field and darker auditoriums. Sports mode also brilliantly enhances colours and presents swiftly moving pictures without residual images. All of this is achieved via specific Gamma corrections and saturation adjustments. Precise audio can be heard.
Concert	Concert mode places you in a virtual concert hall, opera house or other dim environment by means of adaptive brightness and contrast adjustments. Concert mode accentuates symphonic harmonies and the tenor audio range.
User	User mode allows you to save your favourite video and audio settings.
NICE	NICE changes audio parameters automatically according to current TV conditions, including source type, timing format, content category on DTV, and viewing distance.

## Treble

Boost or reduce high audio tones.

## Bass

Boost or reduce low audio tones.

## Balance

Change the balance between the left and right speakers.

## Steady sound

This function prevents sudden changes in the audio output level. If this function is On, volume levels will be consistent when switching between input sources and changing channels.

## Speaker

Turn the TV speakers on or off.

## SPDIF type

This allows you to set the type of SPDIF audio signal that is used.

## Reset audio

Return all audio settings to default values, removing any changes.

# Channel management

Open the **Channel Management** menu as described on page 27. This menu provides the following settings:

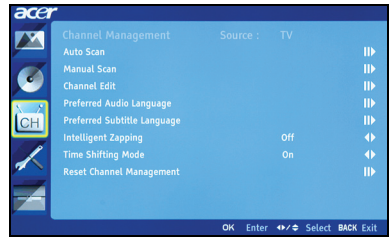

## Auto scan

Auto scan allows you to scan for new or deleted channels. If you completed the setup wizard the first time you turned on your TV, all available channels are listed.

To scan again, select the Auto Scan setting, and then your country from the Country List. Use the directional keys to select **Start tuning** and press the **OK** key.

Wait until the scan has finished; this will take several minutes.

## Manual scan

### Analog manual scan

You can manually add an analog channel by adjusting the settings here. Use the up or down directional keys to select a setting to change, use the left or right directional keys to change the setting. You may set: the analog channel where the signal will be stored, the encoding system, which direction to search through analog frequencies, fine tune to a specific frequency and if this channel will be skipped in the channel list.

Use the left or right directional keys to change the channel being scanned.

### Digital manual scan

You can manually add a digital channel by searching in specific UHF channels. Use the left or right directional keys to change the channel being scanned.

## Channel edit

You can edit the detected channels, to change how they are displayed in the channel list. Use the up or down directional keys to select a channel, you can perform different actions:

- Edit.
- Skip.
- Reorder.
- Decode (available for channels that require a decoder).
- Analog channel fine tune.
- Favourite list.
- Clean channel list (remove all detected channels).

## Preferred audio language

If you are viewing an analog channel that supports multiple sound signals (e.g. NICAM, Bilingual), you may set which signal is used.

## Preferred subtitle language

If multiple subtitles are available, the TV will display the language selected in this option, if it is available.

When watching TV, press the SUBTITLE key to see a list of available subtitles.

## Intelligent zapping

This option sets the delay before a channel is added to the zapping memory. If a delay is set here, channels viewed for less than this period will not be added to the zapping memory.

## Time shifting mode

Turn the Time shifting features on or off.

## Reset channel management

Return all channel settings to default values, removing any changes.

## Settings

Open the **Settings** menu as described on page 27. This menu provides the following settings:

### Wide mode

Press to toggle scaling mode between 4:3, 16:9 and different Letterbox modes (1, 2, 3).

Wide Detect is also available when viewing digital TV, HDMI and SCART signals.



### Menu language

Set the language displayed for the OSD menus.

### Sleep

You can set a time delay, after which the TV will turn off. The delay can be 15, 30, 45, 60, 90 or 120 minutes.

### Auto power down

If Auto power down is active, if the TV on for four hours without any channel changes or other activity, it will turn off. A warning message is displayed before the TV turns off.

### CI

This setting shows information about the CI interface, if a CI card is being used.

### Onscreen help

Show onscreen help messages.

### Time setup

Use these settings to set your time zone and daylight savings period.

### Reset settings

Return all settings (in this section) to default values, removing any changes.



# Advanced

Open the **Advanced** menu as described on page 27. This menu provides the following settings:



## Parental control

Parental control is a handy feature that can block chosen TV sources.

Parental control allows you to enter a password and effectively stop anyone without the password from watching TV.

Select the Parental Control setting and press **OK**. Enter your Password (see below), then select one of the options.

## Channel block

Press **OK** to see the list of channels. Use the up and down directional keys to select the channel to block and then press **OK**. A padlock symbol is displayed next to blocked channels. Press the **OK** again to unblock a channel.

When viewing channels, if a blocked channel is selected the TV will ask for your password. Enter your password to view the channel.

## Age rating (for digital TV)

Most digital TV allows you to block content according to rating systems. The rating system used is dependent on region, and is only available on digital channels. Analog channels will not be blocked with this option.

The settings cover from 4 to 18 years of age. When you lock a category, the categories for that age and younger will be blocked.

## Input block

Press **OK** to see the list of input sources (SCART, HDMI, etc.). Use the up and down directional keys to select the input source to block and then press **OK**. A padlock symbol is displayed next to blocked input sources. Press the **OK** again to unblock an input source.

## Change password

You can change the default password to a 4-digit code of your choice. If you are using the parental controls, then we recommend you change the password periodically.

## Clean all

Return all parental settings to default values, removing any changes.



.....  
The default password for this TV is "0000." First enter "0000" when you want to change the password. If you forget your password, please enter 6163 to reset.  
.....

## Advanced picture adjust

### DNR

Dynamic noise reduction. Reduce any noise on the video signal.

### ACM

Activates Automatic Contrast Management to adjust the backlight brightness depending on the video.

### Backlight

Change the brightness of the TV backlight.

### Viewing distance

If you are using the NICE scenario mode, use this option to set the distance between you and the TV.

### SCART

A SCART connection can send AV, S-video, or both signals. Use this setting to select the correct signal, or the signal that provides the best quality.

## Accessibility

### Subtitle type

You can choose between normal subtitles and subtitles for the hearing impaired, when these are available.

### Audio type

If audio for visually impaired audiences is available, it may be activated with this option.

### Visually impaired

This slider controls the volume of the Visually impaired audio.

### LED light

You can turn off the standby power light here.

### Blue Mute

If blue mute is on and the television receives no signal, a blue screen is displayed.

## Teletext language

Use these settings to adjust digital teletext settings.

### Digital Teletext language

Set the language used for digital teletext pages.

### Decoding page language

Set the type of text used for teletext pages.

## Reset advanced

Return all advanced settings to default values, removing any changes.

# Troubleshooting

---

Before you call the Acer service center, please check the following items:

Here is a list of possible situations that may arise during the use of your LCD TV. Easy answers and solutions are provided for each.

## There is no picture or sound

- Make sure the power cord is properly inserted in the power outlet.
- Make sure the input mode is correctly set by your selected input.
- Make sure the antenna at the rear of the TV is properly connected.
- Make sure the main power switch is turned on.
- Make sure the volume is not set to minimum or the sound is not set to mute.
- Make sure the headphones are not connected.
- Reception other than those of broadcasting stations can be considered.

## Picture is not clear

- Make sure the antenna cable is properly connected.
- Consider whether your TV signal is being properly received.
- Poor picture quality can occur due to a VHS camera, camcorder, or other peripheral being connected at the same time. Switch off one of the other peripherals.
- The 'ghost' or double image may be caused by obstruction to the antenna due to high-rise buildings or hills. Using a highly directional antenna may improve the picture quality.
- The horizontal dotted lines shown on the pictures may be caused by electrical interference, e.g., hair dryer, nearby neon lights, etc. Turn off or remove these.

## Picture is too dark, too light or tinted

- Check the colour adjustment.
- Check the brightness setting.
- Check the sharpness function.
- The fluorescent lamp may have reached the end of its service life.

## Remote control does not work

- Check the batteries of the remote control.
- Make sure the remote sensor window is not under strong fluorescent lighting.
- Try to clean the remote control sensor lens on the TV with a soft cloth.
- Use the buttons (hotkeys) on the TV before the remote control works.

If the above suggestions do not solve your technical issue, please refer to the warranty card for service information.

# PC input signal reference chart

---

	Resolution	Horizontal Freq. (kHz)	Vertical Freq. (Hz)	Standard
1	640 x 480	31.5	60.0	VGA
2	640 x 480	37.9	72.8	VGA
3	640 x 480	37.5	75.0	VGA
4	640 x 480	35.0	66.7	MAC
5	720 x 400	31.5	70.1	VESA
6	800 x 600	35.2	56.3	SVGA
7	800 x 600	37.9	60.3	SVGA
8	800 x 600	48.1	72.2	SVGA
9	800 x 600	46.9	75.0	SVGA
10	832 x 624	49.7	74.6	MAC
11	1024 x 768	48.4	60.0	XGA
12	1024 x 768	56.5	70.1	XGA
13	1024 x 768	60.0	75.0	XGA
14	1280 x 800	45.0	59.9	VESA
15	1152 x 864	67.5	75.0	VESA
16	1280 x 800	49.7	59.8	WXGA
17	1360 x 768	47.7	60.0	WXGA
18	1360 x 768	47.7	59.8	WXGA
19	1600 x 900	56.0	59.9	WXGA
20	1600 x 900	70.5	74.9	WXGA
21	1280 x 1024	64.0	60.0	SXGA
22	1400 x 1050	65.3	60.0	SXGA+
23	1680 x 1050	65.3	60.0	WSXGA+
24	1920 x 1080	67.5	60.0	-
25	1920 x 1080	66.6	59.9	-



.....  
PC input does not support Sync on Green, Composite Sync or interlaced signals.  
.....

# Product specifications

Model	AT2758ML	AT3258ML
<b>Panel spec</b>		
Resolution (pixels)	1920 (H) x 1080 (V)	
Brightness (typ.)	300 nit	400 nit
Contrast Ratio (typ.)	1200:1	4000:1
Display colour	16.7 M	
Viewing angle (typ.)	H: 170° ; V: 160°	H: 178° ; V: 178°
Response (typ.)	3.4 ms (gray to gray)	6.5 ms (gray to gray)
<b>Power supply</b>		
Input	220~240VAC, 50/60 Hz	
Max. power consumption	70 W	108 W
Power saving	<0.5 W	
<b>Mechanical</b>		
Dimensions (W x H x D mm)	669 x 477 x 196	791 x 544 x 202
Weight (kg)	6	10.5
Weight (lbs.)	13.22	23.15
Gross weight (kg)	8.3	12.4
Gross weight (lbs.)	18.3	27.4
Wall-mounting holes	VESA, 100 mm x 100 mm	VESA, 200 mm x 100 mm
<b>Analog TV system</b>		
Colour system	PAL, SECAM	
Sound system	B/G/D/K/I/L	
Stereo system	NICAM / A2	
Subtitle	Teletext 1.5 (1000 pages)	
<b>Digital TV system</b>		
Digital TV standard	DVB-T/C (H.264)	
Sound system	ISO11172-3 layer 1 & layer 2, ISO14496-3 HE-AAC 32 KHz, 44.1 KHz, 48 KHz	
Stereo system	MPEG (Layer I & II), HE-AAC, Dolby AC-3/AC-3 +	
Frequency	7/8 MHz	
Resolution	1080P	
<b>Terminal</b>		
Analog/ Digital Tuner	Hybrid	
HDMI	x4 (1.3)	
AV-in	CVBS, Audio (R/L)	
SCART	CVBS (In/Out), RGB (In), Audio R/L (In/Out), ATV/DTV	

<b>Model</b>	<b>AT2758ML</b>	<b>AT3258ML</b>
Component in		x1
PC D-sub in		x1
PC audio in		x1
SPDIF out		Yes (coaxial)
Headphone out		Yes
USB Port		Yes
<b>Resolution</b>		
HDMI	480i / 480P / 576i / 576P / 720P / 1080i / 1080P	
<b>Audio system</b>		
Speakers	10 W + 10 W	
<b>Mutimedia support via USB</b>		
Photo	JPG, BMP, PNG	
Audio	MP3, AAC	
Video	MPEG-2, H264	
PVR	Yes	

# Wall mount preparation / removing the base

---



.....  
**Caution: Disassemble the base carefully otherwise the plastic parts and/or TV body may be damaged.**  
.....

1. Remove the base cover.
2. Remove the screws that hold the stand.
3. Remove the base.
4. Assemble the wall mount following the instructions included with the wall mount.

